

Part number

PHW 12565 PV



Mobile socket outlet, PLUSO HEAVY DUTY series, 3 poles + N + PE, 6 h (red), 125 A, 380 ÷ 415 V

Product description		Material properties	
Product type	Socket Mobile	Colour	RAL 7012 grey, RAL 3000 red
Series	PHW...PV, PLUSO HEAVY DUTY	RoHs conformity	Compliant with exemption 6(c): copper alloy containing up to 4% lead by weight
Connection type	Screw terminal connection	China RoHs - EFUP	50
N. of poles	3 poles + N + 	REACH SVHC substances	Yes Lead
Clock position	6	SCIP number	Ca7de37f-add8-4b77-9861-279c94903ade
Technical data		Approvals / Standards	
Current	125 A	Reference standard	EN 60309-1 and -2
Voltage	380 ÷ 415 V	General ordering information	
IP degree of protection	IP66 / IP67	EAN13 code	8015747144520
Further technical details		Packaging Information	
Weight	2.150,00 g	Packaging length	330,00 mm
Operating temperature range (min, max)	-40°C ... +100°C	Packaging height	170,00 mm
		Packaging width	230,00 mm
		Packaging weight	4,56 kg
		Packaging volume	12,90 dm ³
		Packaging description	Carton box
		Packaging quantity	2 Pcs
		Packaging EAN code	8015747202930
		Sub-packaging weight	2,28 kg
		Sub-packaging description	Plastic packaging
		Sub-packaging quantity	1 Pcs
		Sub-packaging EAN barcode	8015747144674

Part number

PHW 12565 PV



Catalogue drawings

(63 / 125A) PHW ... PV

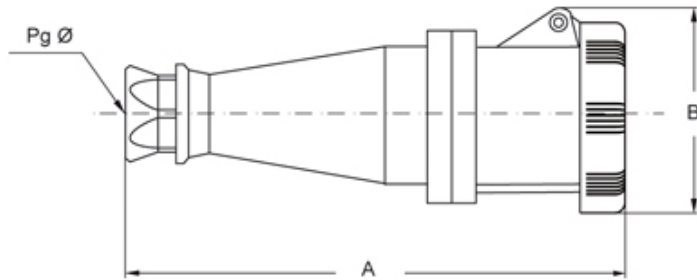

PHW...PV		A	B	Pg ø
63A	2P+⊕	277	108,5	36
	3P+⊕	277	108,5	36
	3P+N+⊕	277	108,5	36
125A	2P+⊕	324	120,5	2"gas
	3P+⊕	324	120,5	2"gas
	3P+N+⊕	324	120,5	2"gas

Notes

Dimensions shown in mm are not binding and may be changed without notice.

-
- Temperature range: from -40 °C to +100 °C
 - Compliant with EN 60309-1 and -2
 - Enclosure, insert and locking ring in insulating, thermoplastic, self-extinguishing material
 - PHW...PV types (IP66/IP67), RAL 9005 black enclosure, locking ring with gasket colour coded according to the operating voltage, entry with cable gland
 - Terminals with retained screws
 - Stainless steel insert fixing screws
 - Nickel-plated contacts as standard
-