

**⚠️ DANGER / 危险**  
**HAZARD OF ELECTRIC SHOCK, EXPLOSION, OR ARC FLASH**  
 Disconnect all power before servicing equipment.  
**Failure to follow these instructions will result in death or serious injury.**  
 可能有触电、爆炸或者电弧灼伤的危险  
 在此电力设备上工作时 请先切断所有电源。  
 不遵循上述规定将可能导致人员伤亡。

				<b>AWG</b>		
		[mm <sup>2</sup> ]	[mm <sup>2</sup> ]			
d	LC1D093/D123/ DT203/D0983	10 mm 3/8"	1...2,5	1...2,5	AWG14-18 CU 75°C Solid or Stranded	3,5 mm
	LC1D183/D253/ DT253/D1283	10 mm 3/8"	1...4	1...4	AWG10-18 CU 75°C Solid or Stranded	4 mm
	LC1D323	10 mm 3/8"	1...4	1...4	-	4 mm
l	LC1DT323/DT403/ D1883/D2583	13 mm 1/2"	1...10	-	AWG10-14 CU 75°C Solid AWG8-14 CU 75°C Stranded	4 mm
	LC1D●●3	8 mm 5/16"	1...2,5	1...2,5	AWG14-18 CU 75°C Solid or Stranded	3,5 mm

"For Motor Starting Use Schneider Electric Overload Relay Series LR".  
 电动机启动请使用施耐德电气LR系列热过载继电器

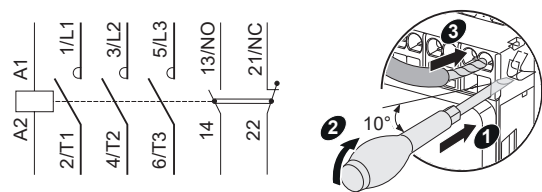

3PAC TeSys D contactors are grade 3 (LC1D09 -> LC1D18) and grade 2 (LC1D25 -> LC1D38) according to GB 21518. Maximum power consumption lower than 9.5 VA.  
 根据GB 21518标准, 三相 TeSys D 系列交流接触器能效等级为3级(LC1D09 -> LC1D18)和2级(LC1D25 -> LC1D38), 产品最大吸持功率低于9.5VA

**Schneider Electric Limited**  
 Stafford Park 5  
 Telford, TF3 3BL  
 United Kingdom  
 www.se.com/uk



**Schneider Electric Industries SAS**  
 35, rue Joseph Monier - CS 30323  
 F - 92506 Rueil Malmaison Cedex  
 www.se.com/contact

© 2021 Schneider Electric  
 All rights reserved.

W9 1378322 0211 A08  
 04/2021

