

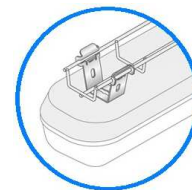

Chemin de câbles fil
(Mesh tray)

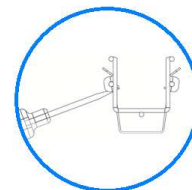
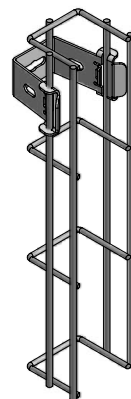

Description	Code	Masse/Weight Kg/p	Ep./Th. mm	 daN
SUL 50 SZ	552118	0,073	1,75	40

G : Pre-galvanised according to NF EN 10346 (S220 GD / Z).

SZ : Tôle d'acier galvanisé avant fabrication suivant NF EN 10346 (S220 GD / Z).



www.niedaxfrance.fr

SUL 50 SZ
SUL 50 BRACKET G



ASSISTANCE TECHNIQUE
+33 (0)1 55 95 92 17
pole.technique@niedax.fr

FT03252

NIEDAX
France

