

THE PANEL 2

102097.01

novalux
ITALIAN LIGHTING DESIGN SINCE 1948

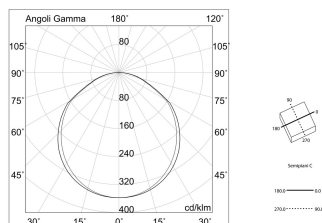
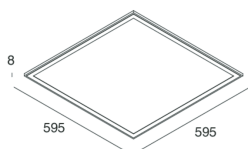

Features

Use: Indoor
Type of installation: RECESSED INTO PLASTERBOARD, SUSPENDED, CEILING MOUNTED
Emission: DIRECT
Colour: WHITE
Dimming: PUSH, DALI
Emergency: WITH ACCESSORY
L: 595mm
A: 595mm
H: 10mm
Warranty: 5 years
Weight: 3kg

Tech data

Luminaire input power: 39W
Luminaire luminous flux: 3447lm
Luminous flux in emergency: 1h: 12% / 3h: 5
IP: 40
Insulation class: I
Supply voltage: 950mA driver incluso
UGR: <19
IK: 07
SELV: Si

Source

Light source: LED
Source power: 35W
Source luminous flux: 4155lm
Colour temperature: 4000K
CRI: >80
Colour tolerance: 3 Step MacAdam
LED lifespan: 50000h L80 B20

Compliance

CEI EN 60598-1:2015 + A11:2009. IEC 60598-2:2015 2-1, 2-2

Standards

Photobiological risk: RISK GROUP 0 Certified fixture in EXEMPT GROUP, in accordance with CEI EN 62471:2010-01, IEC TR 62778:2014.

CAM edilizia: The product complies with the requirements for public buildings, ministerial decree of 23rd June 2022 n.256.

[View more product info](#)



Novalux S.r.l. via Marzabotto, 2 40050 Funo di Argelato (BO) Italy
Tel: +39 051 860558 · Fax +39 051 6647859 · Mail: info@novalux.it · VAT number 00536541204 · novalux.com
Company subject to the management and coordination by SLV GmbH

This technical data sheet is owned by Novalux S.r.l., all rights reserved. Novalux S.r.l. reserves the right to make changes without prior notice.

THE PANEL 2

102097.01

novalux
ITALIAN LIGHTING DESIGN SINCE 1948

MOUNTING ACCESSORIES

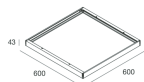

BOX PER INST. PLAFONE THE PANEL 600X600

102086.01

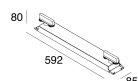

THE PANEL 2: KIT PER BIN.600X600 3P

102053.01

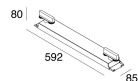

THE PANEL 2: KIT BIN.600X600 3P+DALI

102055.01

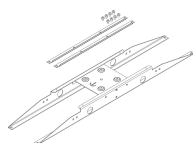

THE PANEL: STAFFE PLAFONE 600/1200

16213.99



THE PANEL 2: KIT ANTIC. L3000 +MORS.

102031.99

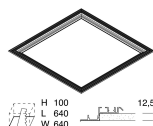

THE PANEL 2: KIT INST.INC.RAS.CART.600

102028.99



Novalux S.r.l. via Marzabotto, 2 40050 Funo di Argelato (BO) Italy
Tel: +39 051 860558 · Fax +39 051 6647859 · Mail: info@novalux.it · VAT number 00536541204 · novalux.com
Company subject to the management and coordination by SLV GmbH

This technical data sheet is owned by Novalux S.r.l., all rights reserved. Novalux S.r.l. reserves the right to make changes without prior notice.

THE PANEL 2

102097.01

novalux
ITALIAN LIGHTING DESIGN SINCE 1948

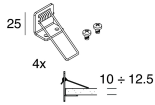

THE PANEL: KIT MOLLE INC.CART.600/1200

16215.99

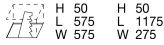

THE PANEL: KIT SOSP.600/1200 CAVI 4X3MT

16223.99



KIT ALIMENTAZIONE L1200 5P BIA

108921.01



KIT ALIMENTAZIONE L3000 5P BIA

108922.01

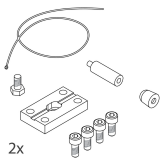

THE PANEL: N.2 GIUNTI+N.2 SOSP.L3000 AN.

16227.96

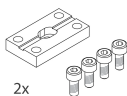

THE PANEL: N.2 GIUNTI NON SOSPESI

16232.96

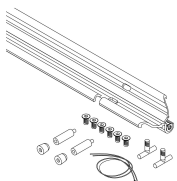

THE PANEL: SNODO 600+N.2 SOSP.L3000 BIA.

16228.01



Novalux S.r.l. via Marzabotto, 2 40050 Funo di Argelato (BO) Italy
Tel: +39 051 860558 · Fax +39 051 6647859 · Mail: info@novalux.it · VAT number 00536541204 · novalux.com
Company subject to the management and coordination by SLV GmbH

This technical data sheet is owned by Novalux S.r.l., all rights reserved. Novalux S.r.l. reserves the right to make changes without prior notice.

THE PANEL 2

102097.01

novalux
ITALIAN LIGHTING DESIGN SINCE 1948



4x

THE PANEL: N.4 SOSP. SNODATE L3000

16230.99

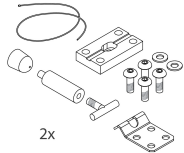

2x

THE PANEL: N.2 GIUNTI SNODATI L3000

16231.96

EMERGENCY ACCESSORIES

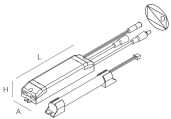

THE PANEL 2: EMER.INC.1H 10/54VDC

1020A4.99

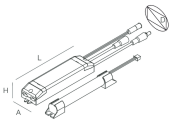

THE PANEL 2: EMER.INC.3H 10/54VDC

1020A5.99



Novalux S.r.l. via Marzabotto, 2 40050 Funo di Argelato (BO) Italy
Tel: +39 051 860558 · Fax +39 051 6647859 · Mail: info@novalux.it · VAT number 00536541204 · novalux.com
Company subject to the management and coordination by SLV GmbH

This technical data sheet is owned by Novalux S.r.l., all rights reserved. Novalux S.r.l. reserves the right to make changes without prior notice.