

THIS COPY IS PROVIDED ON A RESTRICTED BASIS AND IS NOT TO BE USED IN ANY WAY DETRIMENTAL TO THE INTERESTS OF PANDUIT CORP.

2X RIGHT HAND  
HINGES FOR  
CABINET

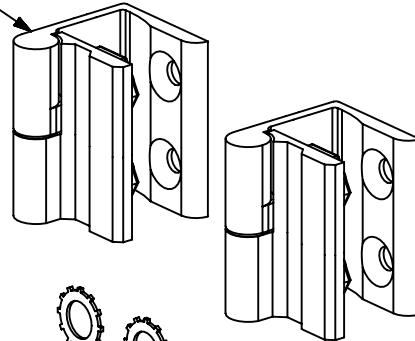

4X M10 LOCK  
WASHER

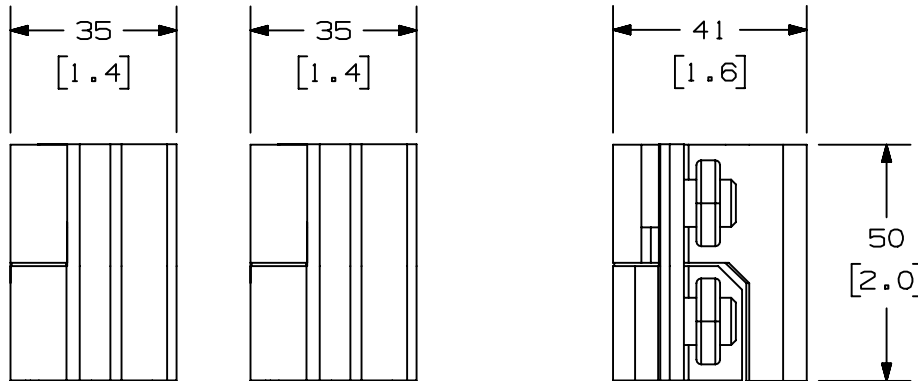
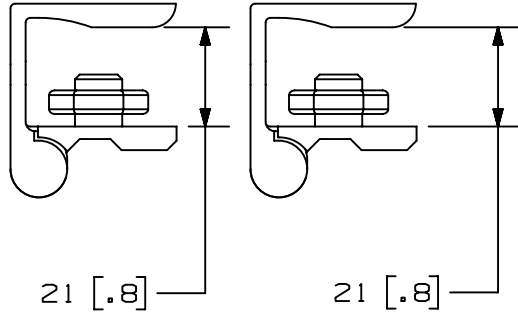
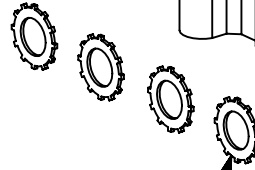

NOTES:

1. VISIT OUR ON-LINE CATALOG AT [WWW.PANDUIT.COM](http://WWW.PANDUIT.COM) FOR A LIST OF CURRENT PARTS APPLICABLE FOR USE WITH THIS PRODUCT.
2. PRIMARY DIMENSIONS ARE IN MILLIMETERS.
3. PARTS SUPPLIED:  
 (2) RIGHT HAND HINGE SETS FOR CABINET/DOOR  
 (4) M10 LOCK WASHER  
 (1) INSTALLATION INSTRUCTIONS (NOT SHOWN)

PANDUIT PART NO.	WEIGHT
XG-DHNGRH	0.5 kg/EACH 1.1 LBS/EACH

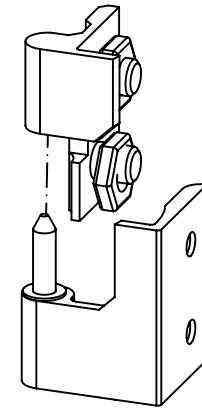

EXPLODED VIEW

TITLE		FLEXFUSION SINGLE HINGE DOOR RIGHT-HAND HINGE KIT (XG-DHNGRH)			
		CUSTOMER DRAWING			
ITEM REVISION NAME		00461EZD/00		<b>PANDUIT</b>	
DATASET FILE NAME		00461EZD_DC/00A			
				MATERIAL:	
				N/A	
				DRAWING NUMBER:	
				00461EZD_DC	
				THIRD ANGLE PROJECTION	
DRAWN BY		DATE		CHK	
MEX-JAGC		3/31/21		MCIS	
				SCALE	
				NONE	
				DRAWING NUMBER:	
				SHT 1 OF 1	
				SIZE	
				A	

00A	3/31/21	MEX-JAGC	MCIS	ELE	DRAWING RELEASE	V09002MN/00
REV	DATE	BY	CHK	APR	DESCRIPTION	ECN

GLOBAL-ASIZE