

## Plugs and receptacles for industrial use: 16 A 3/4/5-pole up to 415 V



Plug



Coupler



Flange socket



Wall socket

### Technical data

#### Plugs and receptacles - industrial use acc. to IEC 60309-1/2 up to 690 V

Permissible ambient temperature	-20 °C to +40 °C / -45 °C to +55 °C (optional) <sup>1)</sup>
Rated voltage	415 V (3-pole) / 690 V (4-/5-pole)
Rated current	16 A
Frequency	50/60 Hz
External back-up fuse, max.	without therm. protection: 16 A
Protection class	I
Degree of protection accd. to EN 60529	IP66

#### Wall socket with interlock switch

Rated making / Rated breaking capacity AC-3 accd. EN 60947-3 for wall socket with switch	$U_e$ 500 V / $I_e$ 20 A
Cable entry	1 x M25 cable gland, 1 x M25 thread plug plastic
Connecting terminals	2 x 1.5 – 4 mm <sup>2</sup>
Enclosure material	glass-fibre reinforced polyester

#### Wall socket without switch

Cable entry	2 x M25 top, 2 x M25 bottom
Connecting terminals	2 x 1.5 – 4 mm <sup>2</sup>
Enclosure material	Polyamide

#### Plug

Cable entry	Ø 8 - 19 mm (3-pole) / Ø 8 - 21 mm (4-pole) / 12 - 21 mm (5-pole)
Connecting terminals	1 x 1.0 – 2.5 mm <sup>2</sup>
Enclosure material	Polyamide

#### Coupler

Cable entry	Ø 8 - 19 mm (3-pole) / Ø 8 - 21 mm (4-pole) / 12 - 21 mm (5-pole)
Connecting terminals	2 x 1.5 – 4 mm <sup>2</sup>
Enclosure material	Polyamide

#### Flange socket/inlet

Connecting terminals	2 x 1.5 – 4 mm <sup>2</sup>
Enclosure material	Polyamide

<sup>1)</sup> extended temperature range on request

Details for used cable glands see pages 2.3.ff

## Plugs and receptacles for industrial use: 16 A 3/4/5-pole up to 415 V

1



Wall socket w. interlock switch



Inlet









Coupler

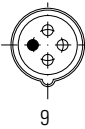
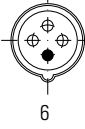

Plug

### Ordering details

Voltage	h	Type	Weight approx.	Order No.
<b>Type 16 A 3-pole</b>				
110-130 V		Wall socket	0.8 kg	<b>GHG 521 2304 R0001</b>
		Plug	0.32 kg	<b>GHG 521 7304 R0001</b>
		Coupler	0.5 kg	<b>GHG 521 3304 R0001</b>
		Flange socket	0.37 kg	<b>GHG 521 8304 R0001</b>
		Inlet	0.26 kg	<b>GHG 521 9304 R0001</b>
200-250 V		Wall socket	0.8 kg	<b>GHG 521 2306 R0001</b>
		Plug	0.32 kg	<b>GHG 521 7306 R0001</b>
		Coupler	0.5 kg	<b>GHG 521 3306 R0001</b>
		Flange socket	0.37 kg	<b>GHG 521 8306 R0001</b>
		Inlet	0.26 kg	<b>GHG 521 9306 R0001</b>
<b>Type 16 A 4-pole</b>				
200-250 V		Wall socket	0.85 kg	<b>GHG 521 2409 R0001</b>
		Wall socket with interlock switch	1.60 kg	<b>GHG 521 4409 R0001</b>
		Plug	0.39 kg	<b>GHG 521 7409 R0001</b>
		Coupler	0.65 kg	<b>GHG 521 3409 R0001</b>
		Flange socket	0.42 kg	<b>GHG 521 8409 R0001</b>
380-415 V		Inlet	0.31 kg	<b>GHG 521 9409 R0001</b>
		Wall socket	0.85 kg	<b>GHG 521 2406 R0001</b>
		Wall socket with interlock switch	1.60 kg	<b>GHG 521 4406 R0001</b>
		Plug	0.39 kg	<b>GHG 521 7406 R0001</b>
		Coupler	0.65 kg	<b>GHG 521 3406 R0001</b>
480-500 V		Flange socket	0.42 kg	<b>GHG 521 8406 R0001</b>
		Inlet	0.31 kg	<b>GHG 521 9406 R0001</b>
		Wall socket	0.85 kg	<b>GHG 521 2407 R0001</b>
		Wall socket with interlock switch	1.60 kg	<b>GHG 521 4407 R0001</b>
		Plug	0.39 kg	<b>GHG 521 7407 R0001</b>
600-690 V		Coupler	0.65 kg	<b>GHG 521 3407 R0001</b>
		Flange socket	0.42 kg	<b>GHG 521 8407 R0001</b>
		Inlet	0.31 kg	<b>GHG 521 9407 R0001</b>
		Wall socket	0.85 kg	<b>GHG 521 2405 R0001</b>
		Wall socket with interlock switch	1.60 kg	<b>GHG 521 4405 R0001</b>
<b>Type 16 A 5-pole</b>		Plug	0.39 kg	<b>GHG 521 7405 R0001</b>
		Coupler	0.65 kg	<b>GHG 521 3405 R0001</b>
		Flange socket	0.42 kg	<b>GHG 521 8405 R0001</b>
		Inlet	0.31 kg	<b>GHG 521 9405 R0001</b>
		Wall socket	0.90 kg	<b>GHG 521 2506 R0001</b>
380-415 V		Wall socket with interlock switch	1.65 kg	<b>GHG 521 4506 R0001</b>
		Plug	0.42 kg	<b>GHG 521 7506 R0001</b>
		Coupler	0.75 kg	<b>GHG 521 3506 R0001</b>
		Flange socket	0.47 kg	<b>GHG 521 8506 R0001</b>
		Inlet	0.34 kg	<b>GHG 521 9506 R0001</b>

Other voltage ranges and versions available on request

Plugs and receptacles for industrial use: 16 A 3/4/5-pole up to 415 V



Plug

Coupler

Flange socket

Wall socket w. switch 5-pole

Dimension drawing | Wiring diagram

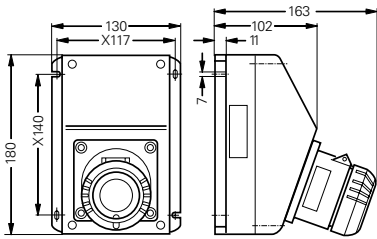

Wall socket without switch 3, 4, 5-pole

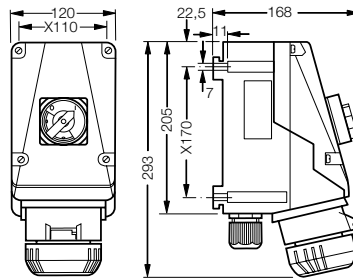

Wall socket 4-pole with switch

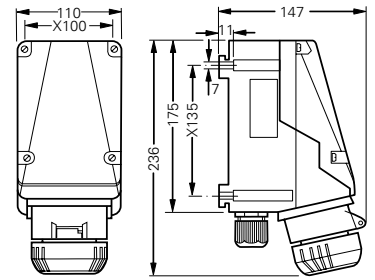

Wall socket 5-pole with switch

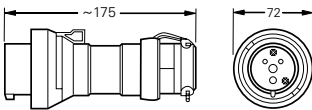

Plug 3-pole

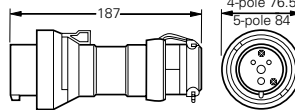

Plug 4/5-pole

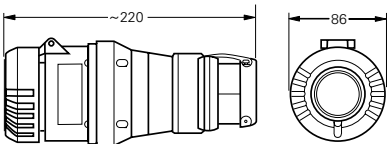

Coupler 3-pole

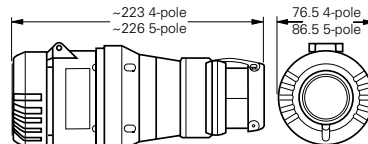

Coupler 4/5-pole

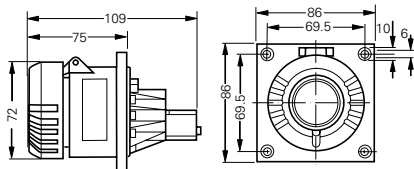

Flange socket 3-pole

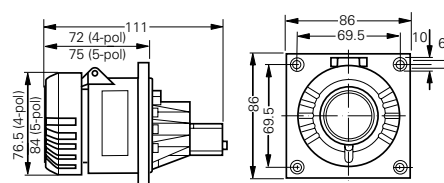

Flange socket 4/5-pole

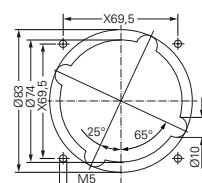

Assembly dimensions flange socket 5 pole

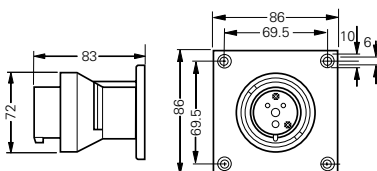

Inlet 3-pole

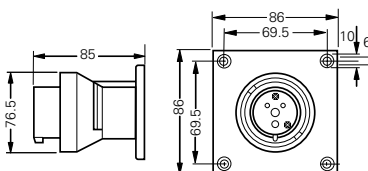

Inlet 4/5-pole

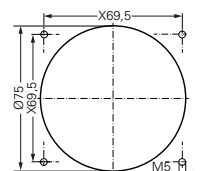

Assembly dimensions inlet 5 pole

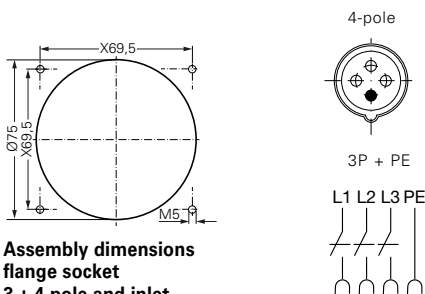

Assembly dimensions flange socket 3 + 4 pole and inlet

without aux. contact

3P + N + PE

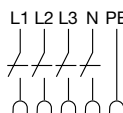

5-pole

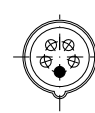

X = fixing dimensions

## Accessories plugs and receptacles 16 A for industrial use



Mounting plate



Plug cap



Protective canopy

### Accessories

Type	Application	Fixing method	Order No.
<b>Mounting plates for wall sockets 16 A</b>			
Size 4	for wall mounting	snap on	<b>GHG 610 1953 R0126</b>
Size 4	for trellis mounting	snap on	<b>GHG 610 1953 R0126</b>
Size 4	for pipe clamp	snap on	<b>GHG 610 1953 R0130</b>

Type	Order No.
<b>Plug cap for plugs 16 A</b>	
Plug 16 A 3-pole	<b>GHG 510 1901 R0001</b>
Plug 16 A 4-pole	<b>GHG 510 1901 R0002</b>
Plug 16 A 5-pole	<b>GHG 510 1901 R0003</b>

Type	OU	Order No.
<b>Accessories for mounting plates</b>		
Mounting set for pipes 1" (Ø 27 - 30 mm) for mounting plates with pipe fixing	10	<b>GHG 610 1953 R0020</b>

Please pay attention that only order units (OU) according to the ordering details can be delivered.

Type	Application	Order No.
<b>Protective canopy for mounting plate</b>		
Size 4	for mounting plate size 4, snap on	<b>GHG 610 1955 R0107</b>

### Dimension drawing

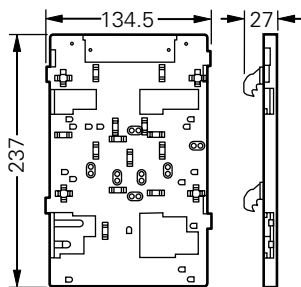

Mounting plate size 4  
for wall/trellis mounting

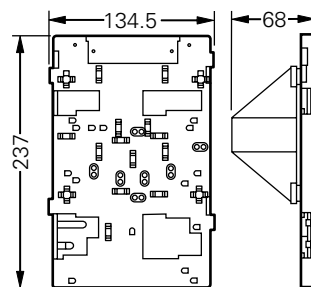

Mounting plate size 4  
for pipe mounting

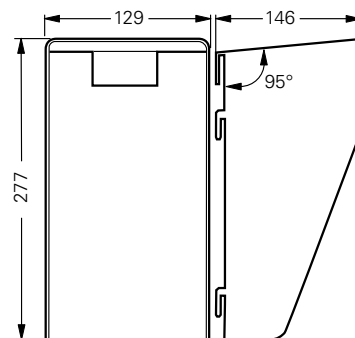

Protective canopy size 4

Dimensions in mm