

THIS COPY IS PROVIDED ON A RESTRICTED BASIS AND IS NOT TO BE USED IN ANY WAY DETRIMENTAL TO THE INTERESTS OF PANDUIT CORP.

NOTES:

1. VISIT OUR ON-LINE CATALOG AT WWW.PANDUIT.COM FOR A LIST OF CURRENT PARTS APPLICABLE USE WITH THIS PRODUCT.
2. ALL CATEGORY 6A, RJ45, 10GB/S, 8-POSITION, 8-WIRE SHIELDED KEYSTONE JACK MODULES ARE UNIVERSAL IN DESIGN. THEY ACCEPT EIGHT POSITION MODULAR PLUGS WITHOUT DAMAGE.
3. TERMINATES 22-24 AWG SOLID OR STRANDED SHIELDED AND UN-SHIELDED CABLE IN A HORIZONTAL MANNER.
4. SEE INSTALLATION INSTRUCTIONS FOR PROPER TERMINATION METHOD.
5. CAP (TERMINATION BLOCK) IS CODED FOR T568A AND T568B WIRING MAPPING SCHEMES.
6. PART INCLUDES:
 - A. MODULE HOUSING: DIECAST/PLATED, INTERNAL COMPONENTS MADE FROM VARIOUS MATERIALS.
 - B. CAP (TERMINATION BLOCK): PLASTIC /WHITE IN COLOR W/ PAD PRINTED WIRE MAPPING SCHEMES.
 - C. CABLE TIE: PLASTIC/NYLON/RAW COLOR (NOT SHOWN IN DRAWING FIGURES).
 - D. COPPER FOIL TAPE: COPPER
7. WEIGHT: 6.67 LBS/100 PCS [3027 grams/100 PCS]
8. DIMENSIONS IN [] ARE METRIC.
9. ALL MATERIALS AND COMPONENTS USED MEET THE MATERIALS RESTRICTIONS OF RoHS (EUROPEAN DIRECTIVE 2011/65/EU ON THE RESTRICTION OF HAZARDOUS SUBSTANCES) AS PROPOSED BY THE RoHS TECHNICAL ADAPATION COMMITTEE.
10. COLOR OF JACK MODULE IS INDICATED BY ** IN THE PART NUMBER (EXAMPLE: KJS6X88TCBU FOR BLUE JACK). NOTE: FOR BASE MODEL WITH NO COLOR LEAVE THE ** BLANK (EXAMPLE: KJS6X88TC) SEE WWW.PANDUIT.COM FOR AVAILABLE COLORS.

RETENTION CAP

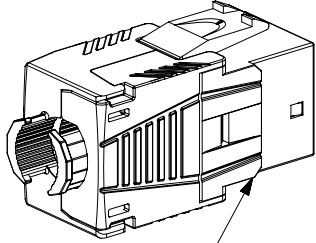
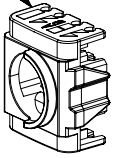

MODULE HOUSING

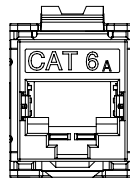
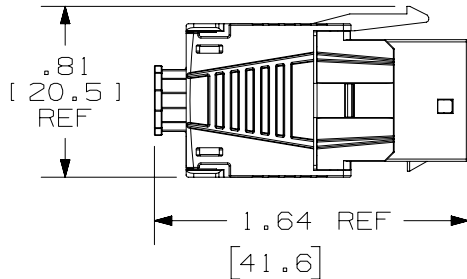
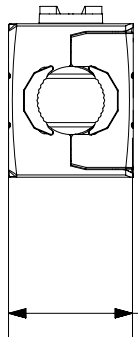

.65 [16.5] REF

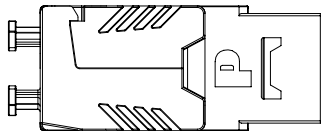

PANDUIT PART NUMBER	
KJS6X88TC	KJS6X88TC**
BASE MODEL	COLOR FACE
** DESIGNATES COLOR OF JACK FACE FOUND AT WWW.PANDUIT.COM	

SEE NOTE 10

PART NUMBER		SEE TABLE	
TITLE			
CATEGORY 6A RJ45 10GB/S 8-POSITION 8-WIRE SHIELDED KEYSTONE JACK MODULE (CABLE RANGE 22-24 AWG)			
CUSTOMER DRAWING			
ITEM REVISION NAME		00326EAA/02	
DATASET FILE NAME		00326EAA_DC/02B	
MATERIAL		SEE NOTE 6	
DRAWN BY		BJN	
DATE		09-14-18	
CHK		DCS	
SCALE		FULL	
DRAWING NUMBER		00326EAA-DC	
SHEET 1 OF 1		A	

02B	11-19-20	BJN	VJV	SKH	UPDATED	0326EAA-DC
REV	DATE	BY	CHK	APR	DESCRIPTION	ECN

A-SIZE CUSTOMER