

THIS COPY IS PROVIDED ON A RESTRICTED BASIS AND IS NOT TO BE USED IN ANY WAY DETRIMENTAL TO THE INTERESTS OF PANDUIT CORP.

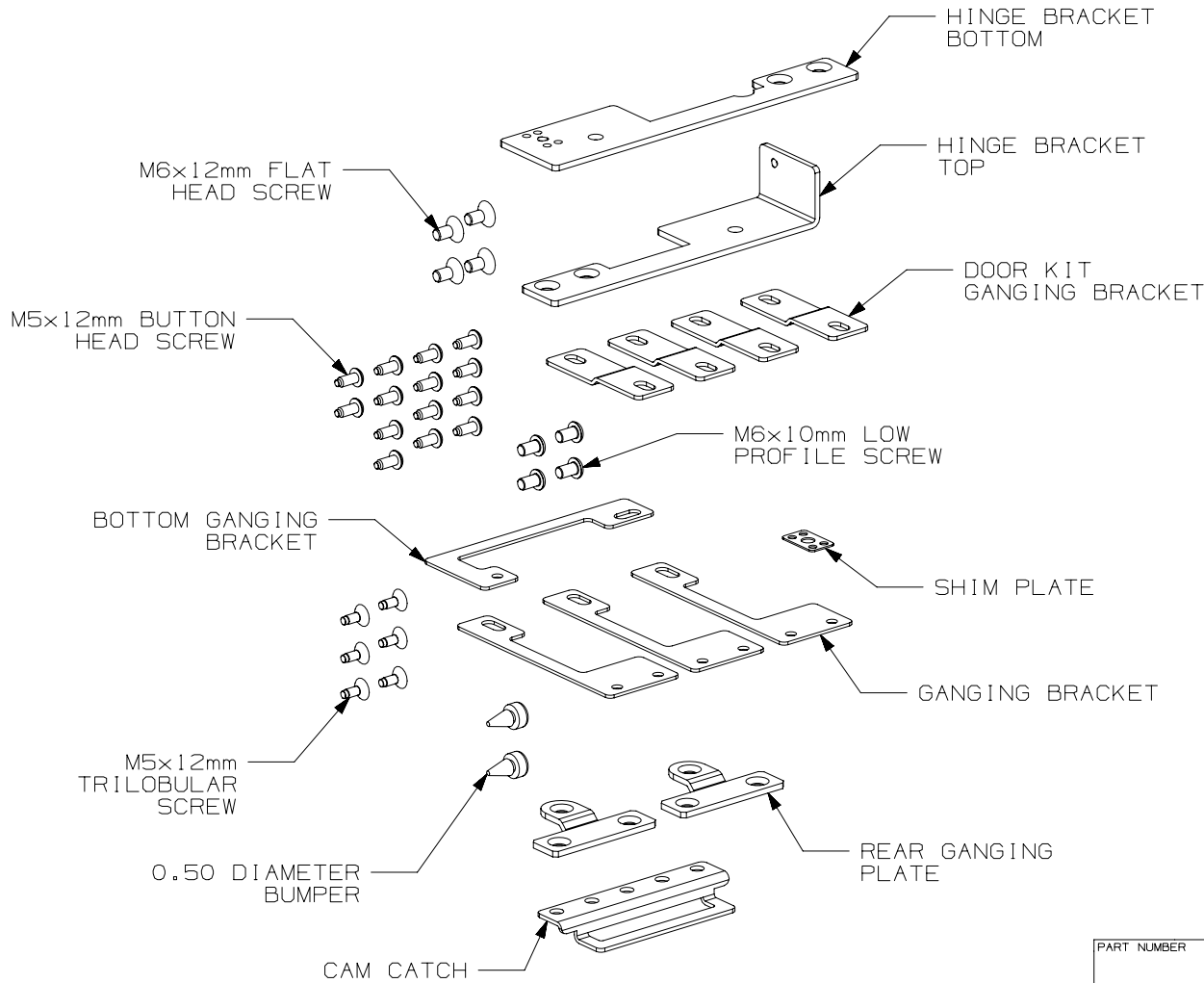

NOTES:

1. VISIT OUR ON-LINE CATALOG AT WWW.PANDUIT.COM FOR A LIST OF CURRENT PARTS APPLICABLE FOR USE WITH THIS PRODUCT.
2. DIMENSIONS IN () ARE IN MILLIMETERS.
3. PARTS SUPPLIED:
 - (1) HINGE BRACKET BOTTOM
 - (1) HINGE BRACKET TOP
 - (1) BOTTOM GANGING BRACKET
 - (1) SHIM PLATE
 - (3) GANGING BRACKET
 - (2) REAR GANGING PLATE
 - (1) CAM CATCH
 - (4) DOOR KIT GANGING BRACKET
 - (4) M6x12mm FLAT HEAD SCREW
 - (14) M5x12mm BUTTON HEAD SCREW
 - (4) M6x10mm LOW PROFILE SCREW
 - (6) M5x12mm TRILOBULAR SCREW
 - (2) 0.50 DIAMETER BUMPER
 - (1) INSTALLATION INSTRUCTIONS (NOT SHOWN)

PANDUIT PART NO.	WEIGHT
XG-STDRKIT*	0.77 kg/EACH 1.70 LBS/EACH

* DENOTES COLOR
ADD SUFFIX "B" FOR BLACK AND
"W" FOR WHITE.

PART NUMBER		XG-STDRKIT*	
TITLE			
FLEXFUSION™ S-TYPE DOOR KIT		CUSTOMER DRAWING	
ITEM REVISION NAME		01170EAA/00	
DATASET FILE NAME		01170EAA_DC/00A	
		THIRD ANGLE PROJECTION	
MATERIAL		N/A	
DRAWING NUMBER		01170EAA-DC	
DRAWN BY	DATE	CHK	SCALE
MEX-JAGC	7/18/22	TKW	NONE
SHEET 1 OF 1		A	

00A	7/18/22	MEX-JAGC	TKW	ELE	DRAWING RELEASE	V09002RU/00
REV	DATE	BY	CHK	APR	DESCRIPTION	ECN

B

A

A-SIZE CUSTOMER

2

1

2

1