

MX SERIES

COOL LOOK, COOL COMFORT



NRR
30
dB

6130 MX-6



NRR
27
dB

6120 MX-5



NRR
28
dB

**6140 MX-7
CAP MOUNTED**

MX-5, MX-6, AND MX-7 PREMIUM EARMUFFS

The MX-5, MX-6 and MX-7 are a cool and comfortable upgrade in earmuffs. The larger cup openings are designed to fit most ear sizes. Exclusive waffled cup foam delivers superior protection in MX-6 and MX-7. The cushion-ribbed headband allows cool comfort all day long and the non-slip wire makes adjustments easy. The MX series are easy to wear and durable, have a sharp, cool look and increase compliance.

- Cushion-ribbed open air headband for cool comfort all day long.
- Overmolded headband is soft yet durable for easy wearing over many shifts.
- Larger ear cushions allow freedom to fit almost all ears comfortably.
- Lightweight wire frame allows easy cup adjustment yet holds its position for lasting comfort.
- Cool looks and comfort to promote worker acceptance and compliance.
- Extra soft foam/low pressure cushions and headband are PVC-Free.
- Glossy surface for easy cleaning and longer wear.
- Independently tested NRR for protection you can count on.
- MX-6 and MX-7 feature exclusive waffled cup foam for superior NRR protection.

WARNING:

1. Use this laboratory derived attenuation data for comparison purposes only. The amount of protection afforded in field use often is significantly lower depending upon how the protectors are fitted and worn.
2. Failure to follow all instructions could result in hearing loss or injury.
3. Failure to obtain a proper fit will reduce effectiveness of hearing protectors and could result in hearing loss or injury.
4. Over protection can be dangerous. The wearer must be able to hear warning signals.
5. Wearers with hearing loss should exercise extreme caution.
6. It is the employer's responsibility to ensure that the type of hearing protector and its NRR rating is appropriate for the user in their particular workplace.
7. Failure to follow these warnings could result in serious injury or death.
8. Moldex earmuffs must only be used as part of a hearing conservation program that complies with applicable local safety and health regulations.

INFORMATION REQUIRED BY EPA:

"The level of noise entering a person's ear, when a hearing protector is worn as directed, is closely approximated by the difference between the A-weighted environmental noise level and the NRR."

EXAMPLE:

- 1) The environmental noise level as measured at the ear is 92 dBA.
- 2) The NRR is 33 decibels (dB).
- 3) The level of noise entering the ear is approximately equal to [92 dB(A) - 33] 59dB(A)."

CAUTION:

"For noise environments dominated by frequencies below 500 Hz the C-weighted environmental noise level should be used. Improper fit of this device will reduce its effectiveness in attenuating noise. Consult the enclosed instructions for proper fit. Although hearing protectors can be recommended for protection against the harmful effects of impulsive noise, the Noise Reduction Rating (NRR) is based on the attenuation of continuous noise and may not be an accurate indicator of the protection attainable against impulsive noise such as gunfire."

MX-5/MX-6 SERIES INSTRUCTIONS FOR USE:

Earmuffs must be fitted and worn correctly to provide effective protection. Earmuffs and their cushions may deteriorate with use and should be examined for cracking or other deformations and replaced as necessary. Routinely wash with mild soap and water. The foam liner should be allowed to air dry before reinserting into the earcups.

- 1) With headband over-the-head, pull the cups outward and position over your ears so that they fully enclose the ear and seal tightly against the head.
- 2) Adjust the height of the cups until you have a tight and comfortable fit. For best results, remove all hair from under the cushions.
- 3) Maintenance: Replace cushions and foam inserts at least twice a year for hygiene and safety. For MX-5 order Part No. 6125 and for MX-6 order Part No. 6135. For MX-6 only: Place the glossy side of the foam against the cup.

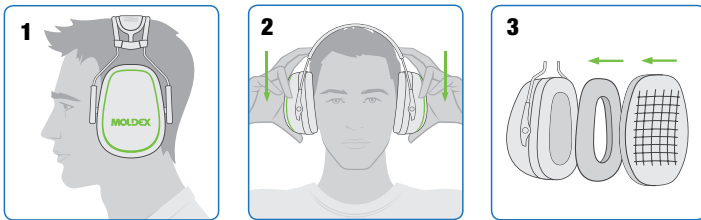
**Ordering Information**

Model	Part #	Display Qty.	Case Qty.
MX-5 Earmuff	6120	1/Box	10 Boxes
MX-6 Earmuff	6130	1/Box	10 Boxes
MX-7 Cap Mounted Earmuff	6140	1/Box	10 Boxes
MX-5 Hygiene Kit	6125	1/Pair/Bag	20 Bags
MX-6/MX-7 Hygiene Kit	6135	1/Pair/Bag	20 Bags

MOLDEX[®]
Ideas that wear well.™

MOLDEX-METRIC, INC.

Moldex-Metric, Inc.
10111 West Jefferson Blvd., Culver City, CA 90232
TEL: +1 (800) 421-0668 or +1 (310) 837-6500
FAX: +1 (310) 837-9563
E-mail: sales@moldex.com www.moldex.com

MOLDEX TECHNICAL SERVICE DEPARTMENT:

+1 (800) 421-0668 or
+1 (310) 837-6500 ext. 512/550
E-mail: tech@moldex.com

6120-709 REV B 11/16

MX-5 EARMUFFS**ATTENUATION DATA / DATOS DE ATENUACIÓN / DONNÉES D'ATTÉNUATION**

Tested According to ANSI Specs S3.19-1974 Michael & Assoc., State College, PA.

Frequency (Hz)	125	250	500	1000	2000	3150	4000	6300	8000		
Mean Attenuation (dB)	20.6	23.6	32.3	39.9	40.2	36.8	36.7	37.1	36.8	NRR 27	CSA AL
Standard Deviation (dB)	3.2	2.3	3.3	3.1	2.6	2.9	3.1	3.2	3.6		

MX-6 EARMUFFS**ATTENUATION DATA / DATOS DE ATENUACIÓN / DONNÉES D'ATTÉNUATION**

Tested According to ANSI Specs S3.19-1974 Michael & Assoc., State College, PA.

Frequency (Hz)	125	250	500	1000	2000	3150	4000	6300	8000		
Mean Attenuation (dB)	21.8	25.6	33.5	37.7	40.7	42.6	43.6	44.6	43.2	NRR 30	CSA AL
Standard Deviation (dB)	2.5	1.6	2.0	3.1	2.8	3.7	2.8	3.2	3.3		

MX-7 CAP MOUNTED EARMUFFS**ATTENUATION DATA / DATOS DE ATENUACIÓN / DONNÉES D'ATTÉNUATION**

Tested According to ANSI Specs S3.19-1974 Michael & Assoc., State College, PA.

Frequency (Hz)	125	250	500	1000	2000	3150	4000	6300	8000		
Mean Attenuation (dB)	22.0	24.7	33.2	38.5	36.8	40.2	42.9	41.2	39.4	NRR 28	CSA AL
Standard Deviation (dB)	2.4	1.9	2.8	2.9	3.3	3.5	2.9	3.5	3.9		

MX-7 SERIES INSTRUCTIONS FOR USE:

Cap Mounted Earmuffs must be fitted and worn correctly to provide effective protection. Earmuffs and their cushions may deteriorate with use and should be examined for cracking or other deformations and replaced as necessary. Routinely wash with mild soap and water. The foam liner should be allowed to air dry before reinserting into the earcups.

- 1) Position top of cup below helmet. Helmet must rest level on head with brim straight forward and be fitted correctly, per manufacturer's instructions.
- 2) Press arm to snap against side of head. An audible click will be heard.
- 3) Adjust position of each cup on wire so both ears are completely and comfortably sealed inside cup cushions. Cup must be sealed around the ear, without any interference from any part of the helmet. If any part of the helmet, including the suspension, contacts the cup or cushion, then readjust. If cup cannot be adjusted to avoid contact with helmet, then hearing protection will be reduced and muffs must not be worn.
- 4) For maximum hearing protection, there must be no interference between the cup cushion sealing surface and wearer's head. Pull hair back outside the cushion sealing area and remove anything that interferes with the cushion seal. Any interference with sealing area (e.g. eyewear, respirator straps, etc.) will significantly reduce hearing protection. To minimize this, use the thinnest temples straps.
- 5) Do not bend or reshape the wires.
- 6) To remove, pull cup out until an audible click is heard.
- 7) Maintenance: Replace cushions and foam inserts at least twice a year for hygiene and safety. MX-7 order Part No. 6140. Place the glossy side of the foam against the cup.

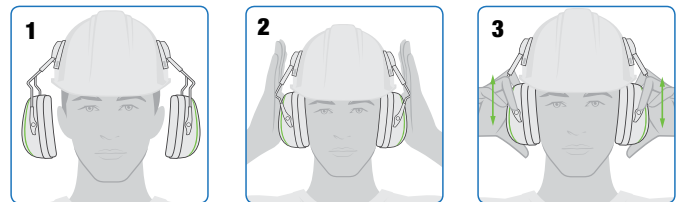

Printed on Recycled Paper