

Lot No. 9.

Lot No. 11.

Phillips B. Simpson.

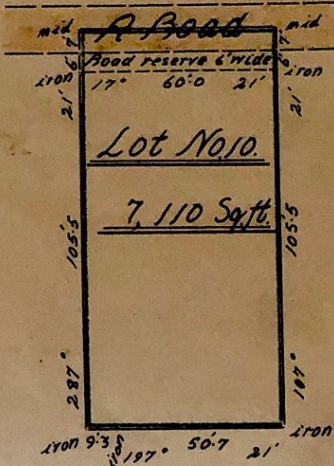

BARBADOS
PLAN OF

Land Situate in the
Parish of Christ Church

CONTAINING

<u>Land</u>	6,690	Sq.ft
<u>Road</u>	420	Sq.ft
<u>Total</u>	<u>7,110</u>	<u>Sq.ft.</u>

the property of

Scale:— 1/500

Certified 8th July 1899

Richard B. Simpson
Land Surveyor