

THE LOUNGE CO

Assembly Instructions

MODULAR LINKING UNITS

Please follow the instructions carefully · We recommend two people manoeuvre a sofa

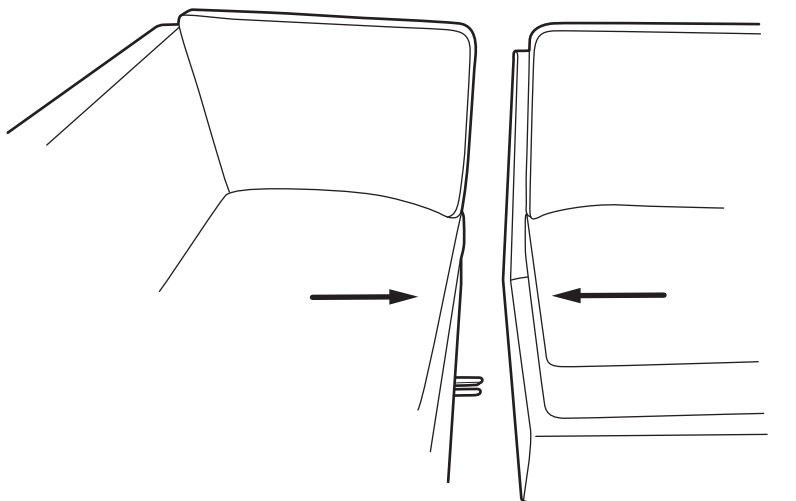

CONNECTING

The main bracket swivels for transit, so rotate the bracket out. Position the units so the lug on the small bracket lines up with the jaws of the large bracket. Push the units together firmly, ensuring the lug engages with the jaws.

DISCONNECTING

Simply lift up the unit with the small lug bracket, this will pull the lug up through the jaws and uncouple the units. For transporting, fold the large bracket back under the unit.

VIEW FROM THE UNDERSIDE

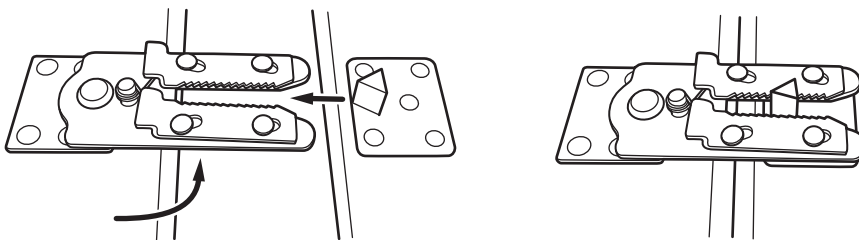

BD061 - 04/16