

ACQUAPURA

TECHNICAL MANUAL



Multifunctional shower panel FREESTANDING

with towel rails pag. 18

with mirror pag. 19

Multifunctional shower panel SEMI-RECESS pag. 21

Technical information

ACQUAPURA FREESTANDING shower panel available with a THERMOSTATIC mixer consists of the following:

A) IN-WALL UNIT including a metal frame

NOTE: Please note that the in-wall unit must be installed at flooring stage.

B) EXTERNAL UNIT including:

a front panel equipped with:

- 504 front jets grouped in 4 sectors which can be activated separately
- waterfall chromed brass shower head 15" wide
- handshower with 49" Vinyl hose
- 3/4" thermostatic mixer
- volume control stop valve with magnetic sensor for water shutoff
- two 3/4" connecting flexibles (hot and cold)
- two filters fitted upstream of the electrovalves
- perimetral led lights to be activated by a remote control button
- six backlit push buttons to activate the different functions:
- blue LED: waterfall function
- white LED: handshower function
- green LED: front jets (x4)

back panel available in two options:

- #6511U with two towel bars (one 15 3/4" long and the other 23" 5/8 long)
- #6516U with a mirror (84 5/8" x 27 1/2")

TECHNICAL DATA

- front jets flow rate at 45 PSI hydraulic pressure: 6-7 GPM
- waterfall showerhead flow rate at 45 PSI hydraulic pressure: 6-7 GPM
- minimum hydraulic pressure: 36 PSI
- maximum hydraulic pressure: 72 PSI
- recommended hydraulic pressure: 45 PSI
- weight: - built-in piece 40 Lbs
- external piece 212 Lbs
- room temperature : 32 F-122 F
- umidity: up to 100%

Guidelines for the set-up

3/4" Connections to the water pipeline are necessary to feed the shower panel.

A hydraulic pressure of 45 PSI by a ow rate of 6-7 GPM is recommended if using all 4 front sectors at the same time.

Recommended boiler: minimum 100 gallons.

Recommended water drain for the shower tray: 2.7 GPM drain flow, drain piping DN 70

- max hot water temperature: 140°F
- max pressure difference between hot and cold water: 22.5 PSI

Electrical features**Voltage:**

- Primary voltage: 110 VAC
- Frequency: 50-60 Hz
- Power: max: 90W
- IPX5 protection class (protection against water ensured)

Protection:

- Thermically selfprotected transformer on primary
- Microfuse on T 1,6 A circuit board 250 V (can not be replaced by end user)

Supply cable:

- Three-pole cable: blue + brown + yellow-green type H05VV-F
- Max diameter of the cable sheath: 5/16"
- Minimum section of the supply cable wires : 0.0016 in²
- Thread diameter for insertion on terminal: < 3/32"

Perimetral Led Lamps:

- Tension: from 10Vdc to 12Vdc
- Electric current: 6 channels of 0.7 A
- Power: max 54W
- The main features of this Led system are long durability and low energy consumption.

REGULATIONS:

- CSA 22.2

Base materials:

- Brass
- AD Cement

Multifunctional free-standing shower panel with waterfall showerhead and towel bars

Art. 651102U

Trim

Front panel equipped with:

- 504 front jets grouped in 4 sectors which can be activated separately
- Waterfall chromed brass showerhead 15 7/8"
- Cylindrical handshower with 49" Vinyl hose
- 3/4" Thermostatic mixer
- Upper led lights to be activated by a remote control button
- Backlit push buttons to activate the different functions (waterfall, handshower, 4 sectors of front body sprays which can be activated separately)

Back panel with:

- 2 chromed brass towel rails (one 15" 3/4 long and the other 23" 5/8 long)
- 2 side profiles

ACQUAPURA does not meet any US and CAN product approvals, building or plumbing codes.

Cement

74 AD 651102U

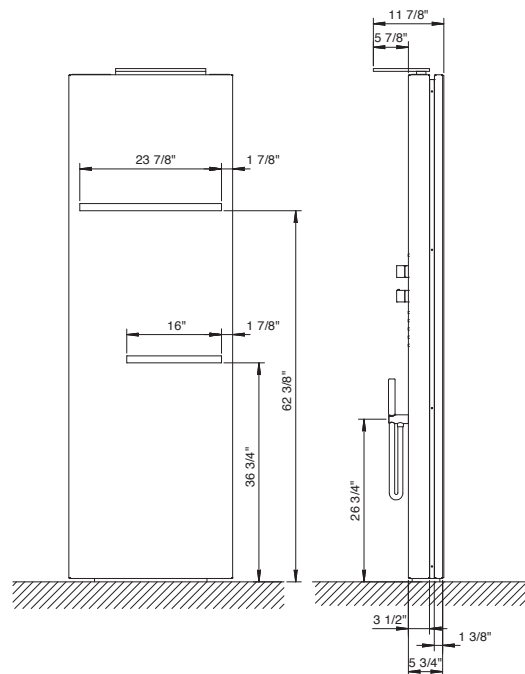

Art. 6580U

Rough

- anticorrosion metal base

74 00 6580

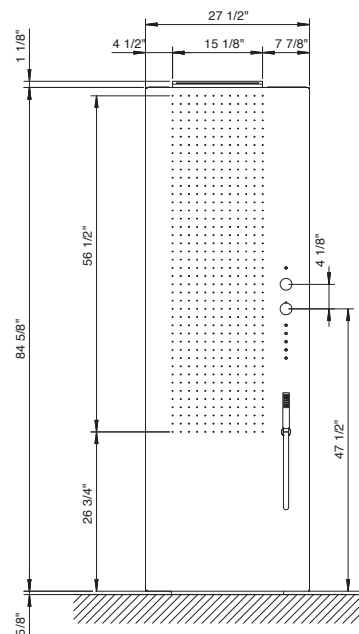

TOTAL PRICE

Cement

Multifunctional free-standing shower panel with waterfall showerhead and mirror

Art. 651602U

Trim

Front panel equipped with:

- 504 front jets grouped in 4 sectors which can be activated separately
- Waterfall chromed brass showerhead 15 7/8"
- Cylindrical handshower with 49" Vinyl hose
- 3/4" Thermostatic mixer
- Upper led lights to be activated by a remote control button
- Backlit push buttons to activate the different functions (waterfall, handshower, 4 sectors of front body sprays which can be activated separately)
- 2 upper led lights to be activated by a remote control button

Back panel with:

- 84 5/8" x 27 1/2" mirror and 2 cover side profiles

ACQUAPURA does not meet any US and CAN product approvals, building or plumbing codes.

Cement

74 AD 651602U

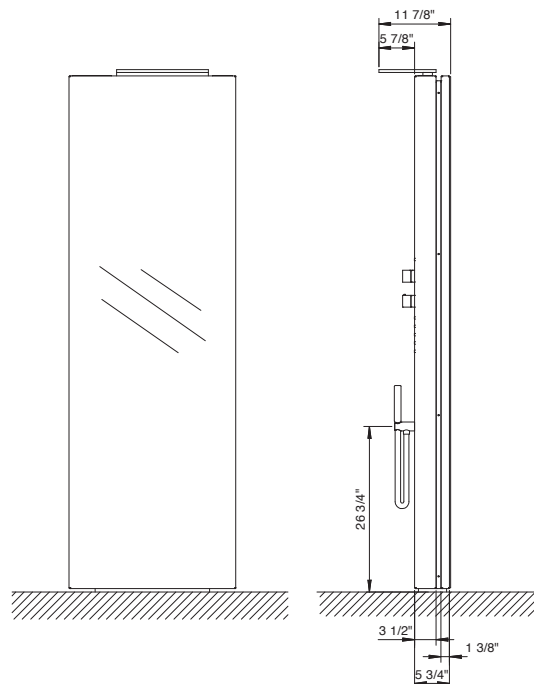

Art. 6580U

Rough

- anticorrosion metal base

74 00 6580

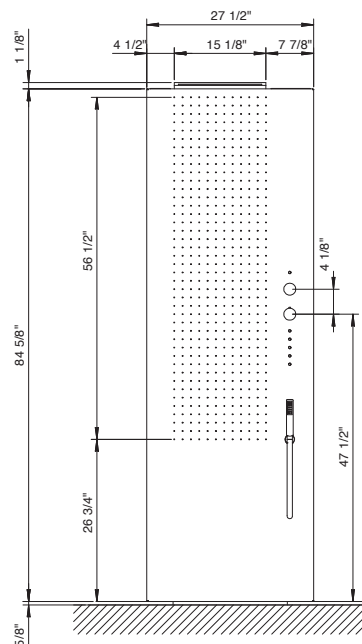

TOTAL PRICE

Cement

Technical information

ACQUAPURA SEMI-RECESS shower panel available with a THERMOSTATIC mixer consists of the following:

A) IN-WALL UNIT including an anti-corrosion metal box

NOTE: Please note that the in-wall unit must be installed at framing stage.

B) EXTERNAL PIECE including:

- a finishing frame suitable for any plating

a panel equipped with:

- 378 front jets grouped in 4 sectors which can be activated separately
- backlit PARAPAN waterfall shower head 11" wide
- handshower with 49" Vinyl hose
- 3/4" thermostatic mixer
- volume control stop valve with magnetic sensor for water shutoff
- two 3/4" connecting flexibles (hot and cold)
- filter fitted upstream of the electrovalves
- perimetral led lights to be activated by a remote control button
- six backlit push buttons to activate the different functions:
 - blue LED: waterfall function
 - white LED: handshower function
 - green LED: front jets (x4)

TECHNICAL DATA

- front jets flow rate at 45 PSI hydraulic pressure: 7-8 GPM
- waterfall showerhead flow rate at 45 PSI hydraulic pressure: 6-7 GPM
- minimum hydraulic pressure: 36 PSI
- maximum hydraulic pressure: 72 PSI
- recommended hydraulic pressure: 45 PSI
- weight:
 - built-in piece 53 Lbs
 - external piece 90 Lbs
- voltage: 110 VAC, 50-60 HZ, max power: 75W
- protection class IPX5 (protection against water ensured)
- room temperature : 32 F-122 F
- umidity: up to 100%

Guidelines for the set-up

3/4" Connections to the water pipeline are necessary to feed the shower panel.

A hydraulic pressure of 45 PSI by a ow rate of 6-7 GPM is recommended if using all 4 front sectors at the same time.

Recommended boiler: minimum 100 gallons.

Recommended water drain for the shower tray: 2.7 GPM drain flow, drain piping DN 70

- max hot water temperature: 140°F
- max pressure difference between hot and cold water: 22.5 PSI

Electrical features**Voltage:**

- Primary voltage: 110 VAC
- Frequency: 50-60 Hz
- Power: max: 75W
- IPX5 protection class (protection against water ensured)

Protection:

- Thermically selfprotected transformer on primary
- Microfuse on T 500mA circuit board 250 V (can not be replaced by end user)

Supply cable:

- Three-pole cable: blue + brown + yellow-green type H05VV-F
- Max diameter of the cable sheath: 5/16"
- Minimum section of the supply cable wires : 0.0016 in²
- Thread diameter for insertion on terminal: < 3/32"

Perimetral Led Lamps:

- Tension 12V
- Power max 25W
- The main features of this Led system are long durability and low energy consumption

REGULATIONS:

- CSA 22.2

Base materials:

- Brass
- AA Pearl

Multifunctional semi-recess shower panel with waterfall showerhead

Art. 650102U

Trim

Consisting of the following:

- a finishing frame suitable for any wall finishing

A panel with:

- 378 front jets grouped in 4 sectors
- Waterfall showerhead with backlights
- Cylindrical handshower
- 3/4" Thermostatic mixer
- Backlit push buttons to activate the different functions (waterfall, handshower, 4 front jet sectors which can be activated separately)
- Perimetral LED lights to be activated by a remote control button
- With transformer 230 VAC, 50 HZ, power 70 W

ACQUAPURA does not meet any US and CAN product approvals, building or plumbing codes.

Pearl-Chrome

74 AA 650102U

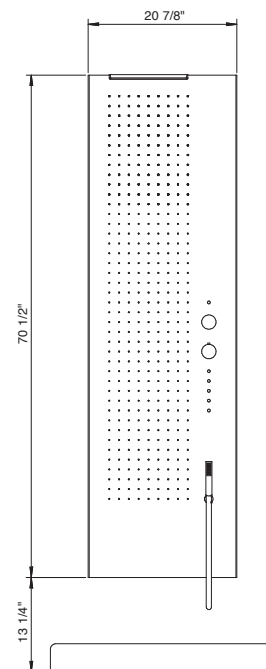
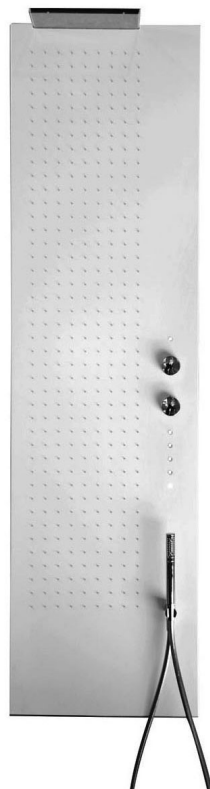

Art. 6590U

Rough

- anti-corrosion metal box

74 00 6590U

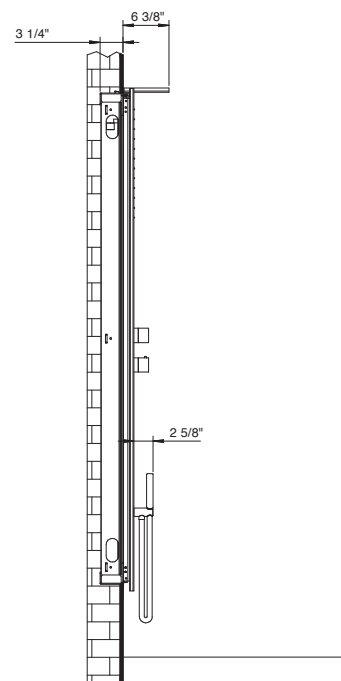

TOTAL PRICE

Pearl-Chrome



Fantini USA Inc.

A&D BUILDING - 150 East 58th Street, 8th floor - New York, NY 10155

Ph. 212 308 8833 - Fax 212 308 8820

www.fantiniusa.com - fantini@fantiniusa.com