

FONTANE BIANCHE

MANUALE TECNICO

SALVATORI +  FANTINI
DAL 1946 RUBINETTI

FONTANE BIANCHE

Design Elisa Ossino



P5 P404B+P404A - P5 P404C

LAVABO	pag.	9
BIDET	pag.	15
DOCCIA	pag.	17
VASCA	pag.	28

Informazioni tecniche

I gruppi e miscelatori FONTANE BIANCHE sono forniti di serie CON MANIGLIA.

I miscelatori lavabo e bidet sono dotati di **aeratori limitati** a 5 l/min.

- VERSIONE CARTUCCIA PROGRESSIVA

Ruotando la maniglia di 180° in senso antiorario si passa da **acqua fredda > acqua miscelata > acqua calda**.

- VERSIONE CARTUCCIA TRADIZIONALE

Sollevando e abbassando la maniglia si **regola la portata dell'acqua**.

Ruotando la maniglia a destra o sinistra si **regola la temperatura**.

FORATURA DEI PIANI SANITARI:

- Miscelatore lavabo 2 fori.

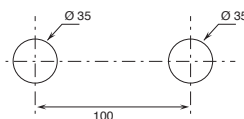

- Gruppo lavabo 3 fori.

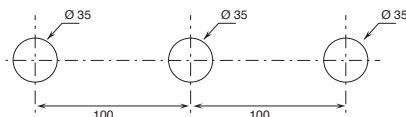

Il miscelatore termostatico doccia incasso 3/4" è disponibile:

- art. **P331B+D331A** - 1 uscita

- art. **P372B+D372A** - 2 uscite

- art. **P373B+D373A** - 3 uscite

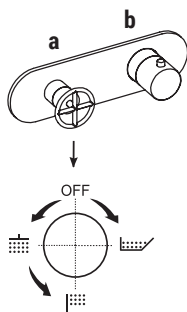

ESEMPIO:

art. P373B+D373A

a) deviatore a rotazione con chiusura - Partendo dalla posizione centrale ruotando verso DX si attiva la 1° uscita, al centro la chiusura, ruotando verso SX si attivano consecutivamente la 2° e la 3° uscita.

b) comando per la regolazione della temperatura.

Materiali di base:

- Ottone

P5 Matt Gun Metal PVD

CARTUCCIA PROGRESSIVA

Miscelatore lavabo da soffitto

_lunghezza bocca 135 cm

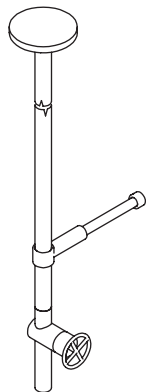

P404B+P404A
SENZA SCARICO

Miscelatore lavabo 2 fori

_interasse bocca 18,2 cm



P107W
SENZA SCARICO

Miscelatore bidet monoforo

_interasse bocca 13,4 cm



P008W
SENZA SCARICO

P008
CON SCARICO

Miscelatore da piano



P495

Bocca lavabo da soffitto

_lunghezza bocca 140 cm

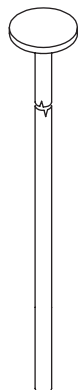

P494

Bocca lavabo da piano

_interasse bocca 18,2 cm



8441

Bocca lavabo da parete

_interasse bocca 15 cm



8442

Bocca lavabo da parete

_interasse bocca 20 cm

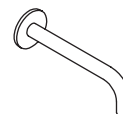

8443

CARTUCCIA TRADIZIONALE

Miscelatore lavabo da parete
_interasse bocca 15 cm



P110B+M011A
SENZA SCARICO

Miscelatore lavabo da parete
_interasse bocca 20 cm



P113B+M011A
SENZA SCARICO

VITONI CERAMICI DA 1/4 DI GIRO

Gruppo lavabo 3 fori
_interasse bocca 18,2 cm



P007W
SENZA SCARICO

P007
CON SCARICO

Gruppo lavabo da parete
_interasse bocca 15 cm

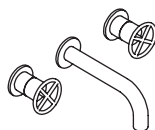

P010B+R010A
SENZA SCARICO

Gruppo lavabo da parete
_interasse bocca 20 cm

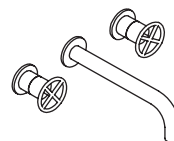

P013B+R010A
SENZA SCARICO

lead \varnothing free**Miscelatore lavabo da soffitto**

- lunghezza bocca 135 cm
- maniglia
- SENZA SCARICO
- limitatore di portata 5 l/min a 3 bar

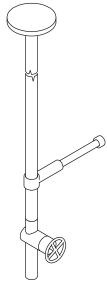
P404B**Parte esterna**

Matt Gun Metal PVD 47 P5 P404B

P404A**Parte da incasso**

47 00 P404A

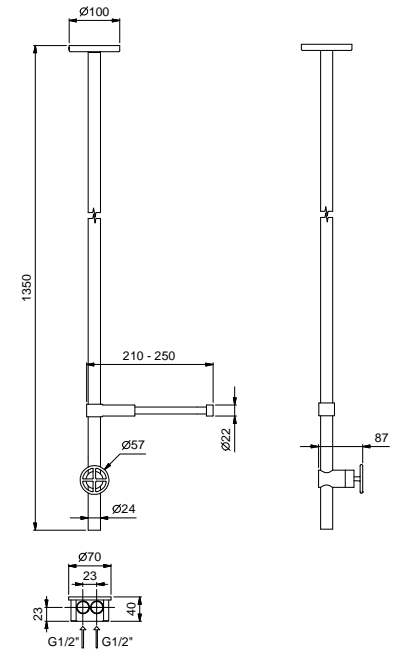
**Prolunghhe per art. P404B+P404A**

Art. 8444 - 10 cm	Matt Gun Metal PVD	47 P5 8444
Art. 8445 - 20 cm	Matt Gun Metal PVD	47 P5 8445
Art. 8446 - 30 cm	Matt Gun Metal PVD	47 P5 8446
Art. 8447 - 40 cm	Matt Gun Metal PVD	47 P5 8447
Art. 8437 - 50 cm	Matt Gun Metal PVD	47 P5 8437
Art. 8448 - 60 cm	Matt Gun Metal PVD	47 P5 8448
Art. 8449 - 70 cm	Matt Gun Metal PVD	47 P5 8449
Art. 8450 - 80 cm	Matt Gun Metal PVD	47 P5 8450
Art. 8451 - 90 cm	Matt Gun Metal PVD	47 P5 8451
Art. 8438 - 100 cm	Matt Gun Metal PVD	47 P5 8438

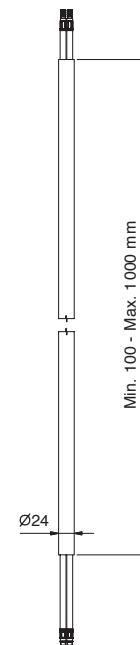

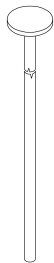
P494
lead \emptyset free**Bocca lavabo da soffitto**

- lunghezza bocca 140 cm
- limitatore di portata 5 l/min a 3 bar
- SENZA SCARICO

N.B. Consigliato in abbinamento con art. P495 o P063B+M063A

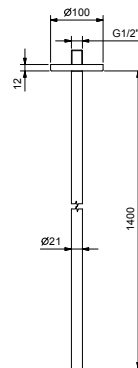

Matt Gun Metal PVD

47 P5 P494

P404C**Specchio**

- Ø 20 cm
- ingrandimento 2X
- con pantografo fisso

N.B. Lo specchio deve essere sempre ordinato con il miscelatore P404B+P404A

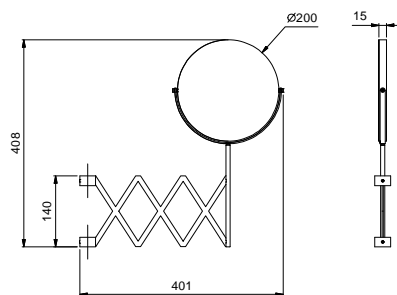

Matt Gun Metal PVD

47 P5 P404C

P495
lead \emptyset free**Miscelatore da piano**

- maniglia
- flessibili di alimentazione

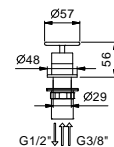

Matt Gun Metal PVD

47 P5 P495

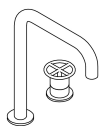
P107W
lead \emptyset free**Miscelatore lavabo 2 fori**

- interasse bocca 18,2 cm
- maniglia
- limitatore di portata 5 l/min a 3 bar
- SENZA SCARICO
- flessibili di alimentazione

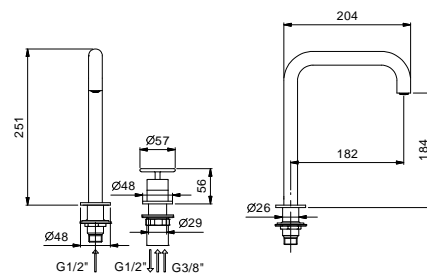

Matt Gun Metal PVD

47 P5 P107W

8441
lead \emptyset free

Bocca lavabo da piano

- interasse bocca 18,2 cm
- limitatore di portata 5 l/min a 3 bar
- SENZA SCARICO

N.B. Consigliato in abbinamento con art. P495 o P063B+M063A

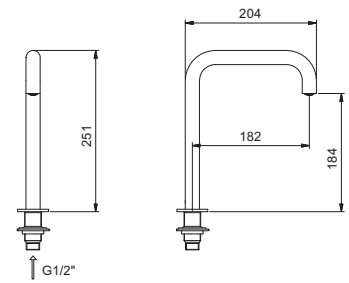

Matt Gun Metal PVD

47 P5 8441

8442
lead \emptyset free

Bocca lavabo da parete

- interasse bocca 15 cm
- limitatore di portata 5 l/min a 3 bar
- ingresso da 1/2"

N.B. Consigliato in abbinamento con art. P495 o P063B+M063A

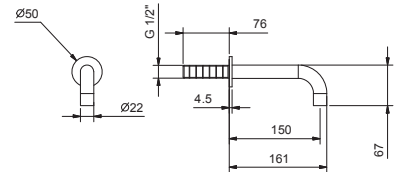

Matt Gun Metal PVD

47 P5 8442

8443
lead \emptyset free

Bocca lavabo da parete

- interasse bocca 20 cm
- limitatore di portata 5 l/min a 3 bar
- ingresso da 1/2"

N.B. Consigliato in abbinamento con art. P495 o P063B+M063A

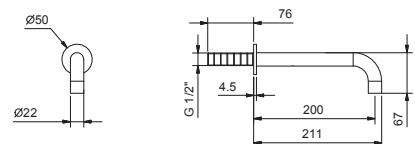
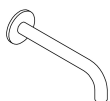

Matt Gun Metal PVD

47 P5 8443

P007W
lead \emptyset free



Gruppo lavabo 3 fori

- interasse bocca 18,2 cm
- maniglie
- limitatore di portata 5 l/min a 3 bar
- vitone ceramico 90°
- flessibili di alimentazione
- SENZA SCARICO

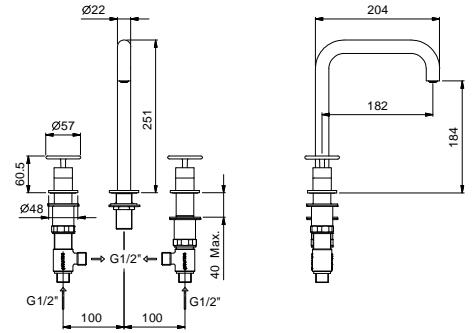

Matt Gun Metal PVD

47 P5 P007W

P007
lead \emptyset free



Gruppo lavabo 3 fori

- interasse bocca 18,2 cm
- maniglie
- limitatore di portata 5 l/min a 3 bar
- vitone ceramico 90°
- flessibili di alimentazione
- CON SCARICO a pressione

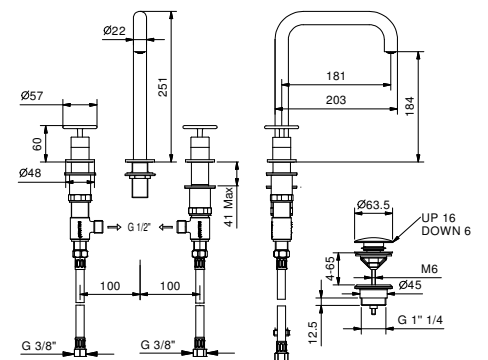

Matt Gun Metal PVD

47 P5 P007

lead \emptyset free

Gruppo lavabo da parete

- interasse bocca 15 cm
- maniglie
- limitatore di portata 5 l/min a 3 bar
- vitone ceramico 90°
- ingressi da 1/2"
- SENZA SCARICO

P010B

Parte esterna

Matt Gun Metal PVD

47 P5 P010B

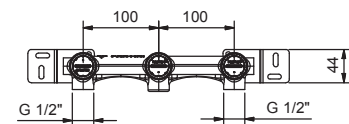
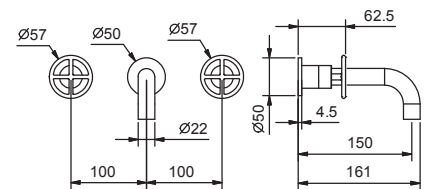
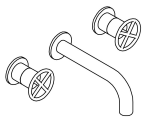

R010A

Parte da incasso

44 00 R010A

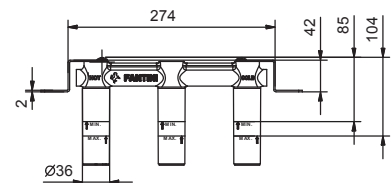
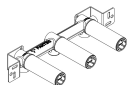

lead \varnothing free**Gruppo lavabo da parete**

- interasse bocca 20 cm
- maniglie
- limitatore di portata 5 l/min a 3 bar
- vitone ceramico 90°
- ingressi da 1/2"
- SENZA SCARICO

P013B**Parte esterna**

Matt Gun Metal PVD

47 P5 P013B

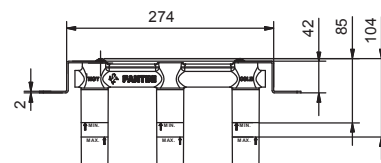
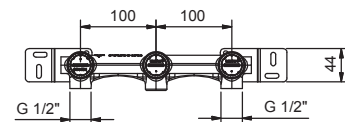
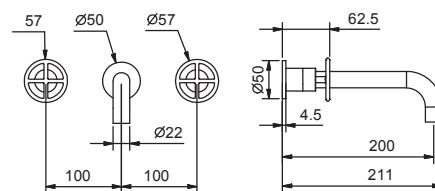
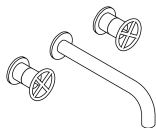
**R010A****Parte da incasso**

44 00 R010A

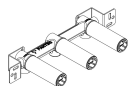

lead \varnothing free**Miscelatore lavabo da parete**

- interasse bocca 20 cm
- maniglia
- limitatore di portata 5 l/min a 3 bar
- ingressi da 1/2"
- SENZA SCARICO

P113B**Parte esterna**

Matt Gun Metal PVD 47 P5 P113B

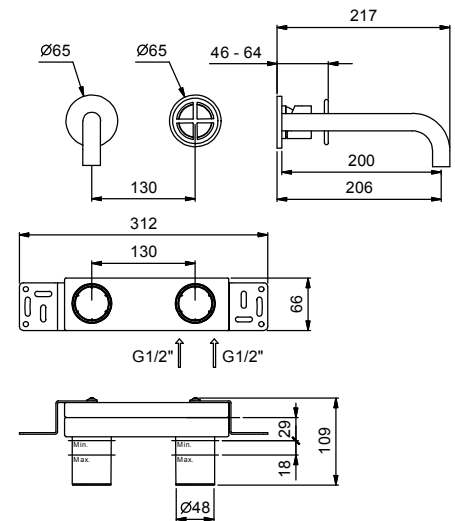
**M011A****Parte da incasso**

44 00 M011A

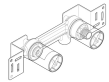
lead \varnothing free**Miscelatore lavabo da parete**

- interasse bocca 15 cm
- maniglia
- limitatore di portata 5 l/min a 3 bar
- ingressi da 1/2"
- SENZA SCARICO

P110B**Parte esterna**

Matt Gun Metal PVD 47 P5 P110B

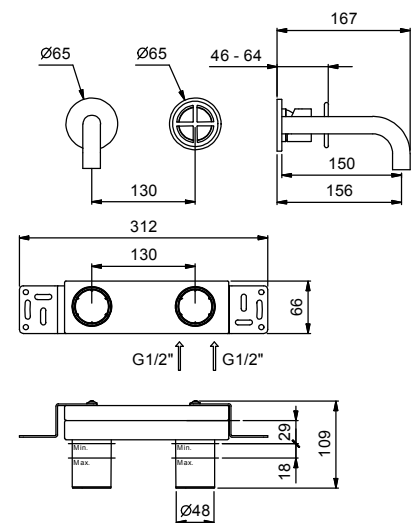
**M011A****Parte da incasso**

44 00 M011A

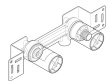

P008W

Miscelatore bidet monoforo

- interasse bocca 13,4 cm
- maniglia
- limitatore di portata 5 l/min a 3 bar
- aeratore snodato
- flessibili di alimentazione
- SENZA SCARICO

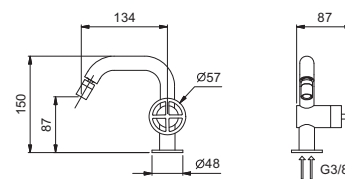

Matt Gun Metal PVD

47 P5 P008W

P008

Miscelatore bidet monoforo

- interasse bocca 13,4 cm
- maniglia
- limitatore di portata 5 l/min a 3 bar
- aeratore snodato
- flessibili di alimentazione
- CON SCARICO a pressione

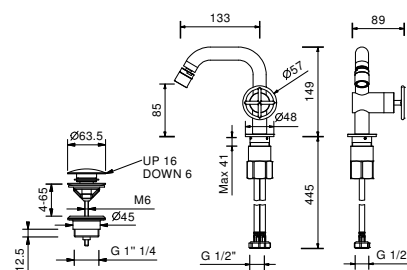

Matt Gun Metal PVD

47 P5 P008

CARTUCCIA TRADIZIONALE

Miscelatore doccia incasso

_ingressi da 1/2"



P063B+M063A

1 uscita



P685B+M585A

2 uscite



P685B+M685A

2 uscite



P687B+M587A

3 uscite



P687B+M687A

3 uscite

CARTUCCIA TERMOSTATICA

Miscelatore doccia incasso

_ingressi da 3/4"

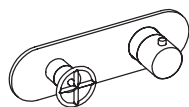

P331B+D331A

1 uscita

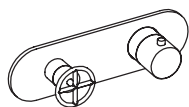

P372B+D372A

2 uscite

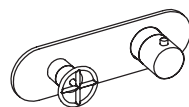

P373B+D373A

3 uscite



P300B+D400A



P391B+D391A

rubinetto di arresto

Miscelatore doccia incasso

- maniglia
- **1 uscita** da 1/2"
- ingressi da 1/2"
- isolamento acustico

P063B**Parte esterna**

Matt Gun Metal PVD 47 P5 P063B

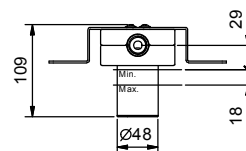
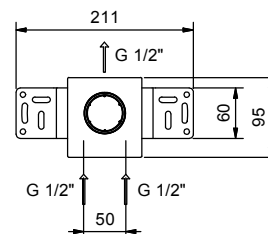
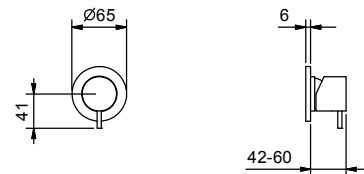
**M063A****Parte da incasso**

44 00 M063A

**Miscelatore doccia incasso**

- maniglie
- deviatore a rotazione a **2 uscite**
- ingressi da 1/2"
- isolamento acustico
- solo per montaggio verticale

P685B**Parte esterna**

Matt Gun Metal PVD 47 P5 P685B

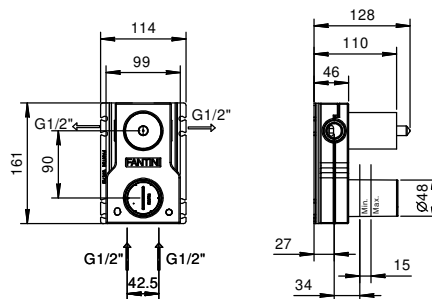
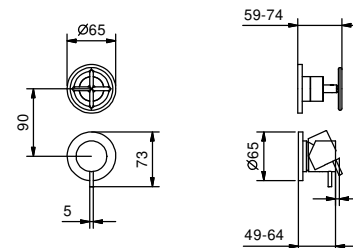
**M585A****Parte da incasso**

44 00 M585A



Miscelatore doccia incasso

- maniglie
- deviatore a rotazione a **2 uscite**
- ingressi da 1/2"
- isolamento acustico
- solo per montaggio orizzontale

P685B**Parte esterna**

Matt Gun Metal PVD 47 P5 P685B

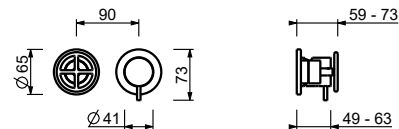
**M685A****Parte da incasso**

44 00 M685A

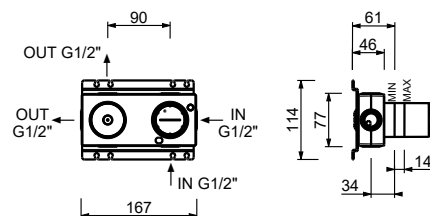
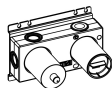
**Miscelatore doccia incasso**

- maniglie
- deviatore a rotazione a **3 uscite**
- ingressi da 1/2"
- isolamento acustico
- solo per montaggio verticale

P687B**Parte esterna**

Matt Gun Metal PVD 47 P5 P687B

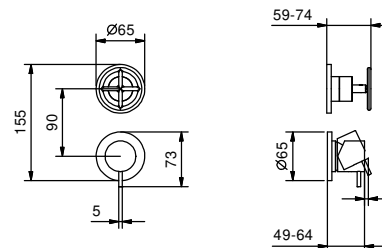
**M587A****Parte da incasso**

44 00 M587A

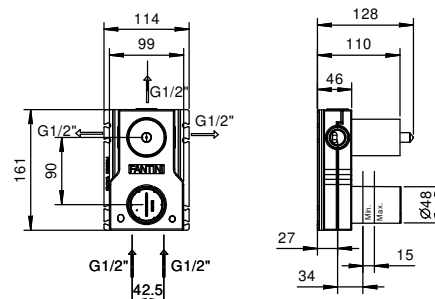

Miscelatore doccia incasso

- maniglie
- deviatore a rotazione a **3 uscite**
- ingressi da 1/2"
- solo per montaggio orizzontale
- isolamento acustico

P687B**Parte esterna**

Matt Gun Metal PVD 47 P5 P687B

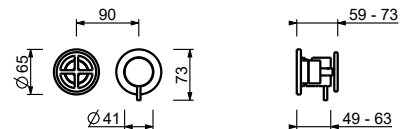
**M687A****Parte da incasso**

44 00 M687A

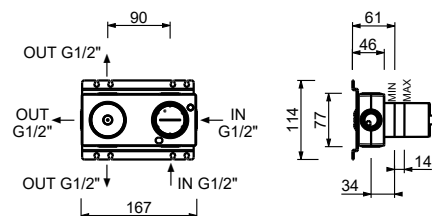
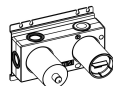

Miscelatore termostatico doccia incasso 3/4"

- maniglie
- **1 uscita** da 1/2"
- solo per montaggio orizzontale
- ingressi da 3/4"

P331B**Parte esterna**

Matt Gun Metal PVD 47 P5 P331B

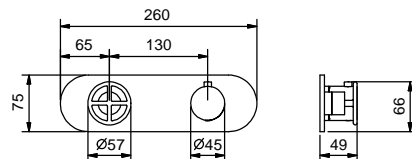
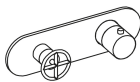
**D331A****Parte da incasso**

19 00 D331A

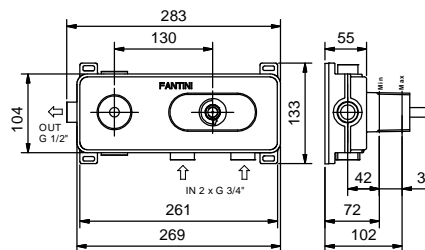
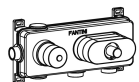
**Miscelatore termostatico doccia incasso 3/4"**

- maniglie
- deviatore a rotazione con chiusura a **2 uscite**
- solo per montaggio orizzontale
- ingressi da 3/4"

P372B**Parte esterna**

Matt Gun Metal PVD 47 P5 P372B

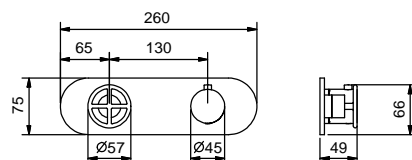
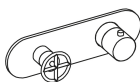
**D372A****Parte da incasso**

19 00 D372A

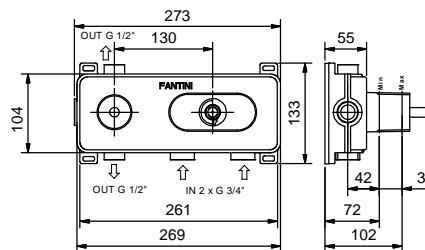
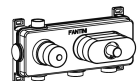

Miscelatore termostatico doccia incasso 3/4"

- maniglie
- deviatore a rotazione con chiusura a **3 uscite**
- solo per montaggio orizzontale
- ingressi da 3/4"

P373B**Parte esterna**

Matt Gun Metal PVD 47 P5 P373B

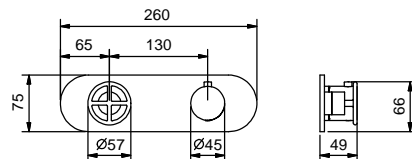
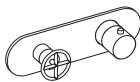
**D373A****Parte da incasso**

19 00 D373A

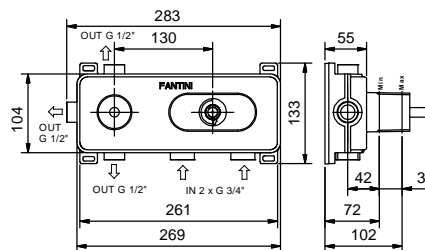
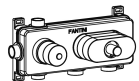
**Miscelatore termostatico doccia incasso 3/4"**

- maniglia
- ingressi da 3/4"
- isolamento acustico
- senza rubinetto di arresto **da ordinare separatamente**

N.B. il miscelatore deve essere sempre ordinato con il rubinetto di arresto P391B+D391A**P300B****Parte esterna**

Matt Gun Metal PVD 47 P5 P300B

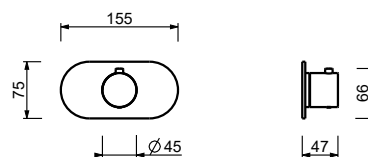
**D400A****Parte da incasso**

19 00 D400A

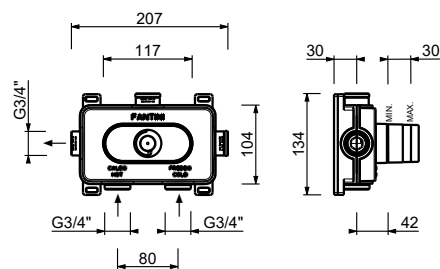

Rubinetto di arresto 3/4"

- maniglia
- vitone ceramico 90°
- ingressi da 3/4"
- isolamento acustico

P391B**Parte esterna**

Matt Gun Metal PVD 47 P5 P391B

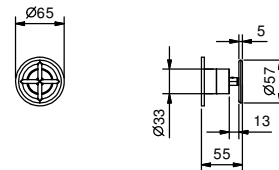
**D391A****Parte da incasso**

19 00 D391A

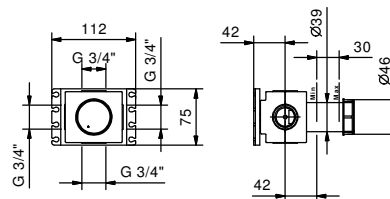
**W213****OPTIONAL - Sistema Easy fix**

- piastra e connessioni :
- per montaggio facilitato orizzontale o verticale termostatici
 - per montaggio art. D400A / D391A - **1 uscita**
 - per montaggio D400A / D391A (2 PZ) - **2 uscite**

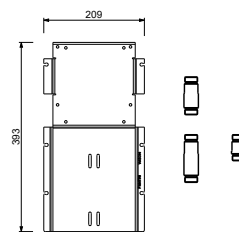
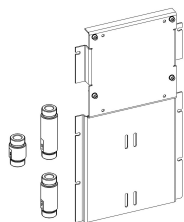
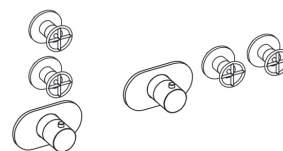
**ESEMPI DI COMBINAZIONI - 1 USCITA****ESEMPI DI COMBINAZIONI - 2 USCITE**

91 00 W213

W214**OPTIONAL - Sistema Easy fix**

piastra e connessioni :

- per montaggio facilitato orizzontale o verticale termostatici
- per montaggio D400A / D391A (3 PZ) - **3 uscite**

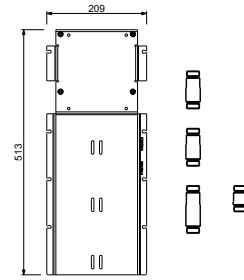
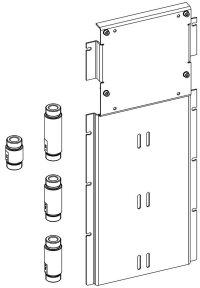
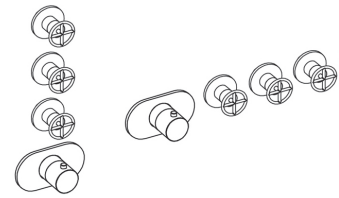
**ESEMPI DI COMBINAZIONI - 3 USCITE**

91 00 W214

8106

Soffione a pioggia

- Ø 20 cm
- limitatore di portata 12 l/min a 3 bar
- sistema anticalcare
- ingresso da 1/2"
- valvola di non ritorno

N.B. Condizioni necessarie per il corretto funzionamento: Portata min.: 10 l/min

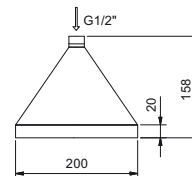

Matt Gun Metal PVD

47 P5 8106

8027

Braccio doccia

- lunghezza 30 cm
- rosone tondo
- per installazione a parete
- ingresso da 1/2"

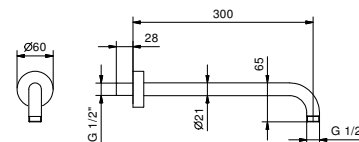
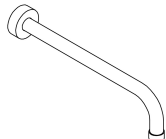

Matt Gun Metal PVD

47 P5 8027

OPTIONAL: Parte da incasso per cartongesso**W046**

91 00 W046

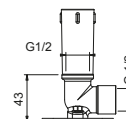

8028

Braccio doccia

- lunghezza 45 cm
- rosone tondo
- per installazione a parete
- ingresso da 1/2"

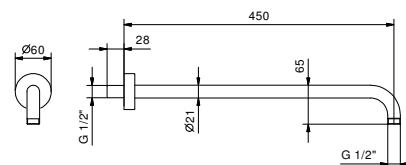
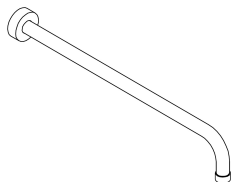

Matt Gun Metal PVD

47 P5 8028

OPTIONAL: Parte da incasso per cartongesso**W046**

91 00 W046

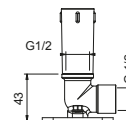

9236

Braccio doccia

- lunghezza 25 cm
- rosone tondo
- per installazione a soffitto
- ingresso da 1/2"

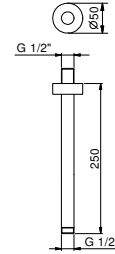

Matt Gun Metal PVD

47 P5 9236

9237

Braccio doccia

- lunghezza 45 cm
- rosone tondo
- per installazione a soffitto
- ingresso da 1/2"

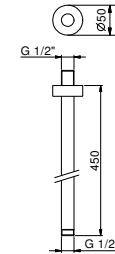

Matt Gun Metal PVD

47 P5 9237

8093

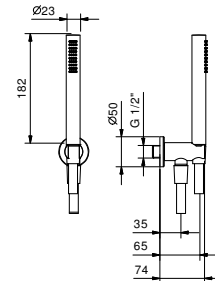
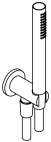

Completo doccia

- doccetta FIT
- presa acqua con supporto per doccetta
- rosone tondo
- flessibile PVC 150 cm
- ingresso da 1/2"

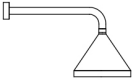

Matt Gun Metal PVD

47 P5 8093

Composizione.1	Art.	Descrizione	Finiture
	8106 8027 P685B+M585A	Soffione a pioggia Braccio doccia Miscelatore doccia incasso	P5 Matt Gun Metal PVD
	8093	Completo doccia	

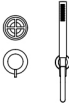
Composizione.2	Art.	Descrizione	Finiture
	8106 9237 P685B+M585A	Soffione a pioggia Braccio doccia Miscelatore doccia incasso	P5 Matt Gun Metal PVD
	8093	Completo doccia	

DOCCIA : composizioni cartuccia termostatica

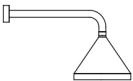
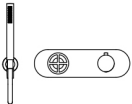
Composizione.1	Art.	Descrizione	Finiture
	8106 8027 P372B+D372A	Soffione a pioggia Braccio doccia Miscelatore termostatico doccia incasso	P5 Matt Gun Metal PVD
	8093	Completo doccia	

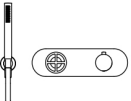
Composizione.2	Art.	Descrizione	Finiture
	8106 9237 P372B+D372A	Soffione a pioggia Braccio doccia Miscelatore termostatico doccia incasso	P5 Matt Gun Metal PVD
	8093	Completo doccia	

VITONI CERAMICI DA 1/4 DI GIRO

Gruppo vasca incasso

_ingressi da 1/2"

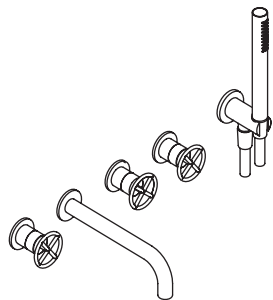

P019B+P019A

2 uscite

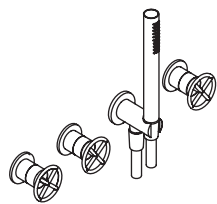

P017B+P017A

2 uscite

Gruppo bordo vasca

_ingressi da 1/2"

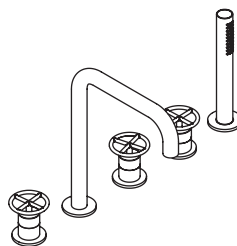

P065

2 uscite

CARTUCCIA TRADIZIONALE

Miscelatore vasca da pavimento

_ingressi da 1/2"



P080B+R080A

2 uscite

Gruppo vasca incasso

- interasse bocca 20 cm
- maniglie
- maniglia apri/chiedi con regolazione portata e temperatura doccia
- doccetta FIT
- presa acqua con supporto per doccetta
- flessibile PVC 150 cm
- vitone ceramico 90°
- ingressi da 1/2"

P019B

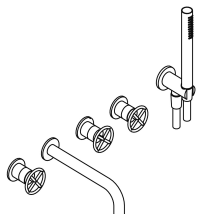

Parte esterna

Matt Gun Metal PVD 47 P5 P019B

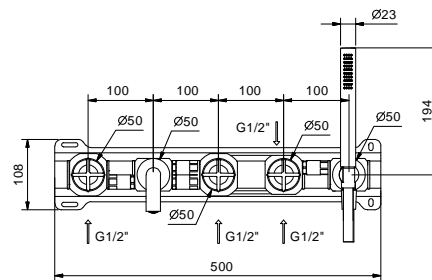

P019A

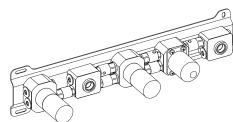

Parte da incasso

47 00 P019A

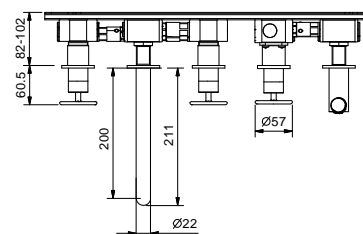

Gruppo vasca incasso

- senza bocca
- maniglie
- maniglia apri/chiedi con regolazione portata e temperatura doccia
- doccetta FIT
- presa acqua con supporto per doccetta
- flessibile PVC 150 cm
- vitone ceramico 90°
- ingressi da 1/2"

P017B

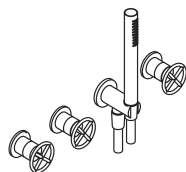

Parte esterna

Matt Gun Metal PVD 47 P5 P017B

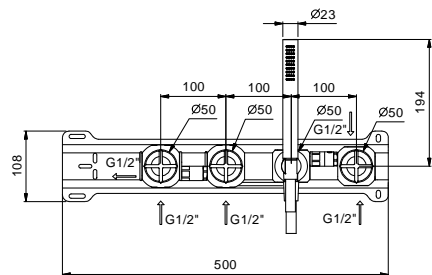

P017A

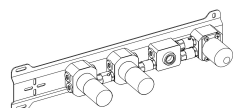

Parte da incasso

47 00 P017A

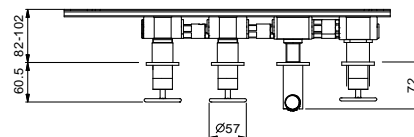

P065

Gruppo bordo vasca

- interasse bocca 18,2 cm
- maniglie
- 5 fori
- maniglia apri/chiedi con regolazione portata e temperatura doccia
- doccetta FIT
- flessibile 150 cm
- vitone ceramico 90°
- ingressi da 1/2"
- flessibili di alimentazione

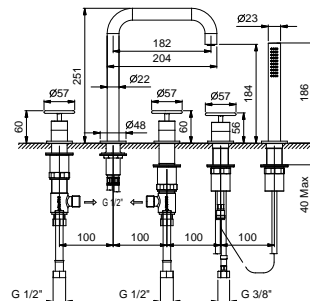
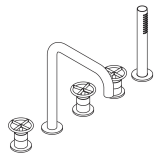

Matt Gun Metal PVD

47 P5 P065

Miscelatore vasca da pavimento

- interasse bocca 20,1 cm
- maniglia
- doccetta FIT
- supporto doccetta
- flessibile 150 cm
- ingressi da 1/2"
- su colonna

P080B



Parte esterna

Matt Gun Metal PVD

47 P5 P080B

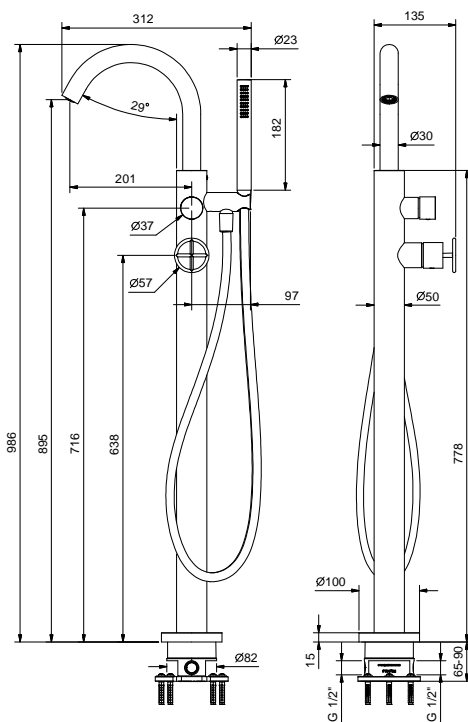

Parte da incasso

44 00 R080A

R080A



VASCA : bocche

8454

Bocca vasca da parete

- interasse bocca 20 cm
- limitatore di portata 5 l/min a 3 bar
- ingresso da 1/2"

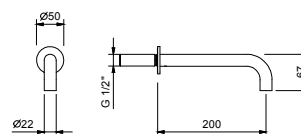

Matt Gun Metal PVD

47 P5 8454