

Art. B472BU+D373AU

3/4" Thermostatic mixer with 3-way diverter

- For horizontal installation
- 3/4" NPT inlets and 1/2" outlets
- With shut-off valve
- Rectangular backplate
- Handles included
- 8.7 GPM @ 60 PSI (primary outlet)
- 7.4 GPM @ 60 PSI (secondary outlet)
- 7.4 GPM @ 60 PSI (third outlet)

Trim
Finishes:

- | | | |
|--------------------------|-------------|--------------|
| <input type="checkbox"/> | Chrome | 26 02 B472BU |
| <input type="checkbox"/> | Matte Black | 26 13 B472BU |
| <input type="checkbox"/> | Matte White | 26 29 B472BU |

Rough
Finishes:

- | | | |
|--------------------------|--|--------------|
| <input type="checkbox"/> | | 19 00 D373AU |
|--------------------------|--|--------------|

Project:

Room:

Date:

Comments:

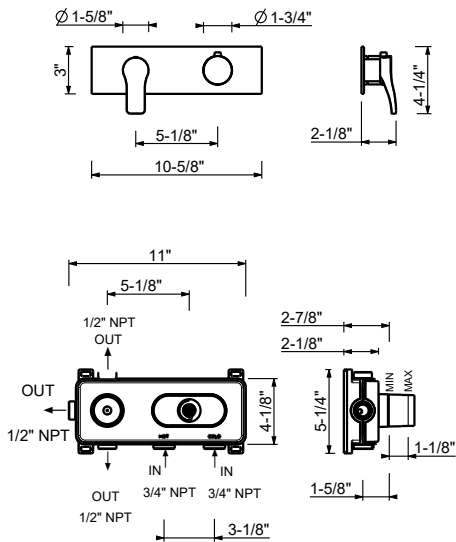

Certifications/Awards:

