

# ACQUA ZONE

TECHNICAL MANUAL

## ACQUA ZONE

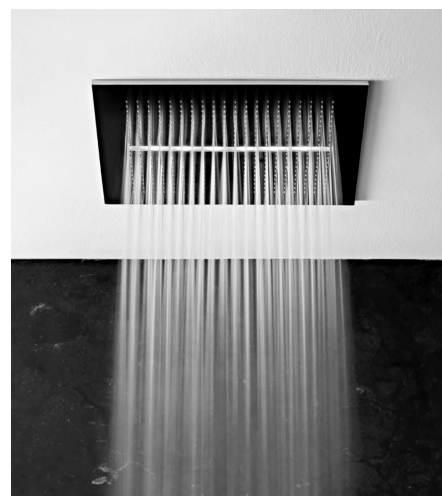

Acqua Zone Dream pag. 20

Acqua Zone pag. 21

SHOWER SET EXAMPLES pag. 22



## Technical information

	ACQUA ZONE DREAM	ACQUA ZONE
Minimum hydraulic pressure:	30PSI	30PSI
Maximum hydraulic pressure:	90PSI	90PSI
Recommended hydraulic pressure:	45PSI	45PSI
Weight:	<b>C031:</b> 44 lbs	<b>C032:</b> 40 lbs
Conditions necessary for the proper functioning:	4 GPM	4 GPM

- Tension: 220-240 V AC., Frequency: 500 Hz, Power: 30W
- IPX5 protection class (protection against water jets)
- Water supplied by means of 3/4" high flow thermostatic mixers
- Flexible connections not included in the package

### ENVIRONMENTAL CONDITIONS:

Humidity: 0 ÷ 100%

Maximum temperature: 122° F

### FUNCTIONS CONTROL BOARD

The control board includes:

- A) BUILT-IN PIECE consisting of:
  - Plastic box
- B) EXTERNAL PIECE consisting of:
  - Glass panel
  - Touch board with backlit function symbols

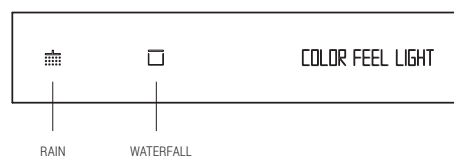

## Electrical features

### Power supply of the electronic control board:

- Connected to the shower head electronics by means of a cable with 4 wires (2 for the data bus and 2 for the power supply)
- Standard data bus RS485
- The low tension IC-board power supply, SELV, is drawn from the shower head electronics

### Led lamps:

- Tension: from 10 Vdc to 12 Vdc
- Current: 3 channels from 280 mA
- The main features of this Led system are long durability and low energy consumption.

### REGULATIONS:

- Electromagnetic compatibility: CEI EN 55014-1; CEI EN 55014-2
- IMQ Certification

## Certifications

ACQUA ZONE DREAM and the FUNCTIONS CONTROL BOARD have IMQ approvals 

### Base materials:

- Stainless Steel AISI 304
- 13 Matt Black (RAL 9005)
- 29 Matt White (RAL 9016)
- 95 Nickel PVD
- P5 Matt Gun Metal PVD
- P6 Matt British Gold PVD
- P9 Matt Copper PVD
- 01 Gold Plus
- 38 Polished Stainless Steel
- 93 Brushed Stainless Steel

## Control board finishing

00 White glass



## Technical information

	ACQUA ZONE DREAM	ACQUA ZONE
Minimum hydraulic pressure:	30PSI	30PSI
Maximum hydraulic pressure:	90PSI	90PSI
Recommended hydraulic pressure:	45PSI	45PSI
Weight:	<b>C031U:</b> 44 lbs	<b>C032U:</b> 40 lbs
Conditions necessary for the proper functioning:	4 GPM	4 GPM

- Tension: 220-240 V AC., Frequency: 500 Hz, Power: 30W
- IPX5 protection class (protection against water jets)
- Water supplied by means of 3/4" high flow thermostatic mixers
- Flexible connections not included in the package

### ENVIRONMENTAL CONDITIONS:

Humidity: 0 ÷ 100%

Maximum temperature: 122° F

### FUNCTIONS CONTROL BOARD

The control board includes:

- A) BUILT-IN PIECE consisting of:
  - Plastic box
- B) EXTERNAL PIECE consisting of:
  - Glass panel
  - Touch board with backlit function symbols

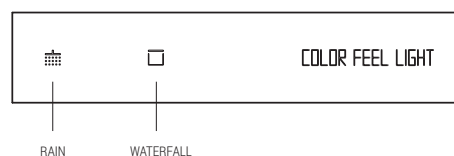

## Electrical features

### Power supply of the electronic control board:

- Connected to the shower head electronics by means of a cable with 4 wires (2 for the data bus and 2 for the power supply)
- Standard data bus RS485
- The low tension IC-board power supply, SELV, is drawn from the shower head electronics

### Led lamps:

- Tension: from 10 Vdc to 12 Vdc
- Current: 3 channels from 280 mA
- The main features of this Led system are long durability and low energy consumption.

### REGULATIONS:

- Electromagnetic compatibility: CEI EN 55014-1; CEI EN 55014-2
- IMQ Certification

## Certifications

ACQUA ZONE DREAM and the FUNCTIONS CONTROL BOARD have IMQ approvals 

### Base materials:

- Stainless Steel AISI 304
- 13 Matt Black (RAL 9005)
- 29 Matt White (RAL 9016)
- 95 Nickel PVD
- P5 Matt Gun Metal PVD
- P6 Matt British Gold PVD
- P9 Matt Copper PVD
- 01 Gold Plus
- 38 Polished Stainless Steel
- 93 Brushed Stainless Steel

## Control board finishing

00 White glass

Art. C031U

Ceiling-mount multifunction showerhead - Rainfall / Waterfall / Mist

- 20 7/8" x 20 7/8"
- 400 anti-lime scale rain jets
- Waterfall (15 3/4" wide)
- Mist blow, 2 anti-lime scale jets with anti-drop valves
- White RGB LED lights
- RGB LED cromotherapy in 4 colors
- "Feel" color program: Dawn, Leaves, Sunset, Night
- Stainless steel construction
- 3 blue backlit push buttons serve as stop valves to control each function (Rain, Waterfall and Mist Blow)
- Each function can only be activated independently
- 3 white backlit push buttons to activate the three LED functions: light, feel program (alternating colors) and cromotherapy (color of your choice)
- Minimum flow: 5 GPM
- Minimum flow pressure: 30 PSI
- Maximum flow pressure: 75 PSI

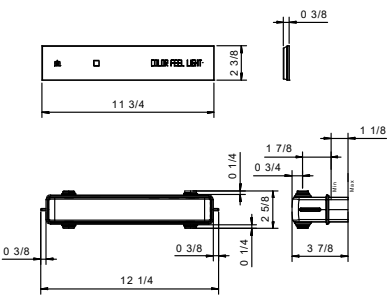
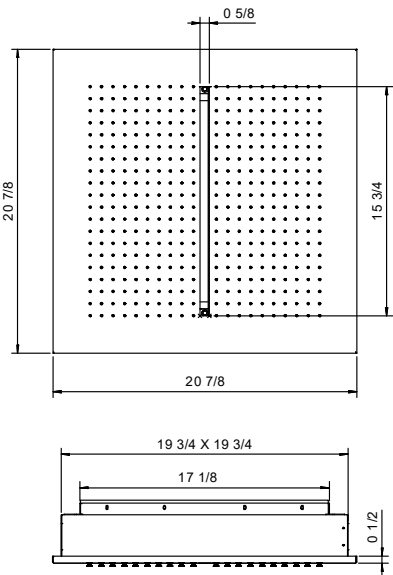

Matte Black	75 13 C031U
Matte White	75 29 C031U
Nickel PVD	75 95 C031U
Matte Gun Metal PVD	75 P5 C031U
Matte British Gold PVD	75 P6 C031U
Matte Copper PVD	75 P9 C031U
Gold Plus	75 01 C031U
Polished Stainless steel	75 38 C031U
Brushed Stainless steel	75 93 C031U

Art. C032U

## Ceiling-mount multifunction showerhead - Rainfall / Waterfall

- 20 7/8" x 20 7/8"
- Ceiling-mount
- 400 anti-lime scale rain jets
- Waterfall (15 3/4" wide)
- Minimum flow: 5 GPM
- Minimum flow pressure: 30 PSI
- Maximum flow pressure: 75 PSI

**Requires 3/4" thermostatic mixer plus two volume controls or two outlets on a diverter**

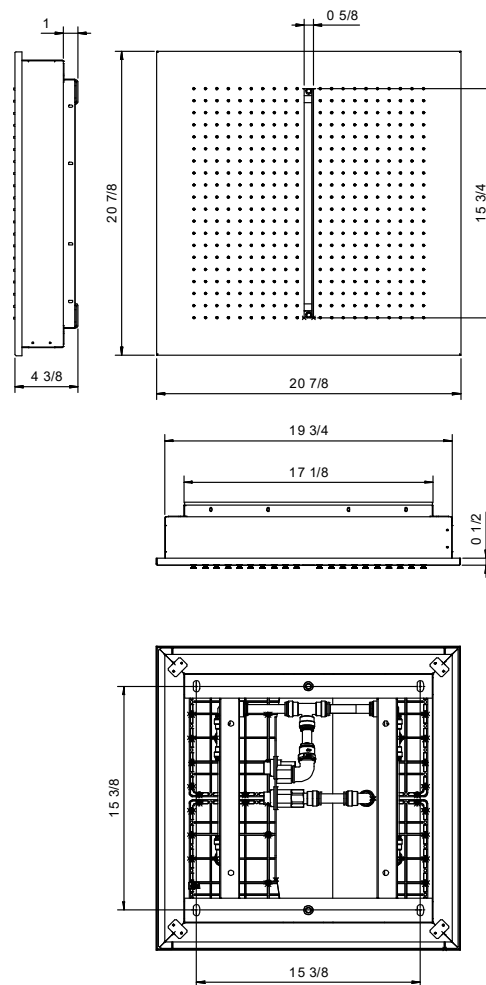

Matte Black	75 13 C032U
Matte White	75 29 C032U
Nickel PVD	75 95 C032U
Matte Gun Metal PVD	75 P5 C032U
Matte British Gold PVD	75 P6 C032U
Matte Copper PVD	75 P9 C032U
Gold Plus	75 01 C032U
Polished Stainless steel	75 38 C032U

**Brushed Stainless steel 75 93 C032U**



1

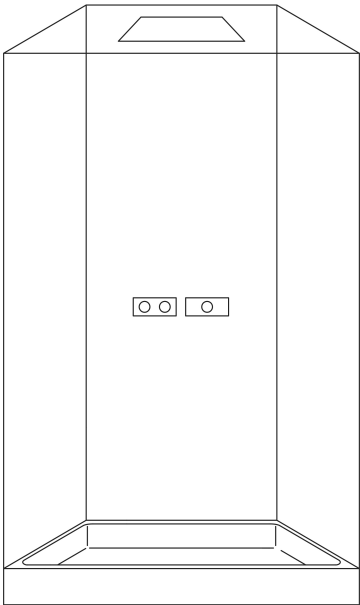

75 38 C032U  
31 02 7300BU  
19 00 D200AU  
31 02 7392BU  
19 00 D292AU

2

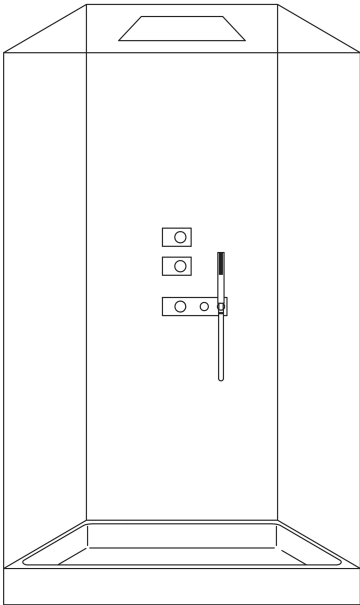

75 38 C032U  
31 02 4713BU  
19 02 4713AU

3

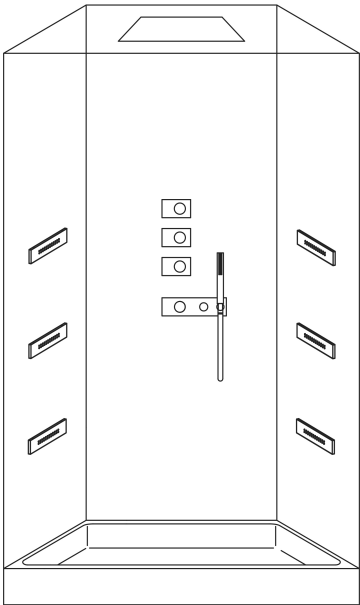

75 38 C032U  
31 02 4714BU  
19 02 4714AU  
86 02 8034BU (x6)  
86 00 8034AU (x6)

4

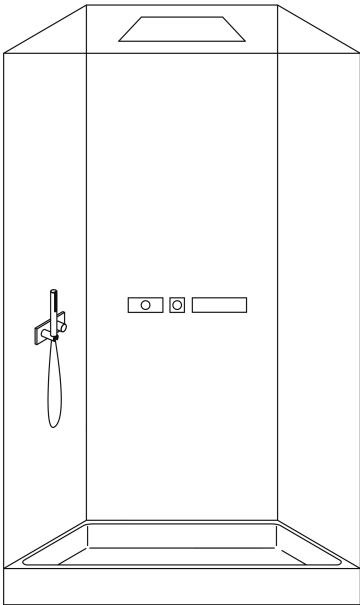

75 38 C031U  
31 02 7321BU  
19 00 D221AU  
31 02 7300BU  
19 00 D200AU  
31 02 7391BU  
19 00 D291AU



**Fantini USA Inc.**

A&D BUILDING - 150 East 58th Street, 8th floor - New York, NY 10155

Ph. 212 308 8833 - Fax 212 308 8820

[www.fantiniusa.com](http://www.fantiniusa.com) - [fantini@fantiniusa.com](mailto:fantini@fantiniusa.com)