

price list

FONTANE BIANCHE

2021

Salvatori + Fantini

SALVATORI +  FANTINI
DAL 1946 RUBINETTI

Prices in US\$

price list

FONTANE BIANCHE

2021

Salvatori + Fantini

Delivery Information

Our products are shipped with UPS directly from Italy to the requested location. The lead-time of our products are divided into the following categories:

CATEGORY	LEAD TIME FROM RECEIPT OF THE ORDER CONFIRMATION (*)
C	6-8 WEEKS
X	1-3 BUSINESS DAYS

(*) The order confirmation will be sent 1-2 days after receiving the PO and will indicate the foreseen ETA.

Please Note:

Orders containing products belonging to delivery category "X" will be shipped separately via UPS EXPRESS SAVER at no additional cost. All other articles belonging to delivery category "C" will automatically be placed on back order and confirmed with a lead time of 6-8 weeks.

Freight Charges

Orders will be delivered with customs and relating duties and brokerage charges prepaid by Fantini. All net orders exceeding \$1,900.00 are shipped free of charge. Orders less than \$1,900.00 will include on the invoice an additional \$15.00 or \$40.00 (according to package size).

PO Net Value (US\$)	Additional Freight Charge	Additional Freight Charge for Small Packages (*)
Less Than \$1,900.00	\$ 40.00	\$ 15.00
More Than \$1,900.00	Free of Charge	Free of Charge

(*) Includes: cartridges, spare parts, handles, shower arms, and small individual components.

Please Note:

Any orders that need to be split will be charged an additional \$40.00 freight charge for each delivery.

Express Deliveries

For items and rough parts in stock, shorter delivery times may be agreed upon and UPS' Express or UPS' Express Saver Service made

available. For these shipments, the customer will be informed of an additional cost which will be included on their invoice.

All express deliveries should be discussed with a Fantini representative and/or our Customer Service.

Frequently Asked Questions

Where are our faucets made?

Fontane Bianche products are made in Piedmont, Italy, adhering to strict production and quality standards. The production cycle from the buying of raw materials, the machining on constantly modernized equipment, the polishing and chrome plating to the final control of each single component is directly overseen and controlled by Fantini.

How do I know if a product is code approved?

We are committed to offering its products in compliance with applicable standards and codes in North America that not only ensure quality but also guarantee a safe installation and a healthy and sustainable use of water. Please visit www.fantiniusa.com/certifications to verify the available certifications for each product. Simply type the article number in the search field to view all obtained certifications (e.g., for Fontane Bianche 3-Hole faucet in chrome 47 02 P007WU, you would only type: P007WU).

Lead Free

All of Fontane Bianche's washbasin mixers have a weighted average lead content equal to or less than 0.25% in compliance with NSF/ANSI 372-2010, California AB1953-2006, Vermont Bill S.152, Maryland House Bill 372, Louisiana House Bill HB.471 which regulate safe water consumption. Lead Free products are labeled with the following logo: 

US & Canadian Plumbing & Building Codes

Plumbing products sold within the territories of US & Canada are required to comply with ASME A112.18.1-2012/CSA B125.1-12 standards. Fontane Bianche products that meet or exceed the standards defined by ASME A112.18.1-2012/CSA B125.1-12 are labeled with the following logo: 

WaterSense®

WaterSense is a U.S. Environmental Protection Agency (EPA) program designed to encourage water efficiency in the United States by restricting faucets to 1.5 GPM and showerheads to 2 GPM. We offer an extensive number of faucets and shower articles that meet or exceed the standards defined within the WaterSense program. Certified WaterSense products are labeled with the following logo: 

CEC

Title 20 of the California Energy Commission (CEC) requires that the flow rate of all bathroom faucets shall not exceed 1.2 GPM, the flow rate of all kitchen faucets shall not exceed 1.8 GPM and that the flow rate of all showerheads and hand showers shall not exceed 1.8 GPM. All of Fontane Bianche's bathroom faucets, hand shower sets and tub fillers with hand showers are restricted to flow rates that meet or exceed the requirement defined in Title 20. Showerheads that meet or exceed the requirement defined in Title 20 have an article number ending with "UC" (e.g., 8106UC). CEC approved products are labeled with the following logo: **CEC**

CALGreen

The California Green Building Standards requires that a shower with multiple functions can only operate one function at a time. Therefore, when a shower has more than one function the use of a diverter becomes necessary. All of Fontane Bianche's collections feature various diverter options, allowing for multiple shower functions while still complying with the CalGreen standard. Shower controls in compliance with CalGreen are labeled with the following logo: 

Commonwealth of Massachusetts

By law, only products registered with the Commonwealth of Massachusetts are allowed to be installed in Massachusetts. Products that are registered for use within Massachusetts are labeled with the following logo: 

Frequently Asked Questions

Is it possible to track my delivery?

Yes. Our standard shipping courier is UPS. Upon request, we may provide you with the relative Order Tracking Number.

What does PVD stand for?

PVD, i.e. Physical Vapor Deposition, is a toxic free and non-allergic coating. It is a thin metallic film which coats solid items, improves surface hardness and offers protection against corrosion as well as normal wear and tear.

Is it possible to customize product dimensions?

Yes. We can change spout and shower arm lengths in addition to spout heights according to special needs and requirements. Please contact us with your request and if possible we will provide pricing and lead time.

What are the lead times for custom articles?

Custom articles can have lead times of up to 8-16 weeks.

Do Fantini shower systems require out of the ordinary flow rates?

No. A standard pressure rate of 45 PSI is enough to make our showerheads and shower systems work properly (including the Acquapura multifunctional shower panel).

What is the advantage of Vinyl hoses?

Vinyl hoses have a smooth surface making it easier to clean and keep free of soap and dirt residue.

Where can I find care and maintenance instructions?

You will find an instruction manual inside the product box. We suggest cleaning our products with a soft lintfree cloth and mild soap and water.

NOTE: DO NOT USE ABRASIVE CLEANERS OR SOLVENTS.

Aerator filters can be removed and rinsed. If there is a problem, soak the aerator in a solution of one part vinegar to five parts water for about ten to twelve hours.

Where can I find technical drawings, images, spec, installation instructions, 2D and 3D drawings?

Visit www.fantiniusa.com, for 2D and 3D drawings you need to register an account to access the reserved area. If you need any further assistance contact customer service.

How can I contact customer service?

Ph: 212.308.8833

Fax: 212.308.8820

fantini@fantiniusa.com

FONTANE BIANCHE



WASHBASIN

progressive cartridge	pag. 26
1/4 turn ceramic disc cartridge	pag. 30
traditional cartridge	pag. 32

BIDET

progressive cartridge	pag. 33
-----------------------	---------

SHOWER

thermostatic cartridge	pag. 35
complementary fittings	pag. 39

TUB	pag. 41
-----	---------

Extensions	pag. 43
------------	---------

SHOWER SET EXAMPLES	pag. 46
---------------------	---------

Technical information

The FONTANE BIANCHE mixers are supplied WITH HANDLE.

All washbasin and bidet mixers are fitted with 1.2 GPM **flow restrictors** and are supplied WITHOUT DRAIN.

The **washbasin** and **bidet mixers** are available in the following versions:

- **PROGRESSIVE** cartridge
- **TRADITIONAL** cartridge

- PROGRESSIVE CARTRIDGE MIXERS

By turning the mixer 180° counterclockwise the water flows gets **cold > warmer > hot**.

- TRADITIONAL CARTRIDGE MIXERS

Water flow is controlled operating the handle up and down.

Temperature is controlled rotating the handle right or left.

BASINS HOLE SIZE:

- Two-handle washbasin mixer.

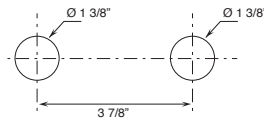

- Three-hole washbasin mixer.

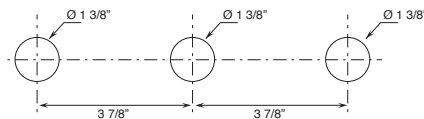

The three-hole washbasin mixers are supplied with a right ceramic disc cartridge with a 1/4 turn (Art. 0892U) and a left ceramic disc cartridge with a 1/4 turn (Art. 9426U).

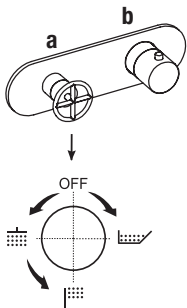

The built-in 3/4" thermostatic shower mixer has two controls:

- art. P272BU/D272AU - two outlets / art. P272BU/D273AU - three outlets

a) shut-off rotating diverter - By rotating the diverter knob from center to right clockwise, one opens the first outlet, shuts off at the center and rotating left opens the second and third outlets in a sequence.

b) temperature control.

Base materials:

- Brass
- P5 Matte Gun Metal PVD

* For spare parts, accessories, miscellaneous items and extensions please refer to specific pricelist sections

PROGRESSIVE CARTRIDGE

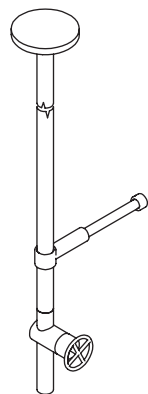
Ceiling-mount washbasin mixer*_53 1/8" spout length***P404BU+P404AU**

without drain

Two-hole washbasin mixer*_7 1/8" spout projection***P107WU**

without drain

Single-hole bidet mixer*_5 1/4" spout projection***P008WU**

without drain

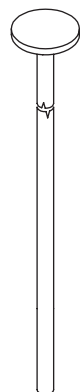
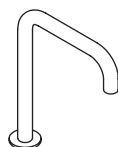
Ceiling-mount washbasin spout*_55 1/8" spout length***P494U****Deck-mount washbasin spout***_7 1/8" spout projection***8441U****Wall-mount washbasin spout***_5 7/8" spout projection***8442U****Wall-mount washbasin spout***_8" spout projection***8443U****Deck-mount remote control****P495U**

TRADITIONAL CARTRIDGE

Wall-mount single-control washbasin mixer
_ 5 7/8" spout projection



P110BU+M011AU
without drain

Wall-mount single-control washbasin mixer
_ 8" spout projection



P113BU+M011AU
without drain

Wall-mount separate control for washbasin spouts



P063BU+M063AU
1 outlet

1/4 TURN CERAMIC DISC CARTRIDGE

Three-hole washbasin mixer
_ 7 1/8" spout projection

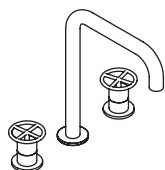

P007WU
without drain

Wall-mount two-handle washbasin mixer
_ 5 7/8" spout projection

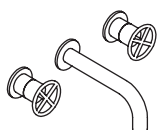

P010BU+R010AU
without drain

Wall-mount two-handle washbasin mixer
_ 8" spout projection

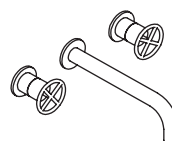

P013BU+R010AU
without drain

WASHBASIN : progressive cartridge

Ceiling-mount washbasin mixer

- 53 1/8" spout length
- Handle included
- Water flow restricted to 1.2 GPM

Drain to be ordered separately:
please select #9865U or #9867U

Art. P404BU

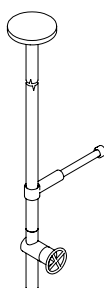

Art. P404AU



Trim

Matte Gun Metal PVD 47 P5 P404BU

Rough

47 00 P404AU

TOTAL PRICE

Matte Gun Metal PVD

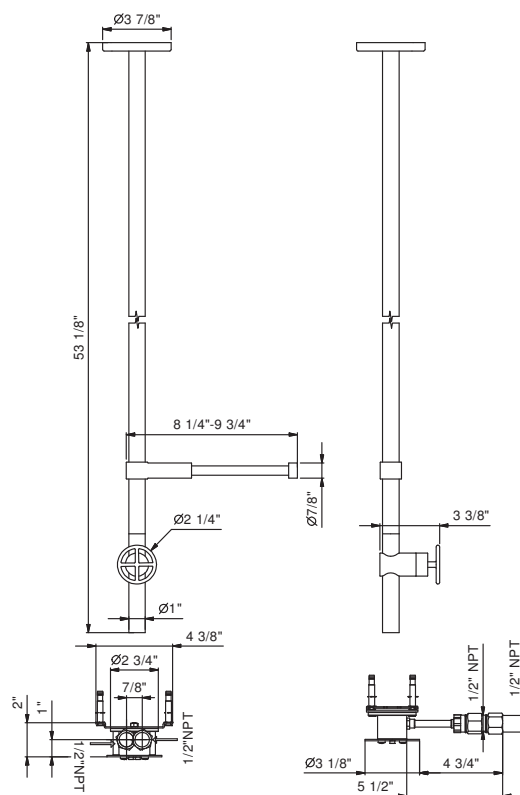

Extensions for #P404BU+#P404AU

Art. 8444 - 3 7/8" Matte Gun Metal PVD 47 P5 8444

Art. 8445 - 7 7/8" Matte Gun Metal PVD 47 P5 8445

Art. 8446 - 11 3/16" Matte Gun Metal PVD 47 P5 8446

Art. 8447 - 15 3/4" Matte Gun Metal PVD 47 P5 8447

Art. 8437 - 19 11/16" Matte Gun Metal PVD 47 P5 8437

Art. 8448 - 23 5/8" Matte Gun Metal PVD 47 P5 8448

Art. 8449 - 27 9/16" Matte Gun Metal PVD 47 P5 8449

Art. 8450 - 31 1/2" Matte Gun Metal PVD 47 P5 8450

Art. 8451 - 35 7/16" Matte Gun Metal PVD 47 P5 8451

Art. 8438 - 39 3/8" Matte Gun Metal PVD 47 P5 8438

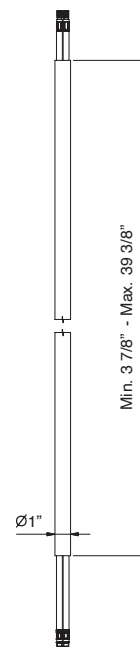

WASHBASIN : progressive cartridge

Art. P494U

Ceiling-mount washbasin spout

- 55 1/8" spout length
- Water flow restricted to 1.2 GPM

**Drain to be ordered separately:
please select #9865U or #9867U**

To be combined with #P495U or #P063BU+#M063AU

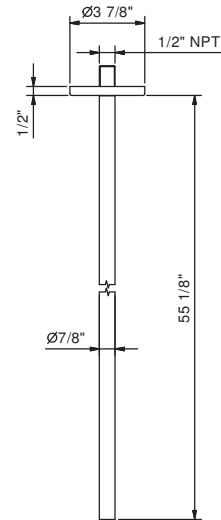

Matte Gun Metal PVD 47 P5 P494U

Art. P404C

Mirror

- Magnifying mirror
- With fixed pantograph

The mirror is compatible with #P404BU+#P404AU

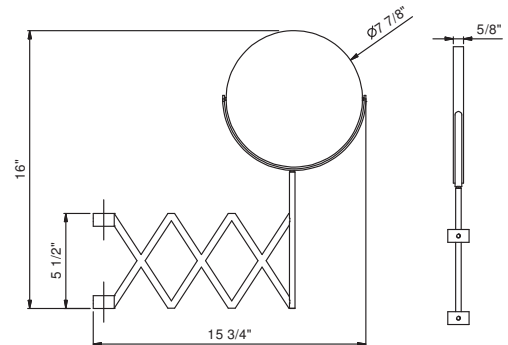

Matte Gun Metal PVD 47 P5 P404C

Art. 8441U

Deck-mount washbasin spout

- 7 1/8" spout projection
- Water flow restricted to 1.2 GPM

**Drain to be ordered separately:
please select #9865U or #9867U**

To be combined with #P495U or #P063BU+#M063AU

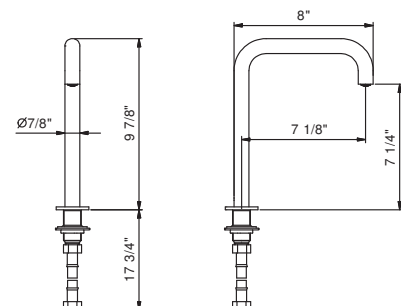
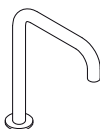

Matte Gun Metal PVD 47 P5 8441U

WASHBASIN : progressive cartridge

Art. 8442U

Wall-mount washbasin spout

- 5 7/8" spout projection
- 1/2" Male NPT fitting
- Water flow restricted to 1.2 GPM

Drain to be ordered separately:
please select #9865U or #9867U



To be combined with #P495U or #P063BU+#M063AU

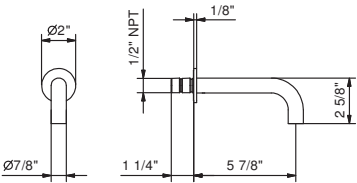

Matte Gun Metal PVD 47 P5 8442U

Art. 8443U

Wall-mount washbasin spout

- 8" spout projection
- 1/2" Male NPT fitting
- Water flow restricted to 1.2 GPM

Drain to be ordered separately:
please select #9865U or #9867U



To be combined with #P495U or #P063BU+#M063AU

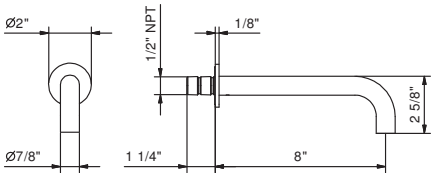

Matte Gun Metal PVD 47 P5 8443U

Art. P495U

Deck-mount remote control

- Handle included
- Flexible supply lines



Matte Gun Metal PVD 47 P5 P495U

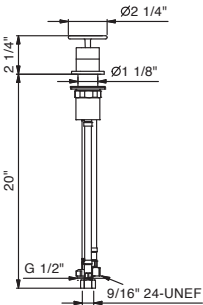

WASHBASIN : progressive cartridge

Wall-mount separate control for washbasin spouts

- 7.6 GPM @ 60 PSI
- Handle included
- 1/2" inlet
- Round escutcheon

Art. P063BU

Trim

Matte Gun Metal PVD 47 P5 P063BU



Art. M063AU

Rough

44 00 M063AU

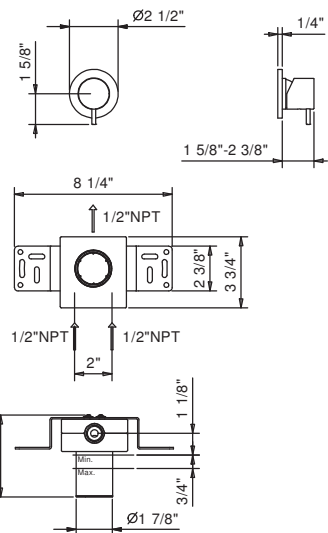

TOTAL PRICE

Matte Gun Metal PVD

Art. P107WU

Two-hole washbasin mixer

- 7 1/8" spout projection
- Handle included
- Flexible supply lines
- Water flow restricted to 1.2 GPM

Drain to be ordered separately:
please select #9865U or #9867U



Matte Gun Metal PVD 47 P5 P107WU

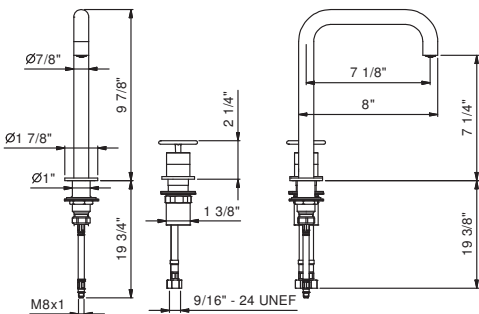

WASHBASIN : 1/4 turn ceramic disc cartridge

Art. P007WU

3-hole washbasin mixer

- 7 1/8" spout projection
- Ceramic disc cartridges, 1/4 turn
- Handles included
- Flexible supply lines
- Water flow restricted to 1.2 GPM

Drain to be ordered separately:
please select #9865U or #9867U



Matte Gun Metal PVD 47 P5 P007WU

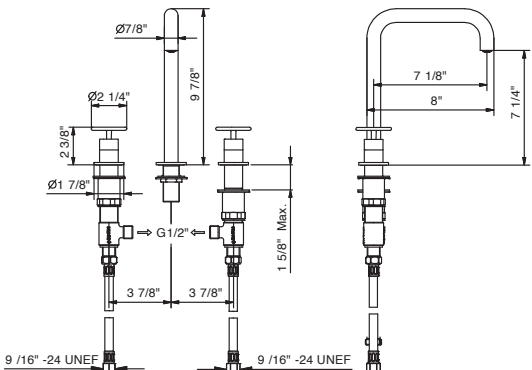

Wall-mount washbasin mixer

- 5 7/8" spout projection
- Handle included
- Ceramic disc cartridges, 1/4 turn
- Water flow restricted to 1.2 GPM

Drain to be ordered separately:
please select #9865U or #9867U

Art. P010BU

Trim

Matte Gun Metal PVD 47 P5 P010BU

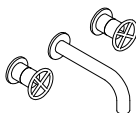

Art. R010AU

Rough

44 00 R010AU

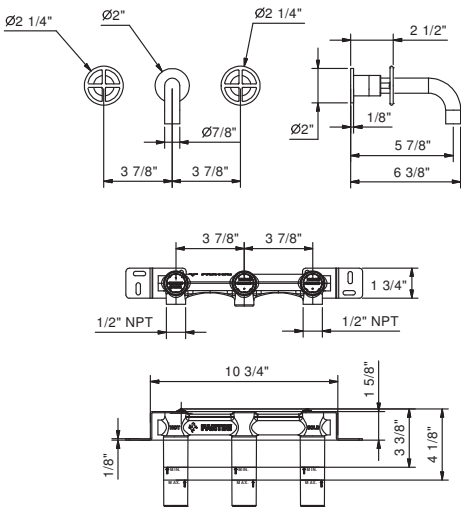
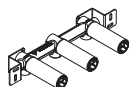

TOTAL PRICE

Matte Gun Metal PVD

WASHBASIN : 1/4 turn ceramic disc cartridge

Wall-mount washbasin mixer

- 7 7/8" spout projection
- Handle included
- Ceramic disc cartridges, 1/4 turn
- Water flow restricted to 1.2 GPM

Drain to be ordered separately:
please select #9865U or #9867U

Art. P013BU

Trim

Matte Gun Metal PVD 47 P5 P013BU

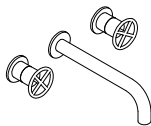

Art. R010AU

Rough

44 00 R010AU

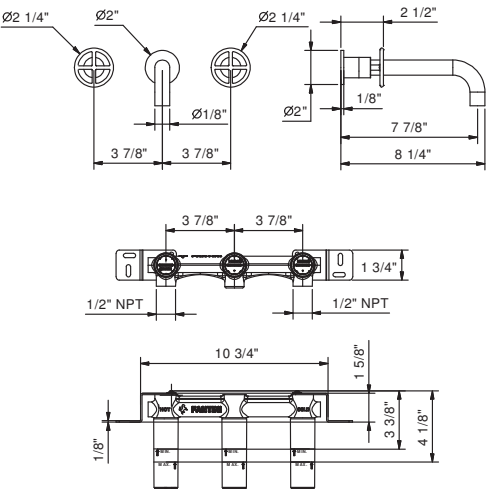
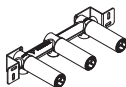

TOTAL PRICE

Matte Gun Metal PVD

WASHBASIN : traditional cartridge

Wall-mount washbasin mixer

- 5 7/8" spout projection
- Handle included
- Ceramic disc cartridges, 1/4 turn
- Water flow restricted to 1.2 GPM

Drain to be ordered separately:
please select #9865U or #9867U

Art. P110BU

Trim

Matte Gun Metal PVD 47 P5 P110BU



Art. M011AU

Rough

44 00 M011AU

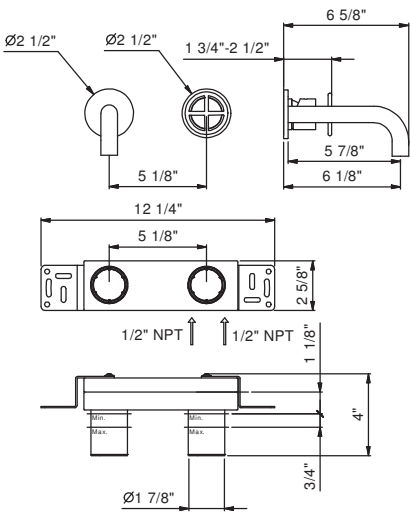
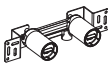

TOTAL PRICE

Matte Gun Metal PVD

Wall-mount washbasin mixer

- 7 7/8" spout projection
- Handle included
- Ceramic disc cartridges, 1/4 turn
- Water flow restricted to 1.2 GPM

Drain to be ordered separately:
please select #9865U or #9867U

Art. P113BU

Trim

Matte Gun Metal PVD 47 P5 P113BU



Art. M011AU

Rough

44 00 M011AU

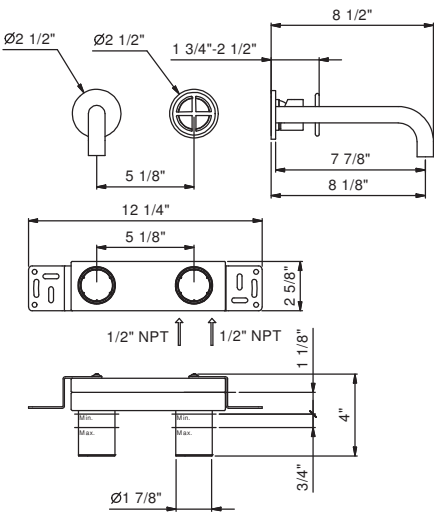
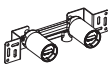

TOTAL PRICE

Matte Gun Metal PVD

BIDET : progressive cartridge

Art. P008WU

Single-hole bidet mixer

- 5 1/4" spout projection
- Handles included
- Progressive cartridge
- Flexible supply lines
- Water flow restricted to 1.2 GPM

**Drain to be ordered separately:
please select #9865U or #9867U**



Matte Gun Metal PVD 47 P5 P008WU

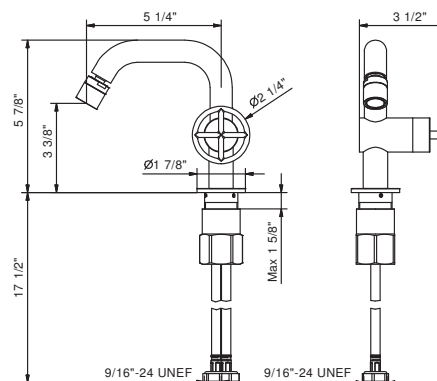

THERMOSTATIC CARTRIDGE

Built-in shower mixer

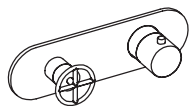
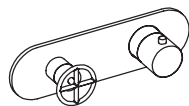
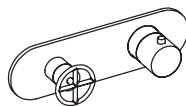
3/4" inlets**P231BU+D231AU**volume control
1 outlet**P272BU+D272AU**diverter
2 outlets**P272BU+D273AU**diverter
3 outlets**P200BU+D200AU****P291BU+D291AU**volume control
1 outlet**P276BU+D276AU**diverter
2 outlets**P276BU+D277AU**diverter
3 outlets

Tub : Summary Table

1/4 TURN CERAMIC DISC CARTRIDGE

Wall-mount tub set

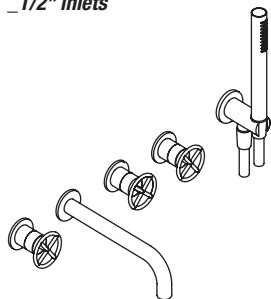
1/2" inlets**P019BU+P019AU**

2 outlets

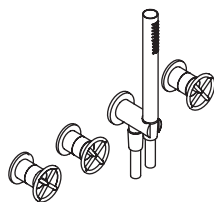
**P017BU+P017AU**

2 outlets

5-Hole Roman tub set

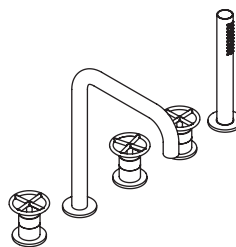
1/2" inlets**P065U**

2 outlets

SHOWER : thermostatic cartridge

3/4" Thermostatic mixer with integrated volume control

- For horizontal installation
- 3/4" NPT inlets and outlets
- With shut-off valve
- Sound insulation foam back
- Handles included
- 15.3 GPM @ 60 PSI

Art. P231BU

Trim

Matte Gun Metal PVD 47 P5 P231BU

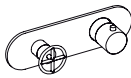

Art. D231AU

Rough

19 00 D231AU

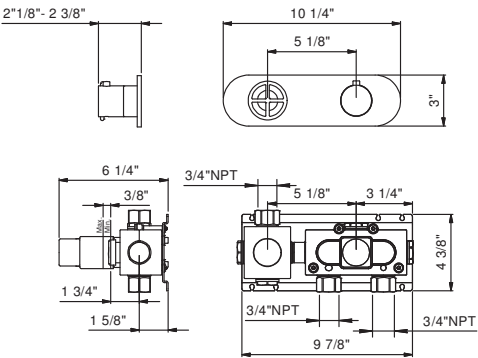
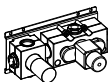

TOTAL PRICE

Matte Gun Metal PVD

3/4" Thermostatic mixer with 2-way diverter

- For horizontal installation
- 3/4" NPT inlets and 1/2" outlets
- With shut-off valve
- Sound insulation foam back
- Handles included
- 8.9 GPM @ 60 PSI (primary outlet)
- 7.6 GPM @ 60 PSI (secondary outlet)

Art. P272BU

Trim

Matte Gun Metal PVD 47 P5 P272BU

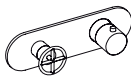

Art. D272AU

Rough

19 00 D272AU

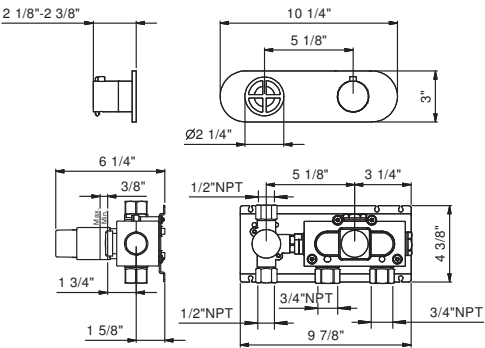
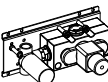

TOTAL PRICE

Matte Gun Metal PVD

SHOWER : thermostatic cartridge

3/4" Thermostatic mixer with 3-way diverter

- For horizontal installation
- 3/4" NPT inlets and 1/2" outlets
- With shut-off valve
- Sound insulation foam back
- Handles included
- 8.7 GPM @ 60 PSI (primary outlet)
- 7.4 GPM @ 60 PSI (secondary outlet)
- 7.4 GPM @ 60 PSI (third outlet)

Art. P272BU

Trim

Matte Gun Metal PVD 47 P5 P272BU

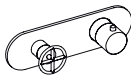

Art. D273AU

Rough

19 00 D273AU

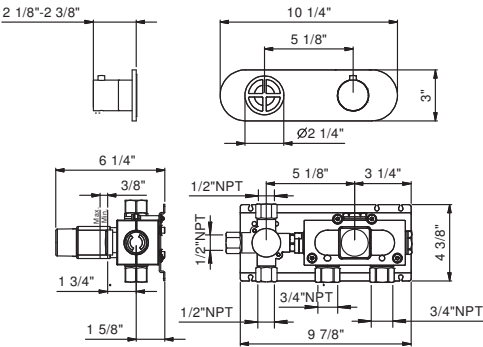
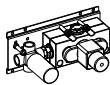

TOTAL PRICE

Matte Gun Metal PVD

3/4" Thermostatic mixer without volume control

- Sound insulation system
- 3/4" inlets
- Handle included
- 16.9 GPM @ 60 PSI

Select one or more stop valves (#P291BU+#D291AU or #P276BU+#D276AU or #P276BU+#D277AU)

Art. P200BU

Trim

Matte Gun Metal PVD 47 P5 P200BU



Art. D200BU

Rough

19 00 D200AU

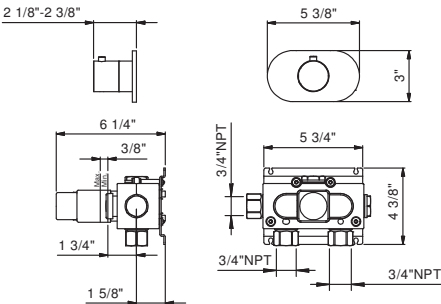

TOTAL PRICE

Matte Gun Metal PVD

SHOWER : thermostatic cartridge

3/4" Volume control

- For remote installation
- 3/4" NPT inlet and outlet
- Handle included
- Sound insulation foam back
- 15.3 GPM @ 60 PSI

To be used with thermostatic valve (#P200BU+#D200AU)

Art. P291BU

Trim

Matte Gun Metal PVD 47 P5 P291BU

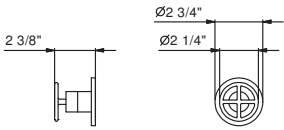

Art. D291AU

Rough

19 00 D291AU

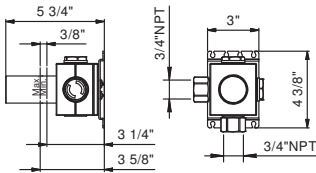

TOTAL PRICE

Matte Gun Metal PVD

2-Way diverter with integrated volume control

- For remote installation
- Round escutcheon
- 1/2" NPT inlets and outlets
- With shut-off valve
- Handle included
- 8.9 GPM @ 60 PSI (primary outlet)
- 7.6 GPM @ 60 PSI (secondary outlet)

To be used with thermostatic valve (#P200BU+#D200AU)

Art. P276BU

Trim

Matte Gun Metal PVD 47 P5 P276BU

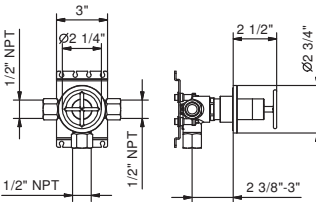

Art. D276AU

Rough

19 00 D276AU



TOTAL PRICE

Matte Gun Metal PVD

SHOWER : thermostatic cartridge

3-Way diverter with integrated volume control

- For remote installation
- Round escutcheon
- 1/2" NPT inlets and outlets
- With shut-off valve
- Handle included
- 8.7 GPM @ 60 PSI (primary outlet)
- 7.4 GPM @ 60 PSI (secondary outlet)
- 7.4 GPM @ 60 PSI (third outlet)

To be used with thermostatic valve (#P200BU+#D200AU)

Art. P276BU

Trim

Matte Gun Metal PVD 47 P5 P276BU



Art. D277AU

Rough

19 00 D277AU

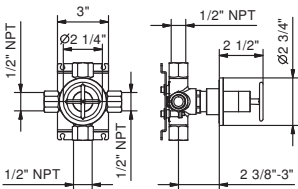

TOTAL PRICE

Matte Gun Metal PVD

SHOWER : complementary fittings

Art. 8106U

8" Round showerhead

- Anti-lime scale system
- Water flow restricted to 2.5 GPM

Shower arms for wall installation: #8028U, #8027U

Shower arms for ceiling installation: #9236U, #9237U

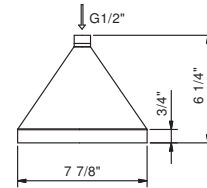
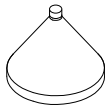

Matte Gun Metal PVD 47 P5 8106U

Art. 8106UC

8" Round showerhead

- Anti-lime scale system
- Water flow restricted to 1.8 GPM

Shower arms for wall installation: #8028U, #8027U

Shower arms for ceiling installation: #9236U, #9237U

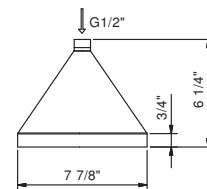
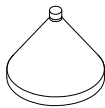

Matte Gun Metal PVD 47 P5 8106UC

Art. 8027U

11 3/4" Wall-mount shower arm

- Round escutcheon
- Curved angle
- 1/2" Male NPT fittings

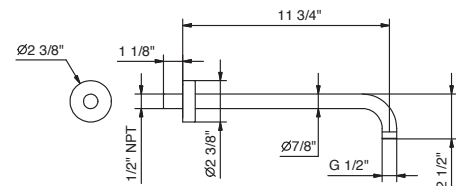
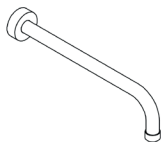

Matte Gun Metal PVD 47 P5 8027U

Art. 8028U

18" Wall-mount shower arm

- Round escutcheon
- Curved angle
- 1/2" Male NPT fittings

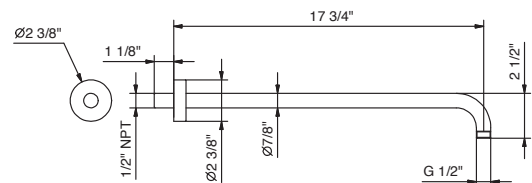
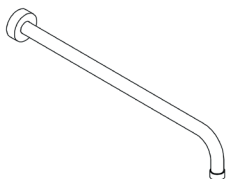

Matte Gun Metal PVD 47 P5 8028U

SHOWER : complementary fittings

Art. 9236U

10" Ceiling-mount shower arm

- Round escutcheon
- 1/2" Male NPT fittings



Matte Gun Metal PVD 47 P5 9236U

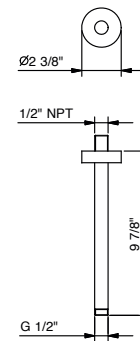

Art. 9237U

18" Ceiling-mount shower arm

- Round escutcheon
- 1/2" Male NPT fittings



Matte Gun Metal PVD 47 P5 9237U

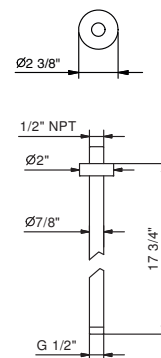

Art. 8093U

Wall-mount handshower set

- FIT handshower with anti-siphon check valve
- Anti-lime scale system
- 56" vinyl hose
- Water outlet with shower holder
- Round escutcheon
- 1/2" Male NPT fittings
- Water flow restricted to 1.8 GPM



Matte Gun Metal PVD 47 P5 8093U

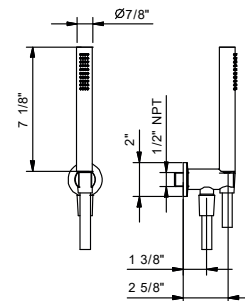

Wall-mount tub filler

- 5" spout projection
- Handles included
- 2-way diverter with turning knob
- FIT handshower
- 48" Vinyl hose
- Water plug with showerholder
- 1/2" inlets
- 10.35 GPM @ 60 PSI

Art. P019BU

Trim

Matte Gun Metal PVD 47 P5 P019BU

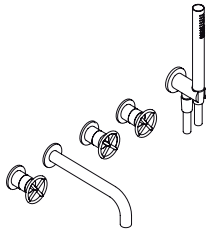

Art. P019AU

Rough

47 00 P019AU

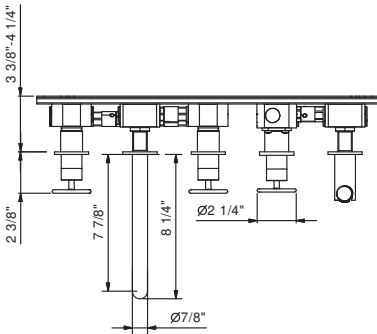
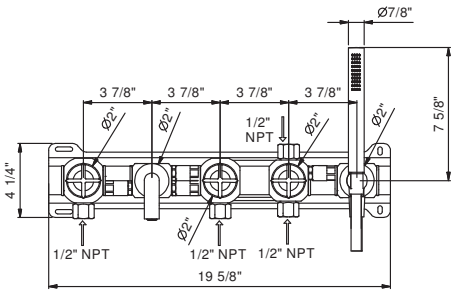
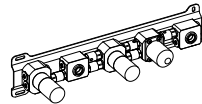

TOTAL PRICE

Matte Gun Metal PVD

Wall-mount tub filler

- Handles included
- 2-way diverter with turning knob
- FIT handshower
- 48" Vinyl hose
- Water plug with showerholder
- 1/2" inlets
- 10.80 GPM @ 60 PSI

Art. P017BU

Trim

Matte Gun Metal PVD 47 P5 P017BU

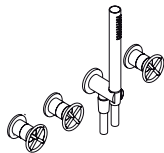

Art. P017AU

Rough

47 00 P017AU

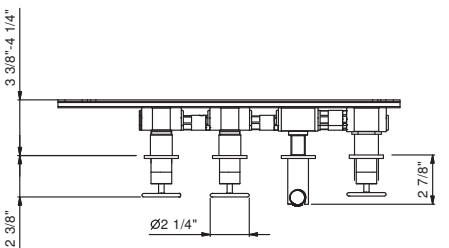
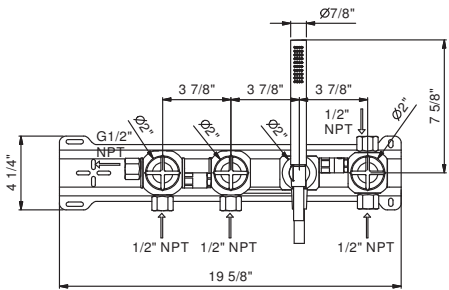
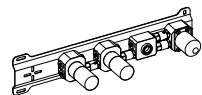

TOTAL PRICE

Matte Gun Metal PVD

TUB

Art. P065U

5-Hole Roman tub set

- 7 1/8" spout projection
- FIT handshower
- 2-way diverter with turning knob
- 58" metal hose
- 1/2" inlets
- 90° ceramic cartridge
- Handle included
- Water flow restricted to 1.8 GPM for handshower
- 7.9 GPM @ 60 PSI

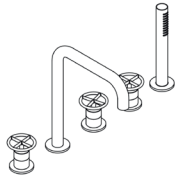

Matte Gun Metal PVD 47 P5 P065U

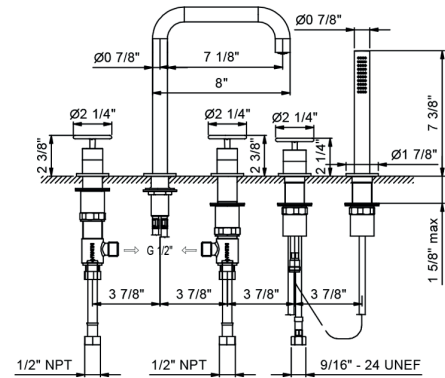

Art. 8453U

Wall-mount tub spout, 5 7/8" projection

- 1/2" NPT fittings
- Max 6.5 GPM @ 60 PSI
- Integrated aerator
- Round backplate

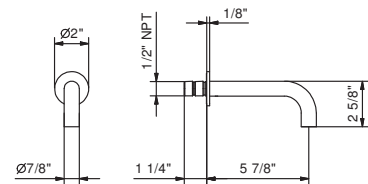

Matte Gun Metal PVD 47 P5 8453U

Art. 8454U

Wall-mount tub spout, 8" projection

- 1/2" NPT fittings
- Max 6.5 GPM @ 60 PSI
- Integrated aerator
- Round backplate

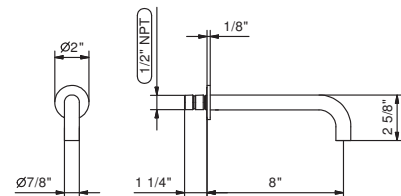

Matte Gun Metal PVD 47 P5 8454U

Extensions

Art. 8480 **1 3/8" Extension kit**
FONTANE BIANCHE Art. P291BU+D291AU

91 00 8480

Art. 8480/2 **3/4" Extension kit**
FONTANE BIANCHE Art. P291BU+D291AU

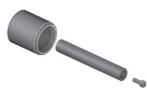

91 00 8480/2

Art. 8481 **1 3/8" Extension kit**
FONTANE BIANCHE Art. P231BU+D231AU

Matte Gun Metal PVD 91 P5 8481

Art. 8481/2 **3/4" Extension kit**
FONTANE BIANCHE Art. P231BU+D231AU



Matte Gun Metal PVD 91 P5 8481/2

Art. 8483 **1 3/8" Extension kit**
FONTANE BIANCHE Art. P272BU+D272AU - P272BU+D273AU

Matte Gun Metal PVD 91 P5 8483

Art. 8483/2 **3/4" Extension kit**
FONTANE BIANCHE Art. P272BU+D272AU - P272BU+D273AU

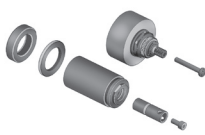

Matte Gun Metal PVD 91 P5 8483/2

Extensions

Art. 8484 **1 3/8" Extension kit**
FONTANE BIANCHE Art. P276BU+D276AU - P276BU+D277AU

91 00 8484

Art. 8484/2 **3/4" Extension kit**
FONTANE BIANCHE Art. P276BU+D276AU - P276BU+D277AU

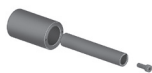

91 00 8484/2

Art. 8485 **3/4" Extension kit**
FONTANE BIANCHE Art. P017BU+P017AU - P019BU+P019AU

Matte Gun Metal PVD 91 P5 8485

Art. 8485/4 **1 1/2" Extension kit**
FONTANE BIANCHE Art. P017BU+P017AU - P019BU+P019AU



Matte Gun Metal PVD 91 P5 8485/4

Art. 8493 **3/4" Extension kit**
FONTANE BIANCHE Art. P063BU+M063AU - P110BU+M011AU - P113BU+M011AU

91 00 8493

Art. 8493/4 **1 1/2" Extension kit**
FONTANE BIANCHE Art. P063BU+M063AU - P110BU+M011AU - P113BU+M011AU



91 00 8493/4

Extensions

Art. 9736 **1 3/8" Extension kit**
FONTANE BIANCHE Art. P200BU+D200AU

Matte Gun Metal PVD 91 P5 9736

Art. 9736/2 **3/4" Extension kit**
FONTANE BIANCHE Art. P200BU+D200AU



Matte Gun Metal PVD 91 P5 9736/2

Art. W009 **3/4" Extension kit**
FONTANE BIANCHE Art. P010BU+R010AU - P013BU+R010AU

91 00 W009

Art. W009/4 **1 1/2" Extension kit**
FONTANE BIANCHE Art. P010BU+R010AU - P013BU+R010AU



91 00 W009/4

SHOWER SET EXAMPLES

Please note: Prices refer to Matte Gun Metal PVD finish

1

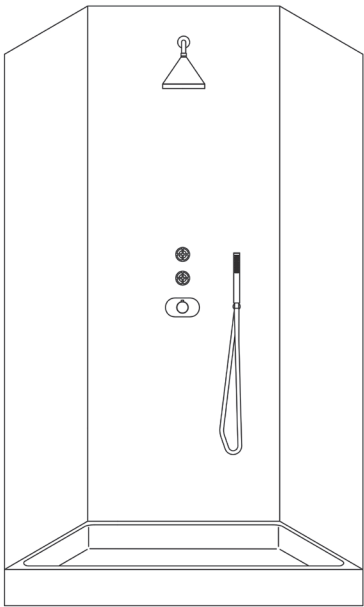

- 47 P5 8027U
- 47 P5 8106U
- 19 00 D291AU (x2)
- 19 00 D200AU
- 47 P5 8093U
- 47 P5 P200BU
- 47 P5 P291BU (x2)

2

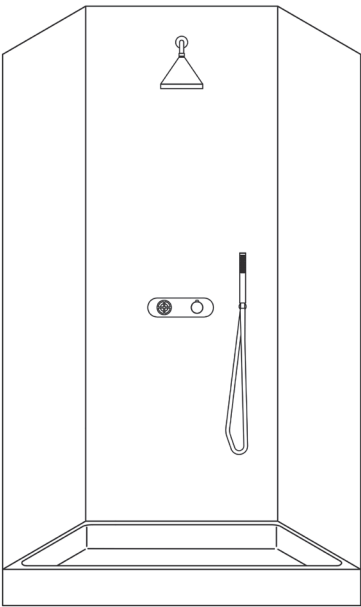

- 47 P5 8027U
- 47 P5 8106U
- 47 P5 8093U
- 47 P5 P272BU
- 19 00 D272AU

3

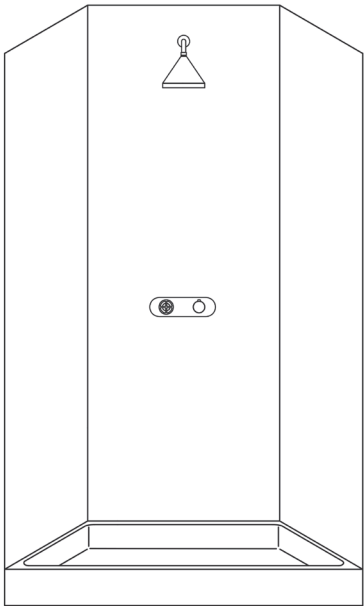

- 47 P5 8027U
- 47 P5 8106U
- 47 P5 P231BU
- 19 00 D231AU

Purchase terms

Orders: Once an order is placed, the customer has accepted all of the following conditions, and cannot be cancelled prior to written agreement with Fantini USA.

Prices: Prices shown in this Price Book are effective starting **June 15, 2021** and may be subject to change without notice.

Payments: Payments are due 30 days from the receipt of merchandise. Overdue invoices cause the account to be 'frozen', therefore all pending shipments will not be released and new orders will not be processed until the account is cleared.

Freight: Shipments are F.O.B. New York (NY). Orders will be delivered with customs, relating duties and brokerage charges prepaid by Fantini. All net orders exceeding \$1,900.00 are shipped free of charge. Orders less than \$1,900.00 will include on the invoice an additional \$15.00 or \$40.00 (based according to package size). Special requests for carriers and/or express deliveries should be discussed with a Fantini representative and/or our Customer service.

Deliveries: Fantini is not responsible for any delay due to conditions and circumstances beyond its control, such as strikes, fires, floods, material shortage, transportation accidents, natural disasters and/or any other unforeseen event.

Damage or loss: Once the carrier takes possession of the goods, it is his responsibility to deliver them in the same conditions as they were dispatched by Fantini to the carrier. Any loss or damage in transit must be reported within 48 hours to the carrier by the customer. Fantini will not be responsible for any damage or loss claims if the customer

fails to follow the above described procedure.

Claims: Shortage, defective and/or wrong material received, is considered a claim. In that event, all details must be noted on the bill of lading or delivery receipt and are to be reported to Fantini USA within 8 days. Customers are responsible for inspection of the goods at the time of delivery. A clean signed bill of lading or delivery receipt will constitute full acceptance by the customer and no claim will be accepted afterwards.

Labor: Fantini USA will not cover any kind of labor charges resulting from the sale, installation, use and replacement of its products.

Returns: Fontane Bianche product(s) are not eligible for return.

Warranty

WARRANTY

Fantini products carry the following limited warranty:

Residential installations

- 5 YEARS against all mechanical defects
- 1 YEAR on washbasin, bidet, bath and kitchen drains
- 5 YEARS on Chrome plating and PVD finishes

This warranty is non-transferable and only applies to the original purchaser starting from the date of purchase. All replaced products and parts under warranty are covered for an additional warranty period of 3 years from replacement.

Commercial, outdoor and marine installations

All products installed under one or more of these categories are covered by a limited warranty of a 1-YEAR period from the date of purchase.

This warranty is non-transferable and only applies to the original purchaser starting from the date of purchase.

All replaced products and parts replaced are warranted for an additional 1-YEAR period from the replacement date.

Limitations

The limited warranty does not apply to the following categories and circumstances:

1. Wrong and/or improper installation (only qualified plumbers/technicians are recommended)
2. Misuse or abuse
3. Accidental damages
4. Damages caused by the quality of the water (ex. hard water)
5. Damages to plated surfaces and/or mechanical failures resulting from proximity to salty water
6. Improper cleaning and maintenance (ex. use of abrasive cleaners or solvents)

Fantini USA does not honor its warranty and return policies if products are purchased online or from an unauthorized dealer. For any concerns or questions feel free to contact Customer Service at 212.308.8833.

FONTANE BIANCHE
SALVATORI +  **FANTINI**
DAL 1946 RUBINETTI

Fantini USA Inc.

A&D BUILDING - 150 East 58th Street, 8th floor - New York, NY 10155

Ph. 212 308 8833 - Fax 212 308 8820

www.fantiniusa.com - fantini@fantiniusa.com