



ART. E863B+M063A

UP-Brausemischer

- ZYLINDRISCHER Griff mit HEBEL
- 1/2" 1 Ausgang
- 1/2" Eingänge
- Schallschutz

Datum

Project/Kommentar

AP-Teil

- | | |
|---|-------------|
| <input type="checkbox"/> Chrom | 50 02 E863B |
| <input type="checkbox"/> Schwarz matt | 50 13 E863B |
| <input type="checkbox"/> Matt Gun Metal PVD | 50 P5 E863B |
| <input type="checkbox"/> Matt British Gold PVD | 50 P6 E863B |
| <input type="checkbox"/> Matt Copper PVD | 50 P9 E863B |
| <input type="checkbox"/> Deep Black PVD | 50 S1 E863B |
| <input type="checkbox"/> Mokka PVD | 50 S5 E863B |
| <input type="checkbox"/> Pure Brass PVD | 50 Q7 E863B |
| <input type="checkbox"/> Raw Metal PVD | 50 Q8 E863B |
| <input type="checkbox"/> Edelstahl gebürstet | 50 93 E863B |

UP-Teil

- | | |
|--------------------------|-------------|
| <input type="checkbox"/> | 44 00 M063A |
|--------------------------|-------------|

GESAMTPREIS

- | | |
|--|-------------|
| <input type="checkbox"/> Chrom | 50 02 E863B |
| <input type="checkbox"/> Schwarz matt | 50 13 E863B |
| <input type="checkbox"/> Matt Gun Metal PVD | 50 P5 E863B |
| <input type="checkbox"/> Matt British Gold PVD | 50 P6 E863B |
| <input type="checkbox"/> Matt Copper PVD | 50 P9 E863B |
| <input type="checkbox"/> Deep Black PVD | 50 S1 E863B |
| <input type="checkbox"/> Mokka PVD | 50 S5 E863B |
| <input type="checkbox"/> Pure Brass PVD | 50 Q7 E863B |
| <input type="checkbox"/> Raw Metal PVD | 50 Q8 E863B |
| <input type="checkbox"/> Edelstahl gebürstet | 50 93 E863B |

NOSTROMO SMALL

ART. E863B+M063A
UP-Brauseemischer

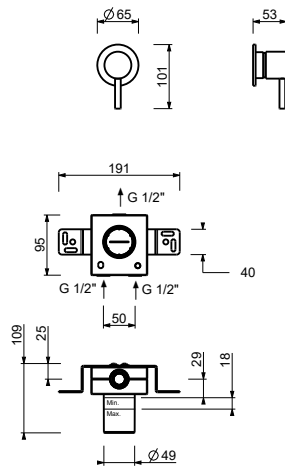

Abgang Nummer 1

Wasserdruck(bar)	Durchfluss (l/min)
0.5	8.31
1	13.58
2	18.83
3	23.86
4	27.6