



ART. L963B+M063A

Mitigeur douche à encastrer

- manette
- 1 sortie en 1/2"
- entrées en 1/2"
- isolation acoustique

Date _____

Projet/Commentaire _____

Partie externe

- | | |
|---|-------------|
| <input type="checkbox"/> Chromé | 58 02 L963B |
| <input type="checkbox"/> Noir Mat | 58 13 L963B |
| <input type="checkbox"/> Matt Gun Metal PVD | 58 P5 L963B |
| <input type="checkbox"/> Matt British Gold PVD | 58 P6 L963B |
| <input type="checkbox"/> Deep Black PVD | 58 S1 L963B |
| <input type="checkbox"/> Mokka PVD | 58 S5 L963B |
| <input type="checkbox"/> Brushed Steel Look PVD | 58 92 L963B |

PRIX TOTAL

- | | |
|---|-------------|
| <input type="checkbox"/> Chromé | 58 02 L963B |
| <input type="checkbox"/> Noir Mat | 58 13 L963B |
| <input type="checkbox"/> Matt Gun Metal PVD | 58 P5 L963B |
| <input type="checkbox"/> Matt British Gold PVD | 58 P6 L963B |
| <input type="checkbox"/> Deep Black PVD | 58 S1 L963B |
| <input type="checkbox"/> Mokka PVD | 58 S5 L963B |
| <input type="checkbox"/> Brushed Steel Look PVD | 58 92 L963B |

Piece Partie à encastrer

- | | |
|--------------------------|-------------|
| <input type="checkbox"/> | 44 00 M063A |
|--------------------------|-------------|

ART. L963B+M063A
Mitigeur douche à encastrer

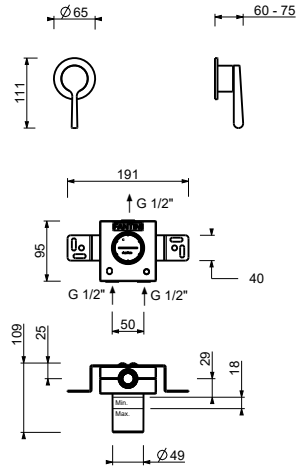

Sortie 1

Pression(bar)	Débit (l/min)
0.5	8.31
1	13.58
2	18.83
3	23.86
4	27.6