



ART. G783B+M063A

Mitigeur douche à encastrer

- manette
- 1 sortie en 1/2"
- entrées en 1/2"
- isolation acoustique

Date _____

Projet/Commentaire _____

Partie externe

- | | |
|--|-------------|
| <input type="checkbox"/> Chromé | 31 02 G783B |
| <input type="checkbox"/> Polished Nickel PVD | 31 95 G783B |
| <input type="checkbox"/> Matt Gun Metal PVD | 31 P5 G783B |
| <input type="checkbox"/> Matt British Gold PVD | 31 P6 G783B |
| <input type="checkbox"/> Matt Copper PVD | 31 P9 G783B |
| <input type="checkbox"/> Deep Black PVD | 31 S1 G783B |
| <input type="checkbox"/> Pure Brass PVD | 31 Q7 G783B |
| <input type="checkbox"/> Raw Metal PVD | 31 Q8 G783B |
| <input type="checkbox"/> Acier Brossé | 31 93 G783B |

Piece Partie à encastrer

- | | |
|--------------------------|-------------|
| <input type="checkbox"/> | 44 00 M063A |
|--------------------------|-------------|

PRIX TOTAL

- | | |
|--|-------------|
| <input type="checkbox"/> Chromé | 31 02 G783B |
| <input type="checkbox"/> Polished Nickel PVD | 31 95 G783B |
| <input type="checkbox"/> Matt Gun Metal PVD | 31 P5 G783B |
| <input type="checkbox"/> Matt British Gold PVD | 31 P6 G783B |
| <input type="checkbox"/> Matt Copper PVD | 31 P9 G783B |
| <input type="checkbox"/> Deep Black PVD | 31 S1 G783B |
| <input type="checkbox"/> Pure Brass PVD | 31 Q7 G783B |
| <input type="checkbox"/> Raw Metal PVD | 31 Q8 G783B |
| <input type="checkbox"/> Acier Brossé | 31 93 G783B |

ART. G783B+M063A
Mitigeur douche à encastrer

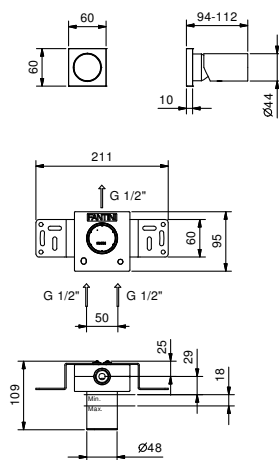

Sortie 1

| Pression(bar) | Débit (l/min) |
|---------------|---------------|
| 0.5 | 8.31 |
| 1 | 13.58 |
| 2 | 18.83 |
| 3 | 23.86 |
| 4 | 27.6 |