



ART. G783B+M063A

Monomando ducha empotrado

- maneta
- 1 salida de 1/2"
- entradas de 1/2"
- aislamiento acústico

Fecha

Proyecto/Comentarios

Parte externa

- | | |
|---|-------------|
| <input type="checkbox"/> Cromo | 31 02 G783B |
| <input type="checkbox"/> Polished Nickel PVD | 31 95 G783B |
| <input type="checkbox"/> Matt Gun Metal PVD | 31 P5 G783B |
| <input type="checkbox"/> Matt British Gold PVD | 31 P6 G783B |
| <input type="checkbox"/> Matt Copper PVD | 31 P9 G783B |
| <input type="checkbox"/> Deep Black PVD | 31 S1 G783B |
| <input type="checkbox"/> Pure Brass PVD | 31 Q7 G783B |
| <input type="checkbox"/> Raw Metal PVD | 31 Q8 G783B |
| <input type="checkbox"/> Acero Cepillado | 31 93 G783B |

Parte empotrable

- | | |
|--------------------------|-------------|
| <input type="checkbox"/> | 44 00 M063A |
|--------------------------|-------------|

PRECIO TOTAL

- | | |
|--|-------------|
| <input type="checkbox"/> Cromo | 31 02 G783B |
| <input type="checkbox"/> Polished Nickel PVD | 31 95 G783B |
| <input type="checkbox"/> Matt Gun Metal PVD | 31 P5 G783B |
| <input type="checkbox"/> Matt British Gold PVD | 31 P6 G783B |
| <input type="checkbox"/> Matt Copper PVD | 31 P9 G783B |
| <input type="checkbox"/> Deep Black PVD | 31 S1 G783B |
| <input type="checkbox"/> Pure Brass PVD | 31 Q7 G783B |
| <input type="checkbox"/> Raw Metal PVD | 31 Q8 G783B |
| <input type="checkbox"/> Acero Cepillado | 31 93 G783B |

ART. G783B+M063A
Monomando ducha empotrado

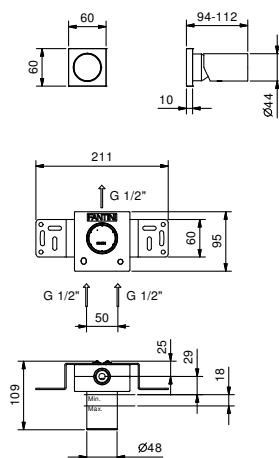

Salida 1

Presión(bar)	Caudal (l/min)
0.5	8.31
1	13.58
2	18.83
3	23.86
4	27.6