



ART. G783B+M063A

UP-Brausemischer

- Griff
- 1/2" 1 Ausgang
- 1/2" Eingänge
- Schallschutz

Datum

Project/Kommentar

AP-Teil

- | | |
|---|-------------|
| <input type="checkbox"/> Chrom | 31 02 G783B |
| <input type="checkbox"/> Polished Nickel PVD | 31 95 G783B |
| <input type="checkbox"/> Matt Gun Metal PVD | 31 P5 G783B |
| <input type="checkbox"/> Matt British Gold PVD | 31 P6 G783B |
| <input type="checkbox"/> Matt Copper PVD | 31 P9 G783B |
| <input type="checkbox"/> Deep Black PVD | 31 S1 G783B |
| <input type="checkbox"/> Pure Brass PVD | 31 Q7 G783B |
| <input type="checkbox"/> Raw Metal PVD | 31 Q8 G783B |
| <input type="checkbox"/> Edelstahl gebürstet | 31 93 G783B |

UP-Teil

- | | |
|--------------------------|-------------|
| <input type="checkbox"/> | 44 00 M063A |
|--------------------------|-------------|

GESAMTPREIS

- | | |
|--|-------------|
| <input type="checkbox"/> Chrom | 31 02 G783B |
| <input type="checkbox"/> Polished Nickel PVD | 31 95 G783B |
| <input type="checkbox"/> Matt Gun Metal PVD | 31 P5 G783B |
| <input type="checkbox"/> Matt British Gold PVD | 31 P6 G783B |
| <input type="checkbox"/> Matt Copper PVD | 31 P9 G783B |
| <input type="checkbox"/> Deep Black PVD | 31 S1 G783B |
| <input type="checkbox"/> Pure Brass PVD | 31 Q7 G783B |
| <input type="checkbox"/> Raw Metal PVD | 31 Q8 G783B |
| <input type="checkbox"/> Edelstahl gebürstet | 31 93 G783B |

ART. G783B+M063A
UP-Brauseemischer

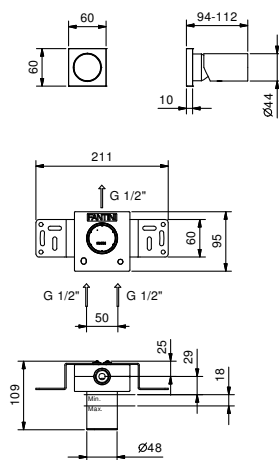

Abgang Nummer 1

Wasserdruck(bar)	Durchfluss (l/min)
0.5	8.31
1	13.58
2	18.83
3	23.86
4	27.6