

## ART. H772B+H572A

### Monomando termostático ducha empotrado 3/4"

- maneta
- botones ON/OFF con ajuste de caudal
- aislamiento acústico
- solo para montaje horizontal
- entradas de 3/4"
- 2 salidas de 1/2"

### Fecha

---

### Proyecto/Comentarios

---



---



---



---



---



---



---

#### Parte externa

- |   |             |
|---|-------------|
| <input type="checkbox"/> Cromo                  | 87 02 H772B |
| <input type="checkbox"/> Matt Gun Metal PVD     | 87 P5 H772B |
| <input type="checkbox"/> Matt British Gold PVD  | 87 P6 H772B |
| <input type="checkbox"/> Deep Black PVD         | 87 S1 H772B |
| <input type="checkbox"/> Mokka PVD              | 87 S5 H772B |
| <input type="checkbox"/> Brushed Steel Look PVD | 87 92 H772B |

#### Parte empotrable

- |                          |             |
|--------------------------|-------------|
| <input type="checkbox"/> | 44 00 H572A |
|--------------------------|-------------|

#### PRECIO TOTAL

- |   |             |
|---|-------------|
| <input type="checkbox"/> Cromo                  | 87 02 H772B |
| <input type="checkbox"/> Matt Gun Metal PVD     | 87 P5 H772B |
| <input type="checkbox"/> Matt British Gold PVD  | 87 P6 H772B |
| <input type="checkbox"/> Deep Black PVD         | 87 S1 H772B |
| <input type="checkbox"/> Mokka PVD              | 87 S5 H772B |
| <input type="checkbox"/> Brushed Steel Look PVD | 87 92 H772B |

## ART. H772B+H572A

Monomando termostático ducha empotrado 3/4"

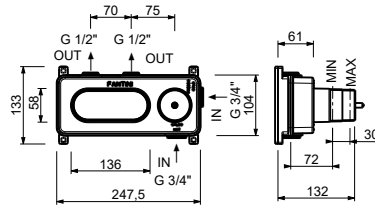
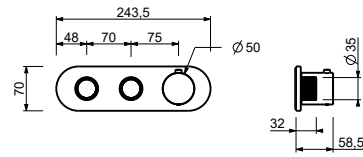

### Salida 1

Presión(bar)	Caudal (l/min)
0.5	5.81
1	9.1
2	13.5
3	16.5
4	19.3

### Salida 2

Presión(bar)	Caudal (l/min)
0.5	5.3
1	8.5
2	12.8
3	15.6
4	18.5