

## ART. H572B+H572A

### Miscelatore termostatico doccia incasso 3/4"

- con maniglia
- pulsanti ON/OFF con regolazione di portata
- isolamento acustico
- solo per montaggio orizzontale
- ingressi da 3/4"
- 2 uscite da 1/2"

### Data

---

### Progetto/Note

---



---



---



---



---



---



---

#### Parte esterna

- |  |             |
|--|-------------|
| <input type="checkbox"/> Cromo                 | 87 02 H572B |
| <input type="checkbox"/> Matt Gun Metal PVD    | 87 P5 H572B |
| <input type="checkbox"/> Matt British Gold PVD | 87 P6 H572B |
| <input type="checkbox"/> Deep Black PVD        | 87 S1 H572B |

#### Parte da incasso

- |                          |             |
|--------------------------|-------------|
| <input type="checkbox"/> | 44 00 H572A |
|--------------------------|-------------|

#### Prezzo totale

- |  |             |
|--|-------------|
| <input type="checkbox"/> Cromo                 | 87 02 H572B |
| <input type="checkbox"/> Matt Gun Metal PVD    | 87 P5 H572B |
| <input type="checkbox"/> Matt British Gold PVD | 87 P6 H572B |
| <input type="checkbox"/> Deep Black PVD        | 87 S1 H572B |

## ART. H572B+H572A

Miscelatore termostatico doccia incasso 3/4"

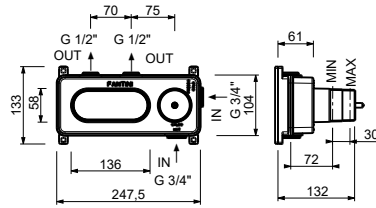
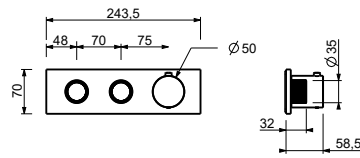

### USCITA 1

| Pressione(bar) | Portata (l/min) |
|----------------|-----------------|
| 0.5            | 5.81            |
| 1              | 9.1             |
| 2              | 13.5            |
| 3              | 16.5            |
| 4              | 19.3            |

### USCITA 2

| Pressione(bar) | Portata (l/min) |
|----------------|-----------------|
| 0.5            | 5.3             |
| 1              | 8.5             |
| 2              | 12.8            |
| 3              | 15.6            |
| 4              | 18.5            |