

# Meridian Home Design

1,793 Sq. Ft. | 3 Bed | 2 Bath | 2.5 Bay Garage | +Flex



EXTERIOR STYLE J



EXTERIOR STYLE L



OPT. 4 PANEL SLIDING GLASS DOORS

OPT. FIREPLACE

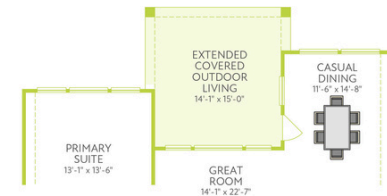

OPT. EXTENDED COVERED OUTDOOR LIVING



OPT. GOURMET KITCHEN

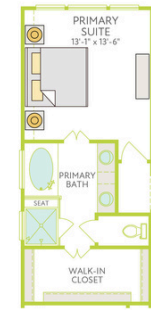

OPT. PRIMARY BATH TUB

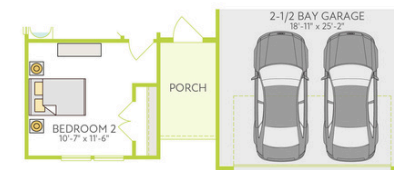

FLOOR PLAN - EXTERIOR STYLE C

Life-changing by Design™

The prices of our homes, included features, plans, specifications, promotions/incentives, neighborhood build-out and available locations are subject to change without notice. Stated dimensions, square footage and acreage are approximate and should not be used as a representation of any home's or homesite's precise or actual size, location or orientation. There is no guarantee that any particular homesite or home will be available. No information or material herein is to be construed to be an offer or solicitation for sale. A Broker/Agent must register their client in person on client's first visit at each community for a Broker/Agent to receive a commission or referral fee, if available. Not all features and options are available in all homes. Unless otherwise expressly stated, homes do not come with hardscape, landscape, or other decorator items. Any photographs or renderings used herein reflect artists' conceptions and are for illustrative purposes only. Community maps, illustrations, plans and/or amenities reflect our current vision and are subject to change without notice. Maps not to scale. Our name and the logos contained herein are registered trademarks of Tri Pointe Homes, Inc. and/or its subsidiaries. © 2024 Tri Pointe Homes Texas, Inc. All rights reserved.