

C4 1964 Valve Body
 Use "SK 4" Shift Kit®
 No HD kit for 64 VB

**C4 Casting Number
 On Valve Body/**

LISTEN UP: Install all the end plate bolts loosely. **LAST THING:** Tighten plate bolts.

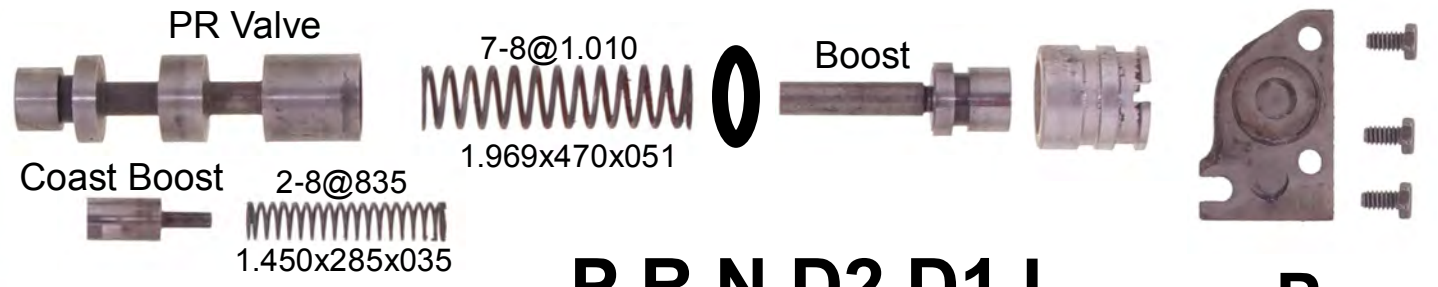
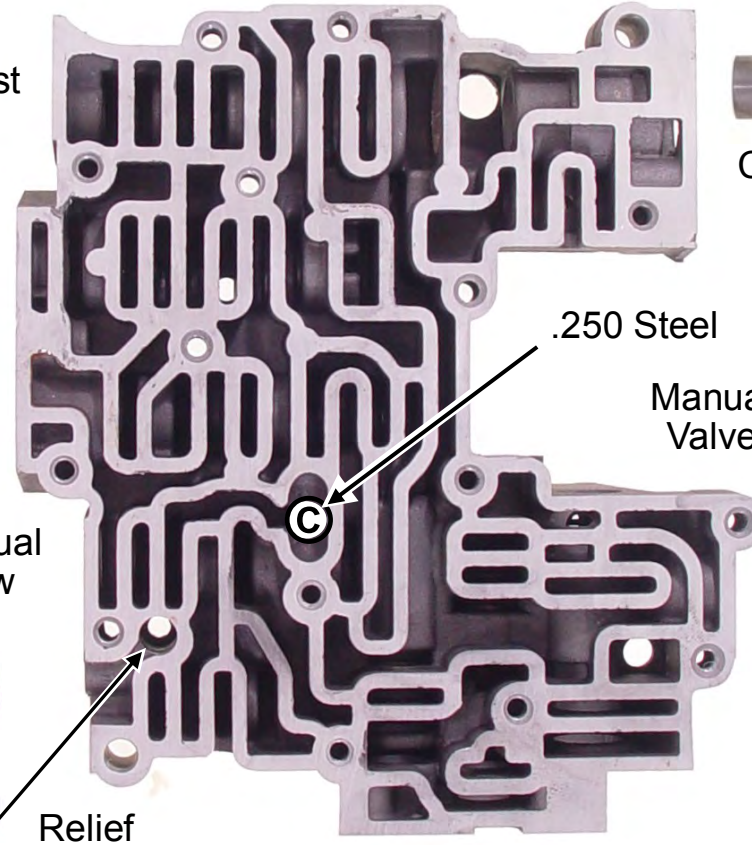
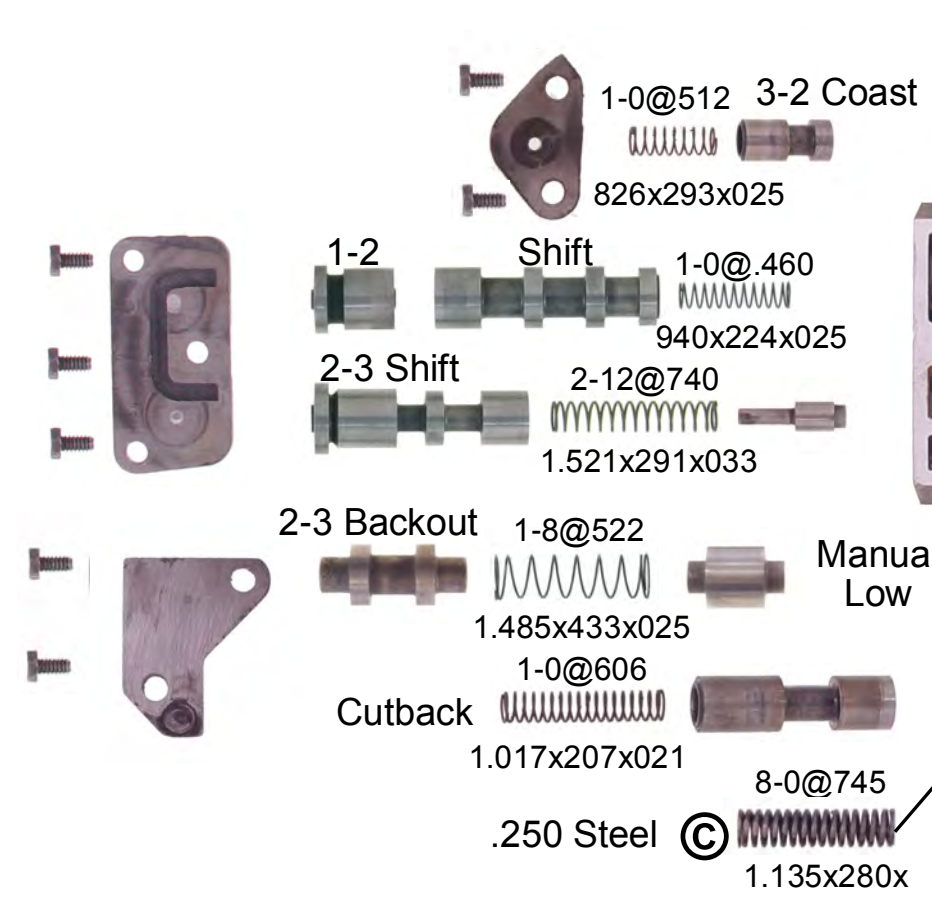

P R N D2 D1 L

D2 Starts in 2nd. Shifts to 3rd
 Kickdown to 2nd but not to first.

D1 Starts in 1st and shifts 1-2 & 2-3
 Kickdown to 2nd or 1st speed dependent.

**P
 R
 N
 D2
 D1
 L**

**Has: Hole Thru Manual Valve
 No Puck in Valve Body**

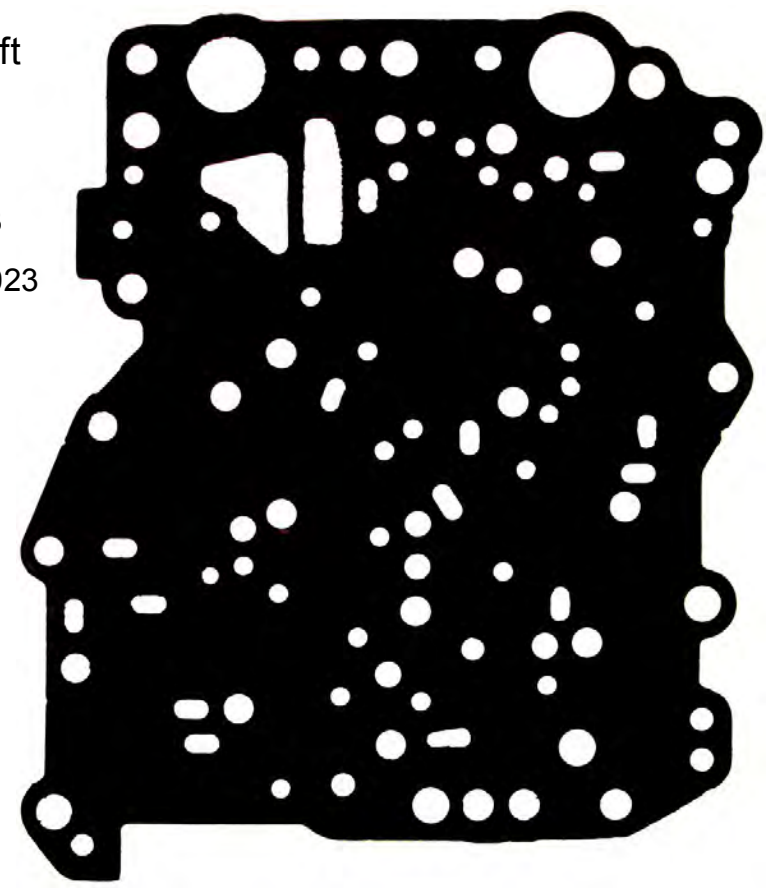
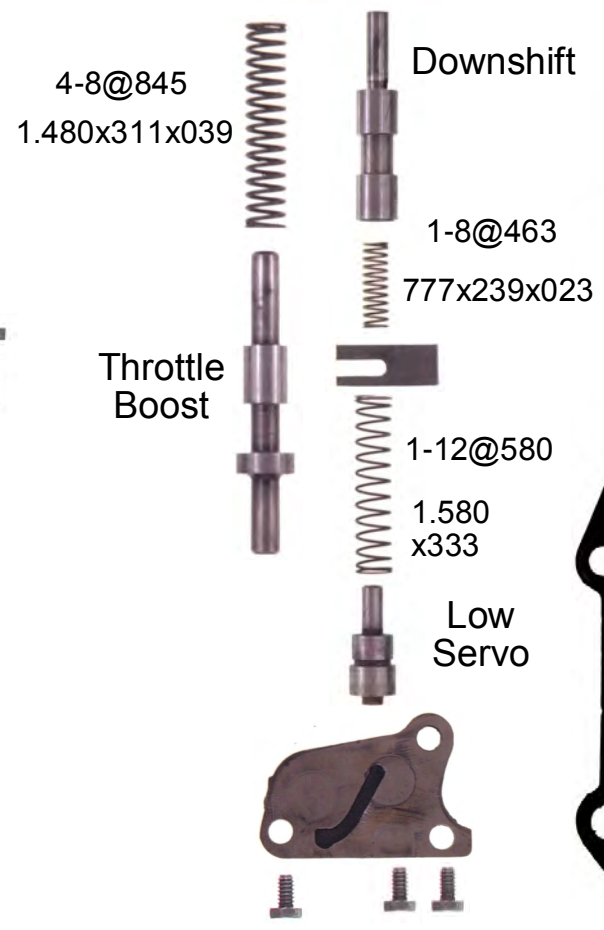
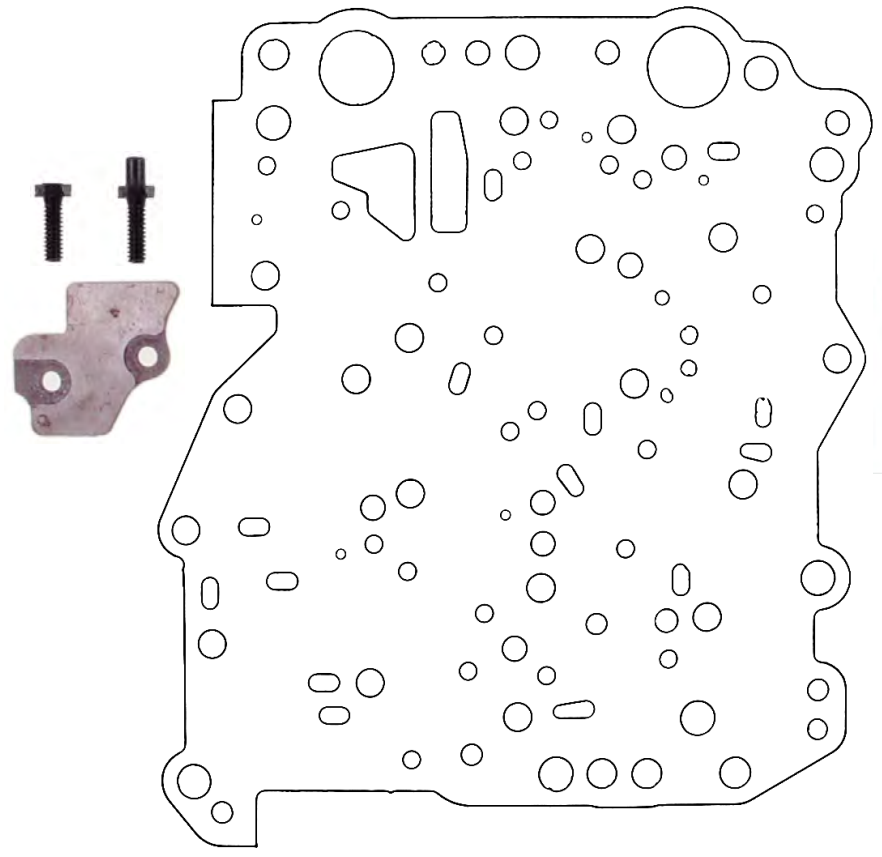

C4 64-66 Valve Body Use "SK 4L"
Shift Kit® Use "45-01" HD Kit

C5 Casting Number
On Valve Body/

LISTEN UP: Install all the end plate bolts loosely. **LAST THING:** Tighten plate bolts.

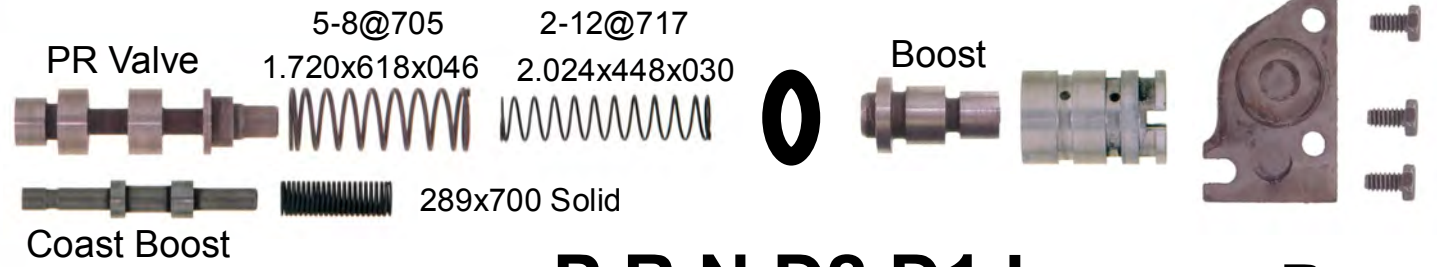
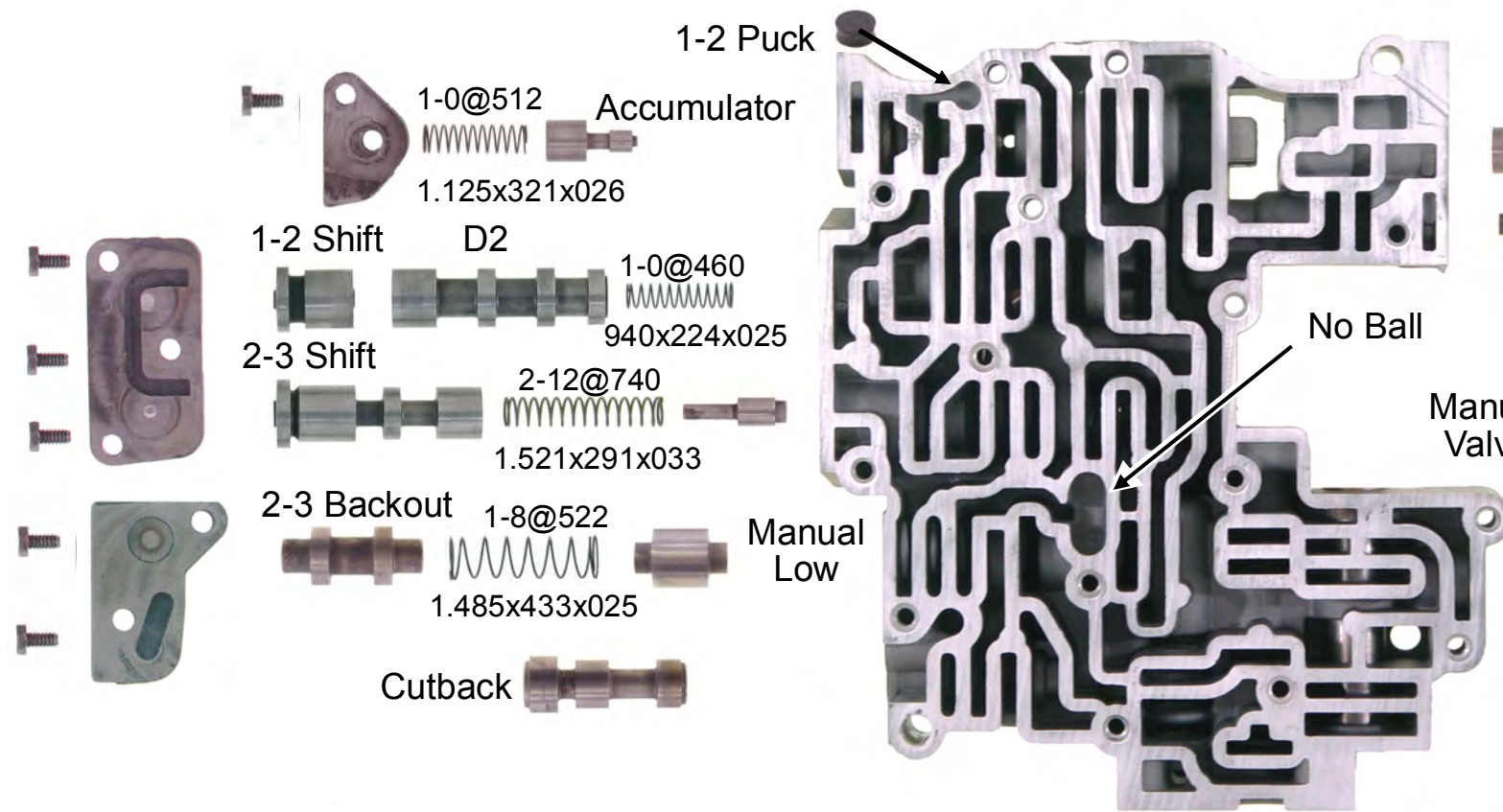

P R N D2 D1 L

D2 Starts in 2nd. Shifts to 3rd
Kickdown to 2nd but not to first.

D1 Starts in 1st and shifts 1-2 & 2-3
Kickdown to 2nd or 1st speed dependent.

L Starts off and stays in Low [1st]

**P
R
N
D2
D1
L**

**Has: Hole Thru Manual Valve
No Check Balls in Valve Body**

No Ball

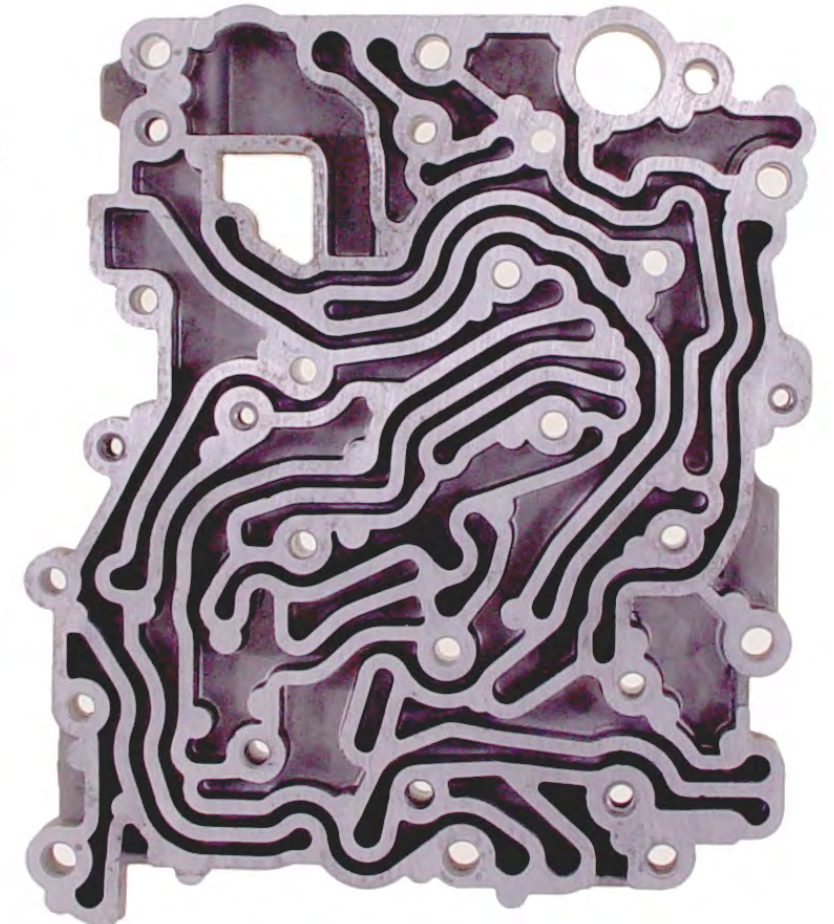
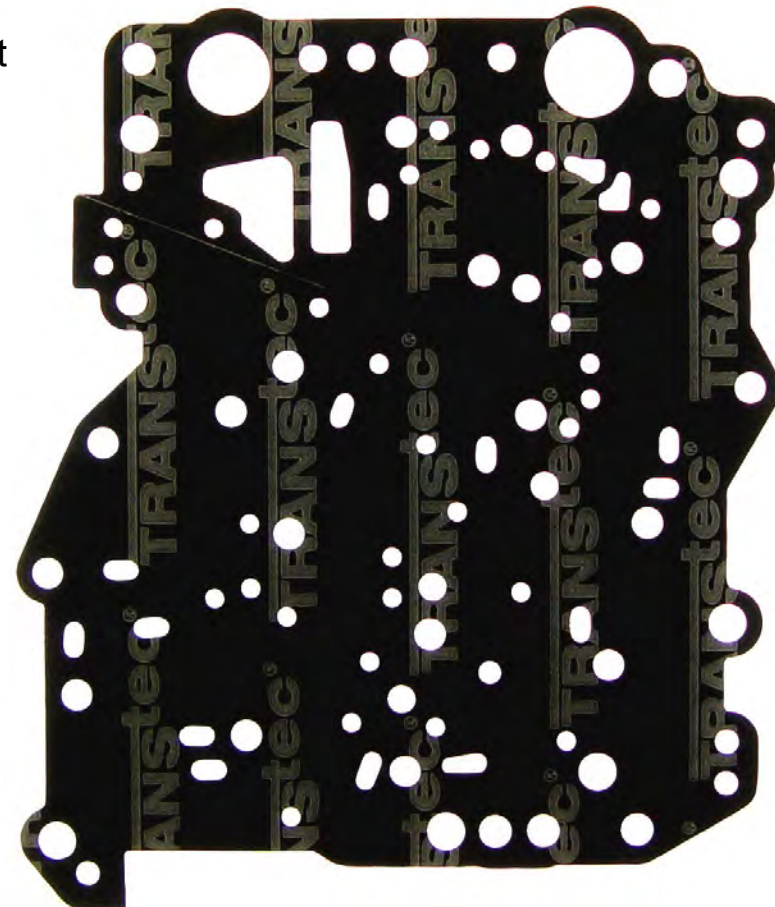
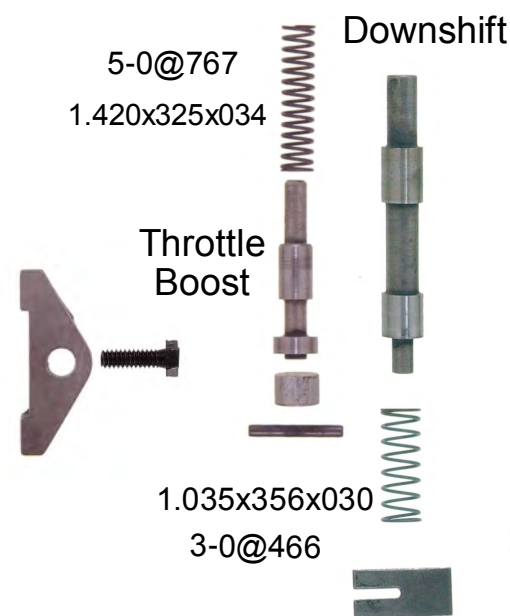
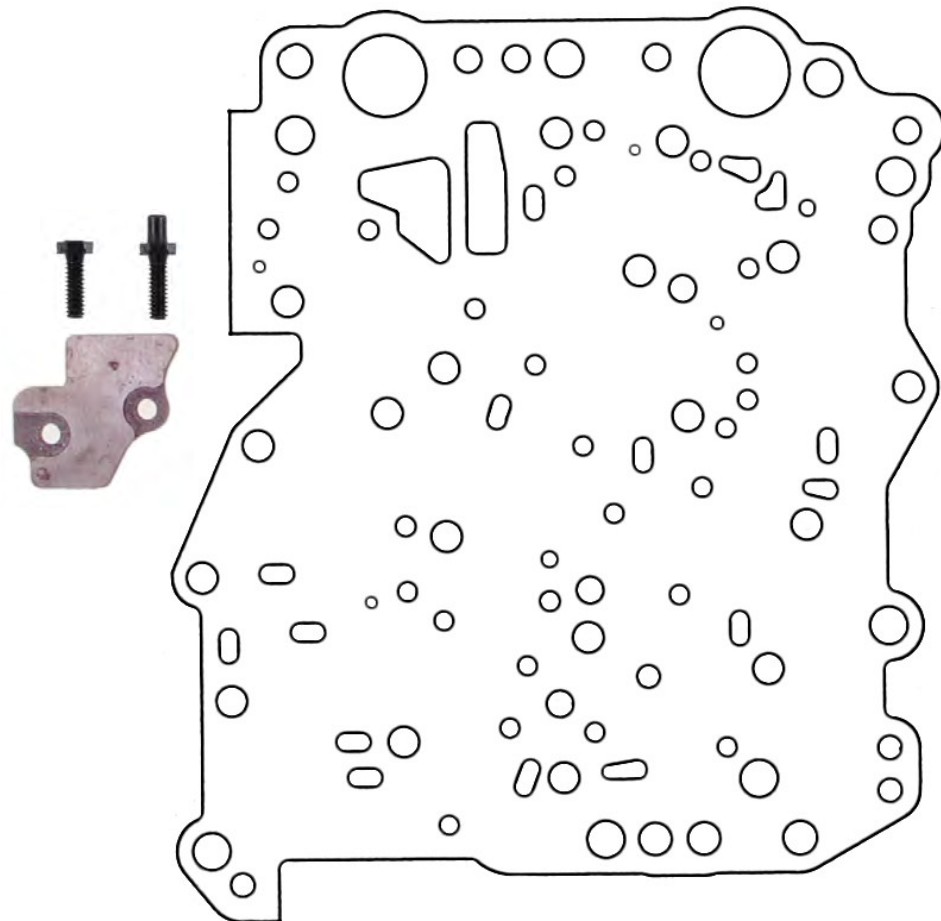

C4 67- 69 Valve Body
 Use "SK 4S" Shift Kit® for 6 cylinder
 Use "SK 4SL" Shift Kit® for 8 cylinder
 Use "47-1", "47-2" or "47-3" HD kit

**C7 Casting Number
 On Valve Body/Channel**

LISTEN UP: Install all the end plate bolts loosely. **LAST THING:** Tighten plate bolts.

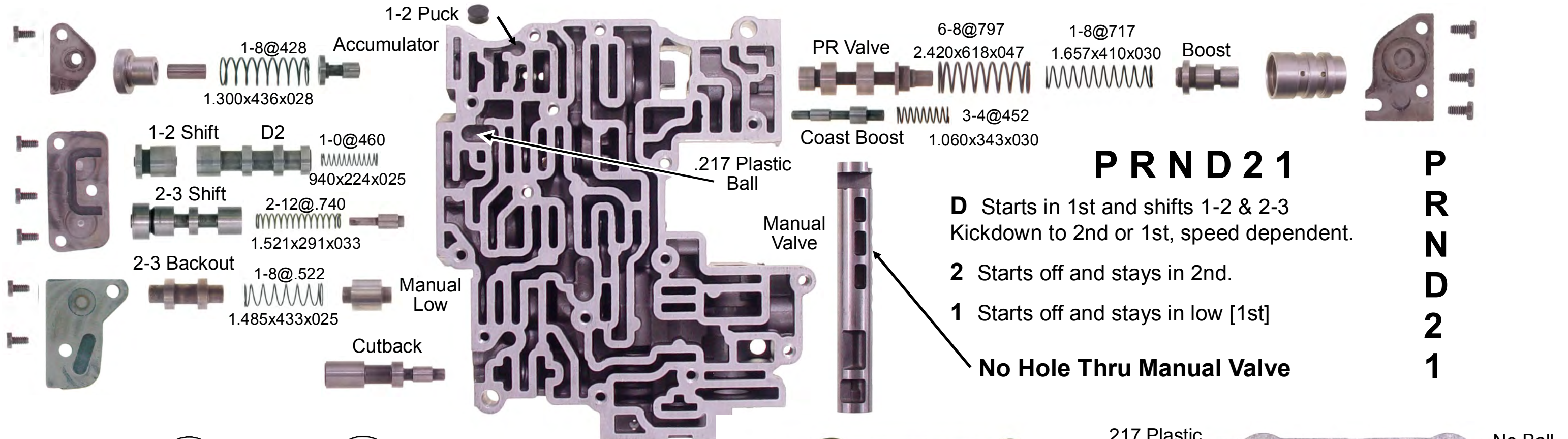

P R N D 2 1

- D** Starts in 1st and shifts 1-2 & 2-3 Kickdown to 2nd or 1st, speed dependent.
- 2** Starts off and stays in 2nd.
- 1** Starts off and stays in low [1st]

**P
R
N
D
2
1**

No Hole Thru Manual Valve

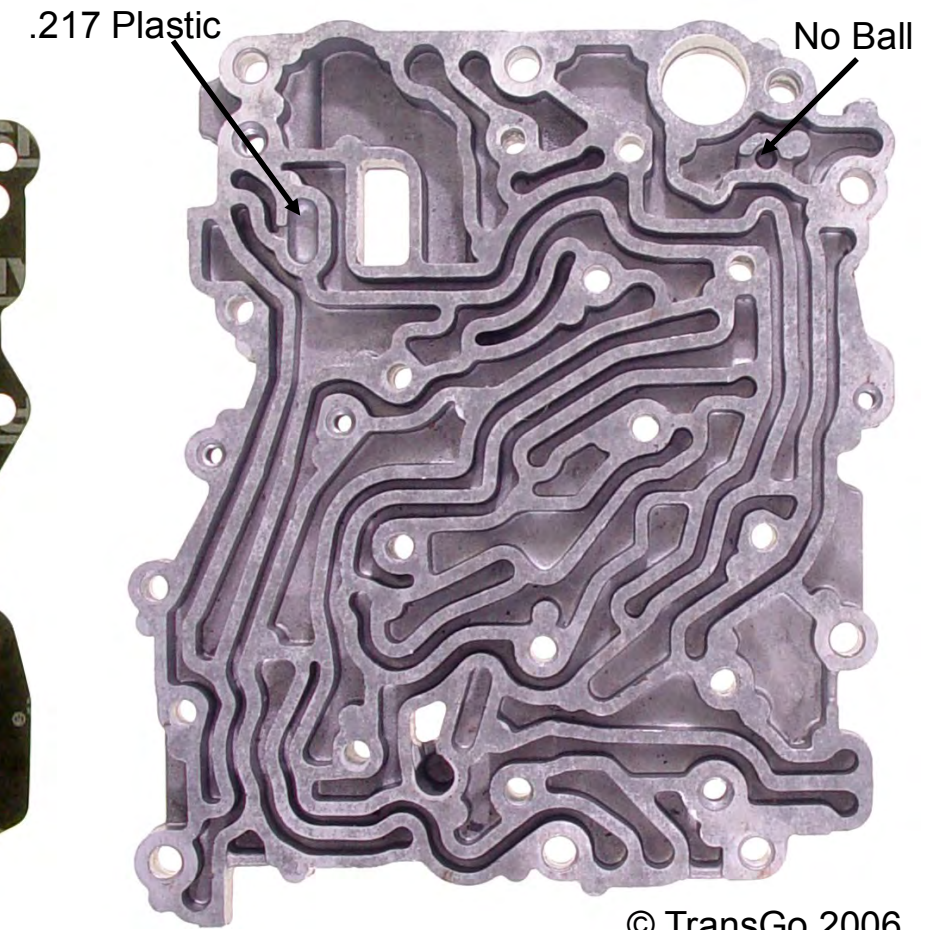
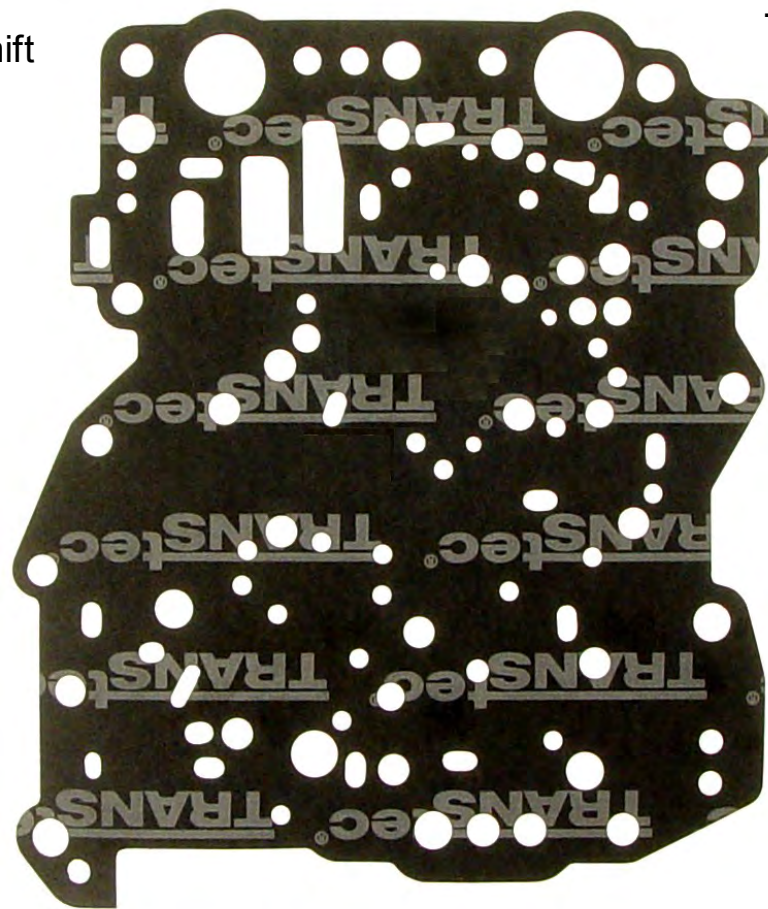
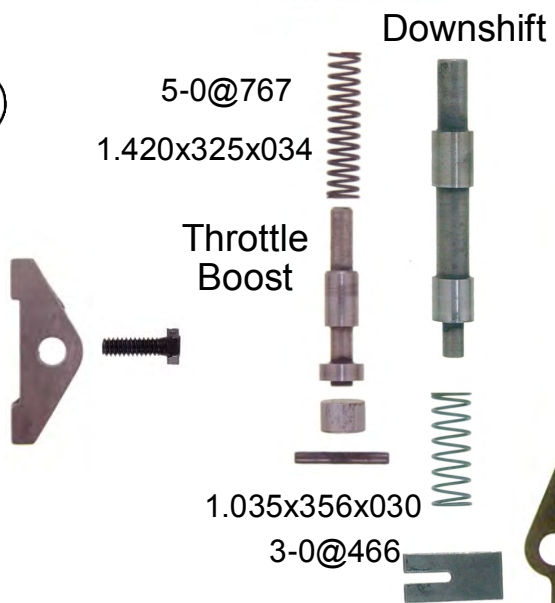
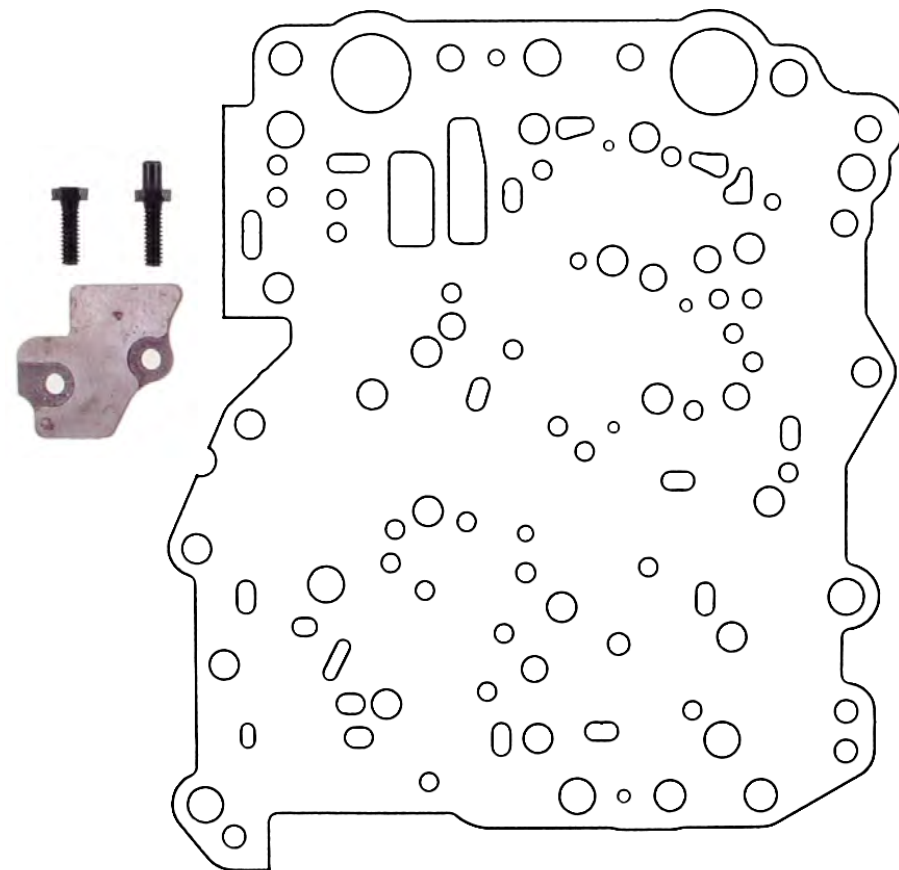

C4 70-72 Valve Body with Screw in Modulator Use "SK 4-71" Shift Kit® or "40-2" or "40-3" Reprogramming Kit™
 C4 71-77 Valve Body with push in Modulator Use "SK C5" Shift Kit® or "40-2" or "40-3" Reprogramming Kit™

D0 to D7 Casting Number
 On Valve Body/Channel

LISTEN UP: Install all the end plate bolts loosely. **LAST THING:** Tighten plate bolts.

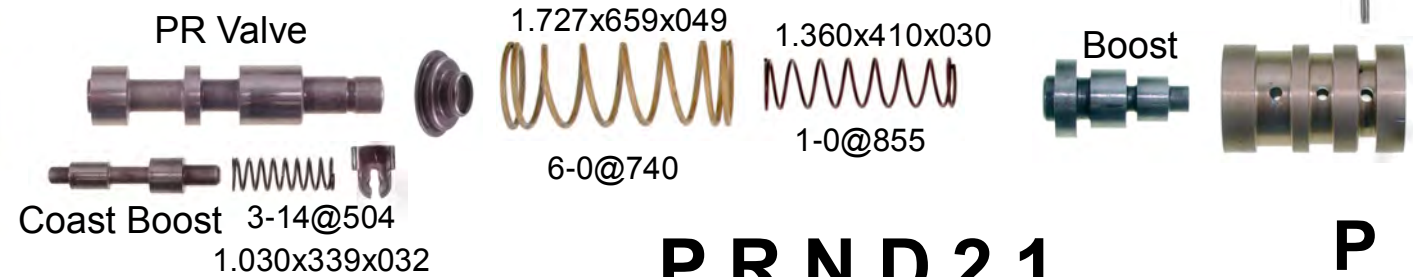
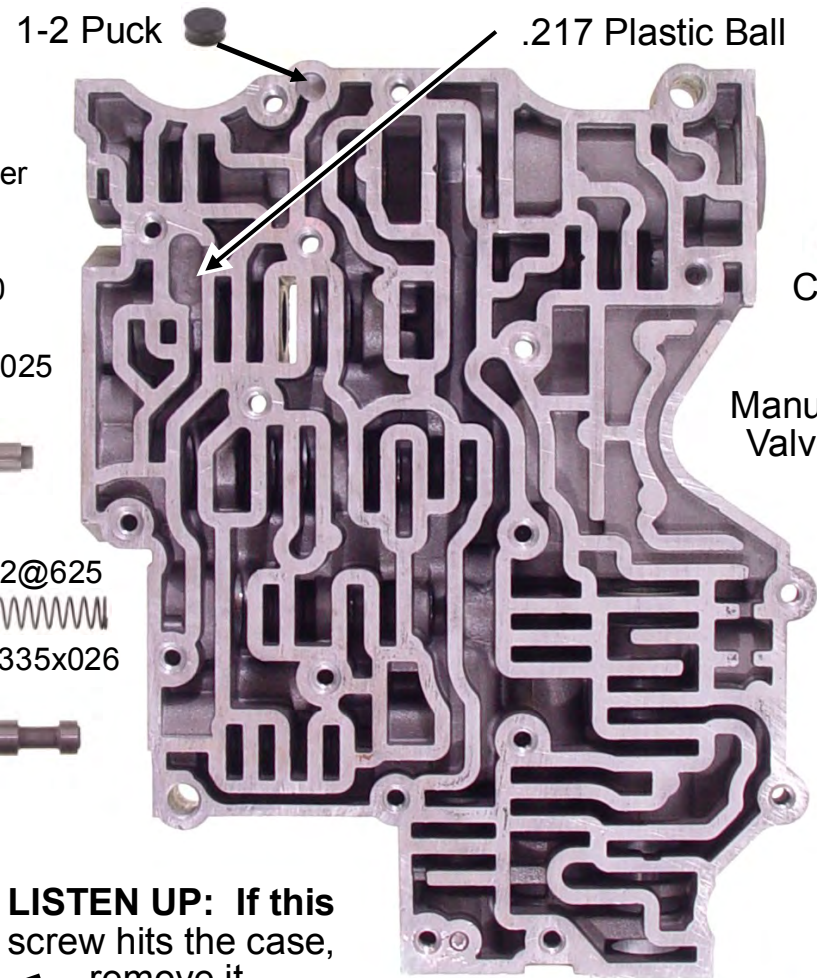
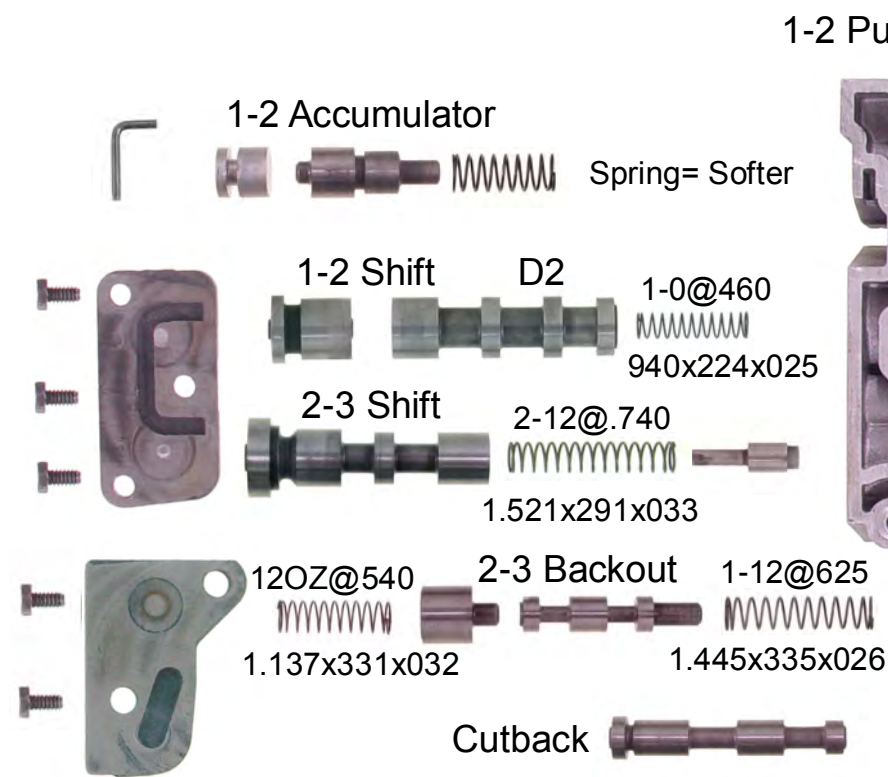

PRND21

D Starts in 1st and shifts 1-2 & 2-3.
 Kickdown to 2nd or 1st, speed dependent.

2 Starts off and stays in 2nd.

1 Starts off and stays in Low [1st]

**P
R
N
D
2
1**

Spindle Type Manual Valve

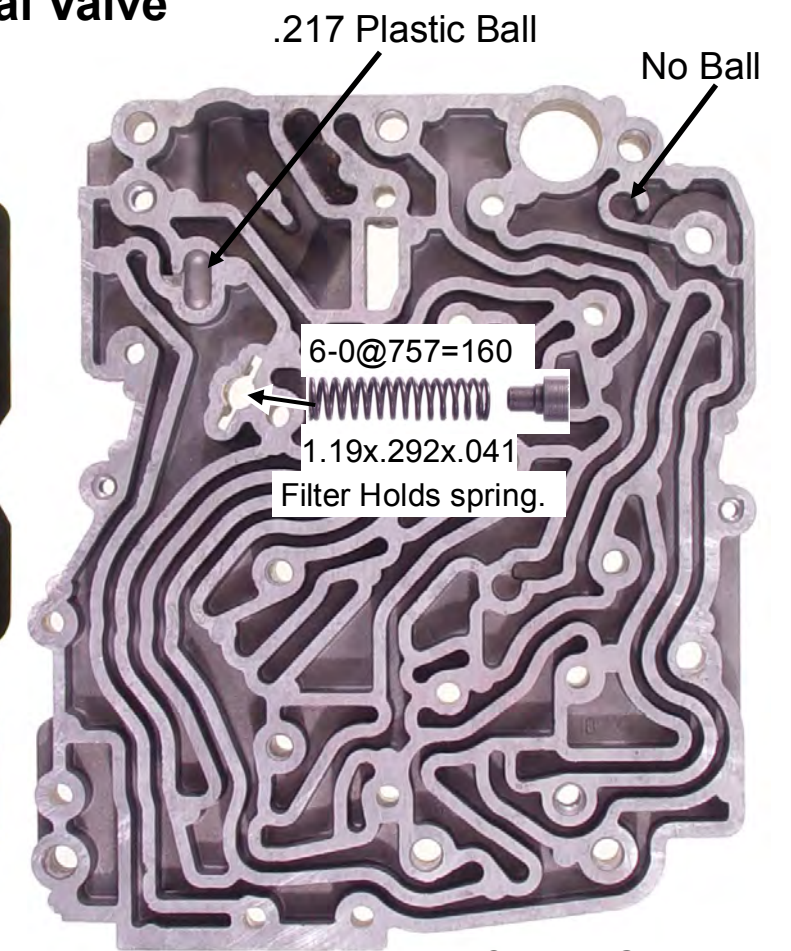
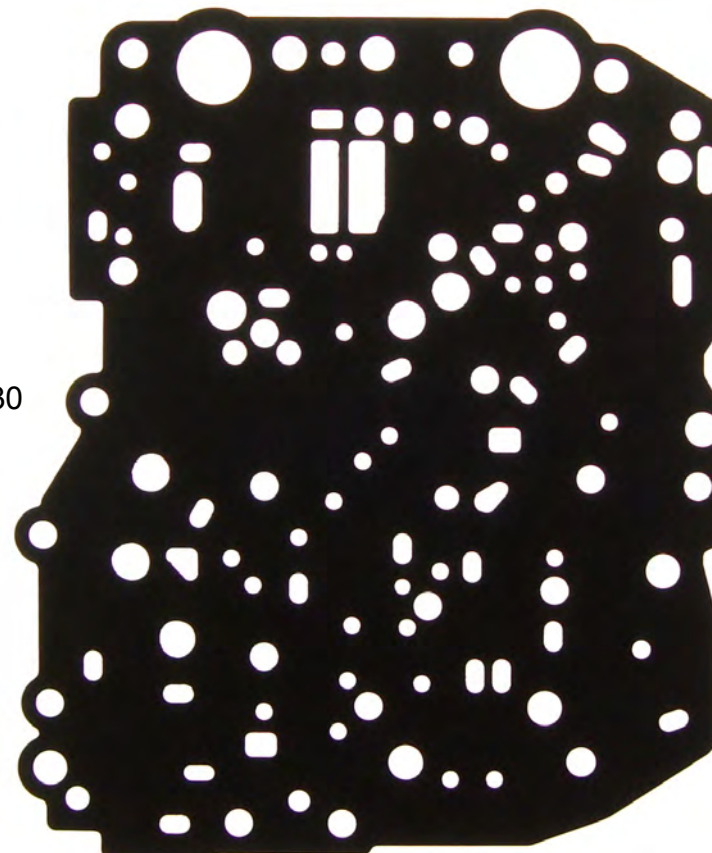
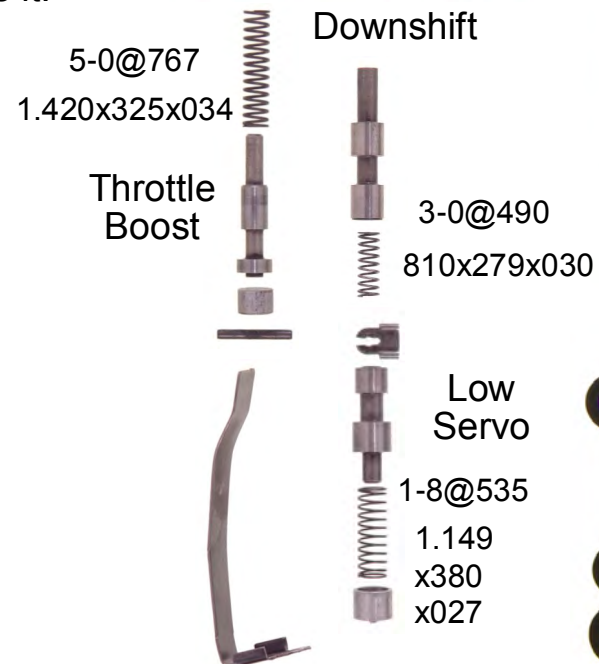
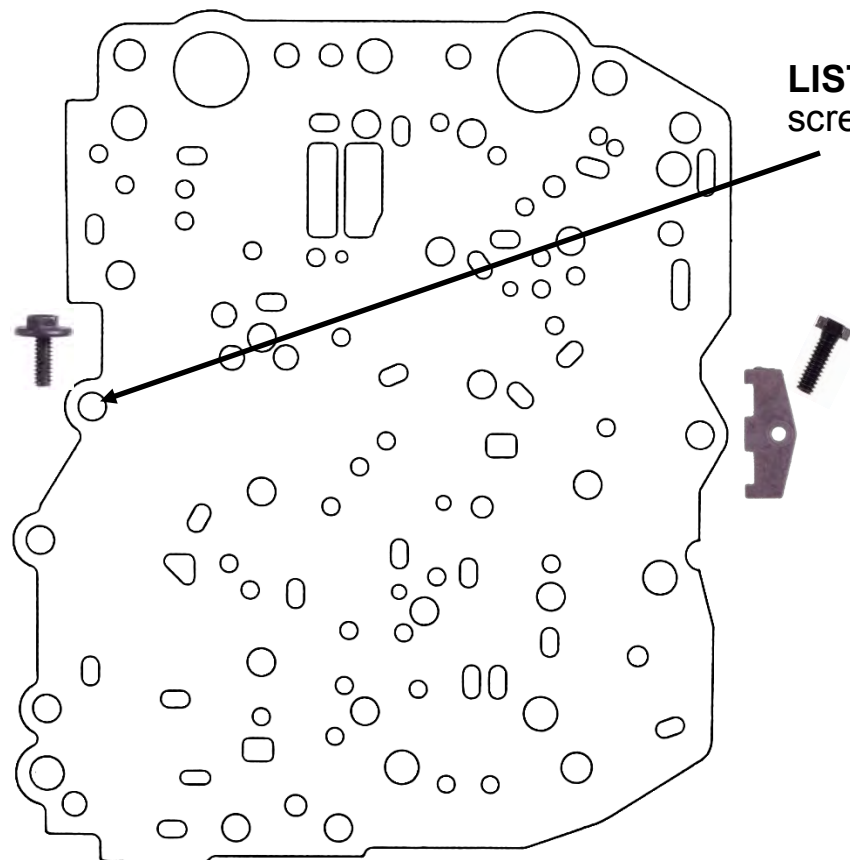

All 78up Valve Body (casting # D8-E2) (models with 1 bolt holding filter on) use "SK C5" Shift Kit® No reprogramming kit™ available.

D8 to E2 Casting Number On Valve Body/Channel

LISTEN UP: Install all the end plate bolts loosely. **LAST THING:** Tighten plate bolts.

