

JF011E-FC (Flow Control Valve Repair)

Prevents-Corrects-Reduces

No Movement, Falls out of gear at idle, Shudder with throttle. Limp-in with pressure codes set.

Note: Complaints of "Surging" or "Bumping" in and out of gear but still operating is usually a very profitable repair with this product.

"Tow-in's" most often require hard part replacement or a trans.

Fits: JF011E / RE0F10A / F1CJA

Nissan

- 07-13 Altima 2.5L
- 07-14 Rogue 2.5L
- 07-12 Sentra 2.0L 2.5L

Mitsubishi

- 08-14 Lancer 1.8L 2.0L 2.4L
- 08-14 Outlander 2.0L 2.4L
- 13-14 Outlander Sport 2.0L 2.4L

Jeep/Dodge

- 07-14 Compass/Patriot 2.0L 2.4L
- 06-12 Caliber 2.0L 2.4L

Fits: JF011E & JF015E

Use pages 1&2 for **JF011E**

Use pages 3&4 for **JF015E**

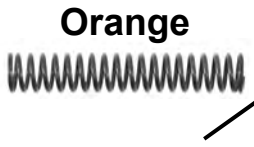
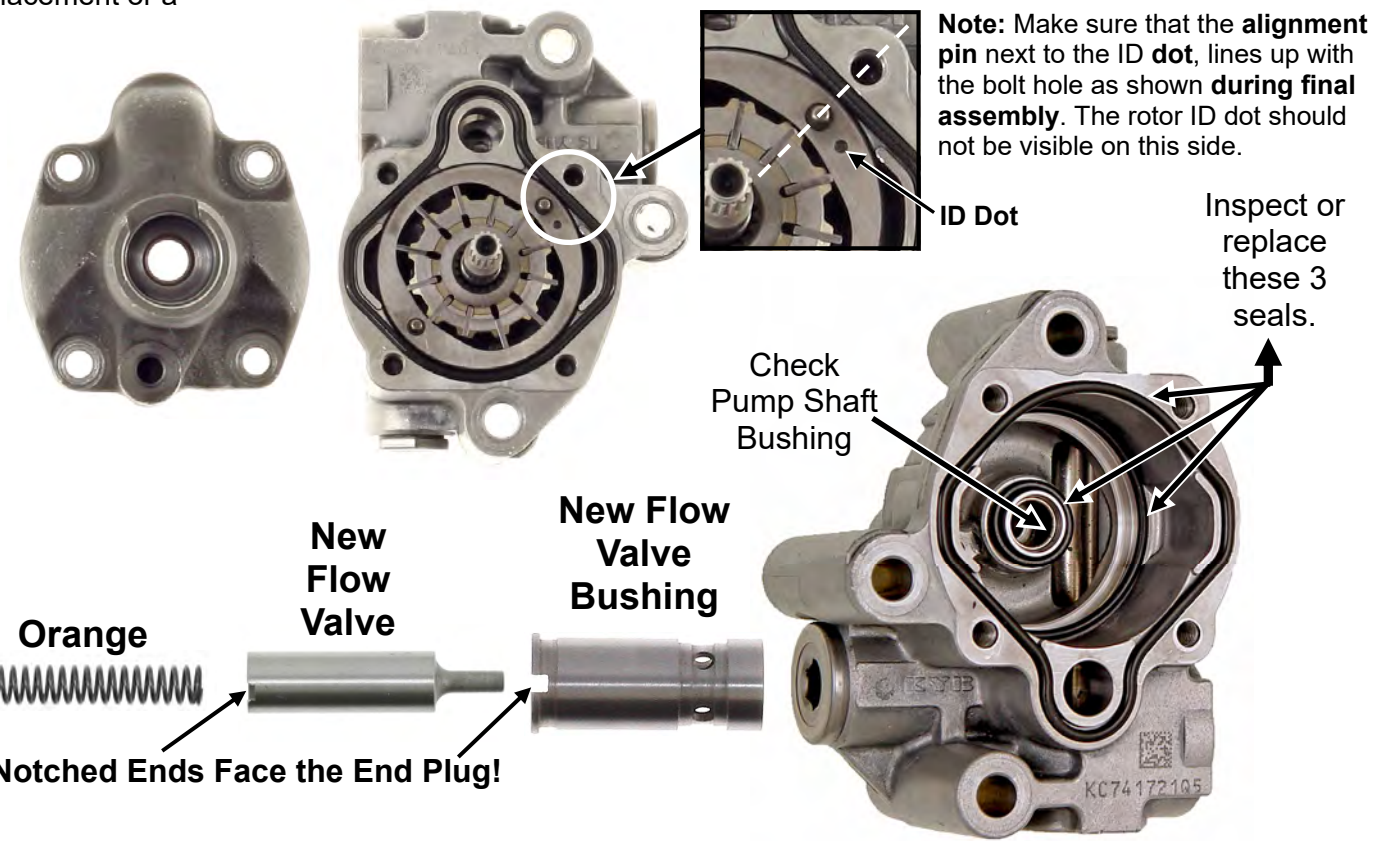

Notched Ends Face the End Plug!

Step 1

Remove Hex Plug, spring and old flow valve. Install New TransGo® Flow valve Bushing, Flow Valve and Orange Spring provided! Smile! It's better than new!

This "Drop-In" fix saves the pump body, some cash and your sanity. No need to replace the body! You're going to love it!



JF011E OE Pump Assembly (For Reference Only)

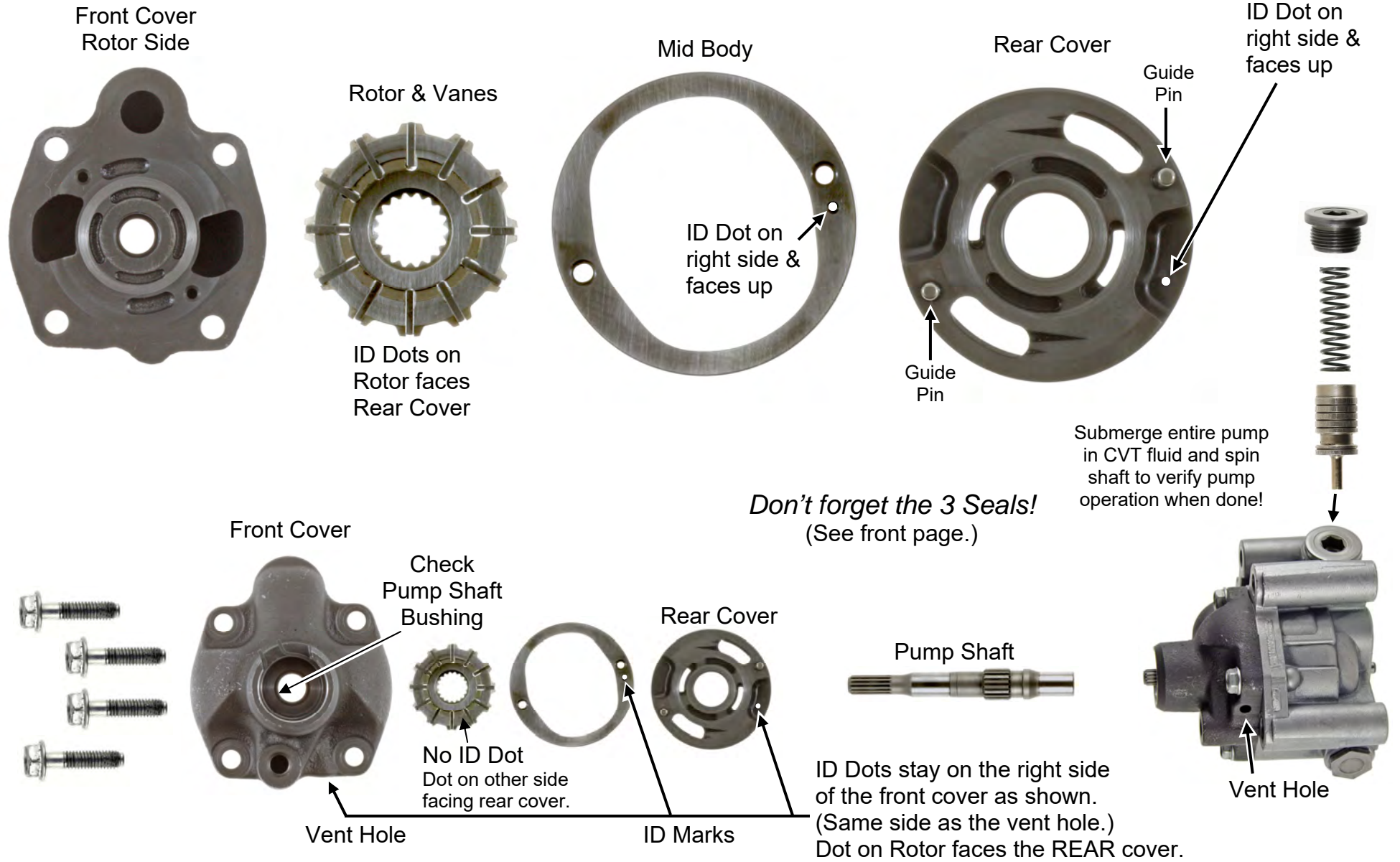

JF011E-FC (Flow Control Valve Repair)



Prevents-Corrects-Reduces

No Movement, Falls out of gear at idle, Shudder with throttle. Limp-in with pressure codes set.

Note: Complaints of "Surging" or "Bumping" in and out of gear but still operating is usually a very profitable repair with this product.

"Tow-in's" most often require hard part replacement or a trans.

Fits: JF011E & JF015E

Use pages 1&2 for **JF011E**

Use pages 3&4 for **JF015E**

Fits: JF015E / RE0F11A

Nissan

2011-2014 Juke

2012-2014 Sentra, Versa

Mitsubishi

2013-2015 Lancer

2014-2015 Mirage

Suzuki

2011-12 Swift

Chevrolet

2013-2014 Spark

Step 1 Remove Hex Plug, spring and old flow valve. Install New TransGo® Flow valve Bushing, Flow Valve and Orange Spring provided! Smile! It's better than new!

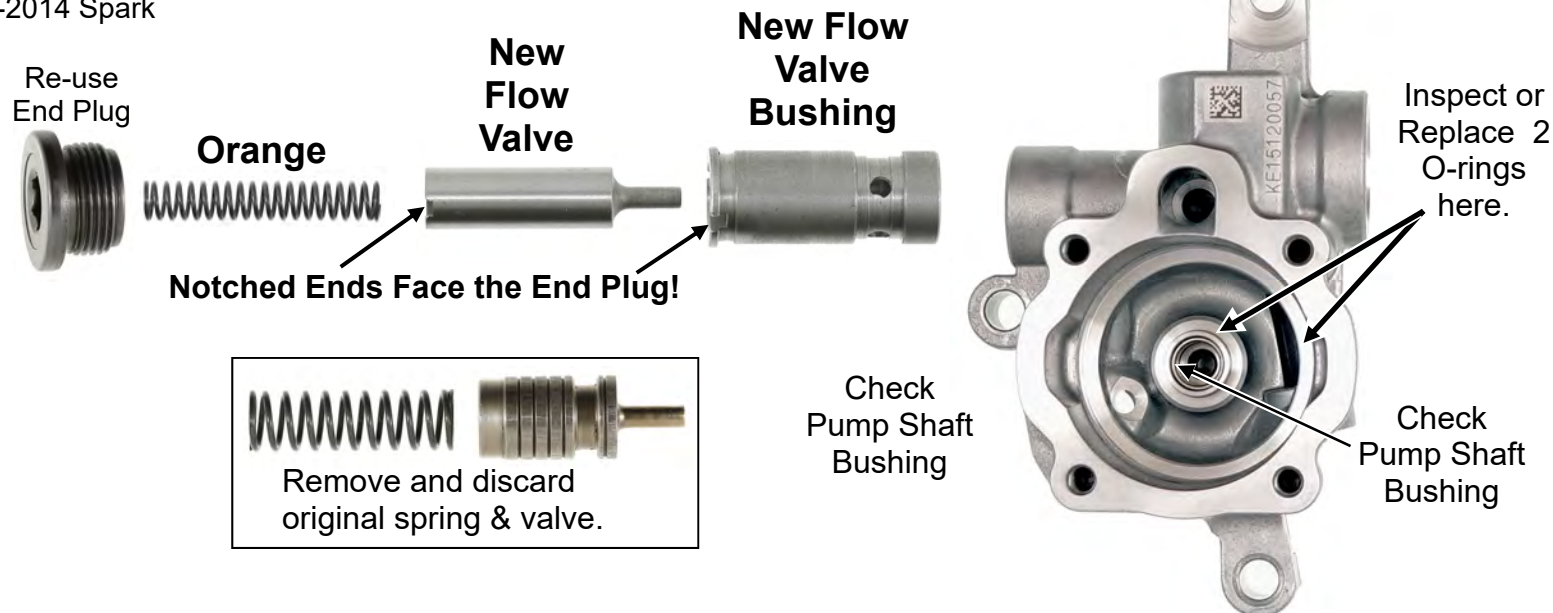

JF015E OE Pump Assembly (For Reference Only)



Front Cover
Rotor Side



Wear Plate
(Rotor Side)



Rotor & Vanes

ID Dots on
Rotor faces
Rear Cover

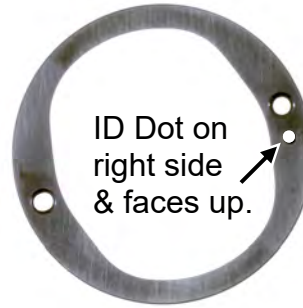

Mid Body

ID Dot on
right side
& faces up.



Rear Cover

Guide
Pin

Guide
Pin

ID Dot on
right side &
faces up

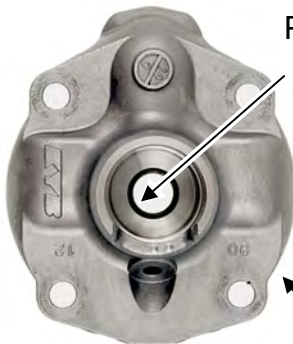

Front Cover

Check
Pump Shaft
Bushing



Rotor



Pre-Assembled
Pump
(Front Cover Side)

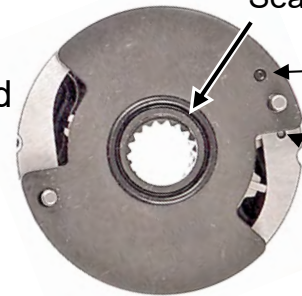

Shaft
Seal

ID Marks

Pump Shaft



ID Dots stay on the right side of the front cover as shown & they face up.
Dots on Rotor face the REAR COVER.

Don't forget the 2 O-rings!
(See front page.)