

**RICHMOND**

**ONTARIO**

**QUEEN**

# ROO

CITY

In Collaboration with  
**TRICON RESIDENTIAL**





**Rental Living in the Soul of the City**



# WHAT'S INSIDE

Project Overview ..... 07

Project Highlights ..... 08

Location Story ..... 10

Demographics ..... 12

Upcoming Developments .....14

Future Connectivity .....16

Units and Floor Plans .....18

Contact ..... 27







THE  
**QUINN**

Located at  
261 QUEEN ST E

THE  
**RICHIE**

Located at  
410 RICHMOND ST E

QUEEN ST E

ELECTRIC AVENUE LANEWAY

RICHMOND ST E

PROJECT OVERVIEW

# ROQ CITY HITS THE RIGHT NOTE

Introducing **ROQ City**—at **RICHMOND, ONTARIO** and **QUEEN**—a creative mixed-use development to include: two residential towers, **THE QUINN** and **THE RICHIE**; a public park; a vibrant Electric Avenue laneway concept; and unique retail and F&B opportunities. ROQ City is an inspired destination where communities come together to create, play and exchange.



CREATIVE  
MIXED-USE  
COMMUNITY

859  
RESIDENTIAL  
UNITS

131  
COMMERCIAL  
PARKING SPOTS

71k  
SF OF RETAIL

0.5  
ACRE PUBLIC  
PARK

1.8  
TOTAL ACRES

2  
RESIDENTIAL  
TOWERS





# ROQ CITY AT RICHMOND, ONTARIO AND QUEEN

A place to explore, create, play and discover, ROQ City is on a corridor to the downtown core that benefits from convenient TTC streetcar access to the Financial District and Downtown East employment nodes.

With the Don Valley Parkway a stone's throw away, bike lanes on Richmond Street and Adelaide Street, and a new TTC subway line — Ontario Line — being implemented a minute from the site, ROQ City is the ultimate hub in the soul of the city.

Residents and visitors can easily shop nearby local businesses and visit neighbouring Corktown, Cabbagetown, Riverdale and Distillery District with ease.





POPULATION  
AND HOUSEHOLDS

| POPULATION | AVG. FAMILY SIZE | MEDIAN AGE |
|------------|------------------|------------|
| 55,053     | 2.53             | 37.2       |
| HOUSEHOLDS | FAMILIES         |            |
| 30,273     | 11,394           |            |

HOUSING  
AND INCOME

| PER CAPITA INCOME | AVG. HOUSEHOLD INCOME |
|-------------------|-----------------------|
| \$59,483          | \$108,173.76          |





# LIVE IN THE SOUL OF THE CITY

There are currently 14 developments under construction within a 1km radius of ROQ City that will provide approximately 6,563 new residential units by 2025.

There are 46 developments in pre-construction that will create an additional 18,217 residential units in the years to come.

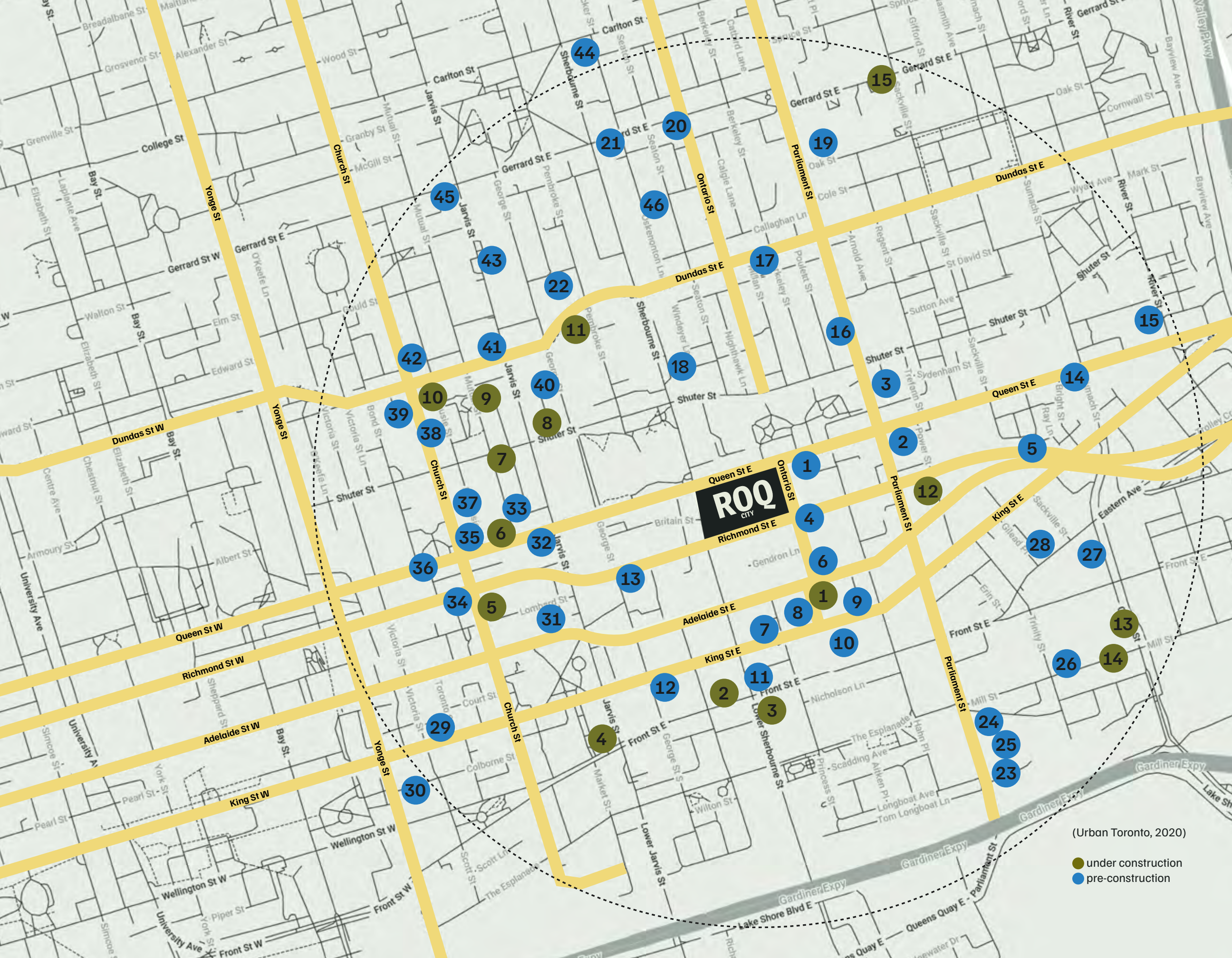



# CLOSE TO EVERYWHERE, EVERYTHING CLOSE TO HOME

ROQ City, currently on the Queen streetcar line, will soon be steps from the Ontario Line, offering faster and smoother connections across dozens of vibrant neighbourhoods, making it easier than ever to travel within Toronto and beyond.

## ONTARIO LINE

The 15.6-kilometre, 15-stop subway line will run from Exhibition Place through the heart of downtown to the Ontario Science Centre, all within 30 minutes of travel time. The Ontario Line is expected to open in 2030.



## MOSS PARK STATION

One of the proposed 15 stops—Moss Park Station—will be located down the street from ROQ City, providing residents and visitors with easy access to the development.





UNITS AND FLOOR PLANS

THE  
QUINN

LEVEL 1

SHOPPERS: 12,020 SF

UNIT A: 6,351 SF

UNIT B: 2,023 SF

THE  
RICHIE

LEVEL 1

UNIT C: 12,757 SF

UNIT D: 4,141 SF

AVAILABLE UNIT

LEASED UNIT

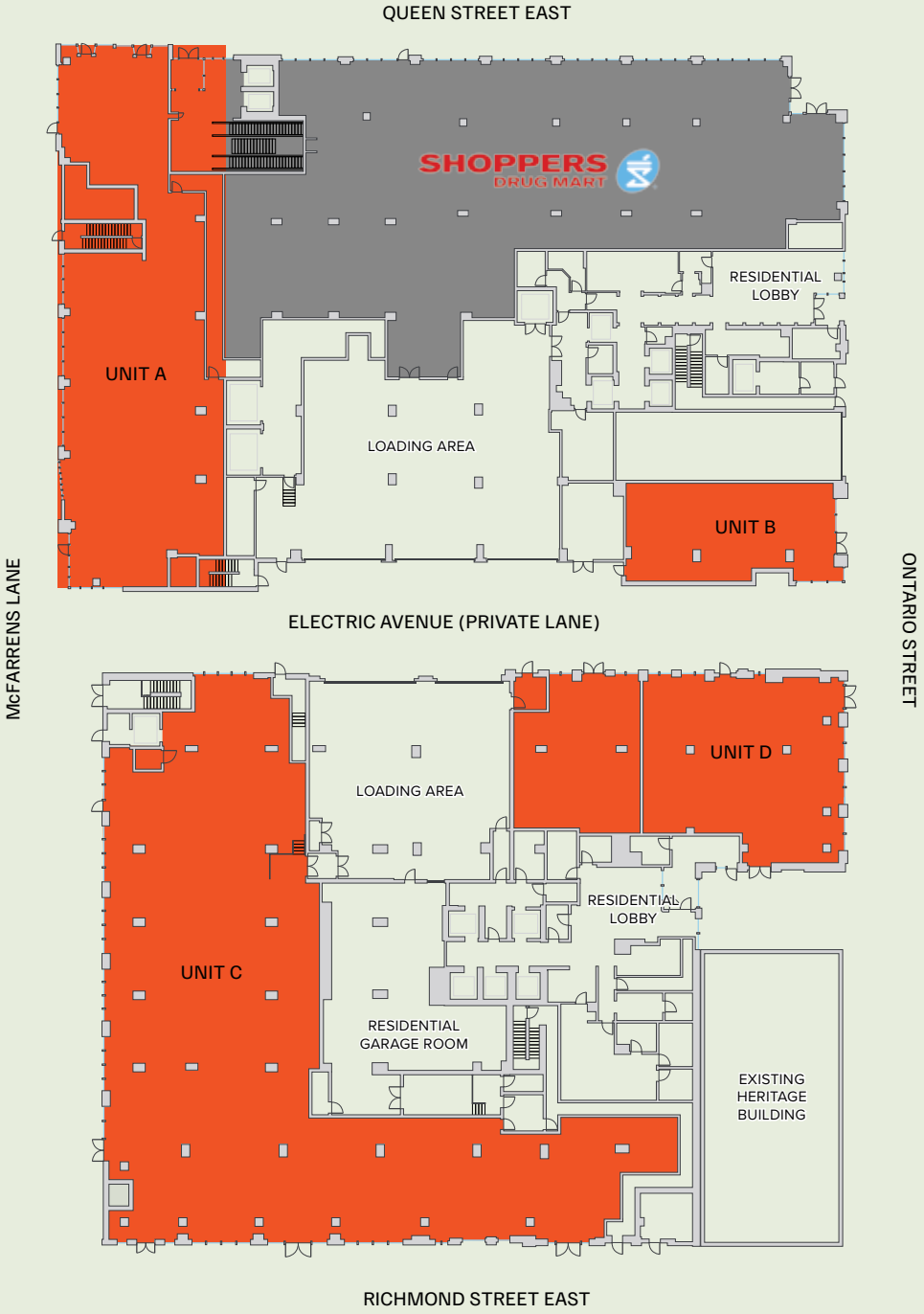

UNITS AND FLOOR PLANS

LEVEL 2

THE  
QUINN

FOOD BASICS: 34,228 SF

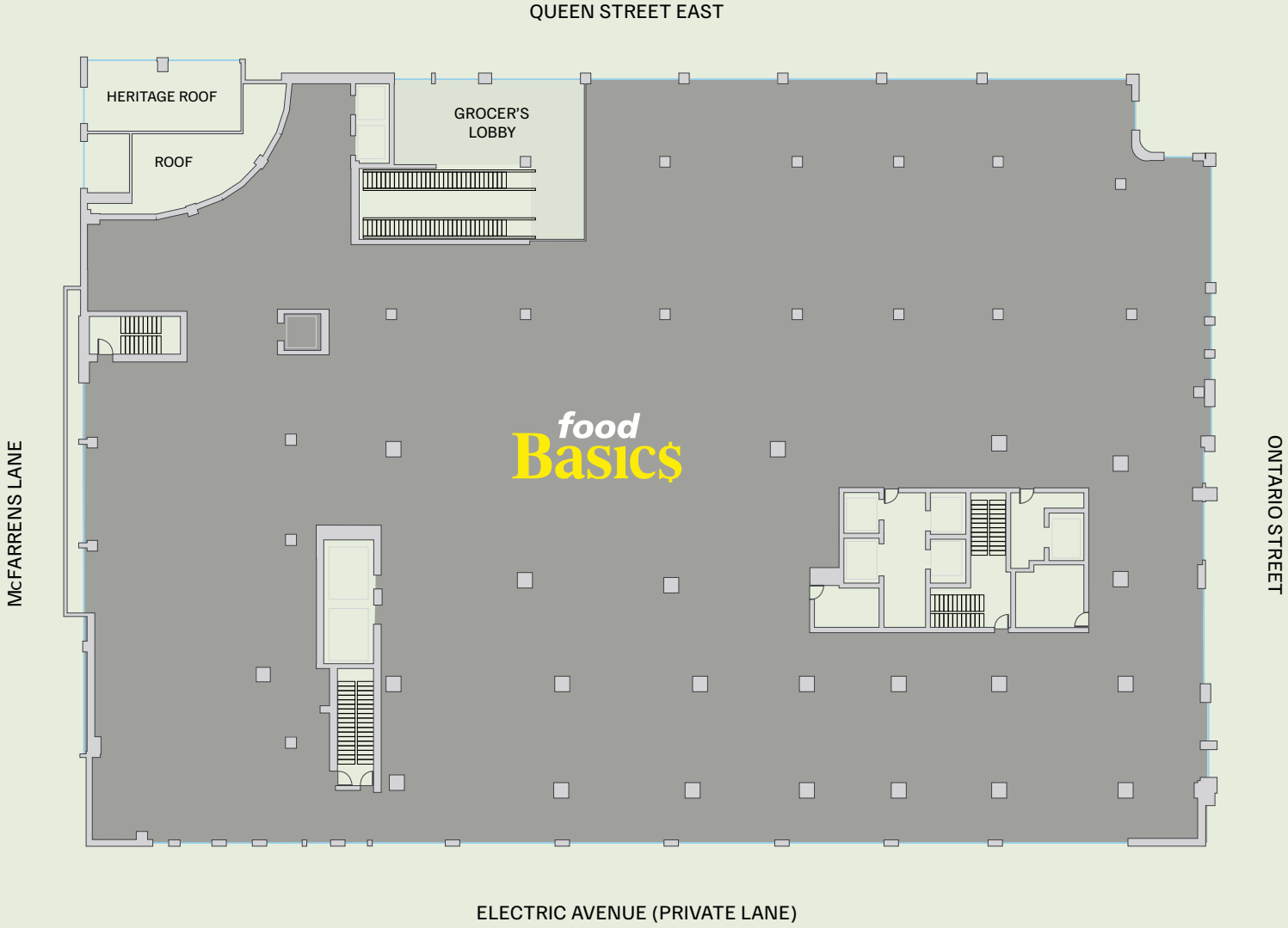





RICHMOND ST VIEW





QUEEN ST VIEW





ONTARIO ST VIEW





**JEREMY HURWITZ**  
Vice President, Retail

E: [JHURWITZ@TRICONRESIDENTIAL.COM](mailto:JHURWITZ@TRICONRESIDENTIAL.COM)  
T: 416 928 4079  
C: 647 998 6097



**LIVE  
ENGAGE  
PLAY  
EXPLORE  
CREATE  
DISCOVER  
COLLABORATE**

**ROQ CITY**