

**CHAMPIONS MUNICIPAL UTILITY DISTRICT IS IN THE ETJ FOR THE CITY OF HOUSTON AND CURRENTLY OWNS AND MAINTAINS ALL OF THE WATER AND SANITARY LINES WITHIN THEIR SERVICE BOUNDARY, INCLUDING THE PROPOSED WATER LINE**

**CONTRACTOR MUST VERIFY LOCATIONS OF EXISTING SANITARY SEWER LATERALS THAT COULD INTERFERE IN THE INSTALLATION OF PROPOSED WATER LINE PRIOR TO STARTING CONSTRUCTION**

**NOTICE:**  
FOR YOUR SAFETY, YOU ARE REQUIRED BY TEXAS LAW TO CALL 811 AT LEAST 48 HOURS BEFORE YOU DIG SO THAT UNDERGROUND LINES CAN BE MARKED. THIS SIGNATURE DOES NOT FULFILL YOUR OBLIGATION TO CALL 811

**VERIFICATION OF PRIVATE UTILITY LINES**

*Mike Brower* 06-16-23  
Date

CenterPoint Energy natural gas utilities shown. (Gas service lines are not shown). This signature not be used for conflict verification.  
Signature valid for six months.

*Mike Brower* 06-16-23  
Date

CenterPoint Energy/UNDERGROUND Electrical Facilities Verification ONLY. (This signature verifies existing underground facilities – not to be used for conflict verification)  
Signature valid for six months.

*Jesse Rodriguez* 06/15/2023  
Date

Approved for AT&T underground conduit facilities only.  
Signature valid for one year.

**Lockwood, Andrews & Newnam, Inc.**  
A LEO A DALY COMPANY

2925 Briarpark Drive, Suite 400  
Houston, TX 77042-3720  
Tel 713-266-6900  
www.lan-inc.com

**CHAMPIONS MUNICIPAL UTILITY DISTRICT**  
**CHAMPIONS SOUTH WATER LINE REPLACEMENT**  
**OVERALL - CHAMPION SOUTH LAYOUT 1**

NOTE: CITY SIGNATURES VALID FOR ONE YEAR ONLY AFTER DATE OF SIGNATURES

**CITY OF HOUSTON**  
HOUSTON PUBLIC WORKS

WATER	STORM WATER QUALITY
WASTE WATER	FACILITIES
STORM WATER	TRAFFIC & TRANSPORTATION/ STREET & BRIDGE

FILE NO.	HORIZ: 1" = 100'
SHEET NO. 5 OF 62	VERT:
DRAWING SCALE	
FOR CITY OF HOUSTON USE ONLY	

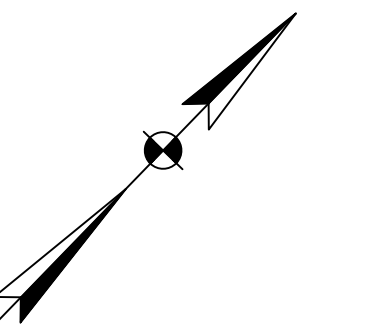

- NOTES:**
- ALL DIMENSIONS ARE IN FEET UNLESS OTHERWISE NOTED.
  - THE CONTRACTOR SHALL FIELD VERIFY ALL EXISTING AND PROPOSED DIMENSIONS AS WELL AS THE LOCATION AND ELEVATION OF EXISTING UTILITIES PRIOR TO CONSTRUCTION. ALL DISCREPANCIES, APPARENT ERRORS OR CONFLICTS SHALL BE BROUGHT TO THE ATTENTION OF THE OWNER AND ENGINEER PRIOR TO CONSTRUCTION.
  - TOPOGRAPHIC SURVEY WAS PROVIDED BY BY CIVIL-SURV LAND SURVEYING, LLC ON 4/18/2022. RIGHT-OF-WAYS AND EASEMENTS SHOWN ARE BASED ON THE SURVEYS FROM CIVIL-SURV. PROPERTY LINES SHOWN ARE BASED ON HARRIS COUNTY APPRAISAL DISTRICT DATA.
  - CONTRACTOR SHALL REMOVE AND DISPOSE OF ASBESTOS CEMENT (A.C.) WATER LINES UNCOVERED DURING EXCAVATION PER OSHA STANDARDS.
  - PERMITS MUST BE OBTAINED AND PROVIDED TO ENGINEER PRIOR TO ANY OPEN STREET CUTS.
  - ALL PROPOSED WATER LINE JOINTS ARE TO BE RESTRAINED.
  - ALL TAPPING SLEEVES SHALL BE FULL CIRCLE STAINLESS STEEL. ALL TAPPING SADDLES FOR SERVICE LINES SHALL BE STAINLESS STEEL.
  - ALL PROPOSED FIRE HYDRANT ASSEMBLIES INCLUDE 1-FH, 1-6" GATE VALVE WITH BOX, AND 1-8"x6" OR 1-12"x6" TEE (A.B.), SEE ON SHEET 61.
  - AFTER EXISTING WATER LINE HAS BEEN ABANDONED, CONTRACTOR SHALL REMOVE THE STACK AND BOX FOR ALL GATE VALVES ON THE ABANDONED WATER LINE.
  - CONTRACTOR SHALL REMOVE AND SALVAGE ALL EXISTING FIRE HYDRANT ASSEMBLIES, AND RETURN TO CHAMPIONS MUD. THE OLD FIRE HYDRANT CONNECTION ON THE EXISTING LINE SHALL BE CAPPED.
  - COORDINATE WITH HOMEOWNERS FOR ANY WORK THAT MAY AFFECT DRIVEWAY ACCESS. CONTRACTOR SHALL MAKE EVERY EFFORT POSSIBLE TO MAINTAIN HOMEOWNER'S ACCESS TO THEIR DRIVEWAY OR AS CLOSE AS POSSIBLE.
  - CONTRACTOR SHALL FOLLOW THE TRAFFIC CONTROL PLAN AS SHOWN ON SHEET 57. CONTRACTOR SHALL ENSURE THAT ALL LANES OF TRAFFIC ARE NOT BLOCKED AT ANY TIME.
  - CONTRACTOR SHALL USE CAUTION WHEN WORKING NEAR EXISTING STORM MANHOLES AND INLETS TO PROTECT THE EXISTING STRUCTURES.

**LEGEND:**

— SAN —	EXIST. SANITARY SEWER
— STM —	EXIST. STORM SEWER
— W —	EXIST. WATER LINE
— GR —	GROUT EXIST. WATER LINE
— W —	PROP. WATER LINE
— SC —	PROP. STEEL CASING
— GAS —	GAS LINE
— E —	OVERHEAD ELECTRIC LINE
— U —	UNDERGROUND ELECTRIC LINE
— TEL —	TELECOM LINE
— M —	EXIST. MAIL BOX
— T —	TREE

SECTION 7.2.05.D.2.b(1) OF THE CITY OF HOUSTON INFRASTRUCTURE DESIGN MANUAL (IDM) STATES TO CLEARLY SHOW AREAS AND LOCATIONS IN WHICH TRENCHLESS PITS WILL NOT BE PERMITTED. THE CONTRACTOR WILL ONLY BE ALLOWED TO WORK WITHIN THE HARRIS COUNTY RIGHT-OF-WAY OR INSIDE OF EXISTING UTILITY OR WATER LINE EASEMENTS. ANY AREAS DISTURBED DURING CONSTRUCTION SHALL BE RESTORED TO ITS ORIGINAL CONDITION OR BETTER.

**HARRIS COUNTY NOTIFICATION:**  
A NOTIFICATION ISSUED BY HARRIS COUNTY INFRASTRUCTURE DEPARTMENT - PERMITS OFFICE IS REQUIRED FOR PROPOSED WORK WITHIN THE HARRIS COUNTY RIGHT-OF-WAY. THE PROJECT MUST BE APPROVED PRIOR TO OBTAIN THE REQUIRED NOTIFICATION. A NOTIFICATION MUST BE OBTAINED SEPARATELY FROM SITE DEVELOPMENT PERMIT PACKAGE. FOR ADDITIONAL INFORMATION, PLEASE VISIT: [HTTP://HCPID.ORG/PERMITS/](http://hcpid.org/permits/) OR [PR\\_NOTIFICATION\\_OF\\_CONSTRUCTION.HTML](http://pr_notification_of_construction.html) OR CONTACT PUBLIC REVIEW INSPECTIONS DEPARTMENT @ 713-274-3931 OR [PUBLIC.REVIEW@HCPID.ORG](mailto:PUBLIC.REVIEW@HCPID.ORG).

**\*Construction in Harris County Flood Control District Right-of-Way requires:**  
Site plans must be approved prior to obtaining the required HCFCD Right-of-Way Notification. Be advised that the HCFCD Right-of-Way Notification is separate from the site development permit package  
1.) HCFCD Right-of-Way Notification (permit)  
2.) HCFCD 48-hr Pre-Construction Notice  
Both are required prior to entering or working within Harris County Flood Control District right-of-way. The HCFCD Right-of-Way Notification and 48-hour notice must be provided to HCFCD at [dcid@hcfcd.hctx.net](mailto:dcid@hcfcd.hctx.net)  
To apply for the HCFCD Right-of-Way Notification please go to <http://apps.harriscountytexas.gov/EPpermits> and apply for the HCFCD ROW under ROW Notification. Failure to provide both items could result in project delays.

**BENCHMARK** ELEV. 110.31'  
HARRIS COUNTY FLOOD REFERENCE MARK No. 110090 BEING A BRASS DISC IN CONCRETE OF OF A BRIDGE LOCATED ON THE EAST RIGHT-OF-WAY LINE OF CHAMPION FOREST DRIVE OVER STREAM No. K100-00-00 CYPRESS CREEK, APPROXIMATELY 0.20 MILE SOUTH FROM THE INTERSECTION OF CYPRESSWOOD DRIVE AND CHAMPION FOREST DRIVE. (NAVD 88, 2001 ADJUSTMENT)  
**TEMPORARY BENCHMARK (T.B.M.) "A" ELEV. 118.53'**  
BOX CUT ON BB INLET ALONG THE EASTERLY RIGHT-OF-WAY LINE OF CHAMPIONS DRIVE APPROXIMATELY 30' NORTHWEST OF THE INTERSECTION OF CHAMPIONS DRIVE AND PEBBLE BEACH DRIVE. (NAVD 88, 2001 ADJUSTMENT)  
**TEMPORARY BENCHMARK (T.B.M.) "B" ELEV. 119.37'**  
BOX CUT ON "BB" INLET ALONG THE WESTERLY RIGHT-OF-WAY LINE OF MISSION VALLEY DRIVE APPROXIMATELY 15' SOUTHEAST OF THE INTERSECTION OF MISSION VALLEY DRIVE AND PEBBLE BEACH DRIVE. (NAVD 88, 2001 ADJUSTMENT)  
**TEMPORARY BENCHMARK (T.B.M.) "F" ELEV. 123.52'**  
RAILROAD SPIKE IN POWER POLE ALONG THE WESTERLY RIGHT-OF-WAY LINE OF MISSION VALLEY DRIVE APPROXIMATELY 730' SOUTHEAST OF THE INTERSECTION OF MISSION VALLEY DRIVE AND PEBBLE BEACH DRIVE. (NAVD 88, 2001 ADJUSTMENT)







MATCHLINE, SHEET 5

MATCHLINE, SHEET 6

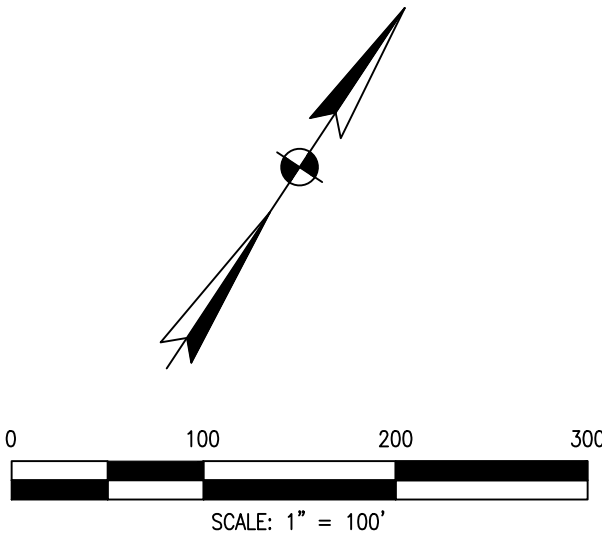
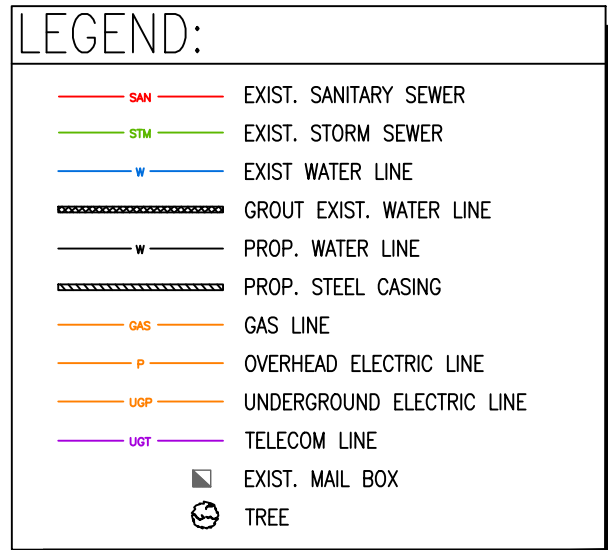
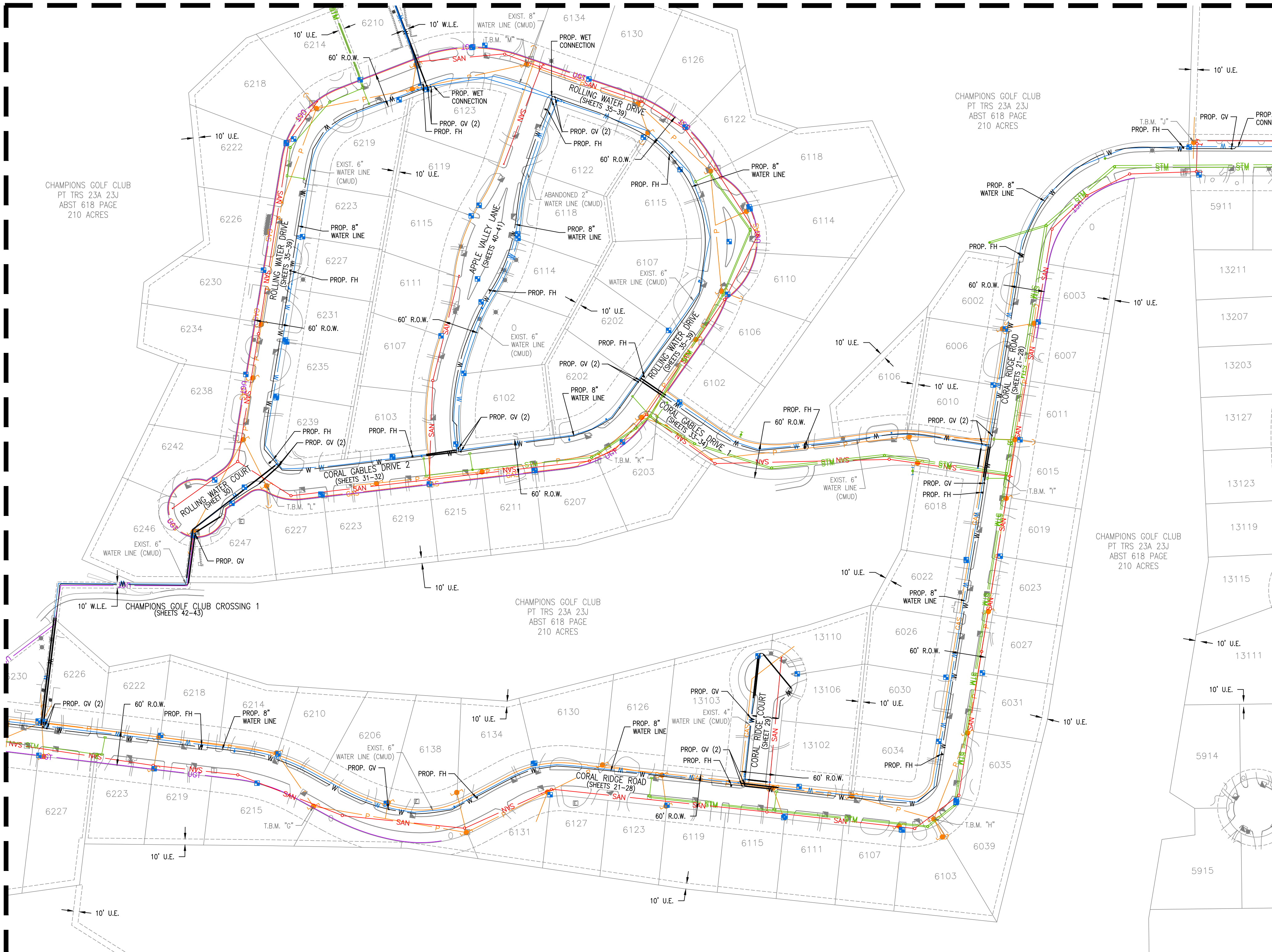

- NOTES:**
- ALL DIMENSIONS ARE IN FEET UNLESS OTHERWISE NOTED.
  - THE CONTRACTOR SHALL FIELD VERIFY ALL EXISTING AND PROPOSED DIMENSIONS AS WELL AS THE LOCATION AND ELEVATION OF EXISTING UTILITIES PRIOR TO CONSTRUCTION. ALL DISCREPANCIES, APPARENT ERRORS OR CONFLICTS SHALL BE BROUGHT TO THE ATTENTION OF THE OWNER AND ENGINEER PRIOR TO CONSTRUCTION.
  - TOPOGRAPHIC SURVEY WAS PROVIDED BY BY CIVIL-SURV LAND SURVEYING, LLC ON 4/18/2022. RIGHT-OF-WAYS AND EASEMENTS SHOWN ARE BASED ON THE SURVEYS FROM CIVIL-SURV. PROPERTY LINES SHOWN ARE BASED ON HARRIS COUNTY APPRAISAL DISTRICT DATA.
  - CONTRACTOR SHALL REMOVE AND DISPOSE OF ASBESTOS CEMENT (A.C.) WATER LINES UNCOVERED DURING EXCAVATION PER OSHA STANDARDS.
  - PERMITS MUST BE OBTAINED AND PROVIDED TO ENGINEER PRIOR TO ANY OPEN STREET CUTS.
  - ALL PROPOSED WATER LINE JOINTS ARE TO BE RESTRAINED.
  - ALL TAPPING SLEEVES SHALL BE FULL CIRCLE STAINLESS STEEL. ALL TAPPING SADDLES FOR SERVICE LINES SHALL BE STAINLESS STEEL.
  - ALL PROPOSED FIRE HYDRANT ASSEMBLIES INCLUDE 1-FH, 1-6" GATE VALVE WITH BOX, AND 1-8"x6" OR 1-12"x6" TEE (A.B.), SEE ON SHEET 61.
  - AFTER EXISTING WATER LINE HAS BEEN ABANDONED, CONTRACTOR SHALL REMOVE THE STACK AND BOX FOR ALL GATE VALVES ON THE ABANDONED WATER LINE.
  - CONTRACTOR SHALL REMOVE AND SALVAGE ALL EXISTING FIRE HYDRANT ASSEMBLIES, AND RETURN TO CHAMPIONS MUD. THE OLD FIRE HYDRANT CONNECTION ON THE EXISTING LINE SHALL BE CAPPED.
  - COORDINATE WITH HOMEOWNERS FOR ANY WORK THAT MAY AFFECT DRIVEWAY ACCESS. CONTRACTOR SHALL MAKE EVERY EFFORT POSSIBLE TO MAINTAIN HOMEOWNER'S ACCESS TO THEIR DRIVEWAY OR AS CLOSE AS POSSIBLE.
  - CONTRACTOR SHALL FOLLOW THE TRAFFIC CONTROL PLAN AS SHOWN ON SHEET 57. CONTRACTOR SHALL ENSURE THAT ALL LANES OF TRAFFIC ARE NOT BLOCKED AT ANY TIME.
  - CONTRACTOR SHALL USE CAUTION WHEN WORKING NEAR EXISTING STORM MANHOLES AND INLETS TO PROTECT THE EXISTING STRUCTURES.

**CONTRACTOR MUST VERIFY LOCATIONS OF EXISTING SANITARY SEWER LATERALS THAT COULD INTERFERE IN THE INSTALLATION OF PROPOSED WATER LINE PRIOR TO STARTING CONSTRUCTION**

CHAMPIONS MUNICIPAL UTILITY DISTRICT IS IN THE ETJ FOR THE CITY OF HOUSTON AND CURRENTLY OWNS AND MAINTAINS ALL OF THE WATER AND SANITARY LINES WITHIN THEIR SERVICE BOUNDARY, INCLUDING THE PROPOSED WATER LINE

**HARRIS COUNTY NOTIFICATION:**  
A NOTIFICATION ISSUED BY HARRIS COUNTY INFRASTRUCTURE DEPARTMENT - PERMITS OFFICE IS REQUIRED FOR PROPOSED WORK WITHIN THE HARRIS COUNTY RIGHT-OF-WAY. THE PROJECT MUST BE APPROVED PRIOR TO OBTAIN THE REQUIRED NOTIFICATION. A NOTIFICATION MUST BE OBTAINED SEPARATELY FROM SITE DEVELOPMENT PERMIT PACKAGE. FOR ADDITIONAL INFORMATION, PLEASE VISIT: [HTTP://HCPID.ORG/PERMITS/](http://hcpid.org/permits/) PR\_NOTIFICATION\_OF\_CONSTRUCTION.HTML OR CONTACT PUBLIC REVIEW INSPECTIONS DEPARTMENT @ 713-274-3931 OR [PUBLIC.REVIEW@HCPID.ORG](mailto:PUBLIC.REVIEW@HCPID.ORG).

**\*Construction in Harris County Flood Control District Right-of-Way requires:**  
  
Site plans must be approved prior to obtaining the required HCFCDD Right-of-Way Notification. Be advised that the HCFCDD Right-of-Way Notification is separate from the site development permit package  
  
1.) HCFCDD Right-of-Way Notification (permit)  
2.) HCFCDD 48-hr Pre-Construction Notice  
  
Both are required prior to entering or working within Harris County Flood Control District right-of-way. The HCFCDD Right-of-Way Notification and 48-hour notice must be provided to HCFCDD at [dcid@hcfcd.hctx.net](mailto:dcid@hcfcd.hctx.net).  
  
To apply for the HCFCDD Right-of-Way Notification please go to <http://apps.harriscountytexas.gov/EPermits> and apply for the HCFCDD ROW under ROW Notification.  
  
Failure to provide both items could result in project delays.

BENCHMARK ELEV. 110.31'

HARRIS COUNTY FLOOD REFERENCE MARK No. 110090 BEING A BRASS DISC IN CONCRETE OF A BRIDGE LOCATED ON THE EAST RIGHT-OF-WAY LINE OF CHAMPION FOREST DRIVE OVER STREAM No. K100-00-00 CYPRESS CREEK, APPROXIMATELY 0.20 MILE SOUTH FROM THE INTERSECTION OF CYPRESSWOOD DRIVE AND CHAMPION FOREST DRIVE. (NAVD 88, 2001 ADJUSTMENT)

TEMPORARY BENCHMARK (T.B.M.) "G" ELEV. 123.12'

RAILROAD SPIKE IN POWER POLE ALONG THE SOUTHERLY RIGHT-OF-WAY LINE OF CORAL RIDGE ROAD APPROXIMATELY 650' EAST OF THE INTERSECTION OF CORAL RIDGE ROAD AND MISSION VALLEY COURT. (NAVD 88, 2001 ADJUSTMENT)

TEMPORARY BENCHMARK (T.B.M.) "H" ELEV. 123.25'

RAILROAD SPIKE IN POWER POLE ALONG THE EASTERLY RIGHT-OF-WAY LINE OF CORAL RIDGE ROAD APPROXIMATELY 300' NORTHEAST OF THE INTERSECTION OF CORAL RIDGE ROAD AND CORAL RIDGE COURT. (NAVD 88, 2001 ADJUSTMENT)

TEMPORARY BENCHMARK (T.B.M.) "I" ELEV. 119.80'

BOX CUT ON "BB" INLET ALONG THE EASTERLY RIGHT-OF-WAY LINE OF CORAL RIDGE ROAD AT THE INTERSECTION OF CORAL RIDGE ROAD AND CORAL GABLES DRIVE. (NAVD 88, 2001 ADJUSTMENT)

TEMPORARY BENCHMARK (T.B.M.) "J" ELEV. 123.53'

RAILROAD SPIKE IN POWER POLE ALONG THE NORTHERLY RIGHT-OF-WAY LINE OF CORAL RIDGE ROAD APPROXIMATELY 11' NORTH OF A WATER METER AND APPROXIMATELY 6' WEST OF A SANITARY SEWER MANHOLE. (NAVD 88, 2001 ADJUSTMENT)

TEMPORARY BENCHMARK (T.B.M.) "K" ELEV. 120.10'

BOX CUT ON "BB" INLET ALONG THE SOUTH RIGHT-OF-WAY LINE OF CORAL GABLES DRIVE AT THE SOUTHEAST INTERSECTION OF CORAL GABLES DRIVE AND ROLLING WATER ROAD. (NAVD 88, 2001 ADJUSTMENT)

TEMPORARY BENCHMARK (T.B.M.) "M" ELEV. 122.00'

RAILROAD SPIKE IN POWER POLE ALONG THE NORTH RIGHT-OF-WAY LINE OF ROLLING WATER DRIVE APPROXIMATELY 35' WEST OF THE INTERSECTION OF ROLLING WATER DRIVE AND APPLE VALLEY LANE. (NAVD 88, 2001 ADJUSTMENT)

TEMPORARY BENCHMARK (T.B.M.) "L" ELEV. 122.53'

RAILROAD SPIKE IN POWER POLE ALONG THE SOUTH RIGHT-OF-WAY LINE OF CORAL GABLES DRIVE AT THE SOUTHEAST INTERSECTION OF CORAL GABLES DRIVE AND ROLLING WATER COURT. (NAVD 88, 2001 ADJUSTMENT)

SECTION 7.2.05.D.2.b(1) OF THE CITY OF HOUSTON INFRASTRUCTURE DESIGN MANUAL (IDM) STATES TO CLEARLY SHOW AREAS AND LOCATIONS IN WHICH TRENCHLESS PITS WILL NOT BE PERMITTED. THE CONTRACTOR WILL ONLY BE ALLOWED TO WORK WITHIN THE HARRIS COUNTY RIGHT-OF-WAY OR INSIDE OF EXISTING UTILITY OR WATER LINE EASEMENTS. ANY AREAS DISTURBED DURING CONSTRUCTION SHALL BE RESTORED TO ITS ORIGINAL CONDITION OR BETTER.

**NOTICE:**

FOR YOUR SAFETY, YOU ARE REQUIRED BY TEXAS LAW TO CALL 811 AT LEAST 48 HOURS BEFORE YOU DIG SO THAT UNDERGROUND LINES CAN BE MARKED. THIS SIGNATURE DOES NOT FULFILL YOUR OBLIGATION TO CALL 811

**VERIFICATION OF PRIVATE UTILITY LINES**

*Mike Brower* 06-16-23  
Date

CenterPoint Energy natural gas utilities shown. (Gas service lines are not shown). This signature not be used for conflict verification.  
Signature valid for six months.

*Mike Brower* 06-16-23  
Date

CenterPoint Energy/UNDERGROUND Electrical Facilities Verification ONLY. (This signature verifies existing underground facilities – not to be used for conflict verification)  
Signature valid for six months.

*Jesse Rodriguez* 06/15/2023  
Date

Approved for AT&T underground conduit facilities only.  
Signature valid for one year.

**LAN** Lockwood, Andrews & Newnam, Inc.  
A LEO A DALY COMPANY  
2925 Briarpark Drive, Suite 400  
Houston, TX 77042-3720  
Tel 713-266-6900  
www.lan-inc.com

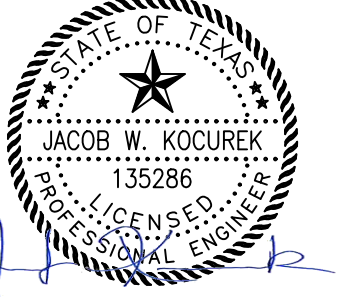

Lockwood, Andrews & Newnam, Inc.  
Texas Registered Engineering Firm  
F-2614  
05/22/2023

**CHAMPIONS MUNICIPAL UTILITY DISTRICT**

**CHAMPIONS SOUTH WATER LINE REPLACEMENT**

**OVERALL - CHAMPION SOUTH LAYOUT 3**

NOTE: CITY SIGNATURES VALID FOR ONE YEAR ONLY AFTER DATE OF SIGNATURES

**CITY OF HOUSTON**  
HOUSTON PUBLIC WORKS

WATER	STORM WATER QUALITY
WASTE WATER	FACILITIES
STORM WATER	TRAFFIC & TRANSPORTATION/ STREET & BRIDGE

FILE NO.	HORIZ: 1" = 100'
	VERT:

SHEET NO. 7 OF 62	DRAWING SCALE
FOR CITY OF HOUSTON USE ONLY	