

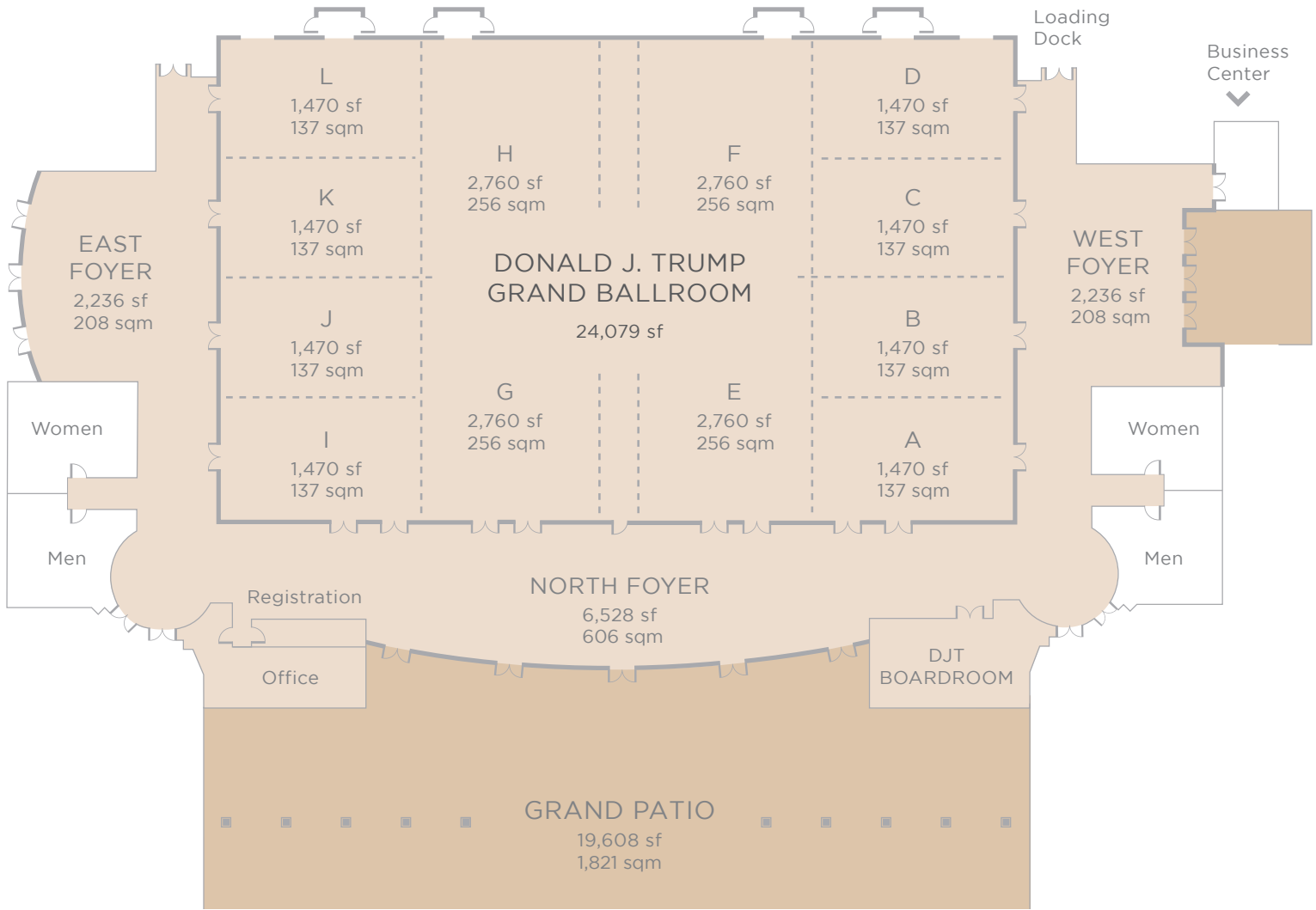

Trump National Doral

FLOOR PLANS & CAPACITY CHARTS

THE DONALD J. TRUMP GRAND BALLROOM



THE DONALD J. TRUMP GRAND BALLROOM

	Square Meters	Square Feet	Length	Width	Ceiling	Banquet (10)	Reception	Classroom	Theater	Crescents (6)	UShape	Hollow Square	Conference	Exhibit 8x10
<i>The Donald J. Trump Grand Ballroom</i>	2,237	24,079	199'	121'	22	1,700	2,400	1,680	3,500	1,020	-	-	-	98
<i>A, B, C, & D (each)</i>	137	1,470	30'	49'	22	80	150	96	150	48	60	48	40	8
<i>A-D (combined)</i>	551	5,929	49'	121'	22	400	600	384	700	240	112	100	-	22
<i>E & F (each)</i>	256	2,760	46'	60'	22	200	275	176	350	120	72	64	56	14
<i>E-F (combined)</i>	517	5,566	46'	121'	22	400	550	384	700	240	100	100	-	29
<i>A-F (combined)</i>	1,068	11,495	95'	121'	22	720	1,150	828	1,500	480	120	124	-	57
<i>G & H (each)</i>	256	2,760	46'	60'	22	200	275	176	350	120	72	64	56	14
<i>G-H (combined)</i>	517	5,566	46'	121'	22	400	550	384	700	240	100	100	-	29
<i>E-H (combined)</i>	1,173	12,621	100'	121'	22	800	1,200	920	1,600	480	120	124	-	78
<i>A-H (combined)</i>	1,724	18,550	121'	150'	22	1,300	1,800	1,100	2,500	780	156	-	-	68
<i>G-L (combined)</i>	1,068	11,495	95'	121'	22	720	1,150	828	1,500	480	120	124	-	57
<i>I, J, K & L (each)</i>	137	1,470	30'	49'	22	80	150	96	150	48	60	48	40	8
<i>I-L (combined)</i>	551	5,929	49'	121'	22	400	600	384	700	240	112	100	-	22
<i>Boardroom</i>	49	528	24'	22'	8	-	-	-	-	-	-	-	10	-
<i>Office</i>	28	300	10'	30'	10	-	-	-	-	-	-	-	-	-
<i>Registration</i>	11	120	6.2'	24'	10	-	-	-	-	-	-	-	-	-
<i>North Foyer</i>	606	6,528	34'	192'	22	240	600	-	-	-	-	-	-	12
<i>East Foyer</i>	208	2,236	-	-	22	100	200	-	-	-	-	-	-	8
<i>West Foyer</i>	208	2,236	-	-	22	100	200	-	-	-	-	-	-	8
<i>The Grand Patio</i>	1,821	19,608	86'	228'	18	600	1,000	-	-	-	-	-	-	-

RESORT CLUBHOUSE

LOBBY LEVEL

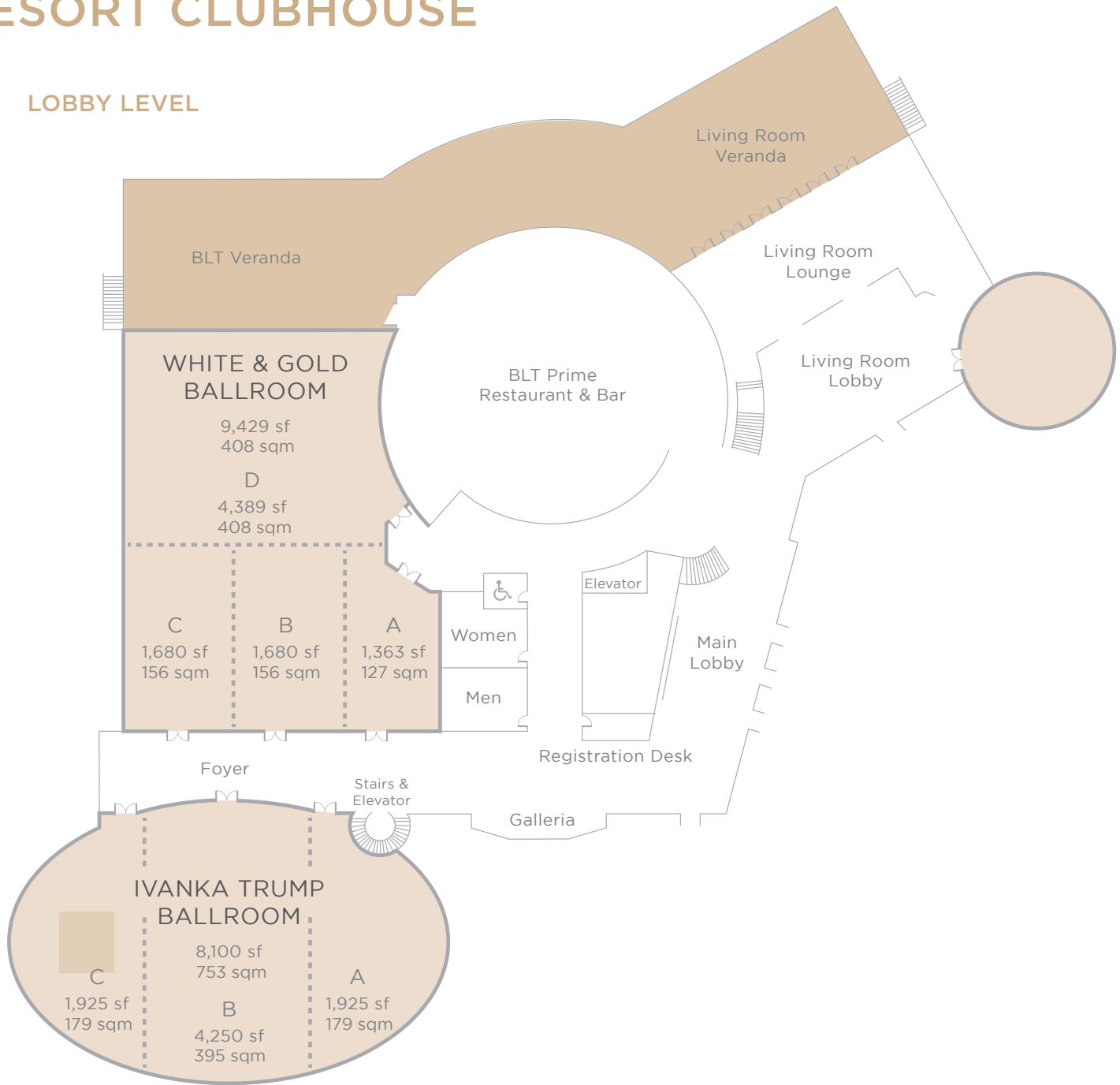

RESORT CLUBHOUSE

	Square Meters	Square Feet	Length	Width	Ceiling	Banquet (10)	Reception	Classroom	Theater	Crescents (6)	UShape	Hollow Square	Conference
<i>The Ivanka Trump Ballroom</i>	753	8,100	85'	130'	21	600	810	440	900	360	84	102	64
<i>Ivanka A</i>	179	1,925	40'	70'	21	140	190	100	200	84	52	60	50
<i>Ivanka B</i>	395	4,250	50'	85'	21	280	425	234	504	168	78	90	72
<i>Ivanka C</i>	179	1,925	40'	70'	21	140	190	100	200	84	52	60	50
<i>Foyer</i>	204	2,200	20'	111'	10	-	200	-	-	-	-	-	-
<i>Galleria</i>	115	1,240	31'	40'	17	-	50	-	-	-	-	-	-
<i>Registration Desk</i>	9	95	10'	9'	9	-	-	-	-	-	-	-	-
<i>The White & Gold Ballroom</i>	876	9,429	90'	113'	16	620	940	440	936	372	87	106	80
<i>White & Gold A</i>	125	1,363	29'	47'	16	80	130	54	100	48	32	40	36
<i>White & Gold B</i>	156	1,680	30'	56'	16	80	150	75	132	48	44	52	42
<i>White & Gold C</i>	156	1,680	30'	56'	16	80	150	75	120	48	43	50	42
<i>White & Gold D</i>	408	4,389	57'	77'	16	300	440	200	456	180	64	88	50
<i>White & Gold ABC</i>	468	5,040	90'	56'	16	340	500	280	456	204	80	96	74

RESORT CLUBHOUSE

UPPER LEVEL

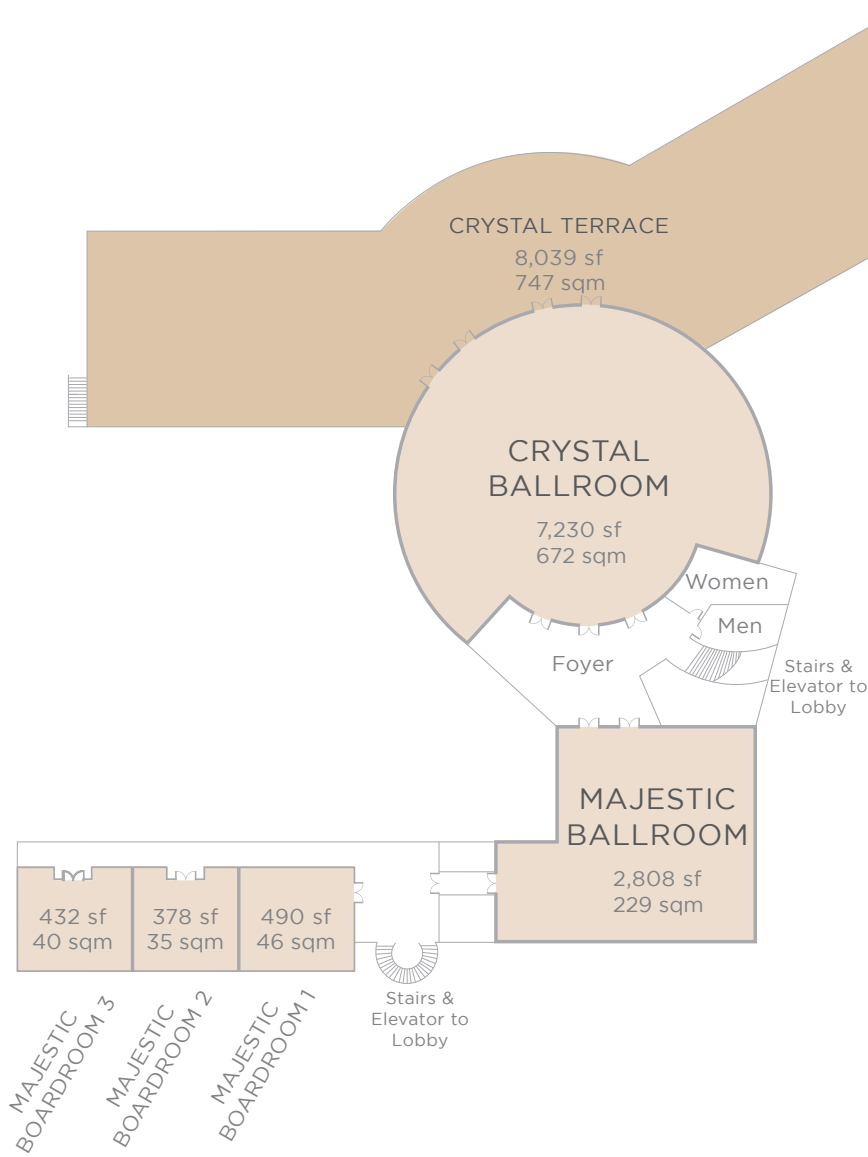

LOWER LEVEL

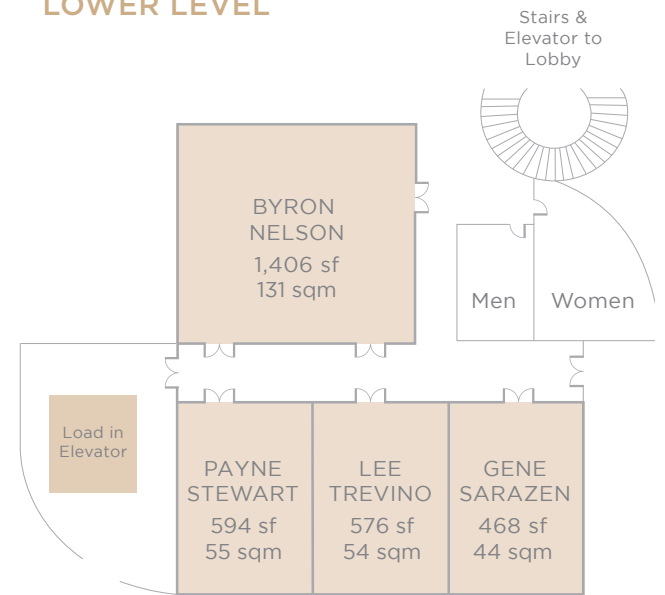

RESORT CLUBHOUSE

	Square Meter	Square Feet	Length	Width	Ceiling	Banquet (10)	Reception	Classroom	Theater	Crescents (6)	UShape	Hollow Square	Conference
<i>The Crystal Ballroom</i>	672	7,230	-	-	17	400	480	352	480	240	60	85	42
<i>The Crystal Terrace</i>	747	8,039	-	-	-	-	500	-	-	-	-	-	-
<i>The Majestic Ballroom</i>	229	2,467	54'	52'	11	120	200	108	198	72	35	40	30
<i>The Majestic Boardroom 1</i>	46	490	17'	19'	7	-	-	-	-	-	-	-	12
<i>The Majestic Boardroom 2</i>	35	378	18'	21'	8	-	-	-	-	-	-	-	10
<i>The Majestic Boardroom 3</i>	40	432	18'	24'	8	-	-	-	-	-	-	-	10
<i>Byron Nelson</i>	131	1,406	38'	37'	9	60	100	60	128	36	32	40	34
<i>Payne Stewart</i>	55	594	18'	33'	9	40	50	36	90	24	21	24	22
<i>Lee Trevino</i>	54	576	18'	32'	9	40	50	36	80	24	21	24	22
<i>Gene Sarazen</i>	44	468	18'	26'	9	30	40	30	60	18	15	18	16

BOBBY JONES VILLA



BOBBY JONES VILLA

	Square Meters	Square Feet	Length	Width	Ceiling	Banquet (10)	Reception	Classroom	Theater	Crescents (6)	UShape	Hollow Square	Conference
<i>Gardenia</i>	56	598	23'	26'	7	40	50	40	73	24	28	32	12
<i>Magnolia</i>	55	588	21'	28'	7	40	50	40	73	24	28	32	24
<i>Hibiscus</i>	47	504	18'	28'	7	30	40	28	56	18	20	24	24
<i>Orchid</i>	43	465	15'	31'	7	30	30	24	40	18	20	24	26
<i>Rose</i>	71	760	19'	40'	9	50	60	40	84	30	28	32	34
<i>Lantana</i>	71	760	19'	40'	9	50	60	40	84	30	28	32	34
<i>Cypress</i>	60	648	27'	24'	9	40	50	20	53	18	20	24	24
<i>Oak</i>	53	567	27'	21'	9	40	50	20	53	18	20	24	24
<i>Ginger</i>	53	567	27'	21'	9	40	50	20	53	18	20	24	24
<i>Juniper</i>	216	2,322	27'	86'	7	120	150	100	200	72	50	50	40
<i>The Jones Courtyard</i>	304	3,276	39'	84'	-	-	300	-	-	-	-	-	-

MEETING & EVENT ACCOMMODATIONS

INDOOR FUNCTION SPACE

- 100,000 Total sq ft (9,290 sq m)
- 24,079 sq ft (2,236 sq m) Donald J. Trump Grand Ballroom
- 8,100 sq ft (752 sq m) Ivanka Trump Ballroom
- 9,429 sq ft (876 sq m) White & Gold Ballroom
- 7,448 sq ft (682 sq m) Imperial Ballroom
- 7,230 sq ft (672 sq m) Crystal Ballroom
- 2,467 sq ft (229 sq m) Majestic Ballroom
- 15 Breakout Rooms
- 5 Executive Boardrooms
- 11 Meeting Venues with Natural Lighting
- Living Room Hospitality Lounge

OUTDOOR FUNCTION SPACE

- 75,000 Total sq ft (6,968 sq m)
- Reception Capacity up to 1,000 Guests
- Banquet Capacity for 600 Guests
- Collection of Unique Outdoor Venues

EVENT SERVICES

- Dedicated Event Concierge Service
- In House Multi Media Production Capabilities
- High Density Internet with Ability to Dedicate Bandwidth
- Breakout Rooms with Built In Screens, Lighting Control, Music and House Sound

OTHER VENUES

	Square Meters	Square Feet	Length	Width	Ceiling	Banquet (10)	Reception	Classroom	Theater	Crescents (6)
<i>Imperial Ballroom</i>	692	7,448	95'	80'	15	350	700	294	600	240
<i>Imperial Ballroom Patio</i>	214	2,300	-	-	-	-	200	-	-	-
<i>Living Room Lounge</i>	244	2,628	81'	35'	-	-	250	-	-	-
<i>Living Room Veranda</i>	256	2,756	76'	31'	-	-	150	-	-	-
<i>Blue Monster Lawn</i>	519	5,589	69'	81'	-	250	500	-	300	-
<i>The Royal Palm Pool</i>	1,393	15,000	-	-	-	600	1,000	-	-	-
<i>The Nicklaus Courtyard</i>	557	6,000	-	-	-	300	500	-	-	-
<i>Golf Shop Patio</i>	335	3,600	63'	58'	-	200	400	-	-	-
<i>The Spa Terrace</i>	465	5,000	-	-	-	200	450	-	225	-



Trump National Doral

Trump National Doral® Miami 4400 NW 87th Avenue Miami, Florida 33178 305.592.2000
Group Sales 305.591.6453 800.936.7259 doral.sales@trumphotels.com
Catering/Conference Services 305.717.6300 doral.catering@trumphotels.com