

Vallox Capto KTC

Manual



The Vallox Capto KTC cooker hood is designed to be used above the cooker top or as a general extraction valve in the kitchen.

USING VENTILATION

For buildings with a centralized ventilation system.

The air flow of the KTC cooker hood is adjusted during setup using a joint duct valve that is installed on the hood and also serves as a fire damper.

USING THE UNIT

The cooker hood is designed to be used above the cooker top and as a general extraction valve in the kitchen.

The cooker hood has a sliding glass that can be pulled out of the cooker hood. It is recommended that the sliding glass be pushed or pulled from the aluminum strip on its front edge. Pull the glass out of the cooker hood for maximal extraction capacity.



Cooker hood light

Turn the light on or off by pressing the light switch.



PLEASE NOTE!

- Neglecting the cleaning of the grease filter can cause a fire hazard.
- The outer surfaces of the hood can become hot when the cooker or the oven is turned on.
- Flaming is forbidden underneath the cooker hood.
- Always follow the instructions provided on adjusting the efficiency of ventilation.
- Enable a sufficient supply airflow into the room if the cooker hood and non-electric devices are used simultaneously.



WARNING!

The unit is not intended for use by children under 8 or by persons with reduced sensory, physical or mental capabilities, or whose lack of knowledge and experience do not ensure safe operation of the unit. Such persons can use the unit under supervision, or by following the instructions of someone who is responsible for their safety. Do not let children play with the unit or to clean or maintain it without supervision.

MAINTENANCE

Keep the cooker hood clean. Wipe outer surfaces regularly with water containing a small amount of a mild detergent. Clean off any grease stains immediately. Do not use abrasive or corrosive detergents or tools.

Keep the grease filter clean to ensure an adequate extract air flow. The grease filter must be washed with warm water and detergent at least 1-2 times a month.

Light

The cooker hood has a long-lasting LED lighting module. If the light is not working, contact a servicing company.

Removing and mounting the grease filter



Removing the filter



Mounting the filter

- Pull the locking device of the grease filter towards the front edge of the cooker hood while pulling the grease filter downwards until it comes off.
- Wash the grease filter and leave to dry.
- Mount the grease filter back in place. Push the front edge of the filter into the pins on the cooker hood, and click the rear edge in place.

NOTE! Ensure that the locking device points downwards.

INSTALLATION

In the example, the bottom of the sides and the rear of the hood are level with the bottom of the top cabinets (see figures 1-2). In this case, a specially made cover panel is needed to hide the hood. The height of the cover panel is roughly 210 mm.

The hood can also be installed higher, even so that it touches the frame of the spice cabinet. In this case, rear corners need to be sawn off from the spice cabinet frame (see figure 3). In this mounting method, the height of the hood cover panel is 100 mm.

When the lowest possible mounting height is used, the bottom edge of the sliding glass, when pushed inside the hood, is level with the bottom of the top cabinet frames (see figure 4). The L strip is mounted on the wall as shown in figure 5. In this mounting method, the height of the hood cover panel is roughly 248 mm.

Figure 1.

Remove the spice cabinet. Mount the L strip on the wall so that it is level.

The L strip fully covers the gap between the hood and the wall and also makes it easier to balance the hood in place during mounting.

If the top cabinet frames are less than 305 mm deep, the longer edge of the L strip is mounted on the wall. The

perforations on the lower surface of the L strip can be covered using white plastic studs.

Figure 2.

Place the hood on top of the L strip so that it is level and fasten the hood on the top cabinet frames with four screws. It is vital that the hood is both vertically and horizontally level. The front panel of the hood must be at the same depth as the outer surface of the top cabinet doors.

Figure 3.

If the highest possible hood mounting height is used, saw off diagonal pieces measuring at least 20x50 mm from the spice cabinet frame.

Figure 4.

The hood when the lowest possible mounting height is used.



PLEASE NOTE!

The minimum distance of the bottom edge of the hood to an electric cooker is 426 mm and to a gas cooker 650 mm.

Figure 5.

Location of the L strip when the lowest hood mounting height is used.

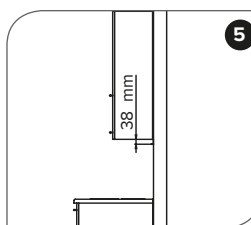
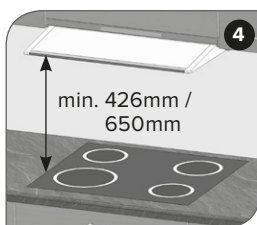
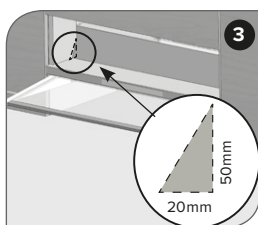
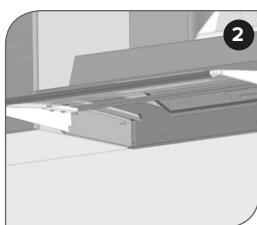

PLEASE NOTE!

- The cooker hood must not be connected to a flue that is used for removing combustion gases (e.g. from a wood- or gas-burning fireplace, cooker, or stove).
- Regulations on leading extraction air outdoors must be observed.



PLEASE NOTE!

- The power outlet used for the cooker hood must be easy to access.
- Only the power adapter that is delivered with the unit and corresponds to the voltage specified in the type plate of the unit must be used to connect the cooker hood into the mains.