Operation Manual

Meeting table A-Plus



Dear customer,

We are pleased that you have chosen our motu table. These operating instructions explain how this sit-stand table is put into operation, used, serviced and cared for.

All sit-stand tables are subjected to a function and quality test before they leave our factory. Should you still have problems with your table frame, you can contact our service department at any time.

Changes to the table frame or improper use can affect the safety, function and service life! These operating instructions are intended for the sit-stand tables of the motu furniture series A-Plus conference table with electrical height adjustment. Due to different designs / types, images may differ.

Karl Westermann GmbH + Co. KG

Content

| | |
|---|----|
| INTENDED USE | 3 |
| SYMBOLS USED SAFETY INFORMATION | 3 |
| SAFETY INSTRUCTIONS | 3 |
| GENERAL SAFETY INSTRUCTIONS | 4 |
| BEFORE INSTALLATION, UNINSTALLING OR TROUBLESHOOTING..... | 6 |
| BEFORE OPERATING | 6 |
| DURING OPERATION..... | 7 |
| IMPORTANT SERVICE NOTE..... | 8 |
| REPAIRS | 8 |
| WARRANTY | 8 |
| MAINTENANCE | 8 |
| CLEANING + CARE INSTRUCTIONS..... | 8 |
| ASSEMBLY | 10 |
| ACTIVATION..... | 14 |
| USAGE | 15 |
| INITIALISIERUNG / RESET | 15 |
| TROUBLESHOOTING..... | 17 |
| CLICK CODES OF THE CONTROL UNIT | 18 |
| TECHNICAL DATA..... | 19 |
| TESTS AND CERTIFICATES..... | 20 |
| CONTACT..... | 20 |

INTENDED USE



This sit-stand table may only be used as an office desk in the professional office sector. Modifications to the table frames are not permitted. This sit-stand table must be assembled, activated and functionally checked thereafter – by competent personnel. The use of this sit-stand table for any purpose other than that previously mentioned, e.g. as a lifting platform, seating facility, etc., is not permitted.

TARGET GROUP AND PRIOR KNOWLEDGE



The following knowledge is required for the assembling and installation of the sit-stand tables:

- Basic mechanical and electrotechnical knowledge (corresponding training).

SYMBOLS USED SAFETY INFORMATION



Danger: This safety symbol indicates a dangerous threat to the life and health of persons! Failure to observe these instructions may result in life-threatening injuries and/or damage to property.



Attention: This safety symbol indicates possible dangers due to electric current! Failure to observe these instructions may result in injury and damage to property!



Information: This safety symbol refers to important information that must be observed for the safe operation of the sit-stand table.



Danger: This safety symbol indicates the threat of a crushing hazard, deemed possible in exceptional circumstances. Failure to observe these instructions may result in harmful outcomes including, life-threatening injuries and damage to property.



Note: Reference to the obligation to read the operating instructions!

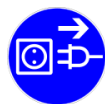

Note: The mains plug must be disconnected before the next activity!

SAFETY INSTRUCTIONS

These operating guidelines contain safety instructions which draw your attention to possible dangers; thus, enabling the safe operation of the sit-stand table. Please be sure to observe these essential safety instructions!

In this section you will find general safety instructions that do not refer to any specific work step. The activity-specific safety instructions can be found in the respective section of the assembly and

operating instructions. Further safety instructions can be found directly on the individual parts of the sit-stand table.

GENERAL SAFETY INSTRUCTIONS



Note: It is essential to read and observe the operating instructions before assembling/activating the sit-stand table!



Anyone who assembles, uses, maintains or cares for this sit-stand table must have access to these operating instructions.



Attention: Do not open the motor control unit under any circumstances! There is a risk of electric shock.



Attention: The sit-stand tables are not designed for continuous operation. The table top height must not be adjusted without interruption for longer than the duty cycle indicated on the type plate.



Attention: The motor control unit may only be operated with the mains voltage specified on the type plate! (Please Note: UK 240v) Before activation, check whether the mains voltage on the type plate of the motor control unit matches your mains voltage!



Danger: The sit-stand table can be used by children aged from 8 years and above and persons with reduced physical, sensory or mental capabilities or lack of experience and knowledge – if they have been given supervision or instruction concerning to use the sit-stand table in a safe way and understand and appreciate the hazards involved.



Danger: Children must not play with the device!



Danger: Cleaning and user maintenance must not be carried out by children without supervision.



Attention: Be sure to use only the power supply cable supplied! Make sure that the power supply cable is not damaged. Operating the sit-stand table with a damaged power supply cable is prohibited!



Attention: If the power supply cable of this device is damaged, it must be replaced by the manufacturer; or its customer service; or a similarly qualified person, in order to avoid hazards



Attention: Before connecting or disconnecting drive units, hand switches or other accessories to the motor control unit, be sure to always disconnect the power supply cable from the mains.



Attention: Only use original accessories from Karl Westermann GmbH + Co. KG. The use of parts and components from third parties is prohibited!

The use of unsuitable accessories may result in damage to or destruction of the table frame.



Attention: In case of a malfunction (e.g. unintentional moving of the table top, e.g. if a key of the hand switch gets stuck) please pull the mains plug immediately!



Danger: Protect the table frame and especially all electrical components on the table frame from moisture – dripping, sprayed or splashed water!



Danger: There is a danger of crushing when changing the position of the table top! Therefore, make sure that there are no objects or persons in the danger area and that there is strictly no reaching into the danger area! Due to the optionally available 'Collision Protection', solid objects are usually detected, but the crushing hazard for persons still exists! The 'Collision Protection' is a system protection and NOT a personal protection!



Danger: All moving parts of the table frame must have the required safety distance of min. 25 mm to adjacent structures.



Attention: Modifications to the components of the table frame, including the motor control and the manual switches, are prohibited!



Danger: The electric motor-driven sit-stand table must not be operated in an explosive atmosphere!



Danger: In the case of a malfunction, the tabletop may jolt a little, move slightly, before the safety shutdown kicks in. Be aware of a possible crushing hazard.



Danger: The optionally available 'Collision Protection' is not active during all reset processes (section INSTALLATION/RESET). Be aware of a possible crushing hazard.



Attention: If the product is visibly damaged, makes unusual noises or causes an odour to develop, it must not be assembled or employed any further!



Attention: never place the table on one side and never drop it. Damage to the side parts and the motor may occur.

BEFORE INSTALLATION, UNINSTALLING OR TROUBLESHOOTING

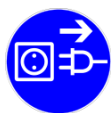

- Deactivate the sit-stand table.
Note: Switch off the power supply and disconnect the power cord!
- Relieve the sit-stand table of any weight.
- Accessing or replacing the electrical systems may only be carried out by qualified electricians.
- The table must not be operated in damp rooms, e.g. such as bathrooms.
- The table must not be used in potentially explosive atmospheres.

BEFORE OPERATING

- Make sure that the table has been assembled according to these instructions.
- Check that the operating voltage of the table corresponds to the local power supply. (see data-plate on the control unit, standard = 230V/240V).
- Connect the plugs from the manual switch and the side panels to the control unit.
- Connect the power cable of the control unit to an electrical outlet.
- Align the table horizontally using the height adjusters (depending on the version).

Make sure:

- That there are no objects or persons within the lifting / moving range of the table, see below.
- That there is a 25mm safety distance to all surrounding structures maintained (e.g. neighbouring furniture, walls, etc.)
- That there is sufficient cable length of any electrical devices on the table.
- For faultless functionality of the sit-stand table, the place of installation must meet the following conditions:
 - The floor must have sufficient load-bearing capacity.
 - The floor must have a level surface.
 - Relative humidity 5% -80% (non-condensing)
- Attention: Please test the function of the "container stop" (see p.16) when activating the table.
- After assembly; or if the table has been disconnected from the power supply for a period of time and there has been a malfunction with the table; or, if the connection between the drive units and the control unit has been disconnected – the control unit of the table must be INITIALISED, see p.16.

DURING OPERATION

- If the drive unit or the control unit cause unusual noises or produce an odour during operation, disconnect the power supply.
- Make sure that the cables are not damaged.
- When operating the sit-stand table, make sure that no objects or body parts can become trapped



- All moving parts of the table frame must have a distance of minimum 25 mm to adjacent objects/structures.

- Ensure that there is sufficient cable length for the electrical systems of the table



- Attention: Risk of collision and crushing: Make sure that there are no objects within the travel range of the table, i.e. no objects under the table (e.g. roll container, wastebasket, etc.) or, above the table (shelf, open window sash, etc.) with which the sit-stand table could collide during height adjustment.

The table moves downwards up to 720mm (upper edge of table top, corresponds to approx. 570mm clear height) and stops at ("container stop"). The table moves upwards to a height of approx. 1290mm (upper edge of table top).

If these settings do not suit your conditions, you can deactivate or change the "container stop" up to a minimum height of 640mm (top edge of table top, corresponds to approx. 570mm clear height). Furthermore, an additional "shelf stop" can be programmed in. Both are described on p. 16.



IMPORTANT SERVICE NOTE



Danger: Only use original accessories! These may only be installed by expert service personnel! Otherwise you may invalidate warranty and guarantee claims.



Danger: In the event of a malfunction, please contact your customer service immediately! Only original spare parts are permitted for repairing the sit-stand table. These may only be replaced by expert service personnel! Otherwise, you may invalidate your warranty and guarantee claims.

REPAIRS

In case of a technical defect on this device, please contact a customer service authorised by us. The solution for simple possible error cases can be found in the section: Error messages!



Attention: In order to avoid malfunctions, all repairs must be carried out by authorised service personnel only.



Attention: If components of this sit-stand table are opened, there is a risk of subsequent malfunctions.

WARRANTY

For these table frames we provide a warranty for a period of 24 months. The warranty covers all material and production defects and is valid from the production date (see data-plate). The warranty is only valid on condition that the table frames have been properly and professionally assembled and used within the described parameters; and that maintenance has been carried out correctly; and that repairs have only been carried out by authorised service personnel.

The sit-stand table must not be handled or used improperly and no modifications may be made to the table frame, otherwise the warranty will be voided.

MAINTENANCE

Remove dust and dirt from the table frame, especially from the guide tubes, at regular time intervals and make sure that there are no damages or cracks.

Check all fastening screws for tightness and check that all connections, cables and plugs, function accordingly.

CLEANING + CARE INSTRUCTIONS



Danger: The control unit, the manual switch and the table frame, in particular the lifting column, may only be cleaned with a dry or slightly moistened cloth. Danger to persons!



Attention: Aggressive cleaning agents may cause damage or colour changes to the product. Therefore, only agents with a pH value of 6-8 may be used.



Danger: No liquid may get into the system (control unit, manual switch, cable and rack).
Danger to persons!

Powder-coated metal surfaces

Clean powder-coated metal parts with soft, lint-free cloths and water (with the exception of the lifting column, which must only be cleaned dry, see above). Please always clean metal surfaces carefully, without scrubbing, to avoid scratches.

Special instructions:

Please do not place sharp-edged objects or objects with abrasive surfaces on the finished surface to avoid unwanted scratches.

Melamine resin-coated surfaces / HPL compact board

Plastic-coated surfaces consist of resin-impregnated decorative papers and are characterised by very high wear resistance. Although liquids cannot penetrate the material, soiling or stains must be wiped away immediately. Simply clean the surface with warm water and then dry it with a paper or soft cloth. If soiling cannot be removed with this, use mild, commercially available cleaning agents that have no abrasive ingredients. Depending on the degree of soiling, it is advisable to allow the cleaning agent to act accordingly. Then rinse with water and dry. Remove all residues of the cleaning agent to prevent streaking. Wipe the surface dry with a clean, absorbent cloth or paper towel. The above procedure can be improved using a cleaning sponge or nylon brush.

Lacquered wood surfaces / OSB

Lacquering protects the wood surface against contamination with a transparent, hard film. As a result, the wood surface is very well protected against the penetration of impurities. The smooth surface allows easy and simple maintenance. However, any liquids should be immediately wiped dry with an absorbent soft cloth.

To clean the surface, it is best to wipe only with a soft, dry cloth; only, if necessary, with a soft damp cloth and then wiped dry with an absorbent cloth. For stubborn stains, curd soap (or domestic) or a PH neutral cleaner can be used. Please do not use furniture polish or furniture sprays! They can attack the lacquer surfaces or lead to streaking!

Special notes:

Furniture made of solid wood are high-quality natural products. They react to their environment: the colour of the wood may change slightly when exposed to light. Excessive fluctuations in ambient temperature and humidity should be avoided if possible, as it can lead to cracking and warping. Please do not place sharp-edged, abrasive or very heavy objects with a small footprint on the wooden top; this could cause unwanted scratches or indentations.

Linoleum surfaces

Loose dirt can be removed by dusting cloths or vacuuming. To remove adhering dirt, use a suitable cleaning agent (neutral cleaner or a special cleaner for linoleum with pH <9, e.g. "HARell") diluted

in water according to the manufacturer's instructions. Soak a soft cloth with cleaning solution and wring out well. Wipe the linoleum surface clean with it. In the case of stubborn dirt and stains, apply the undiluted cleaning agent to a soft cloth and clean the dirt with it, if necessary use a white cleaning pad. Take up the loosened dirt with a clean, absorbent cloth and then wipe the surface with a damp cloth moistened with clear water. To care for and freshen up dull surfaces: after thorough cleaning, apply a care emulsion for linoleum (e.g. from "HARell") to a lint-free cloth and spread it very thinly over the linoleum surface with the cloth in circular movements. After drying, the surface should be polished with a soft cloth or a soft polishing pad.

Special notes:

Particularly in the post-oxidation phase, a "yellow cast" develops on linoleum. This is particularly noticeable in light colours, but disappears completely when exposed to UV light, and the linoleum reverts to its original colour. On the other hand, this "yellow cast" reappears if, for example, the surface of the covering is covered with monitors, mouse pads, etc. for an extended period of time, but disappears; as described above, as soon as the covering is exposed to daylight again. This "yellow cast" cannot be removed by cleaning. Flowerpots and tubs, etc., made of terracotta, or clay, can leave discolourations on linoleum, please use suitable coasters. Hand and equipment disinfectants may cause staining due to their high solvent content, please use only surface disinfectants suitable for linoleum; whenever, the linoleum surface needs to be disinfected. Carrying out a test is advisable beforehand on a sample piece; or a non-visible area.

ASSEMBLY

For the assembly of the table frame, use only the supplied screws according to the enclosed assembly drawing.



Attention: Incorrect screws can cause damage to the table.



Danger: The mains cable of the motor control unit must be disconnected from the mains during assembly of the table frame!

1) Assembly of the foot stabiliser

The version of the table base A-Plus in steel or with attached wooden base is preassembled. No further work step is necessary here.

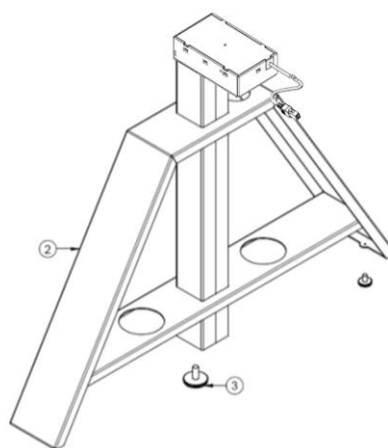

Feet A-Plus

2) Assembly of the traverse

Assemble the traverse upon both/the three feet. For this purpose, use only the supplied M6x30 cylinder head screws and the pressure bushings according to the assembly drawing! The maximum tightening torque for these screws is 7.5Nm. The maximum screw-in depth into the motor housing is 5mm. These screws may only be used with pressure bushings, otherwise there is a risk that the drive unit will be damaged!

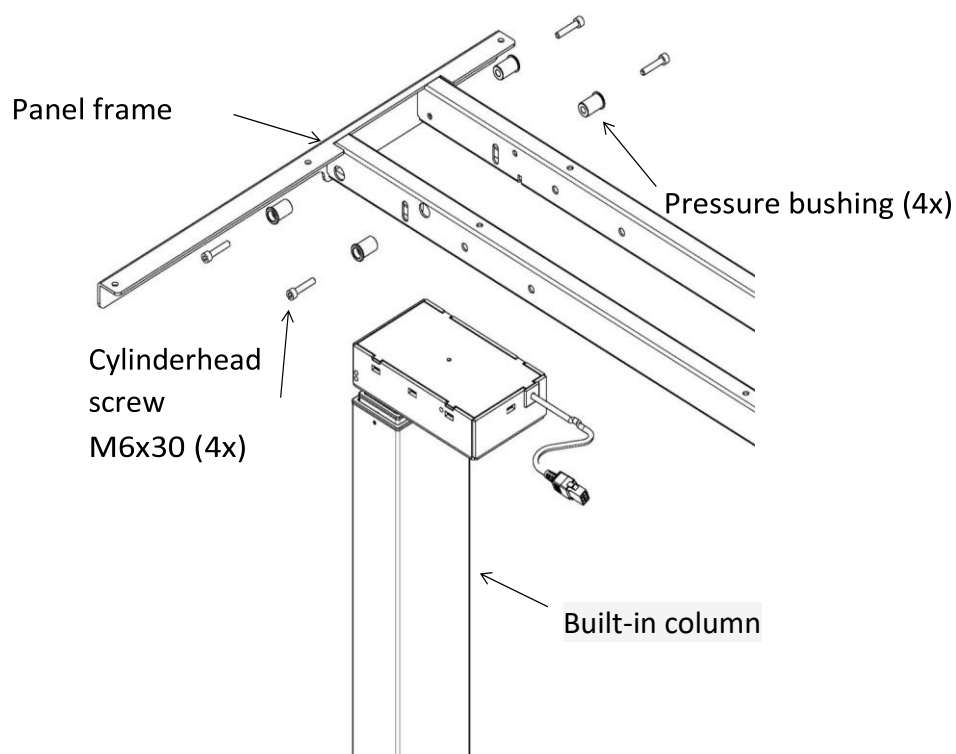

3) Mounting the connecting plate

Place the connecting plate over both plate supports. Affix the connecting plate to the traverse and the foot with screws no. 5. The screws No. 6 are pushed from the inside to the outside through the traverse and screwed into the pre-threaded connecting plate. Screw the cap nuts onto the opposite side.

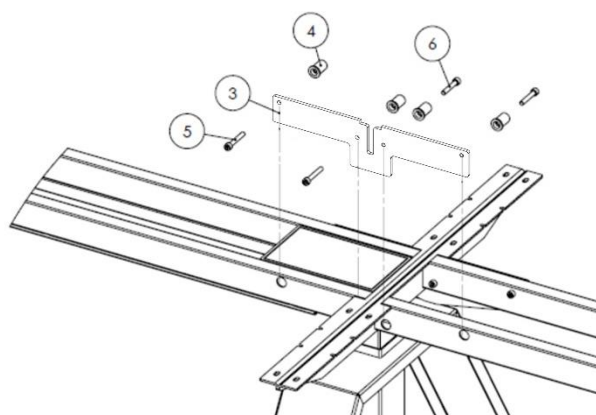

4) Mounting the tabletop

Now fasten your tabletop to the table frame using the supplied fastening material (screws in a labeled bag). The holes for the manual switch are located on the front edge. Holes or screw points are provided on the framework and the tabletop for this purpose. All the screw points provided must be used.

Optional: For tabletops divided into two parts, first push the Clamex connectors into the grooves provided on the front side. Bring the two table top halves together and carefully tighten the Clamex connectors with an Allen key.

5) Wiring

1) Connections to the motor control unit

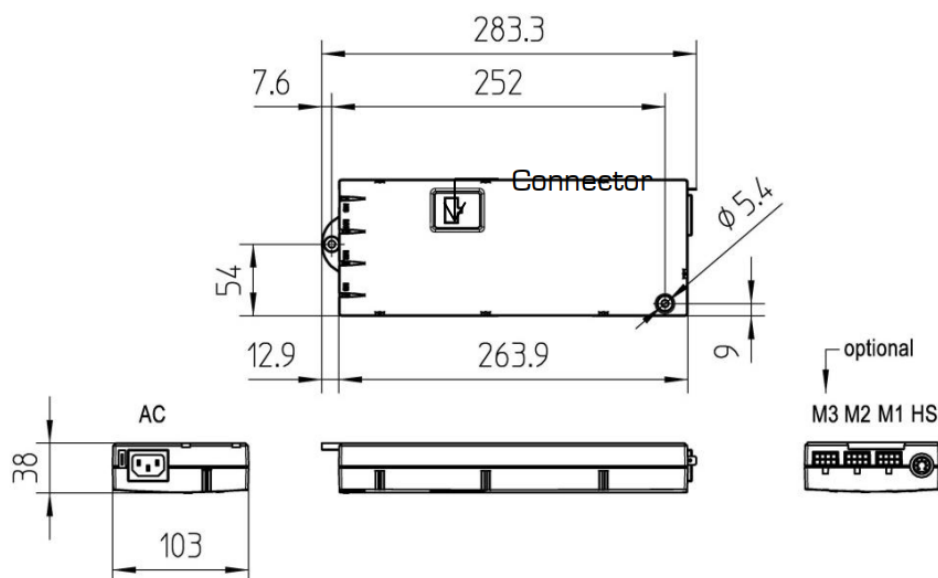

- M1-M3 = Connections for the motors
- HS = Connections for manual switch
- AC = Connections for the mains cable 3 - pin
- Connector = Connectors for optional external sensor



Attention: Do not plug in the mains cable until all other electrical connections have been coupled! (All motors, the manual switch and possibly other accessories are connected to the control).

2) Connecting drive units

Make sure that the connection cables of the drive units reach from both sides to the corresponding connection of the control unit. For this purpose, use the extension cable for one of the two outer motors.

Couple the connection between the drives of the side panels and the control unit by means of the motor cable. The plug connections on the 8-pin motor sockets must engage firmly!

For controls with more connections for drives than there are actual drives, you must start with the connection (M1). (Excess connections may remain free).



Note: When connecting the motor cables, it is essential to observe the sequence M1, M2, M3!

3) Connect manual switch

Connect the Y adapter plug from the manual switch to the 7-pin manual switch socket (HS) on the control unit. Connect the two manual switches to the Y adapter plug.

4) Connect power supply cable / mains cable



Attention: Before connecting the power supply cable, check again whether the mains voltage corresponds to the type plate of your control unit and whether all components are coupled to the appropriate sockets.

The motor control unit is ready for operation when the power supply cable is plugged in!



Note: When connecting the power supply cable/power cord for the first time, INITIALISATION of the table frame (RESET) is required, this is described in section INITIALISATION/RESET



Attention: Only use the supplied power cable! The motor control unit requires 3-pin power cable with protective earth.



Attention: Affix all cables to the table frame or to the tabletop so that no damage can occur during operation.



Attention: Please test the function of the container stop (see p.16) when operating the table.

6) Assembly of the manual switches

Next, affix the manual switch on the tabletop centrally on both sides using the supplied fastening material (screws in a labeled bag). Holes or screw points are provided for this purpose on the manual switch and in the tabletop.

7) Mounting the cable tray

Mount the cable trays [7] to the traverse using the supplied fastening material (screws in labeled bag [12]). Holes or screw points are provided on the traverse for this purpose.

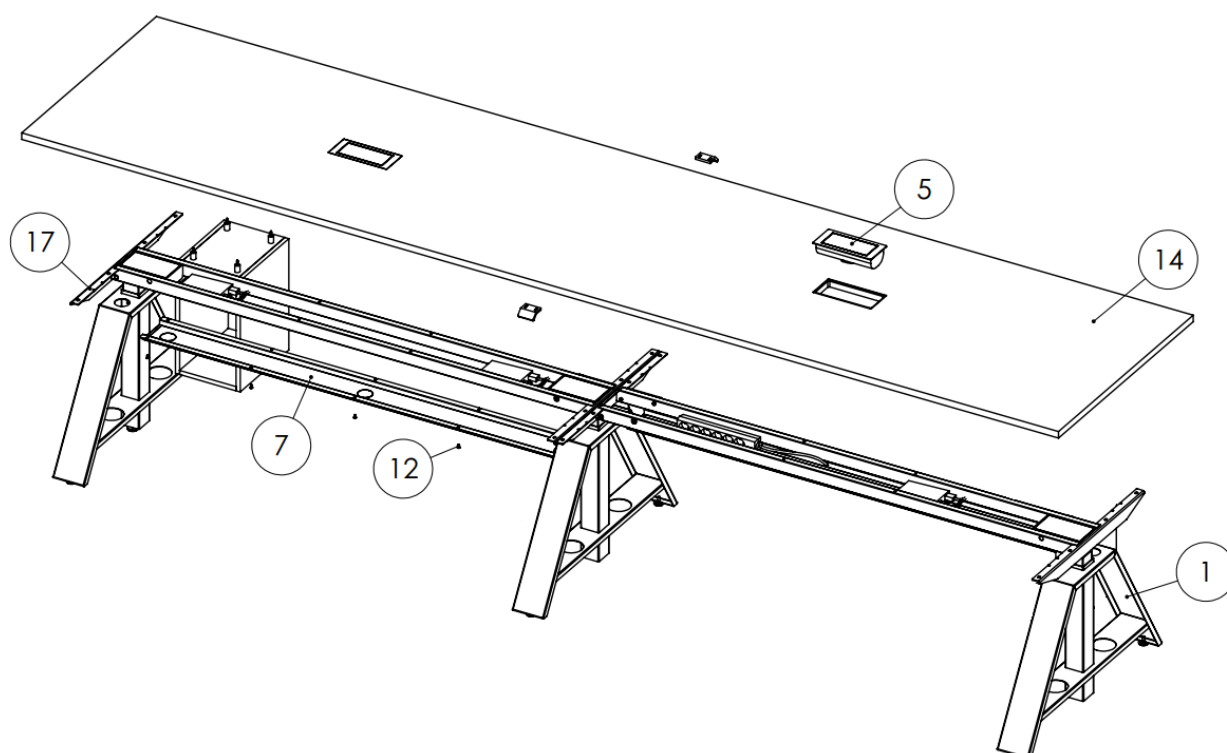

ACTIVATION

Initiating includes those activities, which are required to allow an electric height-adjustable sit-stand table to be adjusted in height using the motor control.

The prerequisites for activation are:

- the table frame is completely assembled
- the motor control and the manual switches are mounted



Danger: The motor control unit may only be activated up by trained and qualified personnel! Qualified personnel must have the required electrical engineering training and be familiar with these operating instructions.



Attention: Before assembling and initiating the sit-stand table, ensure that the product is acclimatised for operation to the temperature and humidity values specified in the technical data!

USAGE

Use the Up and Down keys to move the table up or down in the direction of the arrows, the table stops when the end positions are reached. Keep the key pressed until the desired position is reached.

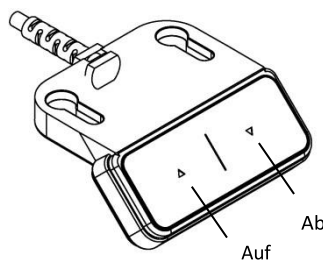

INITIALISIERUNG / RESET

After assembly, or if the table has been disconnected from the power supply for a period of time and there has been a malfunction with the table; or if the connection between the drive units and the control unit has been disconnected – the control unit of the table must be initialised.

If the control unit requires a fresh initialisation, only the downward movement of the table, with a reduced speed, is possible.

To initialise, move the table to the lowest position - to do this, keep the down key on the manual switch pressed until all drive units have reached the lowest position. Then press the down key again and keep it pressed (approx. 5 seconds) until the table has made a slight downward and upward movement, do not release the key until the table stops moving. Releasing the button too early will cause the table to malfunction, if this happens accidentally you will need to repeat the process.



Attention: The stop position is pre-programmed in the control unit. For this reason, only controls that have been supplied to fit the respective table frame may be used!



Danger: The optionally available collision protection is not active during all reset processes. Pay attention to a possible danger of crushing.

1) Container-Stop and Shelf-Stop-Position

These two functions can be used to limit the travel range of the sit-stand table (if, for example, a container is under the sit-stand table or a shelf is situated above the table). A solitary 'container-stop' position can be set in the lower half of the travel range, a solitary 'shelf-stop' position in the upper half of the travel range. If a 'container-stop' position is set, this is used as the lower end position, a 'shelf-stop' position therefore corresponds to the upper end position of the travel range.

To save a container or shelf stop position, proceed as follows:

- Fahren Move the sit-stand table to the position that you want to use as the new container or shelf stop position.
- Now press the Up and Down keys simultaneously for 10 seconds. The control unit confirms the saving process with a double-click sound.

To deactivate a container or shelf stop position, proceed as follows:

- Move the sit-stand table to any position in the lower half of the travel range to deactivate the container stop or to the upper half of the travel range for the shelf stop position.
- Manual switch Up/Down: Now press the Up and Down keys simultaneously for 10 seconds until you hear a click sound, then the function is switched on or off.



Note: These steps must be performed separately for the container stop position and for the shelf stop position!

TROUBLESHOOTING

| Error | Reason | Solution |
|---|--|--|
| Tisch fährt nicht | No power supply | Plug in power cable If necessary, check the plug connection on the control unit |
| | No or loose connection to the drives/side parts | Check the electrical power connections of the motor cables to the control unit and to the drives. |
| | No connection to the Manual switch | Check the electrical power connection on the control unit. |
| | Max. lifting force exceeded | Reduce weight |
| | Max. duty cycle exceeded | The control unit reactivates automatically after approx. 3 minutes ATTENTION! The maximum procedure time of 2 minutes is only available again after a rest period of 18 minutes. |
| | Drive defective | Contact customer service |
| | Control unit defective | Contact customer service |
| | Manual Switch defective | Exchange manual switch |
| Table moves down only slowly | Control unit requires fresh Initialisation | See Initialisation, page 20 |
| Table moves only slowly | Max. lifting force exceeded | Reduce weight |
| Table moves only briefly on one side and then stops | No or loose connection to the drives/side panels | Check/reconnect the motor cable connections of the control unit and the drives. |
| | Drive defective | Contact customer service |

If an error cannot be corrected as described, unplug the mains, wait a few minutes and try to initialize the table again! If an error still occurs repeatedly, disconnect the table from the mains and contact the customer service.

CLICK CODES OF THE CONTROL UNIT

As soon as power is supplied to the motor control unit, the control unit uses the built-in relays to inform the user acoustically about the system status; and in addition, informs about the reason of the last shutdown.

| Click count | When | Status-Information |
|-------------|---------------------|--|
| 2x | plugged in to mains | Normal operation: The system works without problems |
| 1x | | Emergency operation: The system is in emergency mode, the drives cannot be used. Check the LEDs if present and/or the error code on the display of the manual switch. |
| 3x – 6x | | Last shutdown incomplete / forced reset: Check the LEDs if present and/or the error code on the display of the manual switch. |

TECHNICAL DATA

Drive system with motor control for table A, table A Plus, Meeting Table A Plus

General

| | |
|--|-------------------------------|
| Supply voltage | 207-254,4 V / 50-60 Hz |
| Rated voltage | 220-230 V / 50-60 Hz |
| Standby power at nominal voltage, primary (typical) | ≤0.3 W |
| Ambient temperature during operation | 0-30°C |
| Permissible relative humidity (for operation) | 5-85% (non condensing) |
| Storage and transport temperature | -40°C bis +85°C |
| Permissible relative humidity (for storage) | 5-90% (non condensing) |
| Protection class | I |
| IP class | IP 20 |
| Max. Duty cycle | 10% (2 min. on / 18 min. off) |
| Nominal stroke speed of the drive columns (decreases under max. load) | 38 mm/s |

Table frame with 2 drive units

| | |
|-----------------------------------|-------------------|
| Lifting force max. | 1000 N (≈ 100 kg) |
| Range | 650 - 1250mm |
| Power consumption max., primarily | 360 W |

Table frame with 3 drive units

| | |
|-----------------------------------|-------------------|
| Lifting force max. | 1300 N (≈ 130 kg) |
| Range | 650 - 1250mm |
| Power consumption max., primarily | 360 W |

TESTS AND CERTIFICATES

The drive system is tested according to:

Electromagnetic Compatibility (EMC Directive 2014/30/EU).

- EN 61000-6-2:2005 Electromagnetic Compatibility (EMC)
- EN 61000-6-3:2007 + A1 Electromagnetic compatibility (EMC)
- EN 61000-3-2:2006 + A1 + A2 Electromagnetic compatibility (EMC)
- EN 61000-3-3:2008 Electromagnetic compatibility (EMC)

Electrical safety (Low Voltage Directive 2014/35/EU)

- EN 60335-1:2012 Safety standard of electrical devices for household and similar purposes

Safety-related parts of control units

- EN ISO 13849-1:2008 Safety standard of machinery
Safety-related parts of control systems
Performance level "b"

Please keep this instruction manual for future reference.

CONTACT

wp_westermann products

Telefon: +49 (0711) - 93 44 60 - 0
Telefax: +49 (0711) - 93 44 60 - 50

E-Mail: info@westermann-products.com
Webseite: www.westermann-products.com

wp westermann
products

