



BRADFORD WHITE
WATER HEATERS

— BRADFORD WHITE IS —
AMERICAN STRONG

RESIDENTIAL WATER HEATERS & STORAGE TANKS POCKET CATALOG

Products made by Bradford White are manufactured in the United States using the finest raw materials and components from around the world.

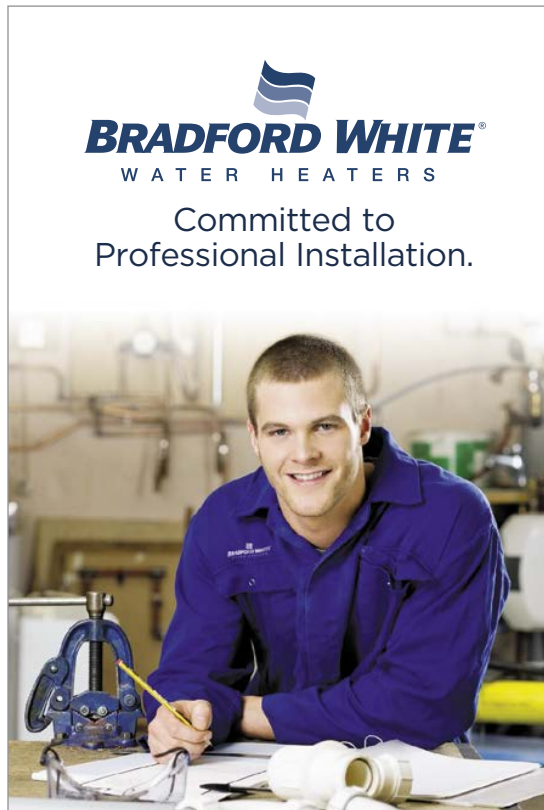

Committed to
Professional Installation.

SALES DEPARTMENT

For questions regarding where to purchase water heaters or who your local Bradford White representative is, call:

800-523-2931

24/7 TECHNICAL SUPPORT

For questions during and after installation, including sequence of operation, diagnosis, and repair assistance.

Phone: 800-334-3393

Email: techserv@bradfordwhite.com

PRODUCT SUPPORT

Pre-Installation support such as product sizing, performance, application, and clarification questions.

Phone: 844-235-4958

Email: products@bradfordwhite.com

24/7 WARRANTY SUPPORT

For questions regarding tank and/or parts warranty and limitations on warranties.

Phone: 800-531-2111

Email: warranty@bradfordwhite.com

Products made by Bradford White are manufactured in the United States using the finest raw materials and components from around the world.



To see Bradford White's complete line of products visit:

www.bradfordwhite.com

© 2022, Bradford White Corporation, USA. All Rights Reserved.

RPC-0122

What American Strong means to Bradford White.

American Pride has always been in everything we do. Bradford White began over 135 years ago with a simple vision, to deliver high quality, superior products made by American craftspeople.

We are committed to American manufacturing. We are an American-owned company, with all our manufacturing facilities located in the United States. Bradford White proudly employs over 1,800 people at our American facilities.

We proudly support the professional. At Bradford White, we focus on the professional. Our quality product deserves a quality installation.

American Strong...around the world. Bradford White products are available to professionals around the world. For example, our Halton Hills, ON sales, training and distribution center provides full support to our Canadian customers.

Built to be the Best®. Bradford White proudly brings American ingenuity and quality to customers around the world. By combining American Strong manufacturing with select components and products sourced from top international partners, the result is all Bradford White products are Built to be the Best® - now and in the future.



Products made by Bradford White are manufactured in the United States using the finest raw materials and components from around the world.



WE'RE HERE FOR THE PRO.

And We Mean It.

At Bradford White, our business is being there for your business. Our job is to help you serve the needs of contractors, installers and specifying engineers. And that's not just talk - we stand behind you every day. **When you sell Bradford White, you can always count on getting:**

Built to be the Best® water heaters, boilers and tanks that deliver top quality, high performance and unmatched reliability.

Unparalleled Tech Sales Support, so you have all the resources you need to make sure the needs of your customers are met.

Marketing Materials to help you communicate with your professional customers and prospects more effectively than ever before.

Our Exclusive For The Pro® Website - full of tools to help you build your business and ensure your success.



Visit bwforthepro.com to learn more!

FOR THE PRO



Products made by Bradford White are manufactured in the United States using the finest raw materials and components from around the world.

Contents

🏠 Residential Water Heaters

🔥 GAS

Atmospheric Vent High EF.....	8/9
Atmospheric Vent Damper.....	10/11
Atmospheric Vent Models.....	12/13
Atmospheric Vent High Input.....	14/15
Direct Vent.....	16/17
High Efficiency eF Series® Power Vent.....	18/19
Power Vent (TTW®).....	20/21
eF Series® Power Direct Vent.....	22/23
Power Direct Vent.....	24/25
Manufactured Home Closed Combustion/Direct Vent.....	26/27
Manufactured Home Atmospheric Combustion.....	28/29
Ultra Low NOx Atmospheric Vent Damper.....	30/31
Ultra Low NOx Atmospheric Vent.....	32/33
Ultra Low NOx Atmospheric Vent High Input.....	34/35
Ultra Low NOx TTW® Power Vent.....	36/37
Ultra Low NOx Power Direct Vent.....	38/39
Ultra Low NOx Direct Vent.....	40/41

Infiniti® K Series Tankless Indoor.....	42/43
Infiniti® K Series Tankless Outdoor.....	44/45
Infiniti® L Tankless Indoor.....	46/47
Infiniti Tankless® High Efficiency.....	48/49
Infiniti Tankless® Mid Efficiency.....	50/51

⚡ ELECTRIC

General Information.....	52/53
AeroTherm® Series Heat Pump.....	54/55
Upright Models.....	56/57
Lowboy Models.....	58/59
Utility.....	60/61
Powerful Compact®.....	62/63
KwickShot® Tankless Electric Water Heaters.....	64-67

☀️ SOLAR

Solar Saver® Electric Backup.....	68/69
-----------------------------------	-------

HYDRONIC SPACE HEATING

Combi1® Single-Wall Atmospheric.....	70/71
Combi1® TTW® Single-Wall Power Vent Models.....	72/73
Combi2® Double-Wall Atmospheric Models.....	74/75
Combi2® TTW® Double-Wall Power Vent.....	76/77

INDIRECTS

PowerStor Series® Single-Wall Indirect.....	78/79
PowerStor2™ Series Double-Wall Indirect.....	80/81
PowerStor Series® SS Single-Wall Indirect.....	82/83

STORAGE TANKS

Storage Tank.....	84/85
-------------------	-------

Warranty Information.....	86
---------------------------	----

Tank Type Serial Number Identification.....	87
---	----

Some products may not be available in Canada. Please check with your supplier for product availability.

General Information About the Products in this Catalog

1. All Gas Water Heaters are design certified by CSA International (formerly AGA and CGA) in accordance with ANSI Z21.10.1 or 10.3 (latest addition). Closed Combustion Manufactured Home Water Heaters, are listed by Intertek (ETL).
2. All Electric Water Heaters are listed by Intertek (ETL).
3. All Residential Storage Models meet or exceed efficiency requirements of the Department of Energy. ASHRAE standard 90.1b (current standard) and the National Appliance Energy Conservation Act of 1987, recent amendment effective April 16, 2015 which supercedes all state and local efficiency requirements.
4. All Tank Type Water Heaters are certified at 300 PSI test pressure and 150 PSI working pressure (except where noted).
5. All Residential Water Connections are ¾" NPT on 8" centers (except where noted).
6. All Residential Gas Models have ½" NPT Gas Connections (except where noted).
7. All Residential Water Heaters come with a T&P Relief Valve included (except where noted).
8. MANUFACTURED UNDER ONE OR MORE OF THE FOLLOWING U.S. PATENTS: 5,682,666; 7,634,976; 5,660,165; 5,954,492; 6,056,542; 6,935,280; 5,372,185; 5,485,879; 5,574,822; 7,971,560; 7,992,526; 6,684,821; 7,334,419; 7,866,168; 7,270,087; 7,007,748; 5,596,952; 6,142,216; 7,699,026; 5,341,770; 7,337,517; 7,665,211; 7,665,210; 7,063,132; 7,063,133; 7,559,293; 7,900,589; 5,943,984; 8,082,888; 5,988,117; 7,621,238; 7,650,859; 5,761,379; 7,409,925; 5,277,171; 8,146,772; 7,458,341; 2,262,174. OTHER U.S. AND FOREIGN PATENT APPLICATIONS PENDING. CURRENT CANADIAN PATENTS: 2,314,845; 2,504,824; 2,108,186; 2,143,031; 2,409,271; 2,548,958; 2,112,515; 2,476,685; 2,239,007; 2,092,105; 2,107,012.
9. All dimensions are in inches (unless otherwise noted). Dimensions and specifications subject to change without notice in accordance with our policy of continuous product improvement.
10. All products manufactured by Bradford White Water Heaters are designed, fabricated, and assembled in Middleville, MI. All raw materials and component parts are sourced from American companies for the highest level of American made content and manufacture, whenever possible.



Air-Conditioning, Heating,
and Refrigeration Institute



American Society
of Mechanical Engineers
Heating Boilers



American Society of
Mechanical Engineers Lined
Potable Water Heaters



Compliance, Safety,
Accountability



CSA International



Intertek



Intertek

Intertek



Underwriters
Laboratories

INNOVATION AND RESOURCES



The Hydrojet® Total Performance System

The Hydrojet® Total Performance System helps reduce the accumulation of sediment buildup within the water heater resulting in better efficiency, longer tank life, more consistent temperatures, and a larger volume of hot water to meet your customer's needs.



Vitrage®

Bradford White water heaters are lined with the exclusive Vitrage® enamel to provide unsurpassed protection so your customer's water heater lasts longer.

INNOVATION AND RESOURCES

The Defender Safety System® and Eco-Defender Safety System®

Designed for our gas-fired water heaters, the Defender Safety System® and Eco-Defender Safety System® helps protect families and their homes by resisting the ignition of flammable vapors from a spill outside the water heater. This technology gives them the peace-of-mind that their water heater will provide hot water safely and efficiently.

DEFENDER
SAFETY SYSTEM®

Eco-DEFENDER
SAFETY SYSTEM® WITH SCREENLOK® TECHNOLOGY
ULTRA LOW NOx SERIES



The Bradford White ICON System® Intelligent Gas Control Valve

The ICON System™ is an exclusive gas control technology that provides you with numerous performance and energy-saving benefits such as an enhanced First Hour Delivery ratings and tighter temperature differentials. Intelligent Diagnostics assist in installation and troubleshooting through a multi-color LED light easily visible from a standing position.

BRADFORD WHITE
ICON
System®

page 6

Online Resources

Bradford White's newly redesigned website is loaded with easy-to-use tools that can help save you a lot of time in the field. These resources include RightSpec® sizing tools and cross reference, eF Series® calculator, tank size calculator, spec sheets and more.

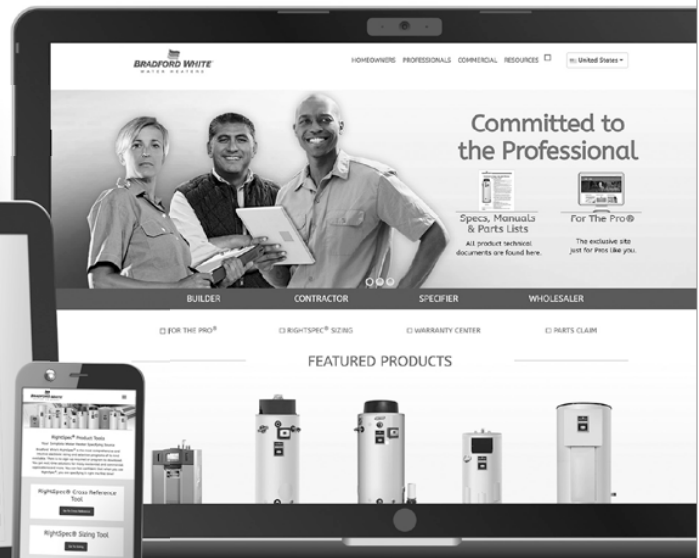

Visit bradfordwhite.com now to see all the resources available to you.

page 7



Residential Gas Atmospheric Vent High EF Models

8/9

- ENERGY STAR® Qualified
- High Efficiency Blower
 - 10 ft. Power Cord Included (120 VAC)
- Bradford White ICON System®
 - Enhanced Performance
 - Advanced Temperature Control System
 - Intelligent Diagnostics
 - Separate Immersed Thermowell
- Defender Safety System® featuring the patented Advanced ScreenLok® Technology flame arrestor design
 - Flammable Vapor Sensor
 - Maintenance-Free
 - Sight Window
 - Pedestal Base
- Hydrojet® Total Performance System
- Vitraglas® Lining
- 2" Non-CFC Foam Insulation
- Water Connections—3/4" NPT true dielectric fittings
- Heat Traps
- Protective Magnesium Anode Rod
- 3"x4" "Snap Lock" Draft Diverter
- T&P Relief Valve
- Low Restrictive Brass Drain Valve

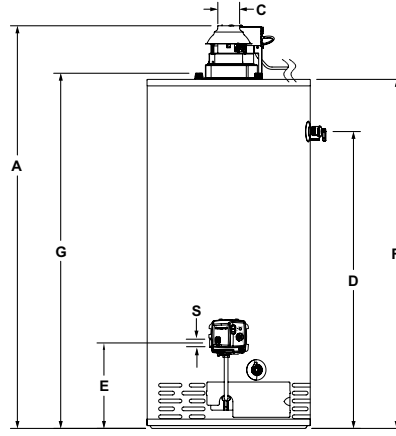
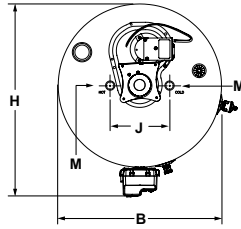

RG2F40S6N

page 8

Atmospheric Vent High EF Models

DIMENSIONS IN INCHES

Meet or exceed ASHRAE 90.1b (current standard) C.E.C. Listed
78% Recovery Efficiency

Model Number	Nominal Gal. Capacity		DOE Rated Storage Volume (Gal.)	BTU/Hr. Input		First Hour Rating (Gal.)	Uniform Energy Factor	Recovery at 90°F Rise*			
	U.S. Gal.	Imp. Gal.		BTU/Hr. Input	LP BTU/Hr. Input			U.S. GPH	Imp. GPH	U.S. GPH	LP GPH
★ RG2F40S6N	40	33	38	38,000	38,000	75	0.70	41	33	40	33
★ RG2F50S6N	50	42	48	38,000	38,000	76	0.68	41	33	40	33

Get additional product information, technical documentation, training videos and more at our exclusive site for the professional.

FOR THE PRO bwfortheapro.com

Model Number	A Floor to Exhaust Conn. in.	B Jacket Dia. in.	C Vent Size in.	D Floor to T&P Conn. in.	E Floor to Gas Conn. in.	F Floor to Top of Heater in.	G Floor to Water Conn. in.	H Depth in.	J C/L of Water Conn. in.	M Water Conn. NPT in.	S Gas Conn. Size in.	Approx. Shipping Weight lbs.
★ RG2F40S6N	54 1/4	22	3 or 4	40	13	47	47 7/8	25 7/8	8	3/4	1/2	150
★ RG2F50S6N	55 1/4	24	3 or 4	40 3/8	13	48	48 7/8	27 7/8	8	3/4	1/2	176

Propane models feature a Titanium Stabilized Stainless Steel propane burner. For Propane (LP) models change suffix "N" to "X".

For 10 year models, change suffix from "6" to "10".

* Based on manufacturer's rated recovery efficiency.

120V, 60Hz, 1 Amp.

Uniform Energy Factor and First Hour Rating are based on the latest AHRI directory listings.

★ = ENERGY STAR® Qualified.



Spec 1124. For additional documentation visit: www.bradfordwhite.com/documentation

page 9



Residential Gas Atmospheric Vent Dampener Models

10/11

- ENERGY STAR® Qualified
- Bradford White ICON System®
 - Enhanced Performance
 - Advanced Temperature Control System
 - Intelligent Diagnostics
 - Separate Immersed Thermowell
- Automatic Flue Damper
 - 10 ft. Power Cord Included (120 VAC)
- Defender Safety System® featuring the patented Advanced ScreenLok® Technology flame arrestor design
 - Flammable Vapor Sensor
 - Maintenance-Free
 - Sight Window
 - Pedestal Base
- Hydrojet® Total Performance System
- Vitraglas® Lining
- Non-CFC Foam Insulation
- Water Connections—3/4" NPT true dielectric fittings

- Heat Traps
- Protective Magnesium Anode Rod
- 3"x4" "Snap Lock" Draft Diverter
- T&P Relief Valve
- Low Restrictive Brass Drain Valve

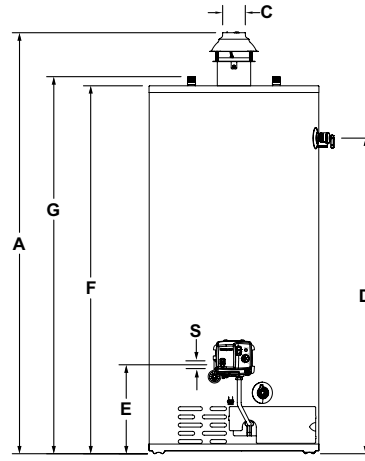
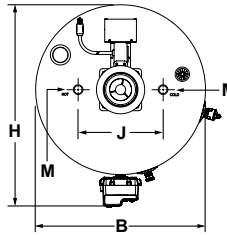

RG2D40S6N

Spec 1120. For additional documentation visit: www.bradfordwhite.com/documentation

page 10

Atmospheric Vent Dampener Models

DIMENSIONS IN INCHES

Meet or exceed ASHRAE 90.1b (current standard) C.E.C. Listed
80% Recovery Efficiency

Model Number	Nominal Gal. Capacity		DOE Rated Storage Volume (Gal.)	BTU/Hr. Input	LP BTU/Hr. Input	First Hour Rating (Gal.)	Uniform Energy Factor	Recovery at 90°F Rise*			
	U.S. Gal.	Imp. Gal.						U.S. GPH	Imp. GPH	LP U.S. GPH	LP Imp. GPH
★ RG2D40S6N	40	35	38	38,000	38,000	62	0.64	41	34	41	34
★ RG2D50S6N	50	42	47	40,000	40,000	81	0.68	43	36	43	36

Get additional product information, technical documentation, training videos and more at our exclusive site for the professional.

FOR THE PRO bwfortheapro.com

Model Number	A Floor to Exhaust Conn. in.	B Jacket Dia. in.	C Vent Size in.	D Floor to T&P Conn. in.	E Floor to Gas Conn. in.	F Floor to Top of Heater in.	G Floor to Water Conn. in.	H Depth in.	J C/L of Water Conn. in.	M Water Conn. NPT in.	S Gas Conn. Size in.	Approx. Shipping Weight lbs.
★ RG2D40S6N	54 1/2	22	3 or 4	41	13	47 11/16	48 7/8	26 1/8	11	3/4	1/2	155
★ RG2D50S6N	63 1/2	22	3 or 4	49 7/8	13	56 9/16	58	26 1/8	11	3/4	1/2	174

Propane models feature a Titanium Stabilized Stainless Steel propane burner. For Propane (LP) models change suffix "N" to "X". For 10 year models, change suffix from "6" to "10".

* Based on manufacturer's rated recovery efficiency. 120V, 60Hz., 12 Amps.

Uniform Energy Factor and First Hour Rating are based on the latest AHRI directory listings.

★ = ENERGY STAR® Qualified.



page 11



Residential Gas Atmospheric Vent Models

12/13

- Bradford White ICON System®
 - Enhanced Performance
 - Advanced Temperature Control System
 - Intelligent Diagnostics
- Defender Safety System® featuring the patented Advanced ScreenLok® Technology flame arrestor design
 - Resettable Thermal Switch
 - Maintenance-Free
 - Sight Window
 - Pedestal Base
- Hydrojet® Total Performance System
- Vitraglas® Lining
- Non-CFC Foam Insulation
- Water Connections—3/4" NPT true dielectric fittings
- Heat Traps
- Protective Magnesium Anode Rod
- 3"x4" "Snap Lock" Draft Diverter
- T&P Relief Valve
- Low Restrictive Brass Drain Valve

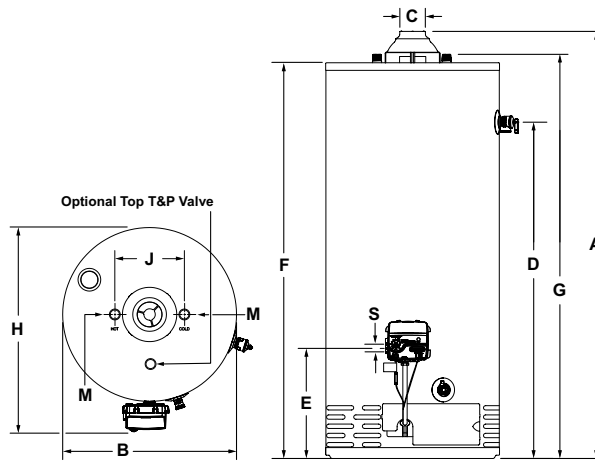

RG240T6N

Spec 1101. For additional documentation visit: www.bradfordwhite.com/documentation

page 12

Atmospheric Vent Models

DIMENSIONS IN INCHES

Meet or exceed ASHRAE 90.1b (current standard) C.E.C. Listed
79% Recovery Efficiency

Model Number	Nominal Gal. Capacity		DOE Rated Storage Volume (Gal.)	BTU/Hr. Input	LP BTU/Hr. Input	First Hour Rating (Gal.)	Uniform Energy Factor	Recovery at 90°F Rise*			
	U.S. Gal.	Imp. Gal.						U.S. GPH	Imp. GPH	U.S. GPH	Imp. GPH
RG130T6N•	30	25	29	27,000	27,000	46	0.54	29	24	29	24
RG230T6N•	30	25	29	32,000	31,000	60	0.60	34	28	33	23
RG230S6N	30	25	29	30,000	26,000	49	0.54	32	37	32	27
RG140T6N•	40	33	38	34,000	34,000	64	0.59	37	31	37	31
RG240T6N•	40	33	38	40,000	36,000	75	0.64	43	36	34	33
RG240S6N•	40	33	38	40,000	38,000	69	0.58	43	36	41	34
RG150T6N•	50	42	47	34,000	34,000	75	0.63	37	31	37	31
RG250T6N•	50	42	48	40,000	36,000	81	0.63	43	36	41	34
RG250L6N	48	40	47	40,000	38,000	77	0.63	43	36	41	34
RG250S6N•	50	42	47	50,000	48,000	75	0.63	54	45	52	45

Propane models feature a Titanium Stabilized Stainless Steel propane burner.

For Propane (LP) models change suffix "N" to "X".

For 10 year models, change suffix from "6" to "10".

* Based on manufacturer's rated recovery efficiency.

• Models feature optional top T&P location and must be specified when ordering.

Note: RG230S6N and RG250L6N do not have top T&P option.

Uniform Energy Factor and First Hour Rating are based on the latest AHRI directory listings.

Model Number	A Floor to Exhaust Conn. in.	B Jacket Dia. in.	C Vent Size in.	D Floor to T&P Conn. in.	E Floor to Gas Conn. in.	F Floor to Top of Heater in.	G Floor to Water Conn. in.	H Depth in.	J C/L of Water Conn. in.	M Water Conn. NPT in.	S Gas Conn. Size in.	Approx. Shipping Weight lbs.
RG130T6N•	59 3/4	16	3 or 4	49 3/4	13	56 1/4	57	19 1/2	8	3/4	1/2	106
RG230T6N•	59 3/4	18	3 or 4	49 3/4	13	56 1/4	57	21 1/2	8	3/4	1/2	116
RG230S6N	49 1/4	20	3 or 4	38 7/8	13	45 3/4	46 1/2	23 1/2	8	3/4	1/2	113
RG140T6N•	61 5/16	18	3 or 4	51 5/8	13	57 13/16	59 9/16	21 1/2	8	3/4	1/2	132
RG240T6N•	60 1/8	20	3 or 4	49 3/4	13	56 5/8	57 3/8	23 1/2	8	3/4	1/2	134
RG240S6N•	51 9/16	22	3 or 4	41 1/16	13	48 1/16	48 13/16	25 1/2	8	3/4	1/2	139
RG150T6N•	60 1/8	20	3 or 4	49 15/16	13	56 5/8	57 3/8	23 1/2	8	3/4	1/2	148
RG250T6N•	60 1/8	22	3 or 4	49 15/16	13	56 5/8	57 3/8	25 1/2	8	3/4	1/2	154
RG250L6N	51 9/16	24	3 or 4	40 11/16	13	48 1/16	48 13/16	27 1/2	8	3/4	1/2	170
RG250S6N•	60 1/8	22	4	49 15/16	13	56 5/8	57 3/8	25 1/2	8	3/4	1/2	167

page 13



Residential Gas Atmospheric Vent High Input Models

14/15

All Model Features (except RG255H6N):

- Bradford White ICON System®
- Enhanced Performance
- Advanced Temperature Control System
- Intelligent Diagnostics

All Model Features:

- Hydrojet® Total Performance System
- Vitraglas® Lining
- Side Connections—3/4"
- Non-CFC Foam Insulation
- Pedestal Base (except RG2100H6N)
- Water Connections
- Hand Hole Cleanout (RG2100H6N only)
- Protective Magnesium Anode Rod
- 4" "Snap Lock" Draft Diverter
- T&P Relief Valve
- Low Restrictive Brass Drain Valve
- Thermostatic Mixing Valve (ASSE Approved)—Included with RG255H6N only

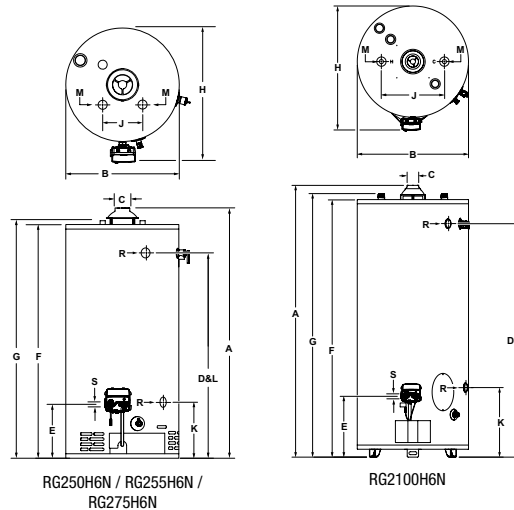
RG250H6N / RG255H6N /
RG275H6N

RG2100H6N

RG255H6N

page 14

Atmospheric Vent High Input Models

Meet or exceed ASHRAE 90.1b (current standard) C.E.C. Listed

DIMENSIONS IN INCHES

Model Number	Nominal Gal. Capacity		DOE Rated Storage Volume (Gal.)	BTU/Hr. Input		First Hour Rating (Gal.)	Uniform Energy Factor	Recovery at 90°F Rise*			
	U.S. Gal.	Imp. Gal.						U.S. GPH	Imp. GPH	U.S. GPH	Imp. GPH
RG250H6N	48	40	46	65,000	65,000	106	0.63	70	35	70	35
RG255H6N	55	46	55	78,000	78,000	117	0.61	84	70	84	70
RG275H6N	75	63	72	76,000	76,000	135	0.59	82	68	82	68
RG2100H6N	100	83	95	80,000	80,000	157	0.57	85	71	85	71

Get additional product information, technical documentation, training videos and more at our exclusive site for the professional.

FOR THE PRO
bwfortheopro.com

Model Number	A Floor to Flue Conn. in.	B Jacket Dia. in.	C Vent Size in.	D Floor to T&P Conn. in.	E Floor to Gas Conn. in.	F Floor to Top of Heater in.	G Floor to Water Conn. in.	H Depth in.	J C/L of Water Conn. in.	K Floor to Space Heating Inlet in.	L Floor to Space Heating Outlet in.	M Water Conn. NPT in.	R Space Heating Conn. Size in.	S Gas Conn. Size in.	Approx. Shipping Weight lbs.
RG250H6N	60 1/8	22	4	49 15/16	13	56 5/8	57 3/8	25 1/2	11	13 7/16	49 15/16	3/4	3/4	1/2	189
RG255H6N	58 1/2	24	4	48 1/8	13 1/8	54 3/4	56 1/2	27 1/4	8	13 1/2	48 1/8	3/4	3/4	1/2	210
RG275H6N	62 5/8	26	4	51 7/8	15	59 5/8	60 1/16	29 1/4	11	16 5/8	51 7/8	1	3/4	1/2	240
RG2100H6N	71 1/2	28 1/4	4	59 5/16	15 3/16	65 5/16	66 1/2	31 3/4	16	17 5/8	50 5/8	1 1/4	3/4	1/2	413

* Based on manufacturer's rated recovery efficiency.

Propane models feature a Titanium Stabilized Stainless Steel propane burner. For Propane (LP) models change suffix "N" to "X".

For 10 year models, change suffix from "6" to "10". RG255H6N not available as 10 year model.

RG2100H6N model features hand hole cleanout.

Uniform Energy Factor and First Hour Rating are based on the latest AHRI directory listings.

Spec 1108. For additional documentation visit: www.bradfordwhite.com/documentation

page 15



Residential Gas Direct Vent Models

16/17

- Bradford White ICON System®
 - Enhanced Performance
 - Advanced Temperature Control System
 - Intelligent Diagnostics
- Defender Safety System® featuring the patented Advanced ScreenLok® Technology flame arrestor design
 - Resettable Thermal Switch
 - Maintenance-Free
 - Sight Window
 - Pedestal Base
- Closed Combustion
- Reinforced Seals
- Maintenance-Free
- Sight Window
- Hydrojet® Total Performance System
- Vitraglas® Lining
- Cast Aluminum Air Intake Boot
- Telescoping Solid Vent Kits
- Flexible Vent Kit
- Side Connections—3/4" NPT tappings (RG2DV50H6N only)

- 2" Non-CFC Foam Insulation
- Water Connections—3/4" NPT—True dielectric fittings
- Heat Traps

- Protective Magnesium Anode Rod
- T&P Relief Valve
- Low Restrictive Brass Drain Valve

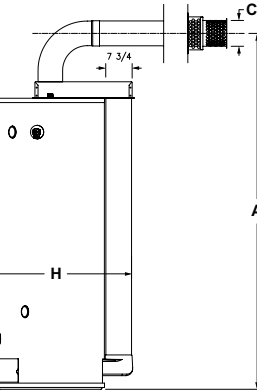
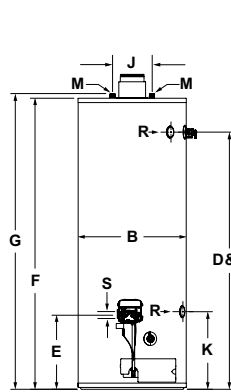

Telescoping Solid Vent Kit (Side View)

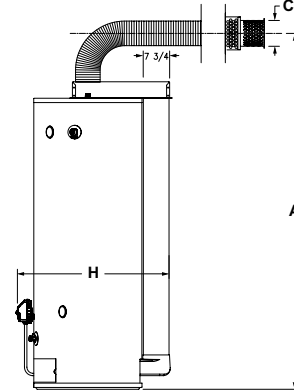

Flexible Vent Kit (Side View)



RG2DV50H6N

page 16

Direct Vent Models

DIMENSIONS IN INCHES

Model Number	Nominal Gal. Capacity		DOE Rated Storage Volume (Gal.)	BTU/Hr. Input	LP BTU/Hr. Input	First Hour Rating (Gal.)	Uniform Energy Factor	Recovery at 90°F Rise*			
	U.S. Gal.	Imp. Gal.						U.S. GPH	Imp. GPH	LP U.S. GPH	LP Imp. GPH
RG2DV40S6N	40	33	38	38,000	36,000	62	0.60	41	34	39	32
RG2DV50S6N	50	42	47	42,000	40,000	77	0.64	45	35	43	36
RG2DV50H6N	48	40	46	50,000	48,000	96	0.64	54	45	50	42

All Propane models feature a Titanium Stabilized Stainless Steel propane burner.

For Propane (LP) models change suffix "N" to "X".

For 10 year models, change suffix from "6" to "10".

* Based on manufacturer's rated recovery efficiency.

Uniform Energy Factor and First Hour Rating are based on the latest AHRI directory listings.

Model Number	A Floor to C/L of Vent in.	B Jacket Dia. in.	C Vent Size in. I.D. / O.D.	D Floor to T&P Conn. in.	E Floor to Gas Conn. in.	F Floor to Top of Heater in.	G Floor to Water Conn. in.	H Depth in.	J C/L of Water Conn. in.	K Floor to Space Heating Inlet in.	L Floor to Space Heating Outlet in.	M Water Conn. NPT in.	R Space Heating Conn. Size in.	S Gas Conn. Size in.	Approx. Shipping Weight lbs.
RG2DV40S6N	63 1/2 min.	22	3 5	43 1/2	13	50 3/16	51 1/8	31	8	N/A	N/A	3/4	N/A	1/2	189
RG2DV50S6N	72 1/2 min.	22	3 5	52 1/4	13	59 3/16	60 1/8	31	8	N/A	N/A	3/4	N/A	1/2	212
RG2DV50H6N	75 7/8 min.	22	4 6	52 1/4	13	59 3/16	60 1/8	31	11	15 3/4	52 1/4	3/4	3/4	1/2	234

RG2DV40S6N / RG2DV50S6N Solid Vent Kit: Part No. 239-51283-00. RG2DV40S6N / RG2DV50S6N Flexible Vent Kit: Part No. 239-51284-00.

RG2DV50H6N Solid Vent Kit: Part No. 239-51286-00. RG2DV50H6N Flexible Vent Kit: Part No. 239-51287-00.

Kits can be ordered and shipped with water heater, or ordered and shipped separately. For vent kit components and venting instructions, refer to Installation and Operation Manual.

RG2DV40S6N / RG2DV50S6N Optional Telescoping Solid Vent Kits:

Kit "A"	Telescopes from 4 3/8" to 5 1/8"	Part No. 239-41260-00
Kit "B"	Telescopes from 6 1/8" to 9 1/8"	Part No. 239-41331-00
Kit "C"	Telescopes from 13 3/8" to 23 1/8"	Part No. 239-41029-00
Kit "D"	Telescopes from 49 3/8" to 95 3/8"	Part No. 239-41424-00

RG2DV50H6N Optional Telescoping Solid Vent Kits:

Kit "F"	Telescopes from 4 3/8" to 5 1/8"	Part No. 239-42516-00
Kit "G"	Telescopes from 6 1/8" to 9 1/8"	Part No. 239-42517-00
Kit "H"	Telescopes from 13 3/8" to 23 1/8"	Part No. 239-42514-00
Kit "I"	Telescopes from 49 3/8" to 95 3/8"	Part No. 239-42512-00

Spec 1105. For additional documentation visit: www.bradfordwhite.com/documentation

page 17



Residential Gas High Efficiency eF Series® Power Vent Model 90%+ Thermal Efficiency

18/19

- ENERGY STAR® Qualified
- Vertical, Dual-pass Heat Exchanger System
- Vitraglas® Protection—On both primary and secondary heat exchanger
- Self-priming Condensate Tee
- Power Vent
- Horizontal and Vertical Venting
- Bradford White ICON System®
 - Enhanced Performance
 - Advanced Temperature Control System
 - Intelligent Diagnostics
 - Separate Immersed Thermowell
- Hydrojet® Total Performance System
- Vitraglas® Lining
- 2" Non-CFC Foam Insulation
- Pedestal Base
- Water Connections—3/4" NPT
- 3/4" NPT Side Connections
- Heat Traps
- Two Protective Anode Rods
- T&P Relief Valve
- Low Restrictive Brass Drain Valve

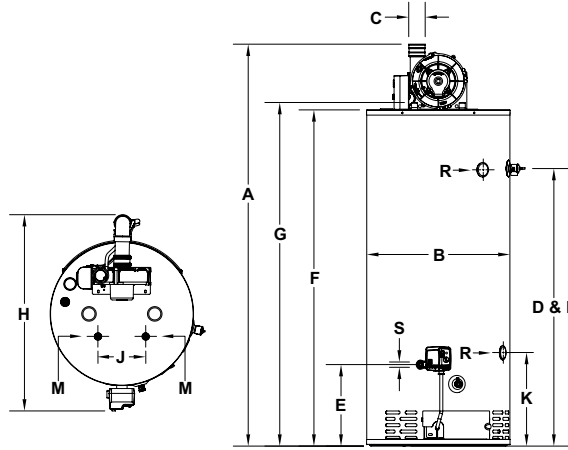

RC2PV50H6N

page 18

High Efficiency eF Series® Power Vent Model 90%+ Thermal Efficiency

DIMENSIONS IN INCHES

Meet or exceed ASHRAE 90.1b (current standard) C.E.C. Listed

Model Number	Nominal Gal. Capacity		DOE Rated Storage Volume (Gal.)	BTU/Hr. Input		First Hour Rating (Gal.)	Uniform Energy Factor	Recovery at 90°F Rise*			
	U.S. Gal.	Imp. Gal.		BTU/Hr. Input	LP BTU/Hr. Input			U.S. GPH	Imp. GPH	U.S. GPH	LP GPH
★RC2PV50H6N	50	42	49	76,000	76,000	120	0.80	91	77	93	77

Get additional product information, technical documentation, training videos and more at our exclusive site for the professional.

FOR THE PRO bwfortheapro.com

Model Number	A Floor to Vent Conn. in.	B Jacket Dia. in.	C Vent Size in.	D Floor to T&P Conn. in.	E Floor to Gas Conn. in.	F Floor to Top of Heater in.	G Floor to Water Conn. in.	H Depth in.	J C/L of Water Conn. in.	K Floor to Space Heating Inlet in.	L Floor to Space Heating Outlet in.	M Water Conn. NPT in.	R Space Heating Conn. Size in.	S Gas Conn. Size in.	Approx. Shipping Weight lbs.
★RC2PV50H6N	67 ^{1/16}	24	2, 3, and 4	46 ^{3/8}	13 ^{3/8}	56 ^{1/4}	57	32 ^{1/8}	8	15 ^{3/8}	46 ^{3/8}	3/4	3/4	1/2	225

Propane models feature a Titanium Stabilized Stainless Steel propane burner. For Propane (LP) models change suffix "N" to "X". For 10 year models, change suffix from "6" to "10".

* Based on manufacturer's rated recovery efficiency.

Uniform Energy Factor and First Hour Rating are based on the latest AHRI directory listings.

★ = ENERGY STAR® Qualified.



Optional Condensate Neutralizer Kit: p/n A2123601.

RC2PV50H6N	2" Vent Pipe	3" Vent Pipe	4" Vent Pipe
Max. Equivalent Length	†50 ft.	†120 ft.	†180 ft.
Min. Equivalent Length	7 ft.	15 ft.	15 ft.
Number of 90° Elbows	1	2	3
	45 ft.	115 ft.	175 ft.
	40 ft.	110 ft.	170 ft.
	35 ft.	105 ft.	165 ft.

Subtract 5 ft. for each additional 90° elbow.

† For high altitude installations, consult the installation instructions.

Spec 1263. For additional documentation visit: www.bradfordwhite.com/documentation

page 19



Residential Gas Power Vent (TTW®) Models

20/21

- ENERGY STAR® Qualified—Some models
- Bradford White ICON System®
 - Enhanced Performance
 - Advanced Temperature Control System
 - Intelligent Diagnostics
 - Separate Immersed Thermowell
- Power Vented Water Heater
- Powerful Blower Motor
 - Exclusively featuring the AquaVENT MAX™ from Fasco™ the quietest blower motor in the industry (40,000 BTU/Hr. Models)
 - 10 ft. Power Cord Included (120 VAC)
- Horizontal and Vertical Venting
- Defender Safety System® featuring the patented advanced ScreenLok® Technology flame arrestor design (except models above 75,000 BTU/Hr.)
 - Flammable Vapor Sensor
 - Maintenance-Free
 - Sight Window
 - Pedestal Base
- Hydrojet® Total Performance System
- Vitraglas® Lining
- Non-CFC Foam Insulation
- Water Connections—3/4" NPT
- 3/4" NPT Side Connections (RG2PV50H6N, RG1PV55H6N, and RG2PV75H6N only)
- Heat Traps
- Protective Magnesium Rod (RG1PV55H6N has two)
- T&P Relief Valve
- Low Restrictive Brass Drain Valve
- Thermostatic Mixing Valve (ASSE Approved) — Included with RG1PV55H6N only

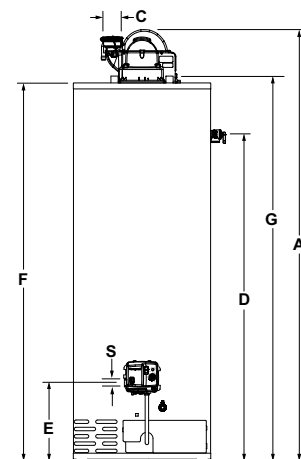
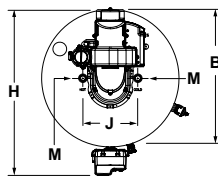

RG2PV50T6N

Spec 1261. For additional documentation visit: www.bradfordwhite.com/documentation

page 20

Power Vent (TTW®) Models

DIMENSIONS IN INCHES

Meet or exceed ASHRAE 90.1b (current standard) C.E.C. Listed
80% Recovery Efficiency

Model Number	Nominal Gal. Capacity U.S. Gal. Imp. Gal.	DOE Rated Storage Volume (Gal.)	BTU/Hr. Input	LP BTU/Hr. Input	First Hour Rating (Gal.)	Uniform Energy Factor	Recovery at 90°F Rise* U.S. GPH Imp. GPH U.S. GPH Imp. GPH
★ RG1PV40S6N	40 33	38	40,000	38,000	75	0.68	43 36 41 34
★ RG1PV50S6N	50 42	48	40,000	38,000	78	0.69	43 36 41 34
★ RG2PV40S6N	40 33	38	40,000	38,000	75	0.72	43 36 41 34
★ RG2PV50S6N	50 42	48	40,000	38,000	78	0.72	43 36 41 34
★ RG2PV40T6N	40 33	38	40,000	40,000	78	0.72	43 36 43 36
★ RG2PV50T6N	50 42	48	40,000	40,000	75	0.72	43 36 43 36
★ RG2PV50H6N	48 42	46	65,000	58,000	116	0.68	70 58 62 52
★ RG1PV55H6N	55 46	55	78,000	78,000	125	0.68	84 70 84 70
★ RG2PV75H6N	75 62	72	76,000	75,500	121	0.69	82 68 81 67

Propane models feature a Titanium Stabilized Stainless Steel propane burner. For Propane (LP) models change suffix "N" to "X". For 10 year models, change suffix from "6" to "10". RG1PV55H6N not available as 10 year model.*Based on manufacturer's rated recovery efficiency. 120 VAC Required for Power Venting / 120 VAC 60Hz., 3.1 Amperes. Uniform Energy Factor and First Hour Rating are based on the latest AHRI directory listings. ★ = ENERGY STAR® Qualified.

RG2PV40S6N RG1PV50S6N RG2PV50S6N RG2PV40T6N RG1PV40S6N RG2PV50T6N	2" Vent Pipe	3" Vent Pipe	RG2PV50H6N RG1PV55H6N RG2PV75H6N	3" Vent Pipe	4" Vent Pipe
Max. Equivalent Length	†50 ft.	†120 ft.	Max. Equivalent Length	†50 ft.	†180 ft.
Min. Equivalent Length	7 ft.	15 ft.	Min. Equivalent Length	7 ft.	15 ft.
Number of 90° Elbows	1 45 ft. 2 40 ft. 3 35 ft.	115 ft. 110 ft. 105 ft.	Number of 90° Elbows	1 45 ft. 2 40 ft. 3 35 ft.	175 ft. 170 ft. 165 ft.

Subtract 5 ft. for each additional 90° elbow. †For high altitude installations, consult the installation instructions.

Model Number	A Floor to Top of Blower In.	B Jacket Dia. In.	C Vent Size In.	D Floor to T&P Conn. In.	E Floor to Gas Conn. In.	F Floor to Top of Heater In.	G Floor to Water Conn. In.	H Depth In.	J C/L of Water Conn. In.	K Floor to Space Heating Inlet In.	L Floor to Space Heating Outlet In.	M Water Conn. NPT In.	R Space Heating Conn. Size In.	S Gas Conn. Size In.	Approx. Shipping Weight lbs.
★ RG1PV40S6N	55 7/16	20	2 or 3	40	11 1/2	46 1/2	49	25 15/16	8	N/A	N/A	3/4	N/A	1/2	140
★ RG1PV50S6N	56 3/8	22	2 or 3	40 5/8	11 1/2	48 3/16	50 1/2	27 3/16	8	N/A	N/A	3/4	N/A	1/2	166
★ RG2PV40S6N	55 7/16	22	2 or 3	40 1/8	11 1/2	47 3/16	49	27 3/16	8	N/A	N/A	3/4	N/A	1/2	142
★ RG2PV50S6N	56 7/16	24	2 or 3	40 5/8	11 1/2	48 3/16	50 1/2	28 7/8	8	N/A	N/A	3/4	N/A	1/2	168
★ RG2PV40T6N	65	20	2 or 3	49 11/16	11 1/2	56 3/4	58	26 1/8	8	N/A	N/A	3/4	N/A	1/2	146
★ RG2PV50T6N	65 13/16	22	2 or 3	50 9/16	11 1/2	57 9/16	58	27 3/16	8	N/A	N/A	3/4	N/A	1/2	173
★ RG2PV50H6N	66 1/2	22	3 or 4	49 7/8	11 1/2	56 3/4	57 3/4	26 15/16	11	13 3/8	49 7/8	3/4	3/4	1/2	187
★ RG1PV55H6N	64 9/16	22	3 or 4	47 15/16	11 1/2	54 3/4	56	27 3/16	7 3/4	13 3/8	47 15/16	3/4	3/4	1/2	219
★ RG2PV75H6N	69 1/2	26	3 or 4	51 15/16	13 15/16	59 11/16	60 3/4	30 11/16	11	16 11/16	51 15/16	3/4	3/4	1/2	260

page 21



Residential Gas Residential eF Series® Power Direct Vent Gas Water Heater

22/23

- ENERGY STAR® Qualified
- Vertical, Dual-pass Heat Exchanger System
- Closed Combustion Venting System
- Cast Aluminum Air Intake Boot
- Horizontal and Vertical Venting
- Optional Concentric Vent Kit Termination
- Bradford White ICON System®
 - Enhanced Performance
 - Advanced Temperature Control System
 - Intelligent Diagnostics
 - Separate Immersed Thermowell
- Hydrojet® Total Performance System
- Vitraglas® Lining
- 2" Non-CFC Foam Insulation
- Pedestal Base
- Water Connections—3/4" NPT
- 3/4" NPT Side Connections
- Heat Traps
- Two Protective Anode Rods
- T&P Relief Valve
- Low Restrictive Brass Drain Valve

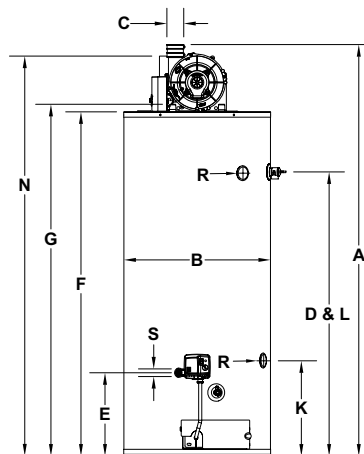
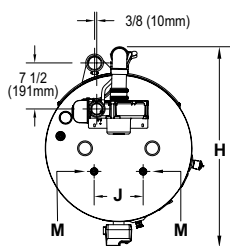

RC2PDV50H6N

page 22

Residential eF Series® Power Direct Vent Gas Water Heater

DIMENSIONS IN INCHES

Model Number	Nominal Gal. Capacity		DOE Rated Storage Volume (Gal.)	BTU/Hr. Input		First Hour Rating (Gal.)	Uniform Energy Factor	Recovery at 90°F Rise*				Get additional product information, technical documentation, training videos and more at our exclusive site for the professional.						
	U.S. Gal.	Imp. Gal.		BTU/Hr. Input	LP BTU/Hr. Input			U.S. GPH	Imp. GPH	LP U.S. GPH	LP Imp. GPH							
★ RC2PDV50H6N	50	42	48	76,000	76,000	125	0.80	89	77	93	77	FOR THE PRO bwforthepro.com						
Model Number	A	B	C	D	E	F	G	H	J	K	L	M	N	R	S	Approx. Shipping Weight		
	Floor to Vent Conn. in.	Jacket Dia. in.	Vent Size in.	Floor to T&P Conn. in.	Floor to Gas Conn. in.	Floor to Top of Heater in.	Floor to Water Conn. in.	Depth in.	C/L of Water Conn. in.	Floor to Space Heating Inlet in.	Floor to Space Heating Outlet in.	Water Conn. NPT in.	Floor to Intake Conn. in.	Space Heating Conn. Size in.	Gas Conn. Size in.	lbs.		
★ RC2PDV50H6N	67 7/16	24	2, 3, and 4	46 3/8	14 1/8	56 1/4	57	33 3/4	8	15 5/8	46 3/8	3/4	65 5/8	3/4	1/2	290		

Propane models feature a Titanium Stabilized Stainless Steel propane burner. For Propane (LP) models change suffix "N" to "X". For 10 year models, change suffix from "6" to "10".

* Based on manufacturer's rated recovery efficiency.

110 VAC Required for Power Venting / 110 VAC, 60Hz., 3.1 Amperes.

Uniform Energy Factor and First Hour Rating are based on the latest AHRI directory listings.

★ = ENERGY STAR® Qualified.



Optional Condensate Neutralizer Kit:
p/n A2123601.

Concentric Vent Kit Termination

2" Kit	A (in.)
P/N 239-44069-02	29 1/4
3" Kit	A (in.)
P/N 239-44069-01	36 1/4

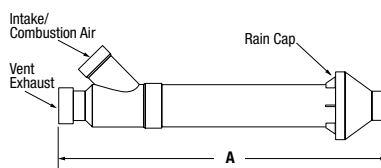

RC2PDV50H6N	2" Vent Pipe	3" Vent Pipe	4" Vent Pipe
Max. Intake Length	50 ft.	120 ft.	180 ft.
Min. Exhaust Length	†50 ft.	†120 ft.	†180 ft.
Min. Equivalent Length	7 ft.	15 ft.	15 ft.
Number of 90° Elbows	1	2	3
	45 ft.	110 ft.	105 ft.
	35 ft.	105 ft.	165 ft.

† Subtract 5 ft. for each additional 90° elbow.

† For high altitude installations, consult the installation instructions.

Spec 1264. For additional documentation visit: www.bradfordwhite.com/documentation

page 23



Residential Gas Power Direct Vent Models

24/25

- ENERGY STAR® Qualified—Some models
- Bradford White ICON System®
 - Enhanced Performance
 - Advanced Temperature Control System
 - Intelligent Diagnostics
 - Separate Immersed Thermowell
- Defender Safety System®
 - Flammable Vapor Sensor
 - Maintenance-Free
 - Sight Window
 - Pedestal Base
- Closed Combustion Venting System
- Powerful Blower Model
 - 10 ft. Power Cord Included (120 VAC)
- Cast Aluminum Air Intake Boot
- Horizontal and Vertical Venting
- Optional Concentric Vent Kit Termination
- Flammable Vapor Sensor
- Hydrojet® Total Performance System
- Vitraglas® Lining
- 2" Non-CFC Foam Insulation
- Water Connections—3/4" NPT
- Side Connections—3/4" NPT (RG2PDV50H6N and RG2PDV75H6N only)
- Heat Traps
- Protective Magnesium Anode Rod
- T&P Relief Valve
- Low Restrictive Brass Drain Valve

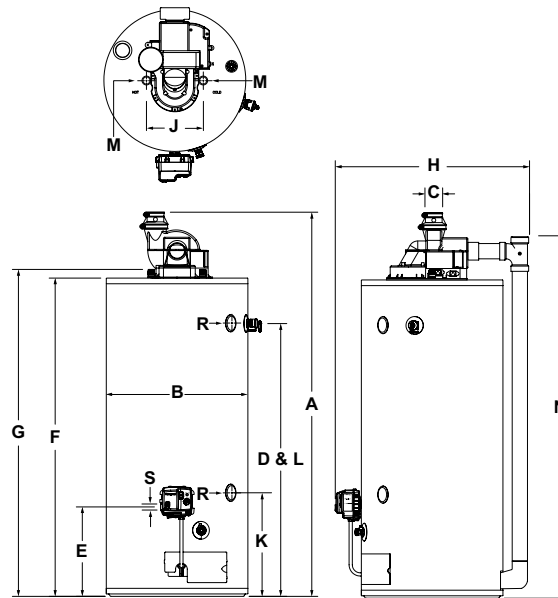

RG2PDV40S6N

Spec 1117. For additional documentation visit: www.bradfordwhite.com/documentation

page 24

Power Direct Vent Models

DIMENSIONS IN INCHES

Meet or exceed ASHRAE 90.1b (current standard) C.E.C. Listed
78% Recovery Efficiency

Model Number	Nominal Gal. Capacity		DOE Rated Storage Volume (Gal.)	LP BTU/Hr. Input		First Hour Rating (Gal.)	Uniform Energy Factor	Recovery at 90°F Rise*			
	U.S. Gal.	Imp. Gal.		BTU/Hr. Input	LP BTU/Hr. Input			U.S. GPH	Imp. GPH	U.S. GPH	Imp. GPH
★ RG2PDV40S6N	40	33	38	40,000	38,000	75	0.70	43	36	41	34
★ RG2PDV50S6N	50	42	48	40,000	38,000	80	0.68	43	36	41	34
★ RG2PDV50H6N	48	40	46	60,000	60,000	103	0.68	65	54	65	54
RG2PDV75H6N	75	62	72	80,000	78,000	134	0.69	86	72	84	70

Concentric Vent Kit Termination

2" Kit	A (in.)
P/N 239-44069-02	29 1/4
3" Kit	A (in.)
P/N 239-44069-01	36 1/4

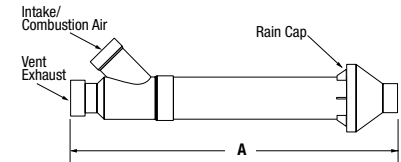

Model Number	A Floor to Exhaust Conn. in.	B Jacket Dia. in.	C Vent Size in.	D Floor to T&P Conn. in.	E Floor to Gas Conn. in.	F Floor to Top of Heater in.	G Floor to Water Conn. in.	H Depth in.	J C/L of Water Conn. in.	K Floor to Space Heating Inlet in.	L Floor to Space Heating Outlet in.	M Water Conn. NPT in.	N Floor to Air Intake in.	R Space Heating Conn. Size in.	S Gas Conn. Size in.	Approx. Shipping Weight lbs.
★ RG2PDV40S6N	59 7/8	22	2 or 3	42 9/16	13 15/16	49 9/16	49 15/16	32 3/8	8	N/A	N/A	3/4	59 7/16	N/A	1/2	161
★ RG2PDV50S6N	60 7/8	24	2 or 3	43 1/16	13 15/16	50 9/16	52	34 3/8	8	N/A	N/A	3/4	60 7/16	N/A	1/2	192
★ RG2PDV50H6N	69 1/16	22	3 or 4	52 5/16	13 15/16	59 5/16	60 3/16	30 1/2	11	15 13/16	52 5/16	3/4	69 3/16	3/4	1/2	204
RG2PDV75H6N	69 1/2	26	3 or 4	51 15/16	13 15/16	59 11/16	60 3/16	35 3/8	11	16 11/16	51 15/16	3/4	69 9/16	3/4	1/2	291

Propane models feature a Titanium Stabilized Stainless Steel propane burner.

For Propane (LP) models change suffix "N" to "X".

For 10 year models, change suffix from "6" to "10".

* Based on manufacturer's rated recovery efficiency.

110 VAC Required for Power Venting / 110 VAC, 60Hz., 3.1 Amperes.

Uniform Energy Factor and First Hour Rating are based on the latest AHRI directory listings.

★ = ENERGY STAR® Qualified.



2" Vent Pipe	RG2PDV40S6N RG2PDV50S6N	3" Vent Pipe	RG2PDV40S6N RG2PDV50S6N	RG2PDV50H6N RG2PDV75H6N	4" Vent Pipe	RG2PDV50H6N RG2PDV75H6N
Max. Intake Length	†35 ft.	Max. Intake Length	†85 ft.	†60 ft.	Max. Intake Length	†100 ft.
Max. Exhaust Length	35 ft.	Max. Exhaust Length	85 ft.	60 ft.	Max. Exhaust Length	100 ft.
Min. Vent Length	7 ft.	Min. Vent Length	7 ft.	7 ft.	Min. Vent Length	7 ft.
Number of	1 30 ft. 2 25 ft. 90° Elbows 3 20 ft.	Number of	1 80 ft. 2 75 ft. 90° Elbows 3 70 ft.	55 ft. 50 ft. 45 ft.	Number of	1 95 ft. 2 90 ft. 90° Elbows 3 85 ft.

Subtract 5 ft. for each additional 90° elbow. †For high altitude installations, consult the installation instructions.

page 25



Residential Gas Manufactured Home Closed Combustion/Direct Vent Models

26/27

- Housing and Urban Development
- Sealed Combustion Roof Jack Kit—Must order for new installations
- Flue Baffle
- Heat Traps
- Vitraglas® Lining
- Fully Automatic Controls
- 2" Non-CFC Foam Insulation
- Water Connections—3/4" NPT
- Protective Magnesium Anode Rod
- T&P Relief Valve
- Low Restrictive Brass Drain Valve
- Convertible Gas Control

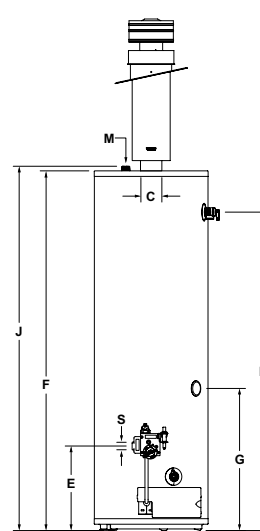
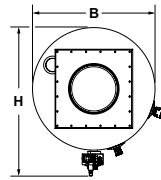

RG2DVMH30T6X

page 26

Manufactured Home Closed Combustion/Direct Vent Models

Meet or exceed ASHRAE 90.1b (current standard) C.E.C. Listed
79% Recovery Efficiency

DIMENSIONS IN INCHES

Model Number	Nominal Gal. Capacity		DOE Rated Storage Volume (Gal.)	BTU/Hr. Input	LP BTU/Hr. Input	First Hour Rating (Gal.)	Uniform Energy Factor	Recovery at 90°F Rise*			
	U.S. Gal.	Imp. Gal.						U.S. GPH	Imp. GPH	U.S. GPH	Imp. GPH
RG2DVMH30T6X	30	27	29	30,000	30,000	56	0.60	32	27	32	27
RG2DVMH40T6X	40	33	38	30,000	30,000	51	0.58	32	27	32	27

Get additional product information, technical documentation, training videos and more at our exclusive site for the professional.

FOR THE PRO® bwfortheapro.com

Model Number	B Jacket Dia. in.	C Vent Size in.	D Floor to T&P Conn. in.	E Floor to Gas Conn. in.	F Floor to Top of Heater in.	G Floor to Cold Water Conn. in.	H Depth in.	J Floor to Hot Water Conn. in.	M Water Conn. NPT in.	S Gas Conn. Size in.	Approx. Shipping Weight lbs.
RG2DVMH30T6X	18	3	50 ⁵ / ₁₆	13 ³ / ₈	57	22 ⁷ / ₁₆	21 ⁵ / ₈	57 ¹¹ / ₁₆	3/4	1/2	119
RG2DVMH40T6X	20	3	50 ⁵ / ₁₆	13 ³ / ₈	57 ¹ / ₈	22 ⁷ / ₁₆	23 ⁵ / ₈	58 ¹⁵ / ₁₆	3/4	1/2	139

To order a natural gas heater change suffix "X" to "N". For 10 year models, change suffix from "6" to "10".

* Based on manufacturer's rated recovery efficiency. Uniform Energy Factor and First Hour Rating are based on the latest AHRI directory listings.

Optional Roof Jack Kits

Part Number	A	B	Through The Roof Clearance
239-37022-01	15"	16"-33"	12"
239-37022-02	33 ¹ / ₂ "	33 ¹ / ₂ "-66"	18" / 32"
239-37022-03	32 ¹ / ₂ "-62 ¹ / ₂ "	37 ¹ / ₂ "-74"	32" / 60"
239-37022-04	50"-98 ¹ / ₂ "	54 ¹ / ₂ "-109 ¹ / ₂ "	48" / 90"

Includes: roof jack, hardware, air intake, instructions.

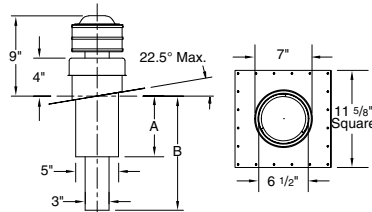

Spec 1107. For additional documentation visit: www.bradfordwhite.com/documentation

This water heater is of the closed combustion type (direct venting) for mobile home applications only, where all combustion air is supplied from the outdoors through the air intake and all combusted gas products are vented directly to the outside by means of the roof jack. No draft diverter (vent hood) is required for this water heater. The ETL listing of this water heater includes the field installation of the following components: roof jack, roof jack clamp, air intake, air intake seal, and heater tie down materials. These components for field installation are shipped with the heater in a separate box and must be installed according to instructions. No other components are approved for use with the water heater. The water heater must be installed in accordance with The Federal Mobile Home Construction and Safety Standard or in the absence of such standard, The Standard for Mobile Homes (ANSI/NFPA No. 601B-1977)

page 27



Residential Gas Manufactured Home Atmospheric Combustion Models

28/29

- Defender Safety System® featuring the patented Advanced ScreenLok® Technology flame arrestor design
 - Resetable Thermal Switch
 - Maintenance-Free
 - Sight Window
 - Pedestal Base
- Piezo Igniter
- Housing and Urban Development
- Roof Jack Kit—Must order for new installations
- Vitraglas® Lining
- Fully Automatic Controls
- Convertible Gas Control
- 2" Non-CFC Foam Insulation
- Water Connections—3/4" NPT
- Heat Trap
- Protective Magnesium Anode Rod
- 3"x4" "Snap Lock" Draft Diverter
- Flue Baffle
- Steel Tank
- T&P Relief Valve
- Low Restrictive Brass Drain Valve
- Design Certified by CSA International (formerly AGA/CGA).

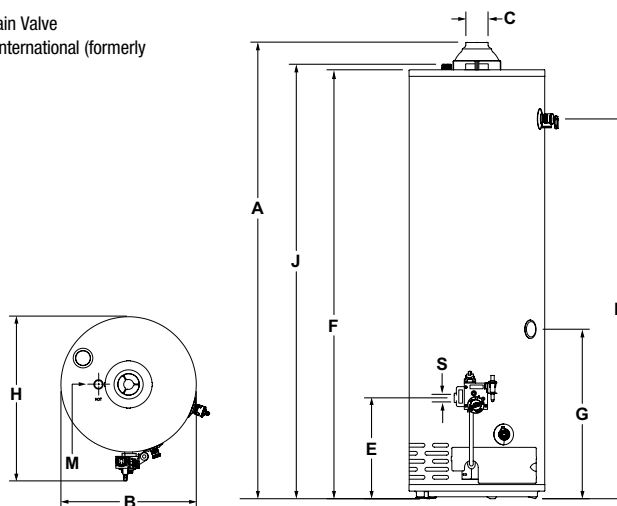

RG2MH30T6X

page 28

Manufactured Home Atmospheric Combustion Models

DIMENSIONS IN INCHES

Model Number	Nominal Gal. Capacity	DOE Rated Storage Volume (Gal.)	BTU/Hr. Input	LP BTU/Hr. Input	First Hour Rating (Gal.)	Uniform Energy Factor	Recovery at 90°F Rise*	U.S. GPH	Imp. GPH	LP U.S. GPH	LP Imp. GPH
RG2MH30T6X	30	25	29	32,000	32,000	50	0.54	34	28	34	28
RG2MH40T6X	40	33	37	34,000	34,000	54	0.59	37	31	37	31

Model Number	A Floor to Flue Conn. in.	B Jacket Dia. in.	C Vent Size in.	D Floor to T&P Conn. in.	E Floor to Gas Conn. in.	F Floor to Top of Heater in.	G Floor to Cold Water Conn. in.	H Depth in.	J Floor to Hot Water Conn. in.	M Water Conn. NPT in.	S Gas Conn. Size in.	Approx. Shipping Weight lbs.
RG2MH30T6X	59 15/16	18	3 or 4	49 11/16	12 3/4	56 3/8	21 13/16	21 5/8	57 5/8	3/4	1/2	118
RG2MH40T6X	60 3/8	20	3 or 4	49 11/16	13 3/8	56 1/4	21 13/16	23 5/8	57 13/16	3/4	1/2	135

Meet or exceed ASHRAE 90.1b (current standard) C.E.C. Listed
77% Recovery Efficiency

Get additional product information, technical documentation, training videos and more at our exclusive site for the professional.

FOR THE PRO® bwfortheapro.com

To order a natural gas heater change suffix "X" to "N". For 10 year models, change suffix from "6" to "10".

* Based on manufacturer's rated recovery efficiency. Uniform Energy Factor and First Hour Rating are based on the latest AHRI directory listings.

Optional Roof Jack Kits			
Part Number	A	B	Through The Roof Clearance
239-37030-01	15"	16"-33"	12"
239-37030-02	33 1/2"	33 1/2"-66"	18" / 32"
239-37030-03	32 1/2"-62 1/2"	37 1/2"-74"	32" / 60"
239-37030-04	50"-98 1/2"	54 1/2"-109 1/2"	48" / 90"

Includes: roof jack, hardware, air intake, instructions.

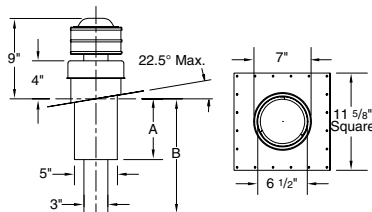

Spec 1110. For additional documentation visit: www.bradfordwhite.com/documentation

The water heater enclosure access door must be on the outside wall of the manufactured home (mobile home) only. Access to the water heater enclosure from the inside of the manufactured home (mobile home) is not permitted. The CSA International (formerly AGA/CGA) listing of this water heater includes the field installation of the following components: roof jack and heater tie down materials. These components for field installation are shipped in a separate box from the heater and must be installed according to instructions. No other components are approved for use with the water heater. The water heater must be installed in accordance with The Federal Manufactured Home Construction and Safety Standard Title 24 CFR, Part 3280.

page 29



Residential Gas Ultra Low NOx Atmospheric Vent Damper Models

30/31

- ENERGY STAR® Qualified
- Bradford White ICON System®
 - Enhanced Performance
 - Advanced Temperature Control
 - Intelligent Diagnostics
 - Separate Immersed Thermowell
- Automatic Flue Damper
 - 10 ft. Power Cord Included (120 VAC)
- Eco-Defender Safety System® featuring the patented advanced ScreenLok® Technology flame arrestor design
 - Digital Thermal Sensor and Resettable Thermal Switch
 - Maintenance-Free
 - Sight Window
 - Pedestal Base
- Ultra Low NOx Burner with Primary and Secondary Air Distribution Devices
- Hydrojet® Total Performance System
- Vitraglas® Lining
- Non-CFC Foam Insulation
- Water Connections—3/4" NPT
- Heat Traps
- Protective Magnesium Anode Rod
- 3"x4" "Snap Lock" Draft Diverter
- T&P Relief Valve
- Low Restrictive Brass Drain Valve
- Design Certified by CSA International (formerly AGA and CGA).
- Complies with the Latest Ultra Low NOx Requirement (10 ng/J NOx limit)

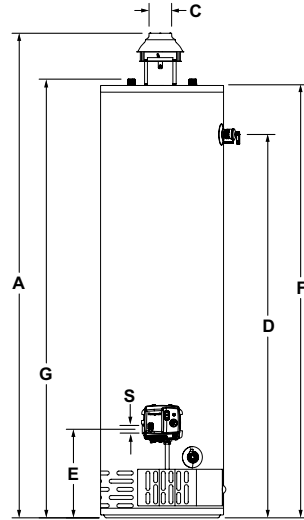
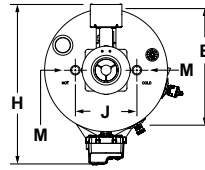

URG2D50S6N

page 30

Ultra Low NOx Atmospheric Vent Damper Models

DIMENSIONS IN INCHES

Meet or exceed ASHRAE 90.1b (current standard) C.E.C. Listed
78% Recovery Efficiency

Model Number	Nominal Gal. Capacity		DOE Rated Storage Volume (Gal.)	BTU/Hr. Input	First Hour Rating (Gal.)	Uniform Energy Factor	Recovery at 90°F Rise*	
	U.S. Gal.	Imp. Gal.					U.S. GPH	Imp. GPH
★ URG2D40S6N	40	33	38	38,000	67	0.64	40	33
★ URG2D50S6N	50	42	47	40,000	81	0.68	42	35

Get additional product information, technical documentation, training videos and more at our exclusive site for the professional.

FOR THE PRO® bwfortheapro.com

Model Number	A Floor to Flue Conn. in.	B Jacket Dia. in.	C Vent Size in.	D Floor to T&P Conn. in.	E Floor to Gas Conn. in.	F Floor to Top of Heater in.	G Floor to Water Conn. in.	H Depth in.	J C/L of Water Conn. in.	M Water Conn. NPT in.	S Gas Conn. Size in.	Approx. Shipping Weight lbs.
★ URG2D40S6N	57 ⁵ / ₁₆	22	3 or 4	41	11 ¹ / ₂	48 ³ / ₁₆	49 ⁹ / ₁₆	26 ¹ / ₈	11	3/4	1/2	159
★ URG2D50S6N	65 ⁷ / ₈	22	3 or 4	49 ⁷ / ₈	11 ¹ / ₂	56 ³ / ₄	58 ¹¹ / ₁₆	26	11	3/4	1/2	172

Available in Natural Gas only.

For 10 year models, change suffix from "6" to "10".

* Based on manufacturer's rated recovery efficiency.

Uniform Energy Factor and First Hour Rating are based on the latest AHRI directory listings.

★ = ENERGY STAR® Qualified.



Spec 1118. For additional documentation visit: www.bradfordwhite.com/documentation

page 31



Residential Gas Ultra Low NOx Atmospheric Vent Models

32/33

- Bradford White ICON System®
 - Enhanced Performance
 - Advanced Temperature Control System
 - Intelligent Diagnostics
- Eco-Defender Safety System® featuring the patented advanced ScreenLok® Technology flame arrestor design
 - Digital Thermal Sensor and Resettable Thermal Switch
 - Maintenance-Free
 - Sight Window
 - Pedestal Base
- Ultra Low NOx Burner with Primary and Secondary Air Distribution Devices
- Hydrojet® Total Performance System
- Vitraglas® Lining
- Non-CFC Foam Insulation
- Water Connections—3/4" NPT
- Heat Traps
- Protective Magnesium Anode Rod
- 3"x4" "Snap Lock" Draft Diverter
- Flue Baffle
- Steel Tank
- T&P Relief Valve
- Low Restrictive Brass Drain Valve
- Design Certified by CSA International (formerly AGA and CGA)
- Complies with the Latest Ultra Low NOx Requirement (10 ng/J NOx limit)

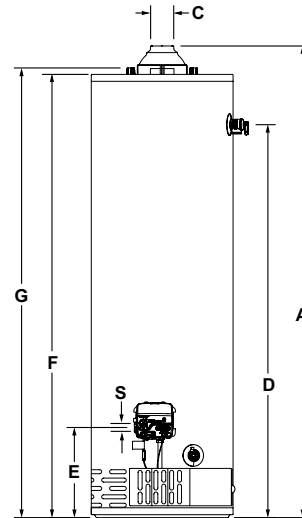
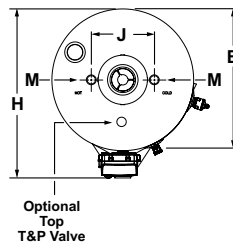

URG250T6N

Spec 1113. For additional documentation visit: www.bradfordwhite.com/documentation

page 32

Ultra Low NOx Atmospheric Vent Models

DIMENSIONS IN INCHES

Meet or exceed ASHRAE 90.1b (current standard) C.E.C. Listed
80% Recovery Efficiency

Model Number	Nominal Gal. Capacity U.S. Imp. Gal.	DOE Rated Storage Volume (Gal.)	BTU/Hr. Input	First Hour Rating (Gal.)	Uniform Energy Factor	Recovery at 90°F Rise*	U.S. GPH	Imp. GPH
• URG130T6N	30 25	29	27,000	46	0.54	29	24	
• URG230T6N	30 25	29	32,000	60	0.60	34	28	
• URG140T6N	40 33	38	34,000	64	0.59	37	31	
• URG240T6N	40 33	38	40,000	75	0.64	43	36	
• URG240S6N	40 33	38	40,000	69	0.58	43	36	
• URG150T6N	50 42	47	34,000	75	0.63	37	31	
• URG250T6N	50 42	48	40,000	81	0.63	43	36	
URG250L6N	48 40	47	40,000	77	0.63	43	36	
• URG250S6N	50 42	47	50,000	75	0.63	54	45	

Available in Natural Gas only.

For 10 year models, change suffix from "6" to "10".

* Based on manufacturer's rated recovery efficiency.

- Models feature optional top T&P location and must be specified when ordering. Note: URG250L6N does not have top T&P option.

Uniform Energy Factor and First Hour Rating are based on the latest AHRI directory listings.

Model Number	A Floor to Flue Conn. in.	B Jacket Dia. in.	C Vent Size in.	D Floor to T&P Conn. in.	E Floor to Gas Conn. in.	F Floor to Top of Heater in.	G Floor to Water Conn. in.	H Depth in.	J C/L of Water Conn. in.	M Water Conn. NPT in.	S Gas Conn. Size in.	Approx. Shipping Weight lbs.
• URG130T6N	59 ^{31/32}	16	3 or 4	50 ^{9/32}	11 ^{7/16}	56 ^{1/3}	57 ^{1/16}	20 ^{1/16}	8	3/4	1/2	112
• URG230T6N	59 ^{27/32}	18	3 or 4	49 ^{21/32}	11 ^{7/16}	56 ^{2/9}	57 ^{1/16}	21 ^{3/16}	8	3/4	1/2	119
• URG140T6N	61 ^{1/2}	18	3 or 4	59 ^{1/2}	11 ^{7/16}	57 ^{15/16}	59 ^{1/2}	22 ^{3/16}	8	3/4	1/2	130
• URG240T6N	60 ^{5/16}	20	3 or 4	56 ^{5/8}	11 ^{7/16}	56 ^{3/4}	57 ^{3/4}	23 ^{3/16}	8	3/4	1/2	137
• URG240S6N	51 ^{3/4}	22	3 or 4	47 ^{1/4}	11 ^{7/16}	48 ^{3/16}	49 ^{7/16}	25 ^{3/16}	8	3/4	1/2	149
• URG150T6N	60 ^{5/16}	20	3 or 4	56 ^{3/8}	11 ^{7/16}	56 ^{3/4}	57 ^{7/8}	24 ^{3/16}	8	3/4	1/2	153
• URG250T6N	60 ^{5/16}	22	3 or 4	57	11 ^{7/16}	56 ^{11/16}	58 ^{1/16}	25 ^{3/8}	8	3/4	1/2	160
URG250L6N	51 ^{13/16}	24	3 or 4	40 ^{5/8}	11 ^{7/16}	48 ^{3/16}	49 ^{9/16}	27 ^{3/16}	8	3/4	1/2	174
• URG250S6N	60 ^{5/8}	22	4	57	11 ^{7/16}	56 ^{3/4}	57 ^{15/16}	25 ^{3/16}	8	3/4	1/2	169

page 33



Residential Gas Ultra Low NOx Atmospheric Vent High Input Models

34/35

- Bradford White ICON System®
 - Enhanced Performance
 - Advanced Temperature Control System
 - Intelligent Diagnostics
- Eco-Defender Safety System® featuring the patented advanced ScreenLok® Technology flame arrestor design (URG250H6N only)
 - Digital Thermal Sensor and Resettable Thermal Switch (URG250H6N only)
 - Maintenance-Free
 - Sight Window
 - Pedestal Base (URG250H6N & URG275H6N only)
- Defender Combustion Chamber (URG250H6N only)
- Ultra Low NOx with Primary and Secondary Air Distribution Devices
- Hydrojet® Total Performance System
- Vitraglas® Lining
- Side Connections—3/4" NPT
- Non-CFC Foam Insulation
- Water Connections
- Heat Traps
- Protective Magnesium Anode Rod
- 4" (107mm) "Snap Lock" Draft Diverter.
- T&P Relief Valve
- Low Restrictive Brass Drain Valve
- Design Certified by CSA International (formerly AGA and CGA).
- URG250H6N Complies with the Latest Ultra Low NOx Requirement (10 ng/J NOx limit)
- URG275H6N / URG2100H6N complies with (14 ng/J NOx limit)

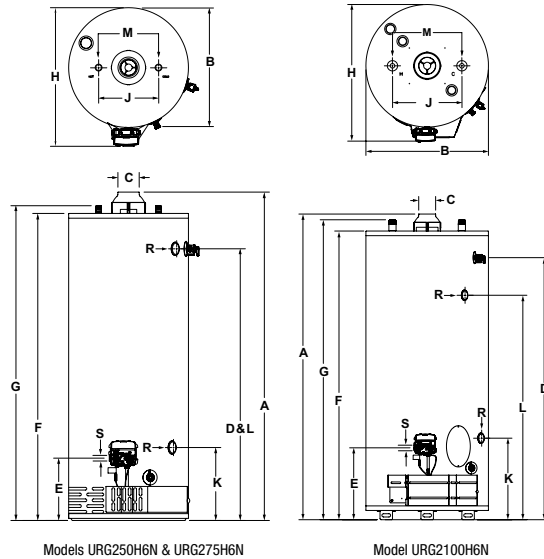

URG250H6N

page 34

Ultra Low NOx Atmospheric Vent High Input Models

DIMENSIONS IN INCHES

Meet or exceed ASHRAE 90.1b (current standard) C.E.C. Listed
Recovery efficiency up to 80%

Model Number	Nominal Gal. Capacity		DOE Rated Storage Volume (Gal.)	Input BTU/Hr.	First Hour Rating (Gal.)	Uniform Energy Factor	Recovery at 90°F Rise*	
	U.S. Gal.	Imp. Gal.					U.S. GPH	Imp. GPH
URG250H6N	48	40	46	55,000	110	0.64	59	49
URG275H6N	75	62	72	76,000	135	0.59	82	68
URG2100H6N	100	83	95	80,000	157	0.57	85	71

Get additional product information, technical documentation, training videos and more at our exclusive site for the professional.

FOR THE PRO bwfortheapro.com

Model Number	A Floor to Flue Conn. in.	B Jacket Dia. in.	C Vent Size in.	D Floor to T&P Conn. in.	E Floor to Gas Conn. in.	F Floor to Top of Heater in.	G Floor to Water Conn. in.	H Depth in.	J C/L of Water Conn. in.	K Floor to Space Heating Inlet in.	L Floor to Space Heating Outlet in.	M Water Conn. NPT in.	R Space Heating Conn. Size in.	S Gas Conn. Size in.	Approx. Shipping Weight lbs.
URG250H6N	60 ⁵ / ₈	22	4	49 ⁷ / ₈	11 ⁷ / ₁₆	56 ³ / ₄	58 ¹ / ₁₆	25 ³ / ₈	11	13 ³ / ₈	49 ⁷ / ₈	3/4	3/4	1/2	194
URG275H6N	64 ¹ / ₄	26	4	53 ³ / ₈	15 ¹ / ₈	60 ⁵ / ₁₆	61 ³ / ₄	29 ³ / ₈	11	16 ¹¹ / ₁₆	53 ³ / ₈	1	3/4	1/2	286
URG2100H6N	69 ³ / ₈	28 ¹ / ₄	4	60 ³ / ₈	16 ¹ / ₂	66 ¹ / ₂	68 ⁵ / ₈	31 ³ / ₄	16	18 ³ / ₄	51 ¹¹ / ₁₆	1 ¹ / ₄	3/4	1/2	416

Available in Natural Gas only.

For 10 year models, change suffix from "6" to "10".

* Based on manufacturer's rated recovery efficiency.

Uniform Energy Factor and First Hour Rating are based on the latest AHRI directory listings.

Spec 1114. For additional documentation visit: www.bradfordwhite.com/documentation

page 35



Residential Gas Ultra Low NOx TTW® Power Vent Models

36/37

- ENERGY STAR® Qualified—Some models
- Ultra Low NOx Burner with Primary and Secondary Air Distribution Devices
- Bradford White ICON System®
 - Enhanced Performance
 - Advanced Temperature Control System
 - Intelligent Diagnostics
 - Separate Immersed Thermowell
- Eco-Defender Safety System® featuring the patented advanced ScreenLok® Technology flame arrestor design (except models above 75,000 BTU/Hr.)
 - Digital Thermal Sensor and Resettable Thermal Switch
 - Maintenance-Free
 - Sight Window
 - Pedestal Base
- Powerful Blower Motor
 - Exclusively featuring the AquaVENT MAX™ from Fasco™ the quietest blower motor in the industry (40,000 BTU/Hr. Models)
 - 10 ft. Power Cord Included (120 VAC)
- Horizontal and Vertical Venting
- Hydrojet® Total Performance System
- Vitrarglas® Lining
- Non-CFC Foam Insulation
- Water Connections
- Heat Traps
- Protective Magnesium Anode Rod
- T&P Relief Valve
- Low Restrictive Brass Drain Valve
- All Models Comply with the Latest Ultra Low NOx Requirement (10 ng/J NOx limit) except URG2PV75H6N (14 ng/J NOx limit)

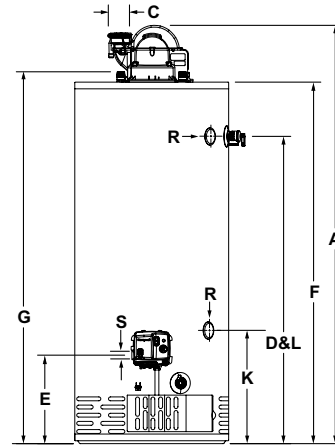
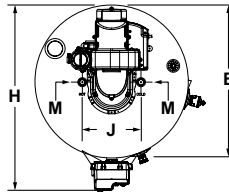

URG1PV40S6N

Spec 1255. For additional documentation visit: www.bradfordwhite.com/documentation

page 36

Ultra Low NOx TTW® Power Vent Models

DIMENSIONS IN INCHES

Meet or exceed ASHRAE 90.1b (current standard) C.E.C. Listed
80% Recovery Efficiency

Model Number	Nominal Gal. Capacity		DOE Rated Storage Volume (Gal.)	BTU/Hr. Input	First Hour Rating (Gal.)	Uniform Energy Factor	Recovery at 90°F Rise*		URG1PV40S6N URG1PV50S6N URG2PV40T6N URG2PV50T6N	2" Vent Pipe	3" Vent Pipe	URG2PV50H6N URG2PV75H6N	3" Vent Pipe	4" Vent Pipe
	U.S. Gal.	Imp. Gal.					U.S. GPH	Imp. GPH						
★ URG1PV40S6N	40	33	38	40,000	75	0.68	43	36	Max. Equivalent Length	†50 ft.	†120 ft.	Max. Equivalent Length	†50 ft.**	†180 ft.**
★ URG1PV50S6N	50	42	48	40,000	78	0.69	43	36	Min. Equivalent Length	7 ft.	15 ft.	Min. Equivalent Length	7 ft.	15 ft.
★ URG2PV40T6N	40	33	38	40,000	78	0.72	43	36	Number	1 45 ft.	115 ft.	Number	1 45 ft.	175 ft.
★ URG2PV50T6N	50	42	48	40,000	75	0.72	43	36	of	2 40 ft.	110 ft.	of	2 40 ft.	170 ft.
★ URG2PV50H6N	48	40	46	56,000	107	0.68	60	50	90° Elbows	3 35 ft.	105 ft.	90° Elbows	3 35 ft.	165 ft.
URG2PV75H6N	75	62	72	76,000	121	0.69	82	68	Subtract 5 ft. for each additional 90° elbow. † For high altitude installations, consult the installation instructions. **URG2PV75H6N maximum 3" vent is 50 ft.					

Model Number	A Floor to Top of Blower in.	B Jacket Dia. in.	C Vent Size in.	D Floor to T&P Conn. in.	E Floor to Gas Conn. in.	F Floor to Top of Heater in.	G Floor to Water Conn. in.	H Depth in.	J C/L of Water Conn. in.	K Floor to Space Heating Inlet in.	L Floor to Space Heating Outlet in.	M Water Conn. NPT in.	R Space Heating Conn. Size in.	S Gas Conn. Size in.	Approx. Shipping Weight lbs.
★ URG1PV40S6N	55 ⁷ / ₁₆	20	2 or 3	40 ¹ / ₈	11 ¹ / ₂	47 ³ / ₁₆	48 ¹⁵ / ₁₆	26 ³ / ₁₆	8	N/A	N/A	3/4	N/A	1/2	144
★ URG1PV50S6N	56 ⁷ / ₁₆	22	2 or 3	40 ⁵ / ₈	11 ¹ / ₂	48 ³ / ₁₆	49 ³ / ₄	27 ¹ / ₄	8	N/A	N/A	3/4	N/A	1/2	169
★ URG2PV40T6N	65	20	2 or 3	49 ¹¹ / ₁₆	11 ¹ / ₂	56 ³ / ₄	57 ¹³ / ₁₆	26	8	N/A	N/A	3/4	N/A	1/2	151
★ URG2PV50T6N	65	22	2 or 3	49 ⁷ / ₈	11 ¹ / ₂	56 ³ / ₄	58 ⁵ / ₈	27 ³ / ₁₆	8	N/A	N/A	3/4	N/A	1/2	176
★ URG2PV50H6N	66 ¹ / ₂	22	3 or 4	49 ⁷ / ₈	11 ¹ / ₂	56 ³ / ₄	57 ⁷ / ₈	26 ⁷ / ₈	11	13 ¹ / ₂	50 ¹ / ₈	3/4	3/4	1/2	192
URG2PV75H6N	69 ⁷ / ₁₆	26	3 or 4	51 ⁷ / ₈	11 ¹ / ₂	59 ⁵ / ₈	61 ¹ / ₈	30 ¹¹ / ₁₆	11	13 ³ / ₈	51 ¹ / ₂	3/4	3/4	1/2	270

Available in Natural Gas only. For 10 year models, change suffix from "6" to "10".

* Based on manufacturer's rated recovery efficiency.

110 VAC Required for Power Venting / 110 VAC, 60Hz., 3.1 Amperes.

Uniform Energy Factor and First Hour Rating are based on the latest AHRI directory listings.

★ = ENERGY STAR® Qualified.



page 37



Residential Gas Ultra Low NOx Power Direct Vent Models

38/39

- ENERGY STAR® Qualified
- Ultra Low NOx Burner with Primary and Secondary Air Distribution Devices
- Eco-Defender Safety System®
 - Maintenance-Free
 - Sight Window
 - Pedestal Base
- Closed Combustion Venting System
- Bradford White ICON System®
 - Enhanced Performance
 - Advanced Temperature Control System
 - Intelligent Diagnostics
 - Separate Immersed Thermowell
- Cast Aluminum Air Intake Boot
- Hydrojet® Total Performance System
- Vitraglas® Lining
- Powerful Blower Model
 - 10 ft. Power Cord Included (120 VAC)
- Optional Concentric Vent Kit Termination
- Horizontal and Vertical Venting
- 2" Non-CFC Foam Insulation
- Water Connections— 3/4" NPT
- 3/4" NPT Side Connections— (URG2PDV50H6N only)
- Heat Traps
- Protective Magnesium Anode Rod
- T&P Relief Valve
- Low Restrictive Brass Drain Valve
- Complies with the Latest Ultra Low NOx Requirement (10 ng/J NOx limit)

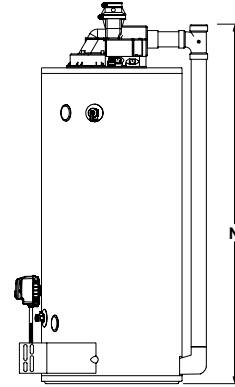
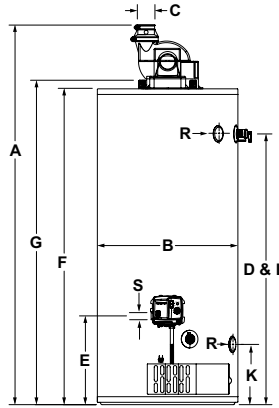
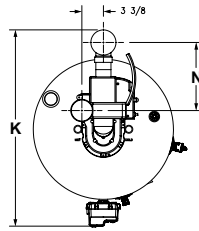

URG2PDV50H6N

page 38

Ultra Low NOx Power Direct Vent Models

DIMENSIONS IN INCHES

Meet or exceed ASHRAE 90.1b (current standard) C.E.C. Listed
78% Recovery Efficiency

Model Number	Nominal Gal. Capacity U.S. Imp. Gal.	DOE Rated Storage Volume (Gal.)	Input BTU/Hr.	First Hour Rating (Gal.)	Uniform Energy Factor	Recovery at 90°F Rise*	U.S. GPH	Imp. GPH
★ URG2PDV40S6N	40 33	38	40,000	75	0.70	43	36	36
★ URG2PDV50S6N	50 42	48	40,000	80	0.68	43	36	36
★ URG2PDV50H6N	48 40	46	50,000	82	0.68	64	45	45

Concentric Vent Kit Termination

2" Kit	A (in.)
P/N 239-44069-02	29 1/4
3" Kit	A (in.)
P/N 239-44069-01	36 1/4

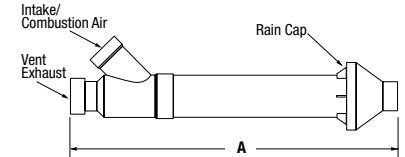

Model Number	A Floor to Exhaust Conn. in.	B Jacket Dia. in.	C Vent Size in.	D Floor to T&P Conn. in.	E Floor to Gas Conn. in.	F Floor to Top of Heater in.	G Floor to Water Conn. in.	H Depth in.	J C/L of Water Conn. in.	K Floor to Space Heating Inlet in.	L Floor to Space Heating Outlet in.	M Water Conn. NPT in.	N Floor to Air Intake in.	P C/L Distance from Intake to Exhaust in.	R Space Heating Conn. Size in.	S Gas Conn. Size in.	Approx. Shipping Weight lbs.
★ URG2PDV40S6N	59 7/8	22	2 or 3	42 9/16	13 15/16	49 9/16	50 15/16	32 5/16	8	N/A	N/A	3/4	59 7/16	10 1/2	3/4	1/2	170
★ URG2PDV50S6N	60 7/8	24	2 or 3	43 1/16	13 15/16	50 9/16	52	34 5/16	8	N/A	N/A	3/4	60 7/16	11 1/2	3/4	1/2	196
★ URG2PDV50H6N	69 1/16	22	3 or 4	52 5/16	13 15/16	59 9/16	50 3/16	30 7/16	11	13 13/16	52 5/16	3/4	69 3/16	8 7/8	3/4	1/2	208

Available in Natural Gas only. For 10 year model, change suffix "6" to "10".

* Based on manufacturer's rated recovery efficiency.

110 VAC Required for Power Venting / 110 VAC, 60Hz., 3.1 Amperes.

Uniform Energy Factor and First Hour Rating are based on the latest AHRI directory listings.

★ = ENERGY STAR® Qualified.



2" Vent Pipe	URG2PDV40S6N	URG2PDV50S6N
Max. Intake Length	35 ft.	35 ft.
Max. Exhaust Length	35 ft.	35 ft.
Min. Vent Length	7 ft.	7 ft.
Number of 90° Elbows	1 30 ft. 2 25 ft. 3 20 ft.	1 30 ft. 2 25 ft. 3 20 ft.

3" Vent Pipe	URG2PDV40S6N	URG2PDV50S6N	URG2PDV50H6N
Max. Intake Length	85 ft.	85 ft.	60 ft.
Max. Exhaust Length	85 ft.	85 ft.	60 ft.
Min. Vent Length	7 ft.	7 ft.	7 ft.
Number of 90° Elbows	1 80 ft. 2 75 ft. 3 70 ft.	1 80 ft. 2 75 ft. 3 70 ft.	1 80 ft. 2 75 ft. 3 70 ft.

4" Vent Pipe	URG2PDV50H6N
Max. Intake Length	100 ft.
Max. Exhaust Length	100 ft.
Min. Vent Length	7 ft.
Number of 90° Elbows	1 95 ft. 2 90 ft. 3 85 ft.

Subtract 5 ft. for each additional 90° elbow.

Spec 1128. For additional documentation visit: www.bradfordwhite.com/documentation

page 39



Residential Gas Ultra Low NOx Direct Vent Models

40/41

- Bradford White ICON System®
 - Enhanced Performance
 - Advanced Temperature Control System
 - Intelligent Diagnostics
 - Separate Immersed Thermowell
- Eco-Defender Safety System®
 - Resettable Thermal Switch
 - Maintenance-Free
 - Sight Window
 - Pedestal Base
- Ultra Low NOx Burner with Primary and Secondary Air Distribution Devices
- Closed Combustion
- Reinforced Seals
- Hydrojet® Total Performance System
- Vitraglas® Lining
- Cast Aluminum Air Intake Boot
- Telescoping Solid Vent Kits
- Flexible Vent Kit
- Side Connections—3/4" NPT (URG2DV50H6N only)
- 2" Non-CFC Foam Insulation
- Water Connections—3/4" NPT
- Heat Traps
- Protective Magnesium Anode Rod
- T&P Relief Valve
- Low Restrictive Brass Drain Valve
- Design Certified by CSA International (formerly AGA and CGA).
- Complies with the Latest Ultra Low NOx Requirement (10 ng/J NOx limit)

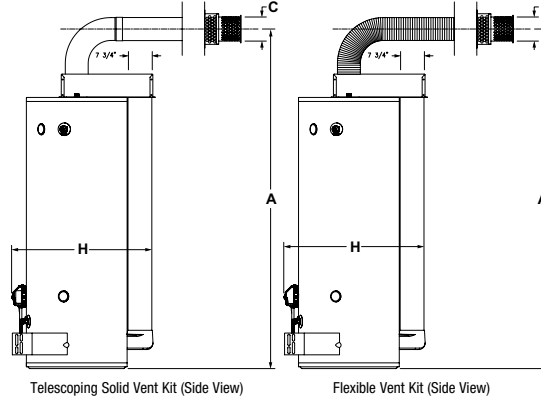
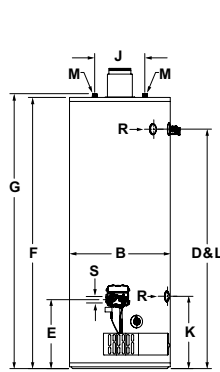

Spec 1122. For additional documentation visit: www.bradfordwhite.com/documentation

page 40

Ultra Low NOx Direct Vent Models

Meet or exceed ASHRAE 90.1b (current standard) C.E.C. Listed
78% Recovery Efficiency

DIMENSIONS IN INCHES

Model Number	Nominal Gal. Capacity U.S. Imp. Gal.	DOE Rated Storage Volume (Gal.)	Input BTU/Hr.	First Hour Rating (Gal.)	Uniform Energy Factor	Recovery at 90°F Rise*
URG2DV40S6N	40 33	38	38,000	62	0.60	41 34
URG2DV50S6N	50 42	47	38,000	78	0.63	41 34
URG2DV50H6N	48 40	46	45,000	83	0.64	46 38

Available in Natural Gas only. For 10 year models, change suffix from "6" to "10".

* Based on manufacturer's rated recovery efficiency.

Uniform Energy Factor and First Hour Rating are based on the latest AHRI directory listings.

Model Number	A Floor to C/L of Vent in.	B Jacket Dia. in.	C Vent Size in. ID / OD	D Floor to T&P Conn. in.	E Floor to Gas Conn. in.	F Floor to Top of Heater in.	G Floor to Water Conn. in.	H Depth in.	J C/L of Water Conn. in.	K Floor to Space Heating Inlet in.	L Floor to Space Heating Outlet in.	M Water Conn. NPT in.	R Space Heating Conn. Size in.	S Gas Conn. Size in.	Approx. Shipping Weight lbs.
URG2DV40S6N	63 1/2	22	3 5	43 7/16	15 1/8	50 5/16	51 3/4	31 3/8	8	N/A	N/A	3/4	N/A	1/2	198
URG2DV50S6N	72 1/2	22	3 5	52 5/16	15 1/8	59 5/16	60 11/16	31 1/2	8	N/A	N/A	3/4	N/A	1/2	221
URG2DV50H6N	74 1/4	22	4 6	52 5/16	15 1/8	59 5/16	60 3/16	31 5/8	11	15 13/16	52 5/16	3/4	3/4	1/2	240

URG2DV40S6N / URG2DV50S6N Solid Vent Kit: Part No. 239-51283-00.

URG2DV40S6N / URG2DV50S6N Flexible Vent Kit: Part No. 239-51284-00.

URG2DV50H6N Solid Vent Kit: Part No. 239-51286-00.

URG2DV50H6N Flexible Vent Kit: Part No. 239-51287-00.

Kits can be ordered and shipped with water heater, or ordered and shipped separately. For vent kit components and venting instructions, refer to Installation and Operation Manual.

URG2DV40S6N / URG2DV50S6N Optional Telescoping Solid Vent Kits:

Kit "A"	Telescopes from 4 3/4" to 5 1/4"	Part No. 239-41260-00
Kit "B"	Telescopes from 6 1/2" to 9 1/4"	Part No. 239-41331-00
Kit "C"	Telescopes from 13 3/4" to 23 1/4"	Part No. 239-41029-00
Kit "D"	Telescopes from 49 1/8" to 95 1/8"	Part No. 239-41424-00

URG2DV50H6N Optional Telescoping Solid Vent Kits:

Kit "F"	Telescopes from 4 3/4" to 5 1/4"	Part No. 239-42516-00
Kit "G"	Telescopes from 6 1/2" to 9 1/4"	Part No. 239-42517-00
Kit "H"	Telescopes from 13 3/4" to 23 1/4"	Part No. 239-42514-00
Kit "I"	Telescopes from 49 1/8" to 95 1/8"	Part No. 239-42512-00

page 41



Residential Gas Infiniti® K Series Tankless Indoor Models

42/43

- ENERGY STAR® Qualified
- Featuring the SRT™ Scale Reduction Technology
- STEADISE™ Technology
- Built-In Digital Control
- Active Bypass
- Intelligent Cascading Kit (Optional)*
- Modulation—Segmented burner with 22:1 turn down ratio
- Self-Calibrating Fan and Gas Valve
- External Recirculation Pump Wiring—Installed
- Venting Flexibility
- Gas Connection Flexibility—1/2", 3/4", or 1"
- Top Water Connections
- Inlet Water Filter—External access for easy maintenance
- Space Saving Installation
- Built-In Freeze Protection
- Easy LP Gas Field Convertibility—Purchase of additional kit NOT required to convert from NG to LP
- Pressure Relief Valve—Included (Integral port)
- Built In Flush Ports
- Flushing Condensate Trap
- Complies with the Latest Ultra-Low NOx Requirement (10 ng/J NOx limit)

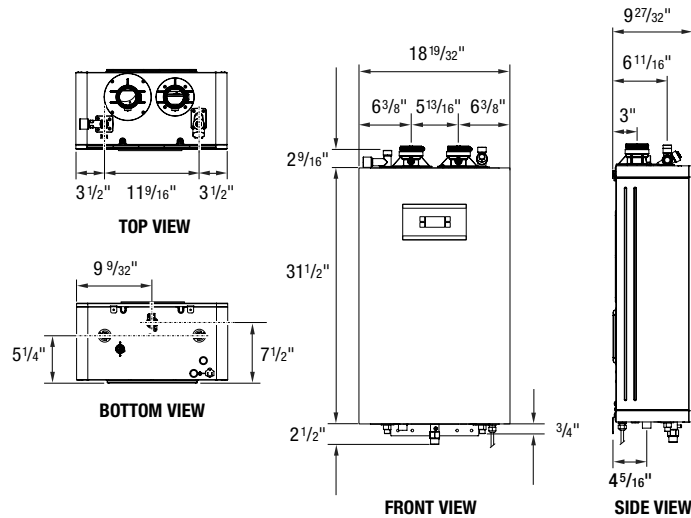

RTG-K-160-N1

page 42

Infiniti® K Series Tankless Indoor Models

DIMENSIONS IN INCHES

NATURAL GAS AND LIQUID PROPANE GAS MODELS

Model Number	Input (BTU/Hr.)		Vent Conn. in.	GPM Flow Rate at °F Temperature Rise			Uniform Energy Factor Nat. and LP	Minimum Water Flow GPM	Maximum Temperature Setting	Approx. Shipping Weight lbs.
	Nat.	LP		45°F	75°F	90°F				
★ RTG-K-160-N1	9,000 - 160,000	17,000 - 160,000	2	7.0	4.2	3.5	0.92	0.45	140°F	73
★ RTG-K-199-N1	9,000 - 199,000	17,000 - 199,000	2	8.7	5.2	4.4	0.96	0.45	140°F	79

Propane (LP) Models are not available for order from the factory.

All Natural Gas products shipped can be converted to Propane (LP) without the purchase of an additional kit.

Requires an electrical power supply from a 120VAC 60Hz., properly rated receptacle and must be properly grounded. Power supply cord provided.

★ = ENERGY STAR® Qualified.



Intelligent Cascading Kit:

* Any indoor Infiniti® K-Series tankless water heater purchased with the serial number "TEB0008188" and after, will have cascading technology available.

Up to 24 units can be connected together with ease.

Part Number 7736502750 (One for each additional water heater).

Optional Condensate Neutralizer Kit: Part Number A2123601.

Get additional product information, technical documentation, training videos and more at our exclusive site for the professional.

FOR THE PRO

bwfortheapro.com

Spec 1152. For additional documentation visit: www.bradfordwhite.com/documentation

page 43



Residential Gas
Infiniti® K Series Tankless Outdoor Models

44/45

- ENERGY STAR® Qualified
- Featuring the SRT™ Scale Reduction Technology
- STEADISET® Technology
- Built-In Digital Control
- Active Bypass
- Intelligent Cascading Kit (Optional)
- Modulation—Segmented burner with 22:1 turn down ratio
- Self-Calibrating Fan and Gas Valve
- External Recirculation Pump Wiring—Installed
- Gas Connection Flexibility—1/2", 3/4", or 1"
- Inlet Water Filter—External access for easy maintenance
- Space Saving Installation
- Built-In Freeze Protection
- Easy LP Gas Field Convertibility—Purchase of additional kit NOT required to convert from NG to LP
- Heat Exchanger—Primary Copper with Secondary Stainless Steel helps maximize life and minimize scale build-up
- Flushing Condensate Trap
- Complies with the Latest Ultra-Low NOx Requirement (10 ng/J NOx limit)

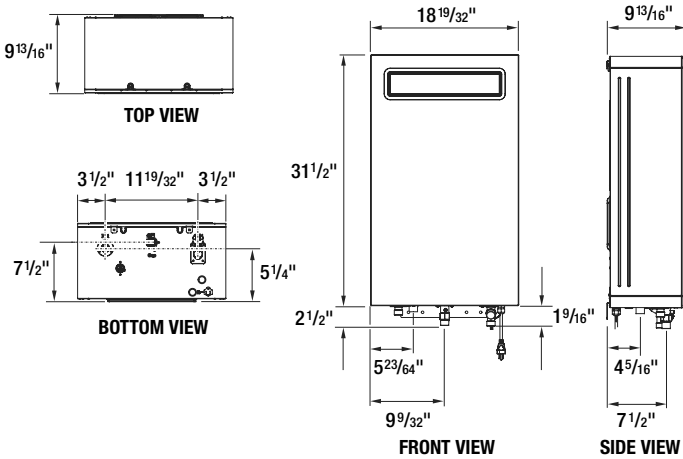

RTG-K-160-N2

page 44

Infiniti® K Series Tankless Outdoor Models

DIMENSIONS IN INCHES					NATURAL GAS MODELS			
Model Number	Input (BTU/Hr.)	GPM Flow Rate at °F Temperature Rise			Uniform Energy Factor	Minimum Water Flow	Maximum Temperature Setting	Approx. Shipping Weight lbs.
		45°F	75°F	90°F				
★ RTG-K-160-N2	9,000 - 160,000	7.0	4.2	3.5	0.92	0.45	140°F	73
★ RTG-K-199-N2	9,000 - 199,000	8.7	5.2	4.4	0.96	0.45	140°F	79

Requires an electrical power supply from a 120VAC 60Hz., properly rated receptacle and must be properly grounded. Power supply cord provided.

★ = ENERGY STAR® Qualified.



Intelligent Cascading Kit:
Up to 24 units can be connected together with ease.
Part Number 7736502750 (One for each additional water heater).

Optional Condensate Neutralizer Kit: Part Number A2123601.

Get additional product information, technical documentation, training videos and more at our exclusive site for the professional.

FOR THE PRO
bwfortheapro.com

Spec 1153. For additional documentation visit: www.bradfordwhite.com/documentation

page 45



Residential Gas Infiniti® L Tankless Indoor Model

46/47

- ENERGY STAR® Qualified
- Featuring the SRT™ Scale Reduction Technology
- STEADISET® Technology
- Hot Water Recirculation With Built-in Pump For Maximum Comfort
- Built-In Digital Control
- Active Bypass
- Modulation—Segmented burner with 22:1 turn down ratio
- Self-Calibrating Fan and Gas Valve
- External Recirculation Pump Wiring—Optional
- Gas Connection Flexibility—1/2", 3/4", or 1"
- Inlet Water Filter—External access for easy maintenance
- Space Saving Installation
- Built-In Freeze Protection
- Easy LP Gas Field Convertibility—Purchase of additional kit NOT required to convert from NG to LP
- Heat Exchanger—Primary Copper with Secondary Stainless Steel helps maximize life and minimize scale build-up
- Built In Flush Ports
- Flushing Condensate Trap
- Complies with the Latest Ultra-Low NOx Requirement (10 ng/J NOx limit)

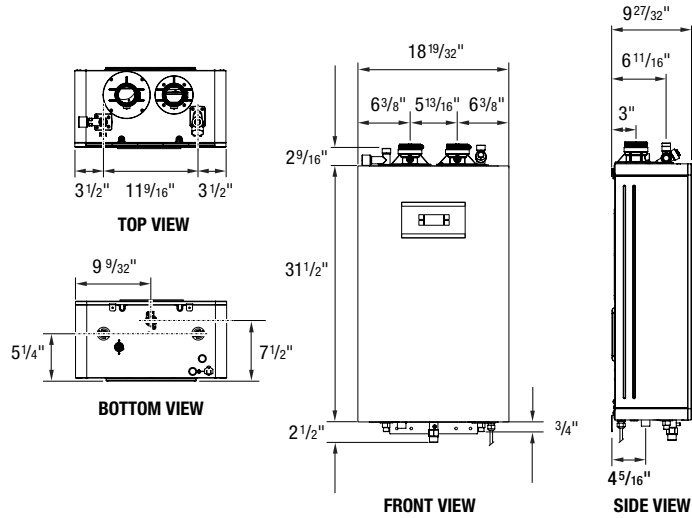

RTG-L-199-N1

page 46

Infiniti® L Tankless Indoor Model

DIMENSIONS IN INCHES

NATURAL GAS AND LIQUID PROPANE GAS MODELS

Model Number	Input (BTU/Hr.)		Vent Conn. in.	GPM Flow Rate at °F Temperature Rise			Uniform Energy Factor Nat. and LP	Minimum Water Flow GPM	Maximum Temperature Setting	Approx. Shipping Weight lbs.
	Nat.	LP		45°F	75°F	90°F				
★ RTG-L-199-N1	9,000 - 199,000	17,000 - 199,000	2	8.7	5.2	4.4	0.96	0.45	140°F	90

Requires an electrical power supply from a 120VAC 60Hz., properly rated receptacle and must be properly grounded. Power supply cord provided.

★ = ENERGY STAR® Qualified.



Optional Condensate Neutralizer Kit: Part Number A2123601.

2" Venting	Maximum allowable exhaust vent length	Maximum allowable intake vent length	Combined maximum allowable vent	3" Venting	Maximum allowable exhaust vent length	Maximum allowable intake vent length	Combined maximum allowable vent
Twin pipe	60 ft.	60 ft.	120 ft.	Twin pipe	280 ft.	280 ft.	560 ft.

Get additional product information, technical documentation, training videos and more at our exclusive site for the professional.

FOR THE PRO
 bwfortheapro.com

Spec 1154. For additional documentation visit: www.bradfordwhite.com/documentation

page 47



Residential Gas Infiniti Tankless® High Efficiency Model

48/49

- ENERGY STAR® Qualified
- Featuring the SRT™ Scale Reduction Technology
 - Vertical Modulating Burner Design
 - Dual Fan Configuration
 - Internal Turbulators
 - Dual Heat Exchanger
- Built-In Digital Control
- Active Bypass
- Intelligent Cascading Kit (Optional)
- Venting Flexibility
- Gas Connection Flexibility—1/2", 3/4", or 1"
- Inlet Water Filter
- Space Saving Installation
- Built-In Freeze Protection
- Interior and Exterior Installation Capability
- Complies with the Latest Ultra-Low NOx Requirement (10 ng/J NOx limit)
- High Temperature Kit- max set point 184°F (optional)

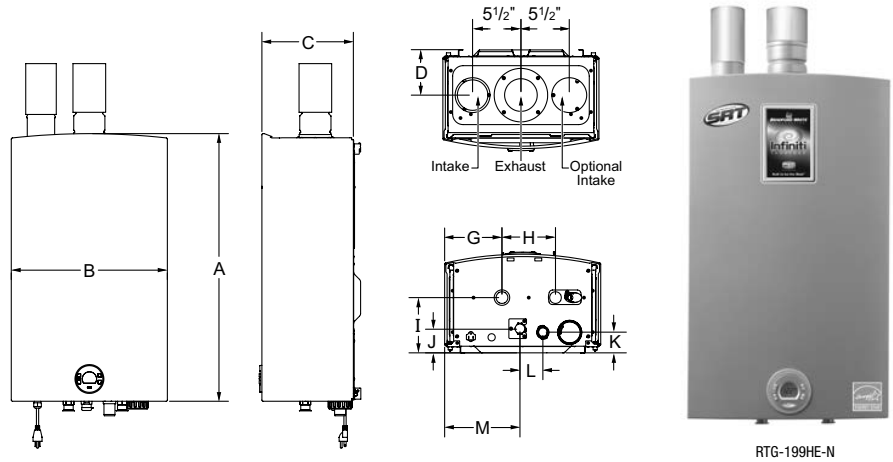

page 48

Infiniti Tankless® High Efficiency Model

DIMENSIONS IN INCHES

NATURAL GAS AND LIQUID PROPANE GAS MODELS

Model Number	Installation	Nat. BTU/Hr. Input	LP BTU/Hr. Input	Vent Conn. in.	GPM Flow Rate at °F Temperature Rise			Uniform Energy Factor Nat. and LP	Minimum Water Flow GPM	Maximum Temperature Setting
					45°F	75°F	90°F			
★ RTG-199HE-N	Indoor / Outdoor*	19,900-199,000	19,900-199,000	3	8.3	5.0	4.2	0.92	0.5	140°F

Model Number	A Height in.	B Width in.	C Depth in.	D Intake/Exhaust Center Line in.	G Hot Water Outlet in.	H Cold Water Inlet in.	I Hot Water Outlet in.	J Gas Conn. in.	K Condensate Tee in.	L Condensate Tee in.	M Gas Conn. in.	Approx. Shipping Weight lbs.
★ RTG-199HE-N	30 9/16	17 13/16	10 7/16	5 3/16	6 9/16	6 1/8	6 5/16	2 11/16	2 3/8	2 5/8	7 1/2	74

For Propane (LP) Models change suffix "N" to "X".

Requires an electrical power supply from a 120 VAC 60Hz., properly rated receptacle and must be properly grounded. Power supply cord provided.

Uniform Energy Factor is based on the latest AHRI directory listings.

* Outdoor installation requires optional outdoor kit.

★ = ENERGY STAR® Qualified.



Intelligent Cascading Kit:

Up to 24 units can be connected together with ease.

Part No. 7736502750 (One for each additional water heater).

Vent Requirements	2" Venting		3" Venting		4" Venting	
	Twin Pipe	Concentric	Twin Pipe	Concentric	Twin Pipe	Concentric
Max. Allowable Exhaust Vent Length	9.5 ft.	31.0 ft.	23.0 ft.	63.0 ft.	43.0 ft.	
Max. Allowable Intake Vent Length	9.5 ft.	31.0 ft.	23.0 ft.	63.0 ft.	43.0 ft.	
Combined Max. Allowable Vent	19.0 ft.	62.0 ft.	46.0 ft.	126.0 ft.	86.0 ft.	
Elbow Equivalency 90°	5.0 ft.	5.0 ft.	5.0 ft.	5.0 ft.	5.0 ft.	
Elbow Equivalency 45°	2.5 ft.	2.5 ft.	2.5 ft.	2.5 ft.	2.5 ft.	
Max. Number of 90° Elbows	1	5	4	7	7	

Spec 151. For additional documentation visit: www.bradfordwhite.com/documentation

page 49



Residential Gas Infiniti Tankless® Mid Efficiency Model

50/51

- Featuring the SRT™ Scale Reduction Technology
 - Vertical Modulating Burner Design
 - Dual Fan Configuration
 - Internal Turbulators
 - Dual Heat Exchanger
- Built-In Digital Control
- Intelligent Cascading Kit (Optional)
- Gas Connection Flexibility—1/2", 3/4", or 1"
- Inlet Water Filter
- Space Saving Installation
- Built-In Freeze Protection
- Interior and Exterior Installation Capability
- Complies with the Latest Ultra-Low NOx Requirement (10 ng/J NOx limit)
- High Temperature Kit- max set point 184°F (optional)

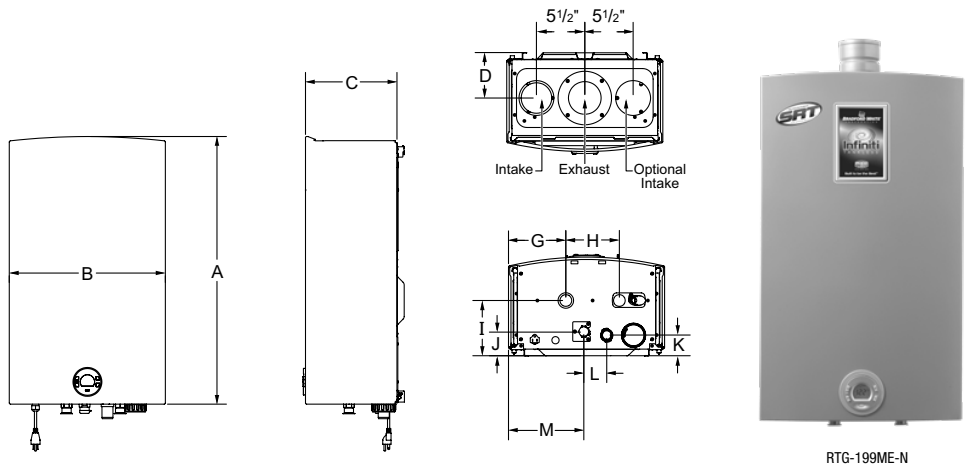

page 50

Infiniti Tankless® Mid Efficiency Model

DIMENSIONS IN INCHES

NATURAL GAS AND LIQUID PROPANE GAS MODELS

Model Number	Installation		Nat. BTU/Hr. Input LP BTU/Hr. Input		Vent Conn. in.	GPM Flow Rate at °F Temperature Rise			Uniform Energy Factor Nat. and LP	Minimum Water Flow GPM	Maximum Temperature Setting	
						45°F	75°F	90°F				
RTG-199ME-N	Indoor / Outdoor*		19,900-199,000	19,900-199,000	3	7.3	4.4	3.7	0.82	0.5	140°F	
Model Number	A Height	B Width	C Depth	D Intake/Exhaust Center Line	G Hot Water Outlet	H Cold Water Inlet	I Hot Water Outlet	J Gas Conn.	K Condensate Tee	L Condensate Tee	M Gas Conn.	Approx. Shipping Weight
	in.	in.	in.	in.	in.	in.	in.	in.	in.	in.	in.	lbs.
RTG-199MF-N	30 ⁹ / ₁₆	17 ¹³ / ₁₆	10 ⁷ / ₁₆	5 ³ / ₁₆	6 ⁹ / ₁₆	6 ¹ / ₈	6 ⁵ / ₁₆	2 ¹¹ / ₁₆	2 ³ / ₈	2 ⁵ / ₈	7 ¹ / ₂	67

For Propane (LP) Models change suffix "N" to "X".

Requires an electrical power supply from a 120 VAC 60Hz., properly rated receptacle and must be properly grounded.

Power supply cord provided.

Uniform Energy Factor is based on the latest AHRI directory listings.

* Outdoor installation requires optional outdoor kit.

Intelligent Cascading Kit:

Up to 24 units can be connected together with ease.

Part No. 7736502750 (One for each additional water heater).

Vent Requirements	3" Venting	4" Venting
Max. Allowable Exhaust Vent Length	28.5 ft.	61.25 ft.
Max. Allowable Intake Vent Length	28.5 ft.	61.25 ft.
Combined Max. Allowable Vent	57.0 ft.	122.5 ft.
Elbow Equivalency 90°	5.0 ft.	5.0 ft.
Elbow Equivalency 45°	2.5 ft.	2.5 ft.
Max. Number of 90° Elbows	5	7

Spec 150. For additional documentation visit: www.bradfordwhite.com/documentation

page 51



Residential Electric Energy Saver Water Heaters

52/53

General Information

Specify voltage and wattage when ordering.

All models are ETL listed. All water connections are 3/4" NPT true dielectric fittings. All electrical connections are 3/4". All models are certified at 300 psi test pressure and 150 psi working pressure. All models come equipped with two installed heat traps (except Utility, and RE120L).

Note: The **Upright** and **Lowboy** heaters will be wired single phase interlocking (non-simultaneous) 240 volt with 4500 watt elements, unless otherwise specified. Other wattages are available up to 6000 watts (208, 240, 277 and 480 volt). (Reference chart on following page for non-simultaneous and simultaneous limitations). 4500 watt/240 volt elements require a 25 amp or 30 amp circuit breaker. For 120 volt (non-simultaneous), all models have a maximum wattage of 3000. (120 and 277 volt can only be wired single phase.)

Note: The **Utility** Heaters will be wired for 120 volt with a 1500 watt element. The 1500 watt/120 volt element requires a 20 amp breaker. Other wattages are available. Maximum wattage for 6 and 12 gallon tall utility models is 3000W. Maximum wattage for 10, 15 and 20 gallon utility models is 6000W.

Incoloy Element Availability Chart					
Watts	120V	208V	240V	277V	480V
1500	yes	yes	yes	no	no
2000	no	yes	yes	yes	yes
2500	no	yes	yes	no	no
3000	no	yes	yes	yes	yes
3500	no	yes	yes	no	no
4000	no	yes	yes	yes	yes
4500	no	yes	yes	yes	yes
5000	no	yes	yes	yes	yes
5500	no	yes	yes	yes	yes
6000	no	yes	yes	yes	yes

page 52

Phase	1	Single Phase
	3	Three Phase

EX: RE350S6-1NCWW

Operation	N	Non-Simultaneous
	S	Simultaneous

EX: RE350S6-1NCWW

Designator	A	C	E	H	J	L*
Voltage	120	208/240	277	480	600	208

EX: RE350S6-1NCWW

* Use "L" voltage designator if wiring 208V with 5000, 5500 or 6000 watt.

Wattage Limitations for Simultaneous Operation	Voltage				
	120V	208V	240V	277V	480V
1500W / 1500W	yes	yes	yes	yes	yes
2000W / 2000W	no	yes	yes	yes	yes
2500W / 2500W	no	yes	yes	yes	yes
3000W / 3000W	no	yes	yes	yes	yes
3500W / 3500W	no	yes	yes	no	no
4000W / 4000W	no	yes	yes	yes	yes
4500W / 4500W	no	yes	yes	yes	yes
5000W / 5000W	no	yes	yes	yes	yes
5500W / 5500W	no	yes	yes	no	no
6000W / 6000W	no	no	yes	yes	yes

Wattage Limitations for Non-Simultaneous Operation	Wattage Limitations for Single Element Operation	Voltage				
		120V	208V	240V	277V	480V
1500W / 1500W	1500W	yes	yes	yes	yes	yes
2000W / 2000W	2000W	yes	yes	yes	yes	yes
2500W / 2500W	2500W	yes	yes	yes	yes	yes
3000W / 3000W	3000W	yes	yes	yes	yes	yes
3500W / 3500W	3500W	no	yes	yes	no	no
4000W / 4000W	4000W	no	yes	yes	yes	yes
4500W / 4500W	4500W	no	yes	yes	yes	yes
5000W / 5000W	5000W	no	yes	yes	yes	yes
5500W / 5500W	5500W	no	yes	yes	yes**	yes**
6000W / 6000W	6000W	no	yes	yes	yes	yes

** INCOLOY® element only.

For 120V, 277V, 480V, and 600V operation

Designator	J	K	L*	M	N	P	R	S	T	W	X	Y	Z
Wattage	1000	1250	1500	2000	2500	3000	3500	3800	4000	4500	5000	5500	6000

EX: RE350S6-1NCWW

* Use "L" voltage designator if wiring 208V with 2500W or 3000W on RE16U, and RE112T models.
All 120V and 277V models are shipped standard single phase. Three phase not available.

For 240V and 208V operation (Dual rated elements show a value for both 240V and 208V)

Designator	J	K	L	M	N	P	R	S	T	W	X	Y	Z	X**	Y**	Z**
240V Wattage	1000	1250	1500	2000	2500	3000	3500	3800	4000	4500	5000	5500	6000	—	—	—
208V Wattage	—	—	1000	1500	2000	—	2500	—	3000	3500	—	4000	4500	5000	5500	6000†

EX: RE350S6-1NCWW, will give 240V with 4500W/4500W. This same heater can also be energized at 208V with reduced wattage of 3500W/3500W.

** Use "L" voltage designator if wiring 208V with 5000W 5500W or 6000W.

† Available in Non-Simultaneous Only.

page 53



Residential Electric AeroTherm® Series Heat Pump Models

54/55

- ENERGY STAR® Qualified
- The AeroTherm® Series Control Panel
 - User-Friendly, Easy-to-Read Display
 - LED's Clearly Indicate the Current Operating Mode
 - Display Communicates Current Status, Mode and Set Point, and Displays Error Messages when Applicable
- Operating Modes Offer Flexibility
 - Heat Pump (Only) Mode
 - Hybrid Mode
 - Electric (Only) Mode
 - Vacation Mode
- Quiet Operation
- Can Be Laid Down for Easier Transportation
- Easily Accessible Top Mounted Washable Air Filter
- Operating Air Temperature Range of 35-120°F for the Heat Pump
- Backup Electric Heating Elements
- Direct Heat Transfer with Immersed Elements
- 2" Non-CFC Foam Insulation
- Water Connections—3/4" NPT
- Protective Magnesium Alloy Anode Rod
- T&P Relief Valve
- Low Restrictive Brass Drain Valve
- Northern Climate Tier 3 Capable
- Optional Ducting Kit

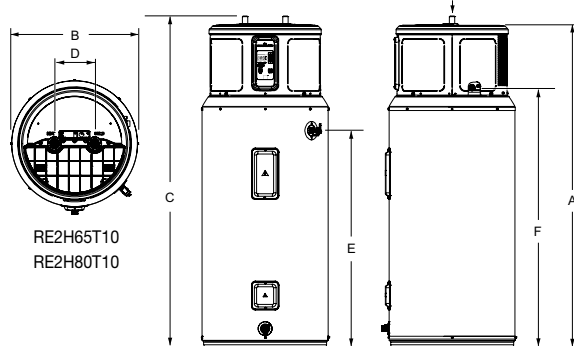
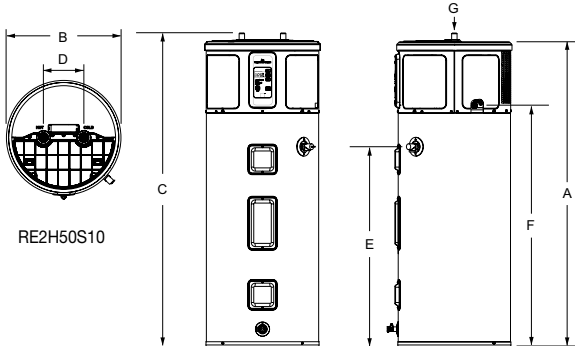

RE2H50S10

page 54

AeroTherm® Series Heat Pump Models

DIMENSIONS IN INCHES

C.E.C. Listed

Model Number	Nominal Gal. Capacity		DOE Rated Storage Volume (Gal.)	First Hour Delivery Rating (Gal.)	Uniform Energy Factor	Recovery at 90°F Rise*		A Floor to Top of Heater in.	B Jacket Dia. in.	C Floor to Water Conn. in.	D C/L of Water Conn. in.	E Floor to T&P Conn. in.	F Floor to Condensate Conn. in.	G Water Conn. Size NPT in.	Approx. Shipping Weight lbs.
★RE2H50S10	50	42	45	65	3.39	21	18	59 3/16	21 3/4	60 3/4	8	38 7/8	46 13/16	3/4	195
★RE2H65T10	65	54	65	77	3.45	21	18	63 3/4	25	65 1/2	8	42 7/8	51 3/8	3/4	236
★RE2H80T10	80	67	75	87	3.48	21	18	70 13/16	25	73 1/2	8	50 3/8	58 11/16	3/4	259

* Based on 4500/4000W, Non-Simultaneous Operation.

For 6 year models, change suffix from "10" to "6".

Uniform Energy Factor and First Hour Rating are based on the latest AHRI directory listings.

★ = ENERGY STAR® Qualified.



Optional Ducting Kit: Part No. 415-52820-00.

Kit installation also requires - 8" insulated flexible ducting, ducting support hangers and exterior wall vents for inlet & outlet. Additional clearances required for ducting, refer to ducting kit instructions.

PARTS INCLUDED

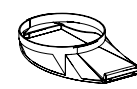

Upper Inlet Duct Adapter

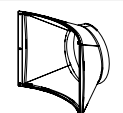

Outlet Duct Adapter

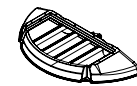

Lower Inlet Duct Adapter

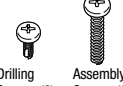

Drilling Screws (6) Assembly Screws (8)



Inlet Duct Filter



8" Hose Clamps (2)

Get additional product information, technical documentation, training videos and more at our exclusive site for the professional.

FOR THE PRO
bwfortheapro.com

Spec 1900. For additional documentation visit: www.bradfordwhite.com/documentation

page 55



Residential Electric Upright Models

56/57

- Fully Automatic Controls
- Direct Heat Transfer with Immersed Elements
- Hydrojet® Total Performance System
- Vitraglas® Lining
- Non-CFC Foam Insulation
- Water Connections—3/4" NPT
- Heat Traps
- Protective Magnesium Anode Rod
- Simultaneous and Non-Simultaneous Operation Available
- Voltages Available—120V, 208V, 240V, 277V, 480V
- Single Phase or Three Phase Operation Available—(120V & 277V Single Phase Only)
- T&P Relief Valve
- Design Evaluated by ETL in Accordance with Part 280.707(d) of HUD Mobile Home Construction and Safety Standards for Energy Efficiency
- Low Restrictive Brass Drain Valve

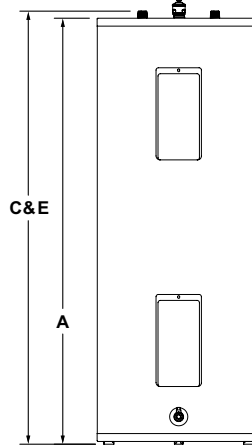
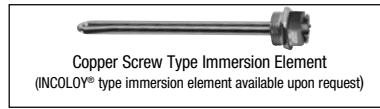
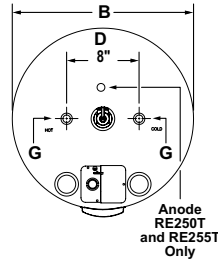

RE250S6

page 56

Upright Models

DIMENSIONS IN INCHES

C.E.C. Listed

Model Number	Nominal Gal. Capacity		DOE Rated Storage Volume (Gal.)	First Hour Rating (Gal.)	Uniform Energy Factor	Recovery at 90°F Rise*		A Floor to Top of Heater	B Jacket Dia.	C Floor to Water Conn.	D C/L of Water Conn.	E Floor to T&P Conn.	G Water Conn. NPT	Approx. Shipping Weight
	U.S. Gal.	Imp. Gal.				U.S. GPH	Imp. GPH	in.	in.	in.	in.	in.	in.	lbs.
RE330S6	30	25	27	43	0.92	21	18	46 11/16	20	48 15/16	8	48 15/16	3/4	100
RE240S6†	40	33	36	48	0.91	21	18	47 3/16	20	49 7/16	8	49 7/16	3/4	123
RE340S6	40	33	36	49	0.91	21	18	47 3/16	22	49 7/16	8	49 7/16	3/4	114
RE340T6	40	33	36	53	0.92	21	18	60 3/16	20	62 7/16	8	62 7/16	3/4	125
RE350S6	50	42	45	60	0.92	21	18	47 3/16	24	49 7/16	8	49 7/16	3/4	144
RE250S6†	50	42	45	60	0.92	21	18	47 3/16	22	49 7/16	8	49 7/16	3/4	143
RE250T6	50	42	45	64	0.92	21	18	59	20	60 1/4	8	60 1/4	3/4	130
RE255T6	55	46	55	75	0.93	21	18	56 15/16	23	58 3/16	8	58 3/16	3/4	142

† Models include supplied insulation blanket (2" thick). Dimensions in charts above do not include blanket thickness. For 10 year models, change suffix "6" to "10".

* Based on 4500W/4500W, Non-Simultaneous operation. Uniform Energy Factor and First Hour Rating are based on the latest AHRI directory listings.

	Wattage Limitations for Simultaneous Operation					Wattage Limitations for Non-Simultaneous Operation					Recovery ▲ GPH Temperature Rise °F				
	Voltage					Voltage					Wattage	60	80	90	100
	120V	208V	240V	277V	480V	120V	208V	240V	277V	480V					
1500W / 1500W	yes	yes	yes	yes	yes	yes	yes	yes	yes	yes	1500W	10	8	7	6
2000W / 2000W	no	yes	yes	yes	yes	yes	yes	yes	yes	yes	2000W	14	10	9	8
2500W / 2500W	no	yes	yes	yes	yes	yes	yes	yes	yes	yes	2500W	17	13	11	10
3000W / 3000W	no	yes	yes	yes	yes	yes	yes	yes	yes	yes	3000W	21	15	14	12
3500W / 3500W	no	yes	yes	no	no	no	yes	yes	no	no	3500W	24	18	16	14
4000W / 4000W	no	yes	yes	yes	yes	no	yes	yes	yes	yes	4000W	28	21	18	16
4500W / 4500W	no	yes	yes	yes	yes	no	yes	yes	yes	yes	4500W	31	23	21	19
5000W / 5000W	no	yes	yes	yes	yes	no	yes	yes	yes	yes	5000W	34	26	23	21
5500W / 5500W	no	yes	yes	no	no	no	yes	yes	no	no	5500W	38	29	25	23
6000W / 6000W	no	no	yes	yes	yes	no	yes	yes	yes	yes	6000W	41	31	28	25

▲ (GPH based on Non-Simultaneous operation, when Simultaneous operation the GPH will approximately double.)

Spec 1201. For additional documentation visit: www.bradfordwhite.com/documentation

page 57



Residential Electric Lowboy Models

58/59

- Models above 20-Gallon Meet or Exceed Efficiency Requirements
- Fully Automatic Controls
- Low Restrictive Brass Drain Valve
- Direct Heat Transfer with Immersed Elements
- Hydrojet® Total Performance System
- Vitraglas® Lining
- Non-CFC Foam Insulation
- Water Connections—3/4" NPT
- Heat Traps (except RE120L)
- Protective Magnesium Anode Rod
- Simultaneous and Non-Simultaneous Operation Available
- Voltages Available—120V, 208V, 240V, 277V, 480V
- Single Phase or Three Phase Operation Available—(120V & 277V Single Phase Only)
- T&P Relief Valve—Side T&P is standard. Optional top T&P location is available
- Design Evaluated by ETL in Accordance with Part 280.707(d) of HUD Mobile Home Construction and Safety Standards for Energy Efficiency

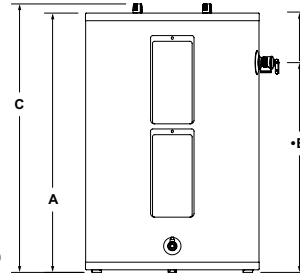
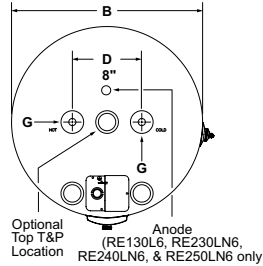

RE240LN6

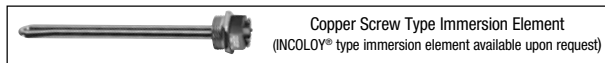

Lowboy Models

DIMENSIONS IN INCHES

C.E.C. Listed

Model Number	Nominal Gal. Capacity		DOE Rated Storage Volume (Gal.)	First Hour Rating (Gal.)	Uniform Energy Factor	Recovery at 90°F Rise*		A Floor to Top of Heater in.	B Jacket Dia. in.	C Floor to Water Conn. in.	D C/L of Water Conn. in.	E Floor to T&P Conn. in.	G Water Conn. NPT in.	Approx. Shipping Weight lbs.
	U.S. Gal.	Imp. Gal.				U.S. GPH*	Imp. GPH*							
RE120L6†	19	16	—	—	—	21	18	24 7/16	18	25 11/16	8	18 15/16 / 25 11/16	3/4	65
RE130L6**	28	23	26	42	0.92	21	18	29 9/16	20	31 5/16	8	23 9/16 / 31 5/16	3/4	99
RE230LN6	28	23	26	41	0.92	21	18	29 9/16	23	31 9/16	8	23 9/16 / 31 5/16	3/4	102
RE230L6**	28	23	26	42	0.92	21	18	29 9/16	22	31 13/16	8	22 13/16 / 31 13/16	3/4	108
RE240LN6	37	31	34	45	0.92	21	18	32 1/16	24 1/2	34 5/16	8	23 9/16 / 34 5/16	3/4	126
RE240L6**	38	32	35	49	0.91	21	18	32 3/8	24	34 5/8	8	23 9/16 / 34 5/8	3/4	140
RE250LN6	47	39	43	61	0.92	21	18	33 5/16	26	36 1/16	8	24 9/16 / 36 1/16	3/4	173

** Models include supplied insulation blanket (2" thick). Dimensions in charts above do not include blanket thickness.

For 10 year models, change suffix "6" to "10".
* Based on 4500W/4500W, Non-Simultaneous operation.
All models available with optional top T&P location (plugged).

† Exempt from ASHRAE 90.1b (current standard).
Uniform Energy Factor and First Hour Rating are based on the latest AHRI directory listings.

Wattage Limitations for Simultaneous Operation	Voltage					Wattage Limitations for Non-Simultaneous Operation	Voltage					Recovery ▲ GPH Temperature Rise °F					
	120V	208V	240V	277V	480V		120V	208V	240V	277V	480V		Wattage	60	80	90	100
1500W / 1500W	yes	yes	yes	yes	yes	1500W / 1500W	yes	yes	yes	yes	yes	1500W	10	8	7	6	5
2000W / 2000W	no	yes	yes	yes	yes	2000W / 2000W	yes	yes	yes	yes	yes	2000W	14	10	9	8	7
2500W / 2500W	no	yes	yes	yes	yes	2500W / 2500W	yes	yes	yes	yes	yes	2500W	17	13	11	10	9
3000W / 3000W	no	yes	yes	yes	yes	3000W / 3000W	yes	yes	yes	yes	yes	3000W	21	15	14	12	10
3500W / 3500W	no	yes	yes	no	no	3500W / 3500W	no	yes	yes	no	no	3500W	24	18	16	14	12
4000W / 4000W	no	yes	yes	yes	yes	4000W / 4000W	no	yes	yes	yes	yes	4000W	28	21	18	16	14
4500W / 4500W	no	yes	yes	yes	yes	4500W / 4500W	no	yes	yes	yes	yes	4500W	31	23	21	19	15
5000W / 5000W	no	yes	yes	yes	yes	5000W / 5000W	no	yes	yes	yes	yes	5000W	34	26	23	21	17
5500W / 5500W	no	yes	yes	no	no	5500W / 5500W	no	yes	yes	no	no	5500W	38	29	25	23	19
6000W / 6000W	no	no	yes	yes	yes	6000W / 6000W	no	yes	yes	yes	yes	6000W	41	31	28	25	21

• = Not available on RE130L and RE230LN6.

▲ (GPH based on Non-Simultaneous operation, when Simultaneous operation the GPH will approximately double.)

Spec 1203. For additional documentation visit: www.bradfordwhite.com/documentation

page 58

page 59



Residential Electric Utility Models

60/61

- Fully Automatic Controls
- Direct Heat Transfer with a Single Immersed Element
- Vitraglas® Lining
- 1" Non-CFC Foam Insulation
- Water Connections—3/4" NPT
- Protective Magnesium Anode Rod
- Voltages Available—120V, 208V, 240V, 277V, 480V
- Single Phase Operation Only
- T&P Relief Valve
- Design Evaluated by ETL in Accordance with Part 280.707(d) of HUD Mobile Home Construction and Safety Standards for Energy Efficiency

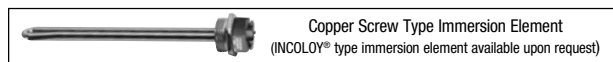
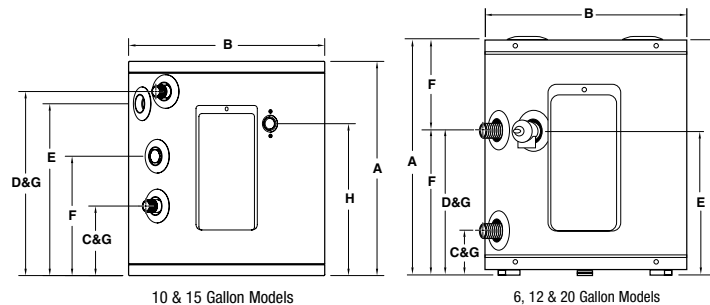

RE112U6

page 60

Utility Models

DIMENSIONS IN INCHES

C.E.C. Listed

Model Number	Nominal Gal. Capacity		Recovery at 90°F Rise*		A Floor to Heater Top in.	B Jacket Dia. in.	C Floor to Cold Water Conn. in.	D Floor to Hot Water Conn. in.	E Floor to T&P Conn. in.	F Floor to Anode Rod in.	G Water Conn. NPT in.	H Floor to Electrical Access in.	Approx. Shipping Weight lbs.
	U.S. Gal.	Imp. Gal.	U.S. GPH	Imp. GPH									
RE16U6†	6	5	7	6	16 ^{3/16}	14	2 ^{3/4}	9 ^{3/4}	9 ^{3/4}	N/A	3/4	16 ^{3/16}	35
RE110U6	10	8	7	6	17 ^{7/16}	16	5 ^{9/8}	14 ^{15/16}	13 ^{15/16}	9 ^{5/8}	3/4	12	44
RE112U6	12	10	7	6	16 ^{15/16}	18	2 ^{3/4}	9 ^{3/4}	9 ^{3/4}	N/A	3/4	16 ^{15/16}	53
RE112T6†	12	10	7	6	27 ^{5/16}	14	2 ^{3/4}	20 ^{5/8}	20 ^{5/8}	N/A	3/4	27 ^{5/16}	48
RE115U6	15	13	7	6	20 ^{3/16}	18	6 ^{1/16}	17 ^{11/16}	16 ^{11/16}	10 ^{1/16}	3/4	12 ^{7/16}	58
RE120U6	19	16	7	6	24 ^{7/16}	18	2 ^{3/4}	18 ^{3/16}	18 ^{3/16}	N/A	3/4	24 ^{7/16}	65

† Maximum wattage at any voltage is 3000W.

For 10 year models, change suffix "6" to "10".

Single element only.

* Based on 1500W operation.

Get additional product information, technical documentation,
training videos and more at our exclusive site for the professional.

FOR THE PRO
bwforthe pro.com

Wattage Limitations	Voltage				
	120V	208V	240V	277V	480V
1500W	yes	yes	yes	yes	yes
2000W	yes	yes	yes	yes	yes
2500W	yes	yes	yes	yes	yes
3000W	yes	yes	yes	yes	yes
3500W	no	yes	yes	no	no
4000W	no	yes	yes	yes	yes
4500W	no	yes	yes	yes	yes
5000W	no	yes	yes	yes	yes
5500W	no	yes	yes	no	no
6000W	no	yes	yes	yes	yes

Wattage	Recovery GPH Temperature Rise °F				
	60	80	90	100	120
1500W	10	8	7	6	5
2000W	14	10	9	8	7
2500W	17	13	11	10	9
3000W	21	15	14	12	10
3500W	24	18	16	14	12
4000W	28	21	18	16	14
4500W	31	23	21	19	15
5000W	34	26	23	21	17
5500W	38	29	25	23	19
6000W	41	31	28	25	21

Spec 1222. For additional documentation visit: www.bradfordwhite.com/documentation

page 61



Residential Electric
Powerful Compact® Model

62/63

- Compact Design
- Fully Automatic Control
- Direct Heat Transfer with Immersed Element
- Vitraglas® Lining
- Non-CFC Insulation
- Water Connections—3/4" NPT
- Protective Magnesium Anode Rod
- T&P Relief Valve Opening

Optional Features:

- Wall Mounting Bracket
- Aluminum Anode Rod

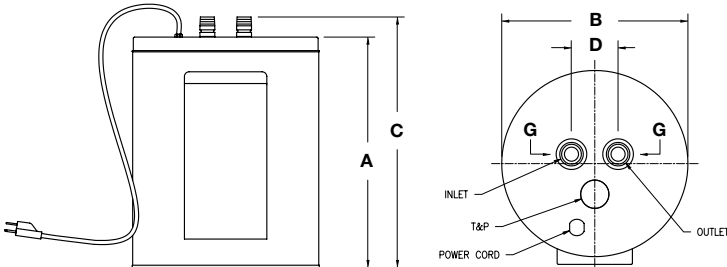

RE1-2U6

page 62

Powerful Compact® Model

DIMENSIONS IN INCHES

Model Number	Nominal Gal. Capacity		Recovery at 90°F Rise*		A Floor to Top of Heater	B Jacket Dia.	C Floor to Water Conn.	D C/L of Water Conn.	G Water Conn. NPT	Approx. Shipping Weight
	U.S. Gal.	Imp. Gal.	U.S. GPH	Imp. GPH	in.	in.	in.	in.	in.	lbs.
RE1-2U6	2	1.7	7	6	12	9 15/16	12 3/4	2 5/8	3/4	13

Includes a 4ft. cord with 3 prong grounded plug (20 amp circuit required).
For 10 year models, change suffix "6" to "10".
Single element only.

* Based on 1500W operation.
Only available as 120V / 1500W.

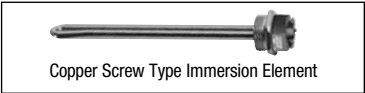

Copper Screw Type Immersion Element

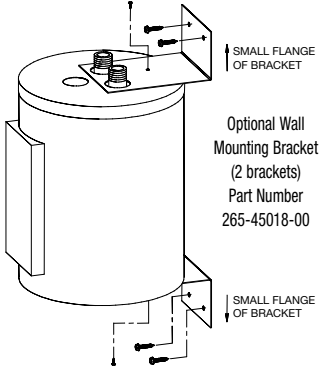

Get additional product information, technical documentation,
training videos and more at our exclusive site for the professional.



Spec 1215. For additional documentation visit: www.bradfordwhite.com/documentation

page 63



Residential Electric Specialty Products

KwickShot® Tankless Electric Water Heaters

64/65



Single Point Flow Controlled, Non-Thermostatic Models (Single Phase Only)

Flow Controlled Models Feature:

- On Demand Hot Water—No delay.
- Continuous Hot Water—No storage capacity to run out.
- Self-diagnostics With Intelligent Controls—Actively protect heater in installed environment.
- LED Indicator—Communicates system status and heater operation feedback.
- Low Flow Activation—Starting at .25 GPM turn on (model dependent).
- Dry-fire Protection—Engages upon start-up to help avoid dry-fire occurrence.
- Flexible Installation—Unit can be installed in any plumbing orientation.
- Compact Size—Fits almost anywhere; suitable for ADA compliant facilities.
- Easy Installation—Only one cold water line needed for installation.
- No T&P Relief Valve Needed—Ready to go, right out-of-the-box (check local codes).
- Integral 3/8" Compression Fittings—No sweat connections or soldering required.
- Control System—Activates heater only on demand.
- Bare Wire Technology—Responsive non-thermostatic tankless technology.
- Automatic High Temperature Limit Reset—Enables safe operation (USA Models only).
- Warranty—5-year limited warranty on leaks, 1-year on parts.

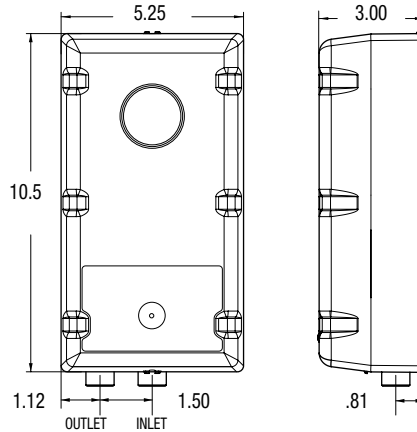

FLOW CONTROLLED

Spec 230. For additional documentation visit: www.bradfordwhite.com/documentation

page 64

Single Point Flow Controlled, Non-Thermostatic Models (Single Phase Only)

Model Number	kW Rating	Voltage (Volts)	AMPS	TURN ON (GPM)	Temperature Rise °F						Recommended Wire Size (75° C/CU)
					0.35 GPM	0.5 GPM	0.75 GPM	1.0 GPM	1.5 GPM	2.0 GPM	
TEF024V120	2.4	120	20	0.25	55	33	22	16	11	8	14 AWG
TEF030V120	3.0	120	25	0.25	68	41	27	20	14	10	12 AWG
TEF030V208	3.0	208	15	0.25	68	41	27	20	14	10	14 AWG
TEF030V277	3.0	277	11	0.25	68	41	27	20	14	10	14 AWG
TEF035V120	3.5	120	29	0.30	80	48	32	24	16	12	10 AWG
TEF035V240	3.5	240	15	0.30	80	48	32	24	16	12	14 AWG
TEF035V240*	2.6	208	13	0.30	59	36	24	18	12	9	14 AWG
TEF041V208	4.1	208	20	0.40	—	56	37	28	19	14	14 AWG
TEF041V277	4.1	277	15	0.40	—	56	37	28	19	14	14 AWG
TEF048V240	4.8	240	20	0.40	—	66	44	33	22	16	14 AWG
TEF048V240*	3.6	208	17	0.40	—	49	33	25	16	12	14 AWG
TEF055V240	5.5	240	23	0.50	—	75	50	38	25	19	12 AWG
TEF055V240*	4.1	208	20	0.50	—	56	37	28	19	14	12 AWG
TEF060V277	6.0	277	22	0.70	—	—	55	41	27	20	12 AWG
TEF065V240	6.5	240	27	0.70	—	—	59	44	30	22	10 AWG
TEF065V240*	4.8	208	23	0.70	—	—	44	33	22	16	10 AWG
TEF075V240	7.5	240	32	0.70	—	—	68	51	34	26	10 AWG
TEF075V240*	5.6	208	27	0.70	—	—	51	38	25	19	10 AWG
TEF080V277	8.0	277	29	0.70	—	—	73	55	36	27	10 AWG
TEF083V208	8.3	208	40	0.70	—	—	76	57	38	28	8 AWG
TEF090V277	9.0	277	33	0.70	—	—	82	61	41	31	10 AWG
TEF095V240	9.5	240	40	0.80	—	—	—	65	43	32	8 AWG
TEF095V240*	7.1	208	34	0.80	—	—	—	38	25	19	8 AWG
TEF100V277	10.0	277	36	0.80	—	—	—	68	46	34	8 AWG

System Specifications DIMENSIONS IN INCHES

Dimensions:	10.5" H x 5.25" W x 3" D
Product Weight:	(model dependent) 2.75 lb/3 lb
Cover:	ABS-UL 94 5VA
Color:	White
Minimum Operating Pressure:	30 PSI
Maximum Operating Pressure:	150 PSI
Element:	Replaceable nichrome cartridge insert
Fittings:	3/8" compression fittings

U.S. Patent Pending Technology.

Note: For optimum performance, mounting location should be located within 2 feet of fixture.

Get additional product information, technical documentation, training videos and more at our exclusive site for the professional.

FOR THE PRO
bwfortheopro.com

* 240V units can be used on 208V single phase with 25% reduced temperature output. Please note per UL standards the rating plate and installation instructions will all be according to a 240V applied voltage. Check with local officials prior to derating the electrical infrastructure.

page 65



Residential Electric Specialty Products

KwickShot® Tankless Electric Water Heaters (continued)



66/67

Thermostatic Models (Single Phase Only)

Thermostatic Models Feature:

- Self-diagnostics With Intelligent Controls—Actively protect heater in installed environment.
- Digital LED Display—With accessible user interface communicates system status and heater operation feedback.
- Dry-fire Protection—Engages upon start-up to help avoid dry-fire occurrence.
- Flexible Installation—Unit can be installed in any plumbing orientation.
- Compact Size—Fits almost anywhere; suitable for ADA compliant facilities.
- Easy Installation—Only one input line, hot or cold, needed for installation.
- Industry's Lowest Activation—With 0.2 GPM turn on flow.
- Silent Operation on All Models—Except TET115V240.
- No T&P Relief Valve Needed—Ready to go, right out-of-the-box (check local codes).
- Integral 3/8" Compression Fittings—No sweat connections or soldering required.
- Control System—Activates heater only on demand.
- Designed to Deliver Hot Water—To a single pipe faucet, mixing valves or mixing faucets.
- Save Water and Time—By installing unit at the point-of-use.
- Active Energy Management With Power Modulation—Allows for thermostatic accuracy.
- High Temperature Limit Switch—Enables safe operation.
- Warranty—5-year limited warranty on leaks, 1-year on parts.

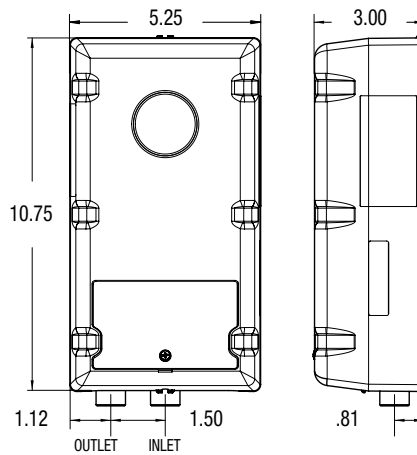

THERMOSTATIC

Spec 231. For additional documentation visit: www.bradfordwhite.com/documentation

page 66

Thermostatic Models (Single Phase Only)

Model Number	kW Rating	Voltage (Volts)	AMPS	TURN ON (GPM)	Temperature Rise °F				Recommended Wire Size (75° C/CU)
					0.35 GPM	0.5 GPM	1.0 GPM	2.0 GPM	
TET055V240	5.5	240	23	0.20	107	75	38	19	12 AWG
TET055V240*	4.1	208	20	0.20	80	56	28	14	12 AWG
TET055V240ML**	5.5	240	23	0.20	†	75	38	19	12 AWG
TET060V277	6.0	277	22	0.20	†	82	41	20	12 AWG
TET060V277ML**	6.0	277	22	0.20	†	†	41	20	12 AWG
TET065V240	6.5	240	27	0.20	†	89	44	22	10 AWG
TET065V240*	4.9	208	24	0.20	96	67	33	17	10 AWG
TET065V240ML**	6.5	240	27	0.20	†	†	44	22	10 AWG
TET075V240	7.5	240	32	0.20	†	102	51	26	10 AWG
TET075V240*	5.6	208	27	0.20	109	76	38	19	10 AWG
TET075V240ML**	7.5	240	32	0.20	†	†	51	26	10 AWG
TET080V277	8.0	277	29	0.20	†	109	55	27	10 AWG
TET080V277ML**	8.0	277	29	0.20	†	†	55	27	10 AWG
TET083V208	8.3	208	40	0.20	†	†	57	28	8 AWG
TET083V208ML**	8.3	208	40	0.20	†	†	57	28	8 AWG
TET090V277	9.0	277	33	0.20	†	†	61	31	10 AWG
TET090V277ML**	9.0	277	33	0.20	†	†	61	31	10 AWG
TET095V240	9.5	240	40	0.20	†	†	65	32	8 AWG
TET095V240*	7.0	208	34	0.20	†	96	48	24	8 AWG
TET095V240ML**	9.5	240	40	0.20	†	†	65	32	8 AWG
TET100V277	10.0	277	36	0.20	†	†	68	34	8 AWG
TET100V277ML**	10.0	277	36	0.20	†	†	68	34	8 AWG
TET115V240	11.5	240	48	0.20	†	†	79	39	8 AWG
TET115V240*	8.7	208	42	0.20	†	†	59	30	8 AWG
TET115V240ML**	11.5	240	48	0.20	†	†	79	39	8 AWG

System Specifications DIMENSIONS IN INCHES

Dimensions:	10.75" H x 5.25" W x 3" D
Product Weight:	4 lb
Cover:	ABS-UL rated 94 V-0
Color:	White
Adjusted Temperature Range:	70°F-140°F**
Minimum Dynamic Operating Pressure:	35 PSI
Maximum Dynamic Operating Pressure:	150 PSI
Element:	Replaceable nichrome cartridge insert
Fittings:	3/8" compression fittings

** Multi-Lavatory (ML) thermostatic models are designed to deliver a maximum water temperature of 110°F.

UL listed file number: E86887

U.S. Patent #'s: 4,762,980 and 4,960,976

Note: For optimum performance, mounting location should be located within 2 feet of fixture.

* 240V units can be used on 208V single phase with 25% reduced temperature output. Please note per UL standards the rating plate and installation instructions will all be according to a 240V applied voltage. Check with local officials prior to derating the electrical infrastructure.

** Multi-Lavatory (ML) thermostatic models are designed to deliver a maximum water temperature of 110°F. ML models are supplied with multiple .35 GPM aerators (refer to I&O manual).

† Temperature electronically controlled to factory preset maximum temperature.

page 67



Residential Solar
Solar Saver® Electric Backup Models

68/69

- Vitraglas® Lining
- Hydrojet® Total Performance System
- Backup Element—4500W element provides heat only when solar energy does not satisfy demand
- Fully Automatic Controls—Fast acting surface-mount thermostat
- Top of Tank Access for Wiring and Water Connections
- Pre-Wired Sensor Lead
- Thermal Feet
- Water Connections—3/4" NPT true dielectric fittings
- 2" Non-CFC foam insulation
- Protective Magnesium Anode Rod
- T&P Relief Valve
- Low Restrictive Brass Drain Valve
- Consult Factory for Other Wattages

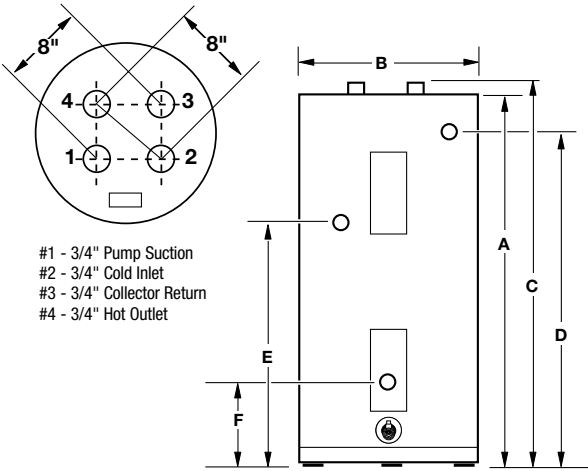

MS80R6SS

page 68

Solar Saver® Electric Backup Models

DIMENSIONS IN INCHES										Meet or exceed ASHRAE 90.1b (current standard)	
Model Number	Capacity		Recovery at 90°F Rise*		A Floor to Heater Top	B Jacket Dia.	C Floor to Water Conn.	D Floor to T&P Conn.	E Floor to Alt. Collector Return Conn.	F Floor to Alt. Collector Supply Conn.	Approx. Shipping Weight
	U.S. Gal.	Imp. Gal.	U.S. GPH	Imp. GPH	in.	in.	in.	in.	in.	in.	lbs.
MS65R6SS	65	54	21	18	59	22	60	52½	—	—	168
MS80R6SS†	80	67	21	18	59	24	60	52½	38	7⅞	210
MS120R6SS†	119	99	21	18	62½	28	63½	56	38¼	7⅞	310

NOTE: Suffix letter "S" denotes single element and surface mounted thermostat.
If requirements are for storage only, do not use element connections.
Second suffix letter "S" denotes Screw-Type Element. Meets California Energy Commission requirements.
† Models offer additional pump suction and collector return connections.

Get additional product information, technical documentation,
training videos and more at our exclusive site for the professional.



Spec 500. For additional documentation visit: www.bradfordwhite.com/documentation

page 69



Residential Gas Combi1® Single-Wall Atmospheric Models

70/71

- Defender Safety System® featuring the patented advanced ScreenLok® Technology flame arrestor design (50 gallon model only)
- Resetttable Thermal Switch
- Maintenance-Free
- Sight Window
- Pedestal Base

All Combi1® Models Feature:

- Bradford White ICON System®
 - Enhanced Performance
 - Advanced Temperature Control System
 - Intelligent Diagnostics
- Heat Exchanger—Single-wall 1½" O.D. enamel coated (Vitrage®) Steel Coil
- Provides Domestic Hot Water and Space Heating in One System
- Low Heat Exchanger Head Loss—Up to 10 GPM flow, with less than 5 ft. of Head Loss
- Vitrage® Lining
- Hydrojet® Total Performance System

- Water Connections – 3/4" NPT true dielectric fittings
- 1" Front NPT Supply and Return Connections
- 2" Non-CFC Foam Insulation
- Two Protective Anode Rods
- T&P Relief Valve
- Low Restrictive Brass Drain Valve
- Thermostatic Mixing Valve (ASSE Approved)

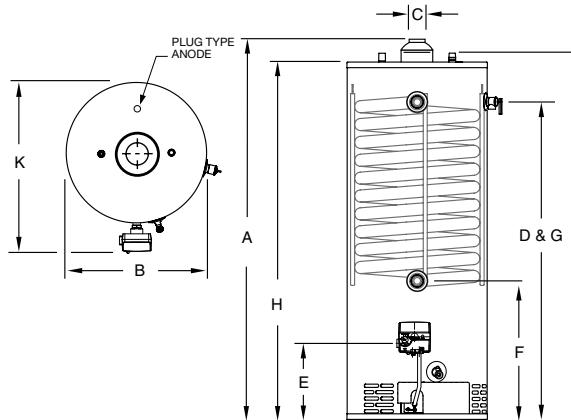

C-SW2-504T10FBN

page 70

Combi1® Single-Wall Atmospheric Models

DIMENSIONS IN INCHES

Meet or exceed ASHRAE 90.1b (current standard) C.E.C. Listed
80% Recovery Efficiency

Model Number	Capacity		Nat. BTU/Hr. Input	LP BTU/Hr. Input	Recovery 90°F Rise*				A Floor to Flue Conn.	B Jacket Dia.	C Vent Size	D Floor to T&P Conn.	E Floor to Gas Conn.	F Floor to Exchanger Inlet	G Floor to Exchanger Outlet	H Floor to Top of Heater	J Floor to Water Conn.	K Depth	Approx. Shipping Weight
	U.S. Gal.	Imp. Gal.			Nat. U.S. GPH	Nat. Imp. GPH	LP U.S. GPH	LP Imp. GPH	in.	in.	in.	in.	in.	in.	in.	in.	in.	in.	in.
C-SW2-504T10FBN	45	38	65,000	61,000	70	59	66	55	59 1/4	22	4	50	13	31 1/3	50	56 3/8	60 3/8	24 1/2	236
C-SW2-75T10BN	72	61	76,000	76,000	81	70	81	70	62 1/4	26	4	51 3/4	13 7/8	29 5/8	51 3/4	59	63	30 3/8	292

All propane models feature a Titanium Stabilized Stainless Steel burner.

For propane (LP) models change suffix "BN" to "SX".

* Based on manufacturer's rated recovery efficiency.

Heat Exchanger Values*

Supply Temperature	140°F	120°F	100°F
Return Temperature	120°F	100°F	80°F
Differential	20°F	20°F	20°F
Flow Rate (C-SW2-504T10FBN)	4.1 GPM	4.6 GPM	4.6 GPM
Flow Rate (C-SW2-75T10BN)	4.1 GPM	5.6 GPM	5.6 GPM
Net Output (C-SW2-504T10FBN)	35,500 BTU/Hr.	39,500 BTU/Hr.	39,500 BTU/Hr.
Net Output (C-SW2-75T10BN)	35,500 BTU/Hr.	47,500 BTU/Hr.	47,500 BTU/Hr.

* These values were obtained using 180°F stored tank temperature. Net Output is the space heating capacity based on normal piping and pickup allowance of 15%. Actual values may vary based on circulator flow rate, number of zones, water and space heating demands. Numbers subject to change.

Heat Exchanger Head Loss	
GPM	Ft. of Hd. Loss
2	0.03
5	0.20
8	0.51
10	0.80
12	1.15

Get additional product information, technical documentation, training videos and more at our exclusive site for the professional.

FOR THE PRO
bwwforthe pro.com

Spec 548. For additional documentation visit: www.bradfordwhite.com/documentation

page 71



Residential Gas Combi1® TTW® Single-Wall Power Vent Models

72/73

- Defender Safety System® featuring the patented advanced ScreenLok® Technology flame arrestor design (50 gallon model only)
 - Resetttable Thermal Switch
 - Maintenance-Free
 - Sight Window
 - Pedestal Base
- Horizontal and Vertical Venting
- Water Connections—3/4" NPT true dielectric fittings
- 1" NPT Front Supply and Return Connections
- 2" Non-CFC Foam Insulation
- Two Protective Anode Rods
- T&P Relief Valve
- Low Restrictive Brass Drain Valve
- Thermostatic Mixing Valve (ASSE Approved)

All Combi1® TTW® Models Feature:

- Bradford White ICON System®
 - Enhanced Performance
 - Advanced Temperature Control System
 - Intelligent Diagnostics
 - Separate Immersed Thermowell
- Heat Exchanger—Single-wall 1½" O.D. enamel coated (Vitraglas®) steel
- Provides Domestic Hot Water and Space Heating in One System
- Low Heat Exchanger Head Loss—Up to 10 GPM flow, with less than 5 ft. of Head Loss
- Vitraglas® Lining
- Power Vented
 - 10 ft. Power Cord Included (120 VAC)
- Hydrojet® Total Performance System

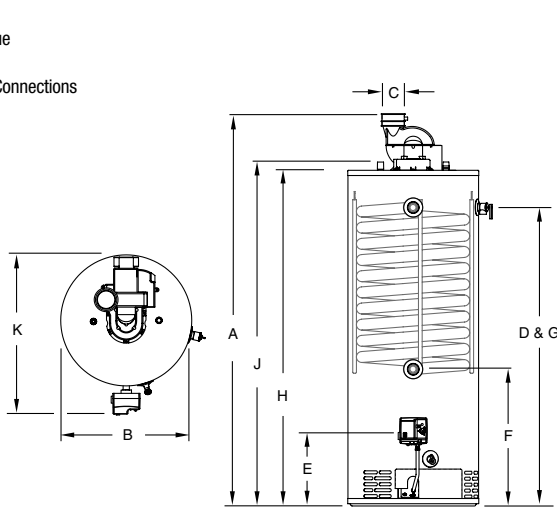

C-SW2-TW50T10FBN

page 72

Combi1® TTW® Single-Wall Power Vent Models

DIMENSIONS IN INCHES

Meet or exceed ASHRAE 90.1b (current standard) C.E.C. Listed
80% Recovery Efficiency

Model Number	Capacity		Nat. BTU/Hr. Input	LP BTU/Hr. Input	Recovery 90°F Rise*				A Floor to Vent Conn.	B Jacket Dia.	C Vent Size	D Floor to T&P Conn.	E Floor to Gas Conn.	F Floor to Exchanger Inlet	G Floor to Exchanger Outlet	H Floor to Heater Top in.	J Floor to Water Conn. in.	K Depth	Approx. Shipping Weight
	U.S. Gal.	Imp. Gal.			Nat. U.S. GPH	Nat. Imp. GPH	LP U.S. GPH	LP Imp. GPH	in.	in.	in.	in.	in.	in.	in.	in.	in.	in.	in.
C-SW2-TW50T10FBN	45	38	67,000	60,000	72	60	65	54	65%	22	3	50%	11%	31½	50	56%	60%	26%	243
C-SW2-TW75T10BN	72	61	76,000	75,500	82	69	81	67	68%	26	3	53	15	34½	53	60%	64%	31	313

All propane models feature a Titanium Stabilized Stainless Steel burner.

For propane (LP) models change suffix "BN" to "SX".

* Based on manufacturer's rated recovery efficiency.

120 VAC Required for Power Venting / 120 VAC, 60Hz., 3.1 Amperes.

C-SW2-TW50T C-SW2-TW75T	3" Vent Pipe	4" Vent Pipe
Max. Equivalent Length	†60 ft.**	†180 ft.
Min. Equivalent Length	7 ft.	15 ft.
Number of 90° Elbows	1 55 ft. 2 50 ft. 3 45 ft.	175 ft. 170 ft. 165 ft.

Subtract 5 ft. for each additional 90° elbow.

† For high altitude installations, consult the installation instructions.

** C-SW2-TW75 maximum 3" vent length is 50 ft.

Heat Exchanger Values*

Supply Temperature	140°F	120°F	100°F
Return Temperature	120°F	100°F	80°F
Differential	20°F	20°F	20°F
Flow Rate (C-SW2-TW50T10FBN)	4.1 GPM	4.6 GPM	4.6 GPM
Net Output (C-SW2-TW50T10FBN)	35,000 BTU/Hr.	39,500 BTU/Hr.	39,500 BTU/Hr.
Flow Rate (C-SW2-TW75T10BN)	4.1 GPM	5.6 GPM	5.6 GPM
Net Output (C-SW2-TW75T10BN)	35,000 BTU/Hr.	47,500 BTU/Hr.	47,500 BTU/Hr.

* These values were obtained using 180°F stored tank temperature. Net Output is the space heating capacity based on normal piping and pickup allowance of 15%. Actual values may vary based on circulator flow rate, number of zones, water and space heating demands. Numbers subject to change.

Heat Exchanger Head Loss	
GPM	Ft. of Hd. Loss
2	0.03
5	0.20
8	0.51
10	0.80
12	1.15

Spec 542. For additional documentation visit: www.bradfordwhite.com/documentation

page 73



Residential Gas Combi2® Double-Wall Atmospheric Models

74/75

- Defender Safety System® featuring the patented advanced ScreenLok® Technology flame arrestor design (50 gallon model only)
 - Resetttable Thermal Switch
 - Maintenance-Free
 - Sight Window
 - Pedestal Base
- 3/4" Front NPT Supply and Return Connections
- 2" Non-CFC Foam Insulation
- Two Protective Anode Rods
- T&P Relief Valve
- Low Restrictive Brass Drain Valve
- Thermostatic Mixing Valve (ASSE Approved)

All Combi2® Models Feature:

- Bradford White ICON System®
 - Enhanced Performance
 - Advanced Temperature Control System
 - Intelligent Diagnostics
- Heat Exchanger—Double-wall 1½" O.D. enamel coated (Vitrarglas®) steel coil ensures separation of potable water and heating fluid
- Provides Domestic Hot Water and Space Heating in One System
- Low Heat Exchanger Head Loss—Up to 8 GPM flow, with less than 6 ft. of Head Loss
- Vitrarglas® Lining
- Hydrojet® Total Performance System
- Water Connections—3/4" NPT true dielectric fittings

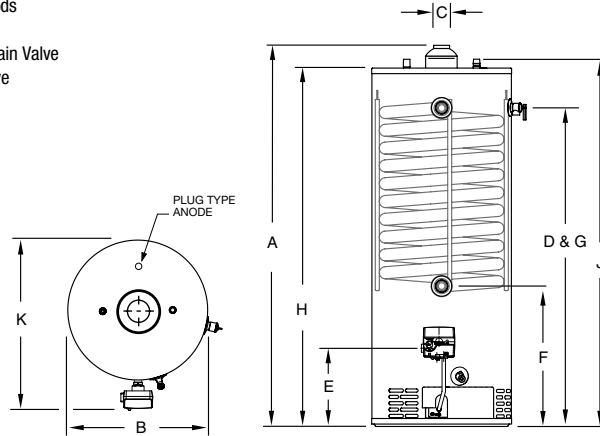

C-DW2-504T10FBN

page 74

Combi2® Double-Wall Atmospheric Models

DIMENSIONS IN INCHES

Meet or exceed ASHRAE 90.1b (current standard) C.E.C. Listed
80% Recovery Efficiency

Model Number	Capacity		Nat. BTU/Hr. Input	LP BTU/Hr. Input	Recovery 90°F Rise*				A Floor to Flue Conn.	B Jacket Dia.	C Vent Size	D Floor to T&P Conn.	E Floor to Gas Conn.	F Floor to Exchanger Inlet	G Floor to Exchanger Outlet	H Floor to Top of Heater	J Floor to Water Conn.	K Depth	Approx. Shipping Weight
	U.S. Gal.	Imp. Gal.			Nat. U.S. GPH	Nat. Imp. GPH	U.S. GPH	LP Imp. GPH											
C-DW2-504T10FBN	45	38	65,000	61,000	70	59	66	55	59 1/4	22	4	50	13	27 7/8	50	56 3/8	60 3/8	24 1/2	238
C-DW2-75T10BN	72	61	76,000	76,000	81	70	81	70	62 1/4	26	4	51 3/4	13 7/8	29 5/8	51 3/4	59	63	30 3/8	302

All propane models feature a Titanium Stabilized Stainless Steel burner.

For propane (LP) models change suffix "BN" to "SX".

* Based on manufacturer's rated recovery efficiency.

Heat Exchanger Values*

Supply Temperature	140°F	120°F	100°F
Return Temperature	120°F	100°F	80°F
Differential	20°F	20°F	20°F
Flow Rate	2.3 GPM	3.4 GPM	4.4 GPM
Net Output	20,000 BTU/Hr.	29,000 BTU/Hr.	38,000 BTU/Hr.

* These values were obtained using 180°F stored tank temperature. Net Output is the space heating capacity based on normal piping and pickup allowance of 15%. Actual values may vary based on circulator flow rate, number of zones, water and space heating demands. Numbers subject to change.

Heat Exchanger Head Loss	
GPM	Ft. of Hd. Loss
2	0.15
5	0.94
8	2.40
10	3.75
12	5.40

Get additional product information, technical documentation,
training videos and more at our exclusive site for the professional.

FOR THE PRO
bwhforthepro.com

Spec 545. For additional documentation visit: www.bradfordwhite.com/documentation

page 75



Residential Gas Combi2® TTW® Double-Wall Power Vent Models

76/77

- Defender Safety System® featuring the patented advanced ScreenLok® Technology flame arrestor design (50 gallon model only)
 - Resetttable Thermal Switch
 - Maintenance-Free
 - Sight Window
 - Pedestal Base

All Combi2® TTW® Models Feature:

- Bradford White ICON System®
 - Enhanced Performance
 - Advanced Temperature Control System
 - Intelligent Diagnostics
 - Separate Immersed Thermowell
- Heat Exchanger—Double-wall 1½" O.D. enamel coated (Vitraglas®) steel coil ensures separation of potable water and heating fluid
- Provides Domestic Hot Water and Hydronic Heating in One System
- Low Heat Exchanger Head Loss—Up to 8 GPM flow, with less than 6 ft. of Head Loss
- Vitraglas® Lining
- Hydrojet® Total Performance System

- Power Vented
 - 10 ft. Power Cord Included (120 VAC)
- Horizontal and Vertical Venting
- Water Connections—¾" NPT true dielectric fittings
- ¾" Front Supply and Return Connections
- 2" Non-CFC Foam Insulation
- Two protective Anode Rods
- T&P Relief Valve
- Low Restrictive Brass Drain Valve
- Thermostatic Mixing Valve (ASSE Approved)

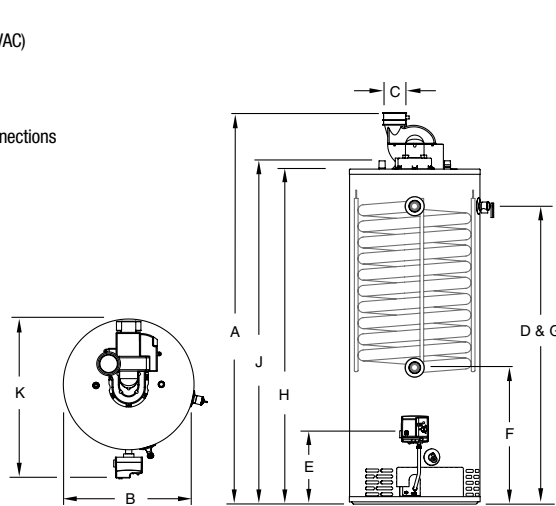

C-DW2-TW50T10FBN

page 76

Combi2® TTW® Double-Wall Power Vent Models

DIMENSIONS IN INCHES

Model Number	Capacity		LP BTU/Hr. Input	Recovery 90°F Rise*				A Floor to Vent Conn.	B Jacket Dia.	C Vent Size	D Floor to T&P Conn.	E Floor to Gas Conn.	F Floor to Exchanger Inlet	G Floor to Exchanger Outlet	H Floor to Heater Top	J Floor to Water Conn.	K Depth	Approx. Shipping Weight
	U.S. Gal.	Imp. Gal.		Nat. U.S. GPH	Nat. Imp. GPH	LP U.S. GPH	LP Imp. GPH											
C-DW2-TW50T10FBN	45	38	67,000	60,000	72	60	65	54	65%	22	3	50%	11½	28	50%	56%	60%	245
C-DW2-TW75T10FBN	72	61	76,000	75,500	82	69	81	67	68%	26	3	53	15	30%	53	60%	64%	315

Meet or exceed ASHRAE 90.1b (current standard) C.E.C. Listed
Recovery Efficiency ranging up to 80% (Minimum)

All propane models feature a Titanium Stabilized Stainless Steel burner.

For propane (LP) models change suffix "BN" to "SX".

* Based on manufacturer's rated recovery efficiency.

110 VAC Required for Power Venting / 110 VAC, 60Hz., 3.1 Amperes.

C-DW2-TW50T C-DW2-TW75T	3" Vent Pipe	4" Vent Pipe
Max. Equivalent Length	†60 ft.**	†180 ft.
Min. Equivalent Length	7 ft.	15 ft.
Number of 90° Elbows	1 2 3	175 ft. 170 ft. 165 ft.

Subtract 5 ft. for each additional 90° elbow.

† For high altitude installations, consult the installation instructions.

** C-DW2-TW75 maximum 3" vent length is 50 ft.

Heat Exchanger Values*

Supply Temperature	140°F	120°F	100°F
Return Temperature	120°F	100°F	80°F
Differential	20°F	20°F	20°F
Flow Rate	2.3 GPM	3.4 GPM	4.4 GPM
Net Output	20,000 BTU/Hr.	29,000 BTU/Hr.	38,000 BTU/Hr.

* These values were obtained using 180°F stored tank temperature. Net Output is the space heating capacity based on normal piping and pickup allowance of 15%. Actual values may vary based on circulator flow rate, number of zones, water and space heating demands. Numbers subject to change.

Heat Exchanger Head Loss	
GPM	Ft. of Hd. Loss
2	0.15
5	0.94
8	2.40
10	3.75
12	5.40

Spec 547. For additional documentation visit: www.bradfordwhite.com/documentation

page 77



Residential PowerStor Series® Single-Wall Indirect Models

78/79

- Heat Exchanger—Single-wall 1½" O.D. enamel coated (Vitrage®) steel coil
- Vitrage® Lining
- Hydrojet® Total Performance System
- Water Connections—¾" NPT true dielectric fittings (SW-2-120L has 1" NPT water connection)
- 1" NPT Connection for Boiler Supply And Return
- 2" Non-CFC Foam Insulation
- Immersion Type Aquastat—Accurate temperature control
- Three Protective Aluminum Anode Rods
- T&P Relief Valve
- Low Restrictive Brass Drain Valve
- Limited Lifetime Tank and Heat Exchanger Warranty
- AHRI Certified
- Standby Heat Loss Is Less than 1/2 °F per Hour (ASHRAE 90.1b Current Standard)

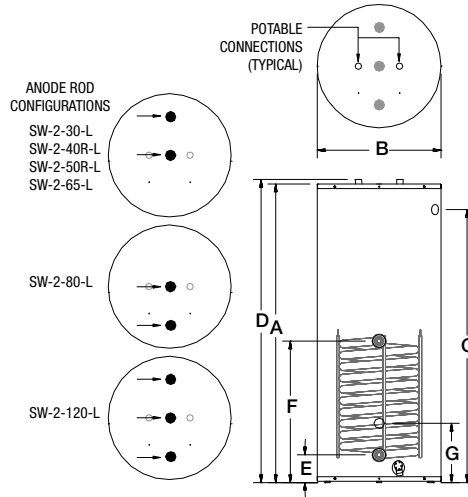

SW-2-65-L

page 78

PowerStor Series® Single-Wall Indirect Models

DIMENSIONS IN INCHES

Meet or exceed ASHRAE 90.1b (current standard)

Model Number	Capacity	A Floor to Heater Top	B Jacket Dia.	C Floor to T&P Conn.	D Floor to Water Conn.	E Floor to Exchanger Outlet	F Floor to Exchanger Inlet	G Floor to Aquastat	Approx. Shipping Weight
	U.S. Gal. Imp. Gal.	in.	in.	in.	in.	in.	in.	in.	lbs.
SW-2-30-L	29 24	33⅞	22	28⅞	34⅞	5⅞	27½	11½	164
SW-2-40R-L	37 31	41⅞	22	34⅞	41⅞	5⅞	27½	11½	185
SW-2-50R-L	43 36	46⅞	22	40⅞	47	5⅞	27½	11½	195
SW-2-65-L	57 47	59⅞	22	53⅞	60	5⅞	27½	11½	225
SW-2-80-L	71 59	59	24	52⅞	59⅞	5⅞	27½	11½	250
SW-2-120-L	110 92	62½	28⅞	55⅞	63⅞	6⅞	28½	11½	370

Heat Exchanger Head Loss	
GPM	Ft. of Hd. Loss
2	0.01
5	0.20
8	0.50
10	0.80
12	1.20

DOE Water Heater Performance

Model Number	Maximum First Hour Rating (Gal.) @ 140°F	Continuous Draw Rating (Gal./Min.) @ 115°F	Approximate Boiler Output Needed for Ratings (BTU/Hr.)
SW-2-30-L	279	4.2	220,000
SW-2-40R-L	288	4.2	220,000
SW-2-50R-L	297	4.2	220,000
SW-2-65-L	306	4.2	220,000
SW-2-80-L	321	4.2	220,000
SW-2-120-L	357	4.2	220,000

Note: Based on 200°F boiler water temperature and 50°F potable water inlet temperature.

AHRI Certified Water Heater Ratings

Model Number	First Hour Delivery @ 135°F (Gal.)	Continuous Draw Rating @ 135°F (Gal./Hr.)	Standby Heat Loss Rating (°F/Hr.)	Minimum Output Rate of Heat Source (BTU/Hr.)	Minimum Heat Source Flow Rate (Gal./Min.)
SW-2-30-L	255	235	1.2	157,000	13.7
SW-2-40R-L	260	235	1.1	157,000	13.7
SW-2-50R-L	265	235	0.9	157,000	13.7
SW-2-65-L	275	235	0.7	157,000	13.7
SW-2-80-L	295	235	0.6	157,000	13.7
SW-2-120-L	325	235	0.4	157,000	13.7

Note: These certified ratings were obtained with a heat source output rate and flow rate as specified and a 180°F boiler water supply temperature. Other results will be obtained under different conditions.

Spec 554. For additional documentation visit: www.bradfordwhite.com/documentation

page 79



Residential PowerStor2™ Series Double-Wall Indirect Models

80/81

- Heat Exchanger—Double-wall 1½" O.D. enamel coated (Vitraglas®) steel coil
- Head Loss—Up to 10 GPM flow, with less than 5 ft. of Head Loss
- Vitraglas® Lining
- Hydrojet® Total Performance System
- Water Connections—¾" NPT true dielectric fittings
- 2" Non-CFC Foam Insulation
- Surface-Mount Thermostat
- Two Protective Magnesium Anode Rods
- T&P Relief Valve
- Low Restrictive Brass Drain Valve
- Limited Lifetime Warranty on Tank and Heat Exchanger
- AHRI Certified
- Standard Heat Loss—Less than 1/2 °F per Hour (ASHRAE 90.1b Current Standard)

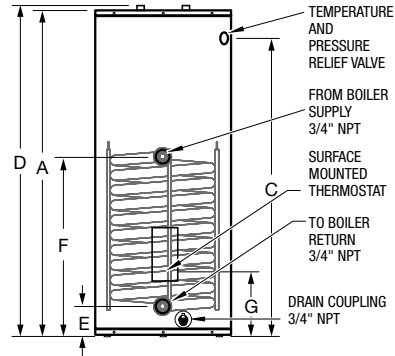
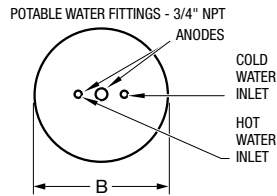

DW-2-50-L

page 80

PowerStor2™ Series Double-Wall Indirect Models

DIMENSIONS IN INCHES

Meet or exceed ASHRAE 90.1b (current standard)

Model Number	Capacity		A Floor to Heater Top in.	B Jacket Dia. in.	C Floor to T&P Conn. in.	D Floor to Water Conn. in.	E Floor to Exchanger Outlet in.	F Floor to Exchanger Inlet in.	G Floor to Thermostat in.	Approx. Shipping Weight lbs.
	U.S. Gal.	Imp. Gal.								
DW-2-40-L	37	31	41	22	34%	41%	5%	27%	11½	195
DW-2-50-L	43	36	46%	22	40%	47%	5%	27%	11½	205
DW-2-65-L	57	47	59	22	53%	60	5%	27%	11½	235
DW-2-80-L	71	59	59	24	52%	59%	5%	27%	11½	255

Heat Exchanger Head Loss	
GPM	Ft. of Hd. Loss
2	0.20
5	0.90
8	2.40
10	3.80
12	5.40

DOE Water Heater Performance

Model	Maximum First Hour Rating (Gal.) @		Continuous Draw Rating (Gal./Min.) @		Approximate Boiler Output Needed For Ratings (BTU/Hr.)
	140°F	115°F	140°F	115°F	
DW-2-40-L	116	164	1.5	2.3	80,000
DW-2-50-L	123	171	1.5	2.3	80,000
DW-2-65-L	132	180	1.5	2.3	80,000
DW-2-80-L	142	190	1.5	2.3	80,000

Note: Based on 200°F boiler water temperature and 50°F potable water inlet temperature.

AHRI Certified Water Heater Ratings

Model	First Hour Rating @ 135°F (Gal.)	Continuous Draw Rating @ 135°F (Gal./Hr.)	Standby Heat Loss Rating (°F/Hr.)	Minimum Heat Req. Rate (BTU/Hr.)	Minimum Heat Source Flow Rate (Gal./Min.)
DW-2-40-L	110	85	1.1	58,000	8.0
DW-2-50-L	120	85	0.9	58,000	8.0
DW-2-65-L	135	85	0.7	58,000	8.0
DW-2-80-L	145	85	0.6	58,000	8.0

Note: These certified ratings were obtained with a heat source output rate and flow rate as specified and a 180°F boiler water supply temperature. Other results will be obtained under different conditions.

Spec 543. For additional documentation visit: www.bradfordwhite.com/documentation

page 81



Residential PowerStor Series® SS Single-Wall Indirect Models

82/83

- Stainless Steel Heat Exchanger—Single-wall 1" O.D. stainless steel coil
- Stainless Steel Tank and Heat Exchanger—Made from Chromium Molybdenum - Titanium Ferritic 444 Stainless Steel Alloy
- Immersed Adjustable Aquastat—Fast acting immersion aquastat for automatic temperature control
- Supply and Return Connections—1" NPT female connections are located on the front for both the Boiler Supply and Boiler Return
- 2" Non-CFC Foam Insulation
- Potable Water Connections—3/4" NPT dielectric fittings extend water heater life and eases installation (1" NPT on SS-120-L)
- T&P Relief Valve
- Low Restrictive Brass Drain Valve (Excluding the SS-120-L)
- AHRI Certified

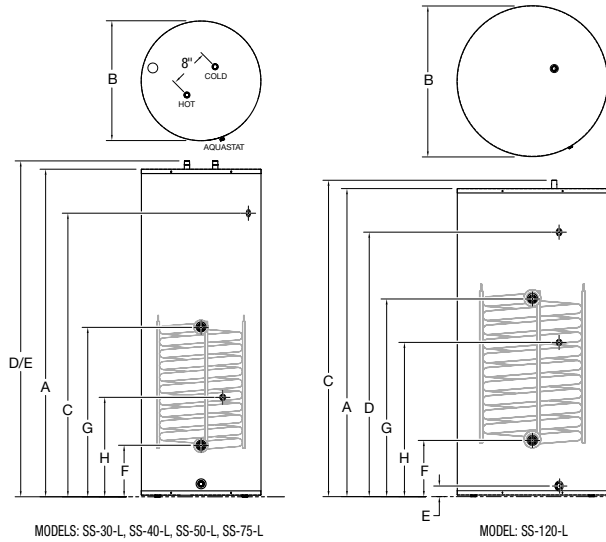

SS-50-L

page 82

PowerStor Series® SS Single-Wall Indirect Models

DIMENSIONS IN INCHES

Model Number	Nominal Gal. Capacity U.S. Gal. Imp. Gal.	A Floor to Top of Heater in.	B Jacket Dia. in.	C Floor to T&P Conn. in.	D Floor to Hot Water Conn. in.	E Floor to Cold Water Conn. in.	F Floor to Exchanger Outlet in.	G Floor to Exchanger Inlet in.	H Floor to Aquastat in.	Approx. Shipping Weight lbs.
SS-30-L	29 24	31 5/8	24	22 1/2	32 1/2	32 1/2	10	22 5/8	16 1/2	75
SS-40-L	38 31	38 1/4	24	29 1/8	38 7/8	38 7/8	10	24 3/4	18 3/4	91
SS-50-L	50 42	48	24	39 3/4	48 7/8	48 7/8	10	29 1/4	19 1/2	103
SS-75-L	73 60	65 5/8	24	56 1/2	66 1/4	66 1/4	10	33 5/8	19 1/2	142
SS-120-L	111 92	63 3/8	30 1/4	65 3/4	53 1/2	2 11/16	11 3/4	40	31 3/8	217

Heat Exchanger Head Loss					
Model	GPM	Ft. of Hd. Loss	Model	GPM	Ft. of Hd. Loss
SS-30-L & SS-40-L	2	0.2	SS-30-L & SS-40-L	8	2.8
SS-50-L		0.2	SS-50-L		3.6
SS-75-L		0.1	SS-75-L		2.1
SS-120-L		0.2	SS-120-L		3.5
SS-30-L & SS-40-L	5	1.1	SS-30-L & SS-40-L	10	4.4
SS-50-L		1.4	SS-50-L		5.6
SS-75-L		0.8	SS-75-L		3.3
SS-120-L		1.4	SS-120-L		5.5

AHRI Certified Water Heater Ratings

Model Number	First Hour Delivery Rating Gal./Hr.	Continuous Draw @135°F Gal./Hr.	Standby Heat Loss Rating °F/Hr.	Minimum Heat Required Rate BTU/Hr.	Minimum Heat Source Flow Rate Gal./Min.
SS-30-L	179	160	0.8	105,000	14.0
SS-40-L	237	209	0.6	135,000	14.0
SS-50-L	269	229	0.5	145,000	14.0
SS-75-L	367	307	0.4	193,000	14.0
SS-120-L	409	319	0.3	199,000	9.0

NOTE: These certified ratings were obtained with a heat source output and flow rate as specified and a 180°F boiler water supply temperature. Other results will be obtained under different conditions.

Spec 556. For additional documentation visit: www.bradfordwhite.com/documentation

page 83



Residential
Storage Tank Models

84/85

- Vitraglas® Lining
- Hydrojet® Total Performance System
- Water Connections—3/4" NPT true dielectric fittings (AST-120 has 1" NPT Connections)
- 2" Non-CFC Foam Insulation
- Fully Automatic Controls
- Protective Magnesium Anode Rod
- Boiler Return Is 3/4"
- Thermal Feet
- T&P Relief Valve Opening
- Brass Drain/Return Valve (3/4")

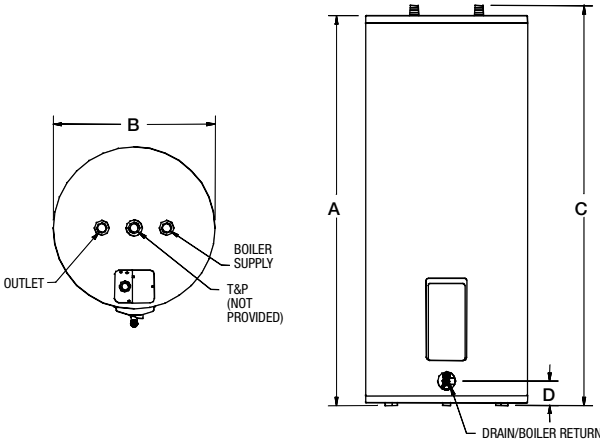

AST-50-6

Spec 609. For additional documentation visit: www.bradfordwhite.com/documentation

Storage Tank Models

DIMENSIONS IN INCHES							Meet or exceed ASHRAE 90.1b (current standard)			
Model Number	Capacity		A Floor to Heater Top	B Jacket Dia.	C Floor to Top Water Conn.	D Floor to Drain/Boiler Return	Outlet in.	Heat Source Supply in.	Heat Source Return in.	Approx. Shipping Weight
	U.S. Gal.	Imp. Gal.	in.	in.	in.	in.				lbs.
AST-40-6	40	33	46 ⁷ / ₈	20	47 ⁷ / ₈	3 ¹ / ₁₆	3/4	3/4	3/4	103
AST-50-6	50	42	46 ⁵ / ₁₆	22	47 ⁵ / ₁₆	3 ¹ / ₁₆	3/4	3/4	3/4	130
AST-80-6	80	67	58 ⁷ / ₈	24	59 ⁷ / ₈	3 ¹ / ₁₆	3/4	3/4	3/4	183
AST-120-6	119	99	62 ⁷ / ₈	28 ¹ / ₄	63 ⁷ / ₈	3 ¹ / ₁₆	1	1	3/4	305

Note: Circulator pump and temperature pressure relief valve are NOT included. We recommend you use a stainless steel or low lead circulator pump and relief valve of your choice when installing these storage tanks.

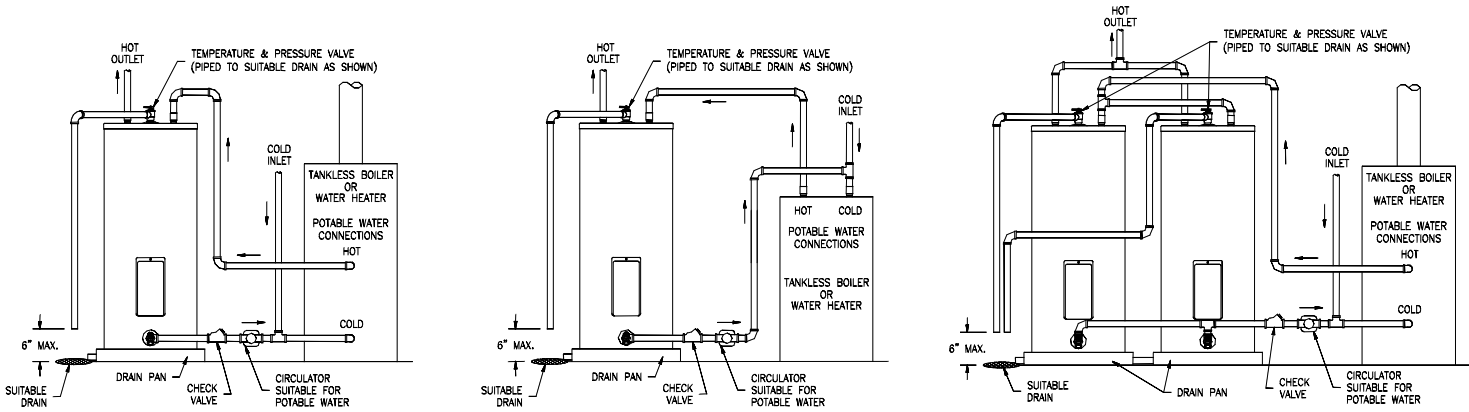

Warranty Information

	Limited Tank Warranty	Limited Parts Warranty		Limited Tank Warranty	Limited Parts Warranty
Residential Gas Models			Residential Electric Models		
Atmospheric Vent High EF Models	6 or 10 Year	6 or 10 Year**	Residential High Efficiency, Upright, Lowboy Models	6 or 10 Year	6 or 10 Year**
Atmospheric Vent Damper Models	6 or 10 Year	6 or 10 Year**	Residential Utility Models	6 or 10 Year	6 or 10 Year**
Residential High EF Models	6 or 10 Year	6 or 10 Year**	KwickShot® Tankless Electric Water Heaters	5 Year†	1 Year
Residential High Input Models	6 or 10 Year	6 or 10 Year**	Solar Models		
Residential Upright Models	6 or 10 Year	6 or 10 Year**	Residential Solar Models	6 or 10 Year	6 Year
Residential Power Vent Models	6 or 10 Year	6 or 10 Year**	Residential Hydronic/Space Heating		
Residential eF Series® Power Direct Vent Model	6 or 10 Year	6 or 10 Year**	Residential Combi1® Models	10 Year	6 Year
Residential Power Direct Vent Models	6 or 10 Year	6 or 10 Year**	Residential Combi2® Models	10 Year	6 Year
Residential Direct Vent Models	6 or 10 Year	6 or 10 Year**	Residential Indirect Models		
Residential Ultra Low NOx Models	6 or 10 Year	6 or 10 Year**	Residential PowerStor Series® Model	Limited Lifetime	6 Year
Residential eF Series® Models	6 or 10 Year	6 or 10 Year**	Residential PowerStor2™ Series Models	Limited Lifetime	6 Year
Residential Manufactured Home Models	6 or 10 Year	6 Year	Residential PowerStor Series® SS Models	Limited Lifetime	6 Year
Residential Infiniti® Series Tankless Models	15 Year*	5 Year	Residential Storage Tank		
Residential Infiniti Tankless® Models	12 Year*	5 Year	Residential AST Models	6 Year	6 Year
Residential Heat Pump Models					
Residential AeroTherm® Heat Pump Models	6 or 10 Year	6 or 10 Year**			

Coverage may vary, please contact the Bradford White Warranty Department for specific details.

Some states do not allow limitations on warranties. See copy of the Warranty included with the heater.

* Heat Exchanger Only

** 10 year parts warranty on warranty upgrade kit models only

† Heater Body Element Assembly.

Tank Type Serial Number Identification

FIRST LETTER - YEAR OF MANUFACTURE

K = 1993	S = 1998	Z = 2003	E = 2008	K = 2013
L = 1994	T = 1999	A = 2004	F = 2009	L = 2014
M = 1995	W = 2000	B = 2005	G = 2010	M = 2015
N = 1996	X = 2001	C = 2006	H = 2011	N = 2016
P = 1997	Y = 2002	D = 2007	J = 2012	

Bradford White uses a 20-year letter designation rotation in serial numbers. Therefore, please be aware that water heaters manufactured 20 years apart will have the same serial number "letter year" designation. (i.e. A = 2004 and 1984).

SECOND LETTER - MONTH OF MANUFACTURE

A = JANUARY	E = MAY	J = SEPTEMBER
B = FEBRUARY	F = JUNE	K = OCTOBER
C = MARCH	G = JULY	L = NOVEMBER
D = APRIL	H = AUGUST	M = DECEMBER

Example:

FC12345678 = MARCH, 2009 Production

NA12345678 = JANUARY, 1996 Production