

## For Residential and Commercial Applications

Job Name		Engineer / Architect	
Job Location		Wholesaler	
Submittal Date		Contractor	

## SSR19 Multi-Turn Angle Stop w/ Lock Shield Screwdriver Slot – Sweat x Compression

**Use:** For use in potable water distribution systems. Not intended for recirculating water systems that produce continuous use temperatures above 115° F. For those applications, use our KT™ series ball stops.

### Design Features:

- **Machined one-piece brass body** provides strength, durability, and long-lasting performance
-  **No Lead**

### Operating Specifications:

**Temperature:** 40° - 140° F

**Pressure:** 125 PSI maximum

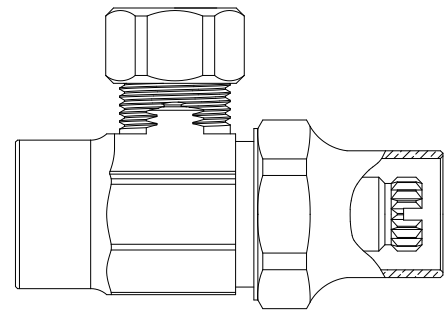

### Standard Product

STOP MATERIAL SPECIFICATIONS	
<b>Body</b>	Brass or brass, chrome plated
<b>Screwdriver Slot Stem</b>	Brass or brass, chrome plated
<b>Bib &amp; Packing Washer</b>	Rubber
<b>Lock Shield</b>	Brass or brass, chrome plated
<b>Compression Nut</b>	Brass or brass, chrome plated
<b>Compression Sleeve</b>	Brass

### No-Lead Product

STOP MATERIAL SPECIFICATIONS	
<b>Body</b>	No-Lead brass or No-Lead brass, chrome plated
<b>Screwdriver Slot Stem</b>	No-Lead brass or No-Lead brass, chrome plated
<b>Bib &amp; Packing Washer</b>	Rubber
<b>Lock Shield</b>	No-Lead brass or No-Lead brass, chrome plated
<b>Compression Nut</b>	No-Lead brass or No-Lead brass, chrome plated
<b>Compression Sleeve</b>	Brass

### Standard Part Listing:

- ☐ SSR19 C 1/2" sweat x 3/8" OD compression with lock shield, screwdriver slot, chrome plated, tray
- ☐ SSR19 C. 1/2" sweat x 3/8" OD compression with lock shield, screwdriver slot, chrome plated, tray
- ☐ SSR19 CBT. 1/2" sweat x 3/8" OD compression with lock shield, screwdriver slot, chrome plated, bulk
- ☐ SSR19 R. 1/2" sweat x 3/8" OD compression with lock shield, screwdriver slot, rough brass, tray

### No-Lead Part Listing:

- ☐ SSR19X C 1/2" sweat x 3/8" OD compression with lock shield, screwdriver slot, chrome plated, tray

*This specification and all information contained herein is the confidential and exclusive property of BrassCraft Manufacturing, and shall not be disclosed to others without the written consent of BrassCraft Mfg. This specification must be returned to BrassCraft Mfg. if requested.*

**BrassCraft®**

# SSR19 Multi-Turn Angle Stop w/ Lock Shield Screwdriver Slot – Sweat x Compression

PART DIMENSIONS (Inches)		
Model	DIM. A	DIM. B
SSR19	1.04	2.16

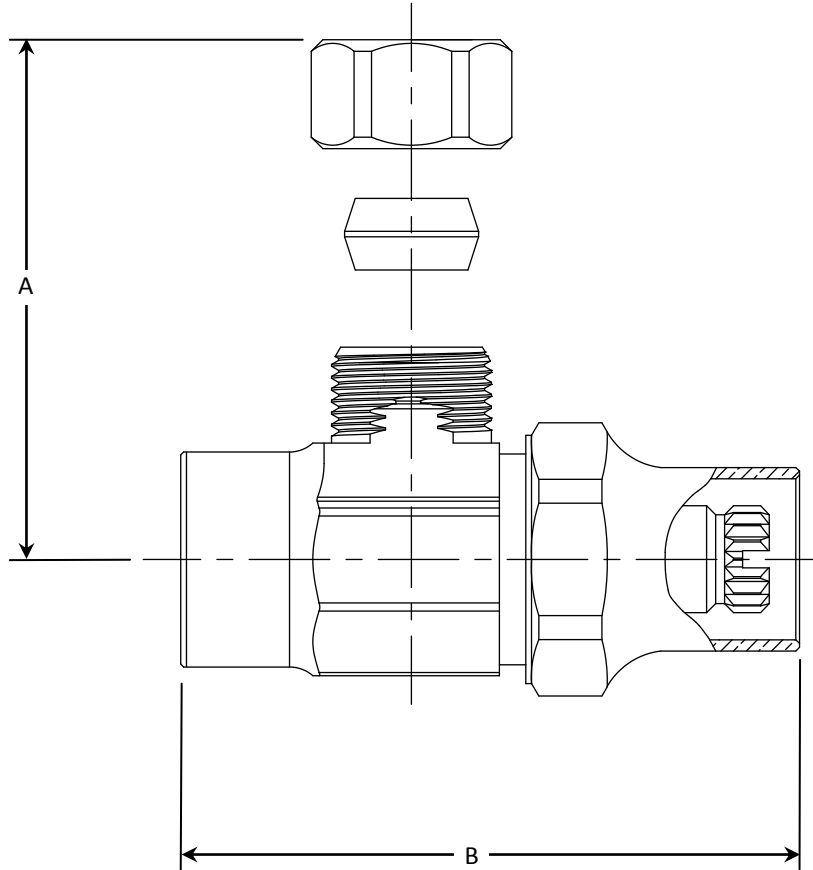

## Listings & Certifications:

- IAPMO listed to ASME A112.18.1 / CSA B125.1 (File # 0645)
- CSA listed to ASME A112.18.1 / CSA B125.1 (File # 204593)
- No-Lead product CSA listed to Low Lead Content Certification Program – Plumbing Products Class 6853-01



This specification and all information contained herein is the confidential and exclusive property of BrassCraft Manufacturing, and shall not be disclosed to others without the written consent of BrassCraft Mfg. This specification must be returned to BrassCraft Mfg. if requested.

400.329 SSR19 Multi-Turn Angle Stop w/ Lock Shield - Sweat x Compr REV 12/13

**BrassCraft**

© 2013 BrassCraft Mfg.