

PROJECT:	_____	UNIT TAG:	_____	QUANTITY:	_____
REPRESENTATIVE:	_____	TYPE OF SERVICE:	_____	DATE:	_____
ENGINEER:	_____	SUBMITTED BY:	_____	DATE:	_____
CONTRACTOR:	_____	APPROVED BY:	_____	DATE:	_____
	_____	ORDER NO.:	_____	DATE:	_____

UPS 50-60 SF

Circulator pumps



Product photo could vary from the actual product

Conditions of Service	Pump Data	Motor Data
Flow: _____	Maximum operating pressure: 145 psi	Max. power input: 395 W
Head: _____	Liquid temperature range: 32 .. 230 °F	Rated power - P2: 0.33 HP
Efficiency: _____	Maximum ambient temperature: 104 °F	Rated voltage: 115 V
Liquid: Water	Approvals: ETL, CSA	Main frequency: 60 Hz
Temperature: 140 °F	Type of connection: S.S. Flange	Insulation class: H
NPSH required: ft	Flange standard: USA Oval	Motor protection: CONTACT
Viscosity: _____	Pipe connection: 4 - Bolt Flange	Thermal protection: internal
Specific Gravity: 0.985	Product number: 97523136	

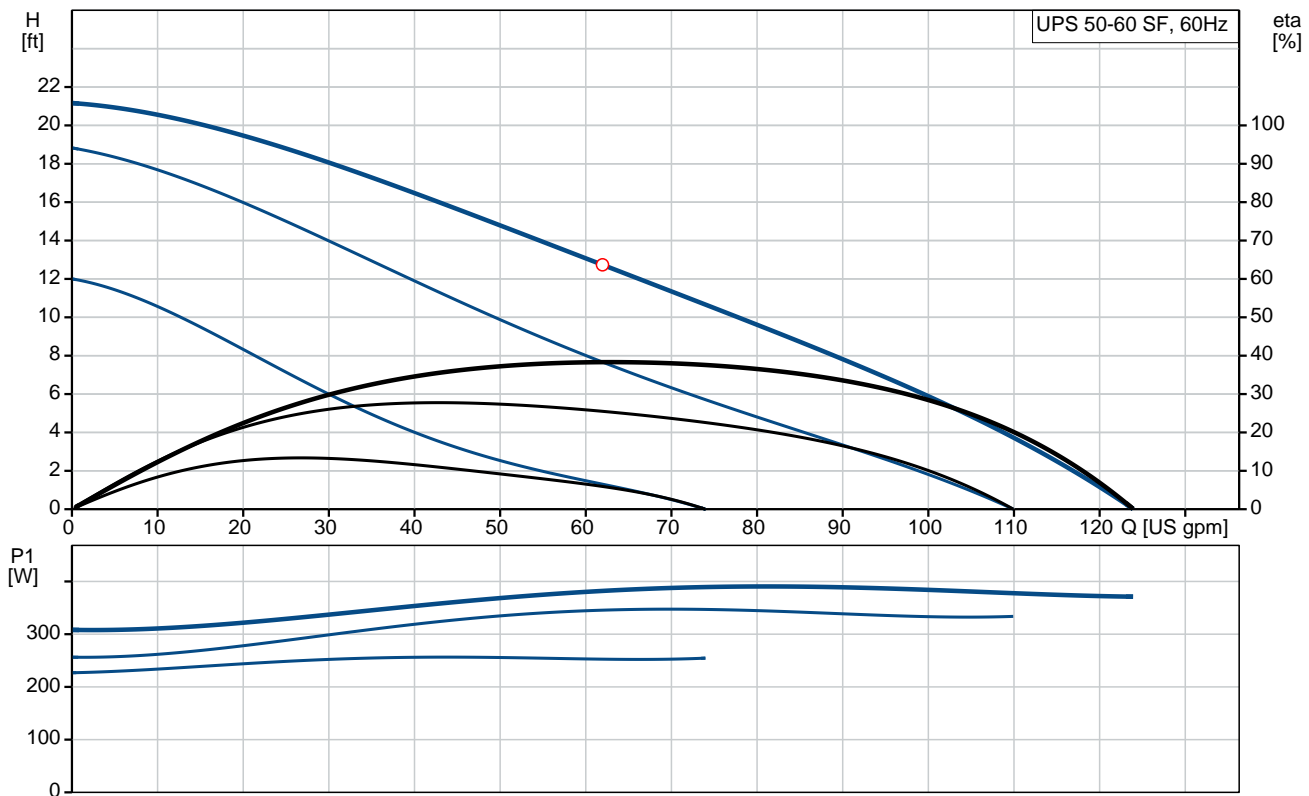

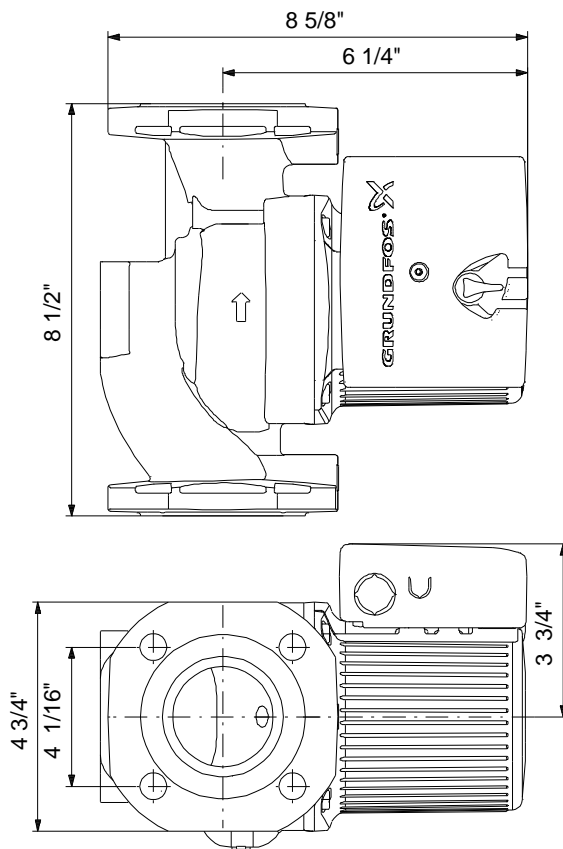

Materials:

Pump housing: Stainless steel
DIN W.-Nr. 1.4301

Impeller: Composite, PES

Tender Text



Product photo could vary from the actual product

Product No.: [97523136](#)

UPS 50-60 SF

The pump is of the canned rotor type, i.e. pump and motor form an integral unit without shaft seal and with only two gaskets for sealing. The bearings are lubricated by the pumped liquid.

The pump is characterized by:

- * Ceramic shaft and radial bearings.
- * Carbon axial bearing.
- * Stainless steel rotor can and bearing plate.
- * Corrosion-resistant impeller, Composite, PES.
- * Stainless steel pump housing.

The motor is a 1-phase motor.

No additional motor protection is required.

Liquid:

Pumped liquid: Water
Liquid temperature range: 32 .. 230 °F
Liquid temperature during operation: 140 °F
Density: 61.35 lb/ft³

Technical:

Approvals on nameplate: ETL, CSA

Materials:

Pump housing: Stainless steel
DIN W.-Nr. 1.4301
Impeller: Composite, PES

Installation:

Maximum ambient temperature: 104 °F
Ambient max at 176°F liquid: 176 °F
Maximum operating pressure: 145 psi
Flange standard: USA Oval
Type of connection: S.S. Flange
Pipe connection: 4 - Bolt Flange
Pressure stage: 10
Port-to-port length: 8 1/2 in

Electrical data:

Power input in speed 1: 260 W
Power input in speed 2: 350 W



Company name:

Created by:

Phone:

Date:

2/21/2018

Max. power input:	395 W
Rated power - P2:	0.33 HP
Main frequency:	60 Hz
Rated voltage:	1 x 115 V
Current in speed 1:	2.7 A
Current in speed 2:	3.4 A
Current in speed 3:	3.6 A
Capacitor size - run:	40 μ F/180 V
Number of poles:	2
Insulation class (IEC 85):	H

Others:

Gross weight:	20.1 lb
---------------	---------

Position	Count	Description
	1	<p>UPS 50-60 SF</p>  <p>Product photo could vary from the actual product</p> <p>Product No.: 97523136</p> <p>The pump is of the canned rotor type, i.e. pump and motor form an integral unit without shaft seal and with only two gaskets for sealing. The bearings are lubricated by the pumped liquid. The pump is characterized by:</p> <ul style="list-style-type: none"> * Ceramic shaft and radial bearings. * Carbon axial bearing. * Stainless steel rotor can and bearing plate. * Corrosion-resistant impeller, Composite, PES. * Stainless steel pump housing. <p>The motor is a 1-phase motor. No additional motor protection is required.</p> <p>Liquid: Pumped liquid: Water Liquid temperature range: 32 .. 230 °F Liquid temperature during operation: 140 °F Density: 61.35 lb/ft³</p> <p>Technical: Approvals on nameplate: ETL, CSA</p> <p>Materials: Pump housing: Stainless steel DIN W.-Nr. 1.4301 Impeller: Composite, PES</p> <p>Installation: Maximum ambient temperature: 104 °F Ambient max at 176°F liquid: 176 °F Maximum operating pressure: 145 psi Flange standard: USA Oval Type of connection: S.S. Flange Pipe connection: 4 - Bolt Flange Pressure stage: 10 Port-to-port length: 8 1/2 in</p> <p>Electrical data: Power input in speed 1: 260 W Power input in speed 2: 350 W Max. power input: 395 W Rated power - P2: 0.33 HP</p>



Company name:

Created by:

Phone:

Date:

2/21/2018

Position	Count	Description
		Main frequency: 60 Hz Rated voltage: 1 x 115 V Current in speed 1: 2.7 A Current in speed 2: 3.4 A Current in speed 3: 3.6 A Capacitor size - run: 40 µF/180 V Number of poles: 2 Insulation class (IEC 85): H Others: Gross weight: 20.1 lb

97523136 UPS 50-60 SF 60 Hz

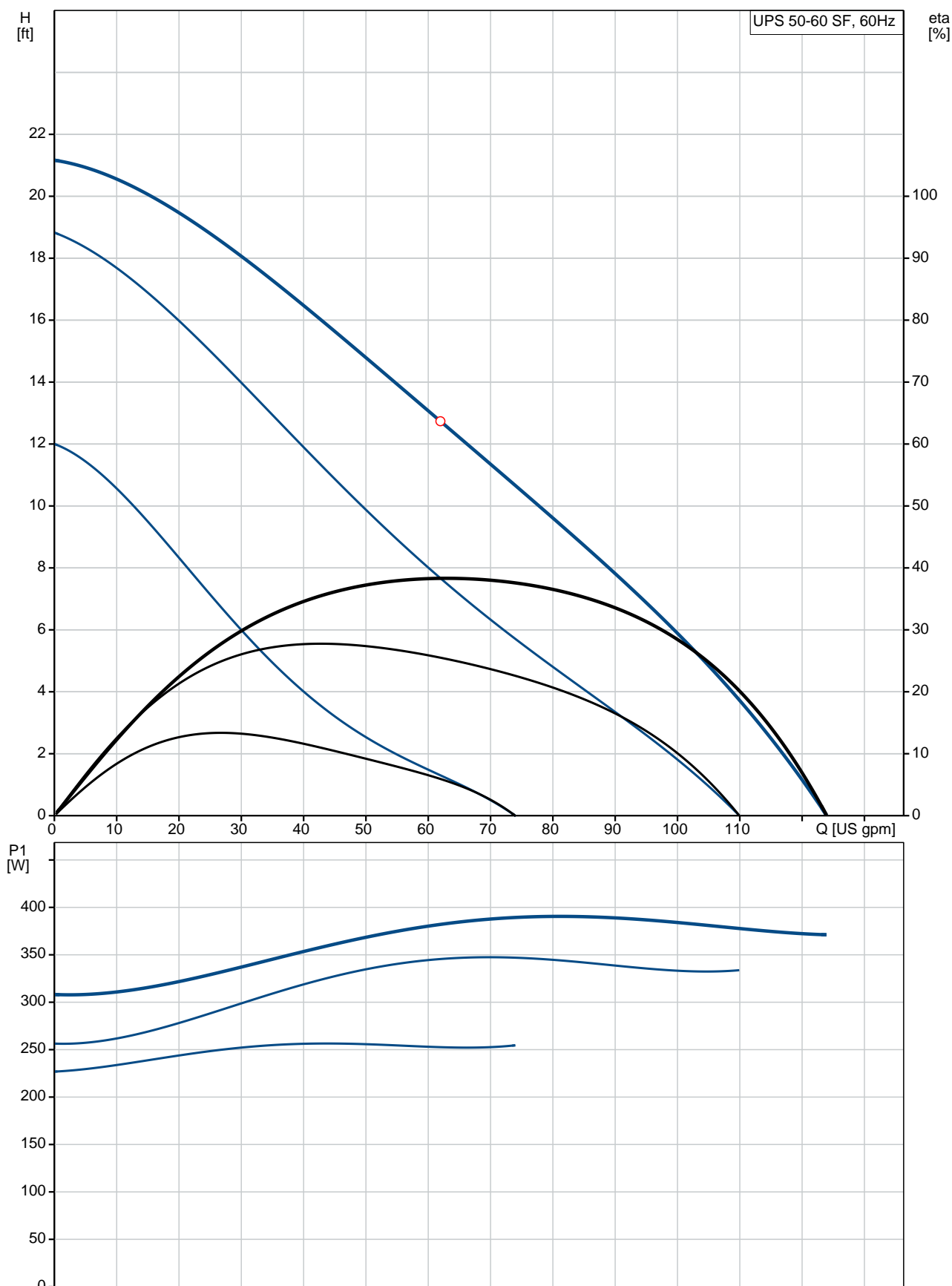

Description	Value
General information:	
Product name:	UPS 50-60 SF
Product No.:	97523136
EAN:	5700317647510
Technical:	
Speed Number:	3
Max flow:	124 US gpm
Head max:	21.33 ft
Approvals on nameplate:	ETL, CSA
Materials:	
Pump housing:	Stainless steel
	DIN W.-Nr. 1.4301
Impeller:	Composite, PES
Installation:	
Maximum ambient temperature:	104 °F
Ambient max at 176°F liquid:	176 °F
Maximum operating pressure:	145 psi
Flange standard:	USA Oval
Type of connection:	S.S. Flange
Pipe connection:	4 - Bolt Flange
Pressure stage:	10
Port-to-port length:	8 1/2 in
Liquid:	
Pumped liquid:	Water
Liquid temperature range:	32 .. 230 °F
Liquid temperature during operation:	140 °F
Density:	61.35 lb/ft³
Electrical data:	
Power input in speed 1:	260 W
Power input in speed 2:	350 W
Max. power input:	395 W
Rated power - P2:	0.33 HP
Main frequency:	60 Hz
Rated voltage:	1 x 115 V
Current in speed 1:	2.7 A
Current in speed 2:	3.4 A
Current in speed 3:	3.6 A
Capacitor size - run:	40 µF/180 V
Number of poles:	2
Insulation class (IEC 85):	H
Motor protection:	CONTACT
Thermal protec:	internal
Controls:	
Pos term box:	9H
Others:	
Gross weight:	20.1 lb

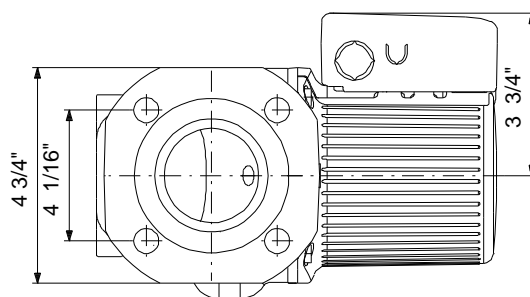
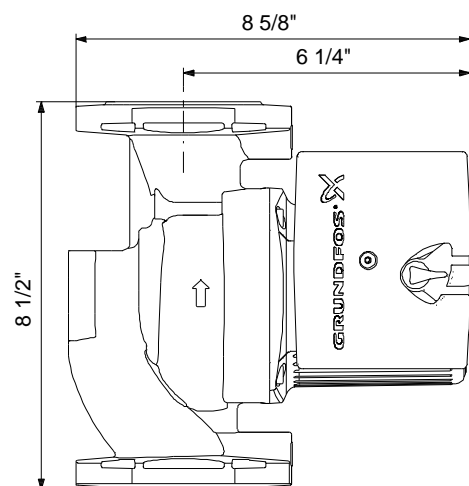
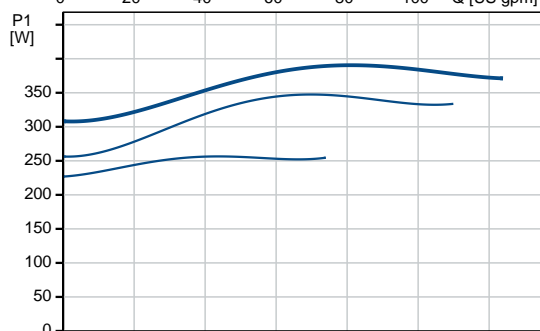
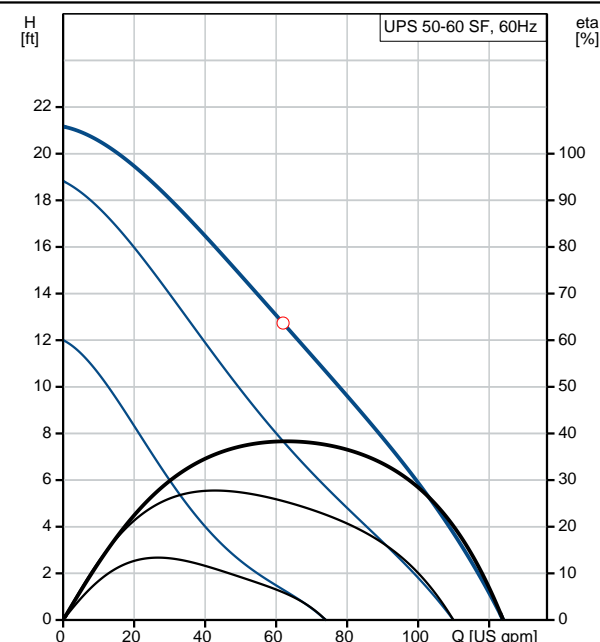

97523136 UPS 50-60 SF 60 Hz

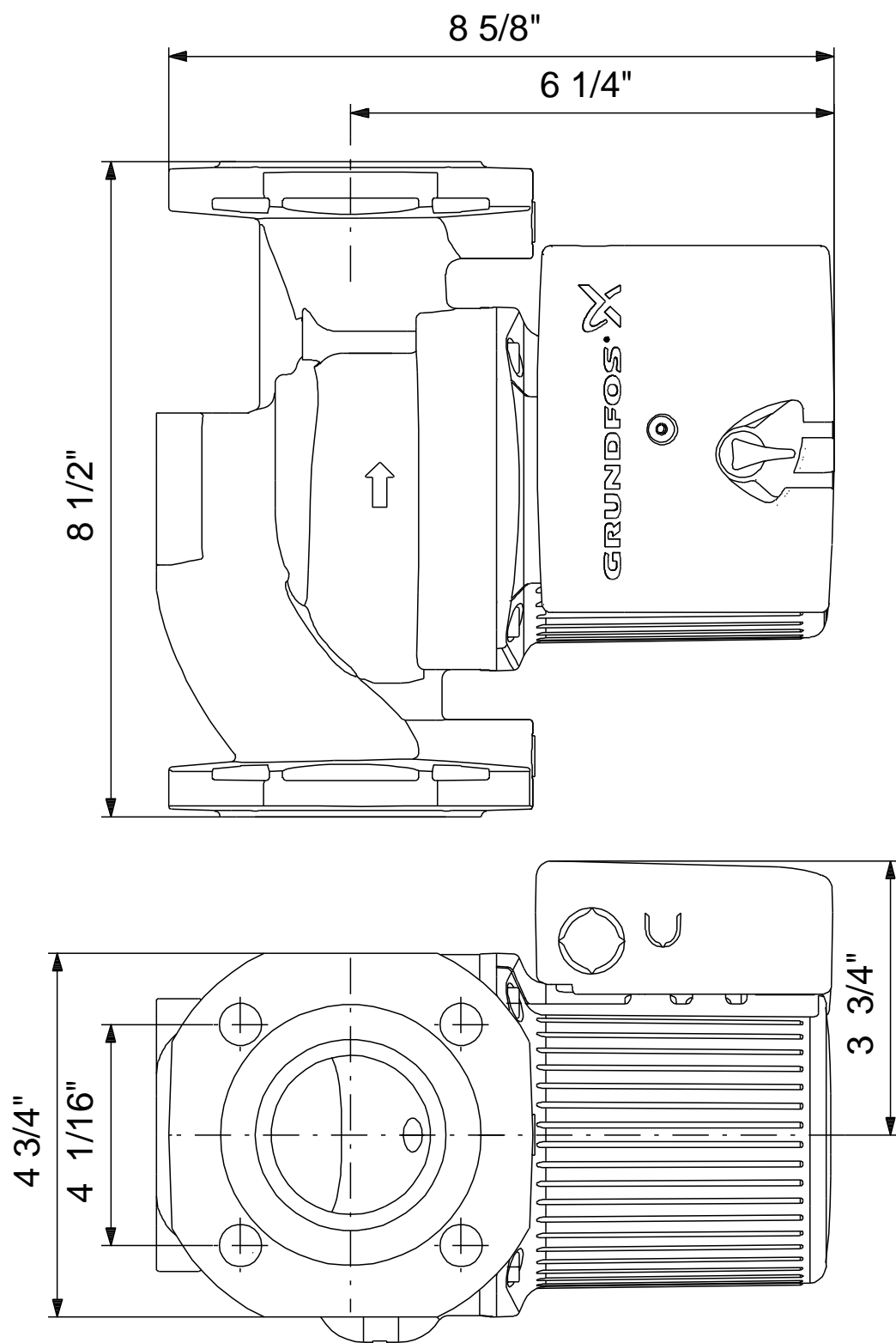

Note! All units are in [mm] unless otherwise stated.
Disclaimer: This simplified dimensional drawing does not show all details.



Company name:

Created by:

Phone:

Date:

2/21/2018

Order Data:

Product name: UPS 50-60 SF

Amount: 1

Product No.: 97523136

Total: Price on request
