

Job or Customer :	
Location :	
Engineer :	
<input type="checkbox"/> Complies with Spec <input type="checkbox"/> Alternate	Notes :
Contractor :	
HeatLink Rep :	
Submitted By :	Date :
Approved By :	Date :
P.O. Number :	Date :

Description

Three-way mixing valve for fluid temperature control in heating and cooling systems. Used with HeatLink actuators or thermostatic heads, the valve is normally closed.

Technical Data

Material - Housing: Bronze
 Material - Spindle:..... Stainless steel
 Spindle Sealing:..... 2 o-rings
 Material - Nipples:..... Brass
 Max. Operating Temperature:..... 100°C / 212°F
 Max. Operating Pressure:..... 10 bar / 145 psi

Standards / Listings

n/a

Qty	Stk. #	A, B, AB	Dimension			Cv	Kvs	Weight
	63716	1/2" Female Sweat	4" (100 mm)	1" (26 mm)	1-3/4" (44.5 mm)	2.9	2.5	1.1 lb 0.5 kg
	63720	3/4" Female Sweat	4-5/8" (117 mm)	1-1/4" (31.5 mm)	2-1/4" (117 mm)	4.1	3.5	1.5 lb 0.7 kg
	63725	1" Female Sweat	5-1/2" (138 mm)	1-3/8" (33.5 mm)	4-3/8" (111 mm)	5.3	4.6	2.5 lb 1.15 kg
	63732	1-1/4" Female Sweat	6" (153 mm)	1-3/8" (33.5 mm)	4-3/4" (121 mm)	7.4	6.4	3.4 lb 1.55 kg

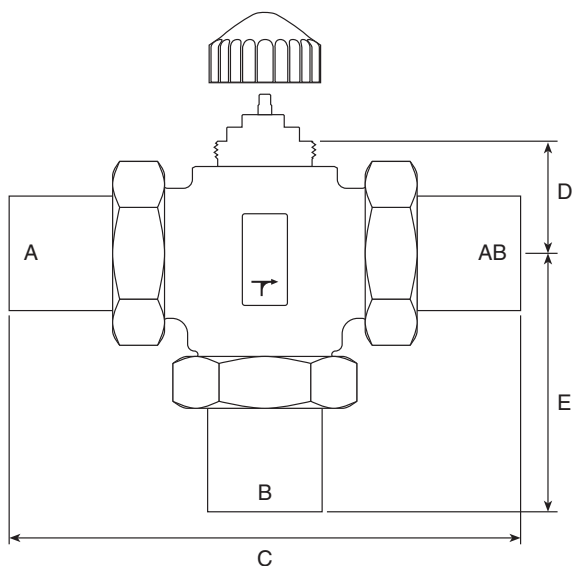

Valve closed:	Valve open:
A-AB is open	A-AB is closed
B-AB is closed	B-AB is open

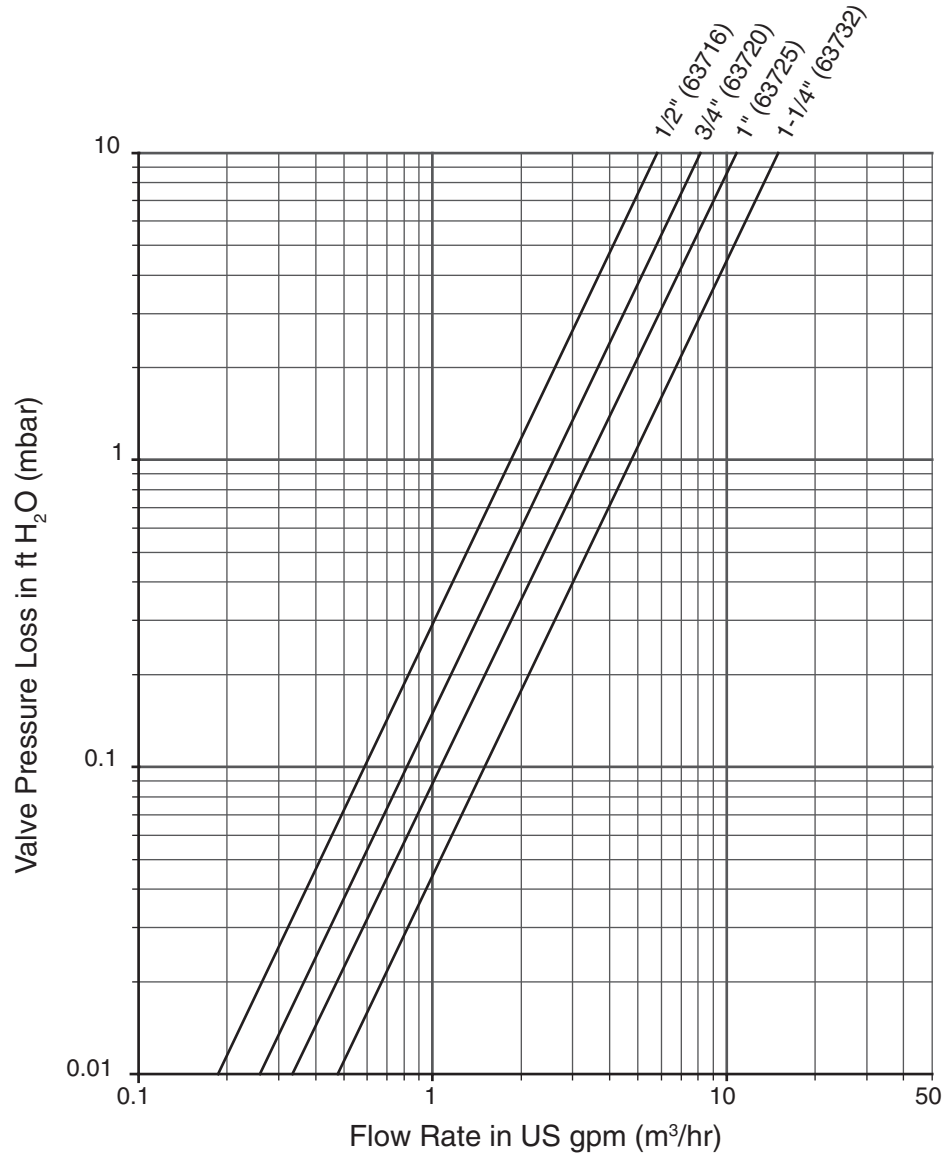

Installation

Installation must follow all of HeatLink's instructions and guidelines, including those in the installation instructions.

Related Documents

- Compact Mixing Valve Installation Instructions (L663700)
- Component Warranty