

# Tandem 5454

Model number:	100875
---------------	--------

Dimensions:	54" x 54" x 18"	Installation:	Corner	Material:	Acrylic
-------------	-----------------	---------------	--------	-----------	---------



### Standard Features:

- Corner shape bathtub
- Drop-in installation or with or without integrated tiling flange
- Textured floor with integrated seat
- Center drain
- Skirt available

### Product characteristics:

- Comfortable backrest
- Textured Floor
- Therapy System Available

### Warranty:

25 Years

### Standard colors:

White (001)

Bone (004)

Biscuit (007)

### Certifications

MAAX products adhere to one or more of the following certifications:



### Options (Visit our website for a complete list of our options)

No	Description
<input type="checkbox"/> OPT 10004	Nailing flange
<input type="checkbox"/> OPT 10053	Chromatherapy
<input type="checkbox"/> OPT 10095	Water heater assembly
<input type="checkbox"/> OPT 10106	Metal trim kit for whirlpool and combined systems
<input type="checkbox"/> OPT 10113	One 6-in. acrylic grab bar

# Tandem 5454

Model number:

100875

Dimensions: 54" x 54" x 18"

Installation: Corner

Material: Acrylic

## Dimensions:

54 1/8 x 54 1/8 x 18 1/4 in.  
(1375 x 1375 x 464 mm)

## Weight:

78 lbs -

## Drain location:

Without tiling flange, Center

With tiling flange, Center

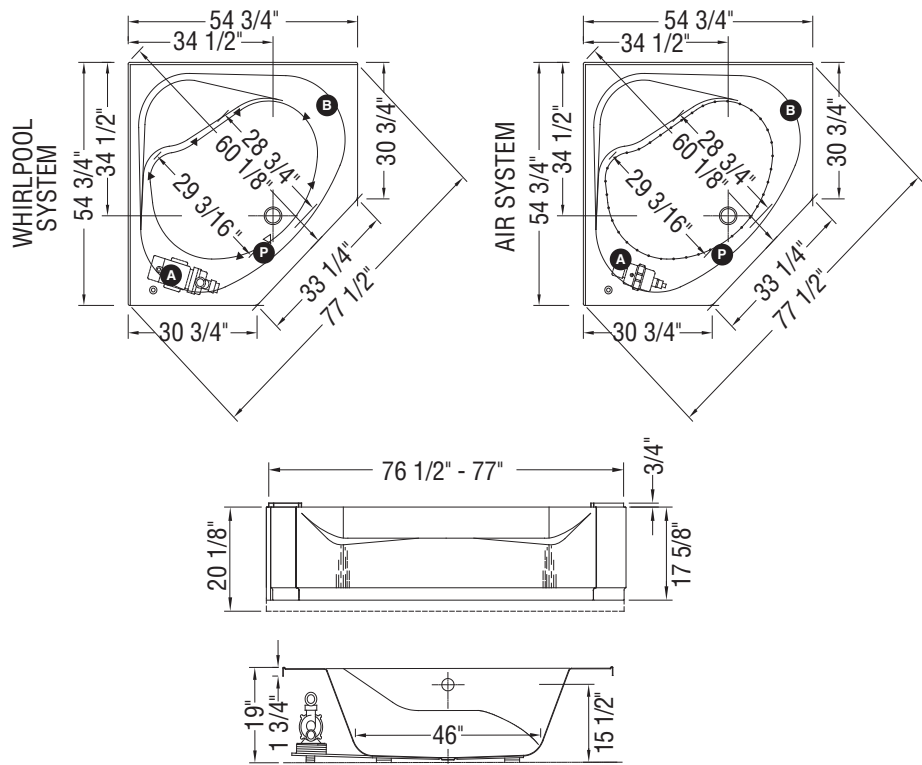

- (A) : Standard blower and/or pump location
- (B) : Optional blower and/or pump location
- (P) : Indicates optional grab bar positioning
- (▲) : Indicates Whirlpool jets positioning
- (●) : Indicates airjets positioning
- (△) : Indicates suction positioning

All dimensions are approximate. Structure measurements must be verified against the unit to ensure proper fit.

Project:

Contractor:

Representative:

Date:

Tel:

Notes: