

# MAAX SUBMITTAL SPECIFICATIONS

## KDS 3232

**MODEL NUMBER 145018**

DIMENSIONS: 32" x 32" x 76" Fiberglass



Project : .....  
Contractor : .....  
MAAX Representative : ..... Tel : .....  
Date : .....

**www.maax.com**

Vivez l'expérience  
**MAAX®**  
Enjoy the experience

### STANDARD FEATURES

- Product available with or without Above-the-Floor Rough
- 4-piece shower with low threshold base
- Large top corner shelves, convenient footrests and acrylic handle
- Center drain
- Unique feature: pin system for easy front installation
- All grab bars can support up to 300 lbs

### OPTIONS

- 18" Modern straight grab bar
- 24" Modern straight grab bar
- Wall reinforcement (one wall)
- One 12-in. handle with metallic finish

### UNIQUE FEATURES

- PIN system

### SYSTEMS

- None

### DOOR SELECTION

Combine with MAAX's complete shower door offering visit [www.maax.com](http://www.maax.com)

### CERTIFICATIONS

Maax products adhere to one or more of the following certifications:



2017-11-10

## MAAX SUBMITTAL SPECIFICATIONS

# KDS 3232

MODEL NUMBER 145018

## TECHNICAL DRAWINGS

### STANDARD

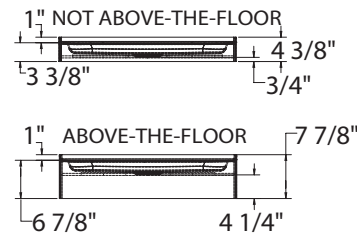
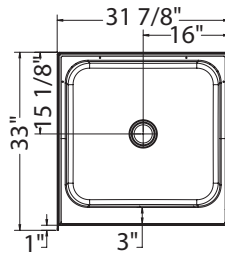
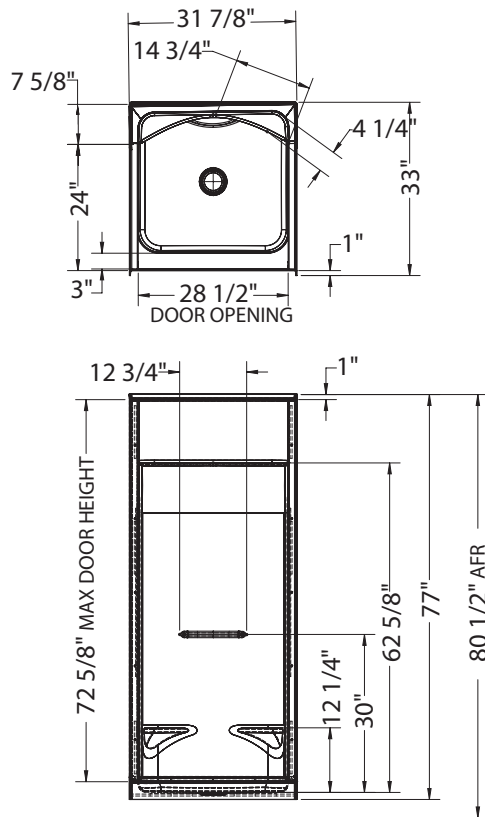

### REINFORCEMENT BACKING

OPTION 20198 SHOWN  
 OPTION 20197 SYMMETRICAL

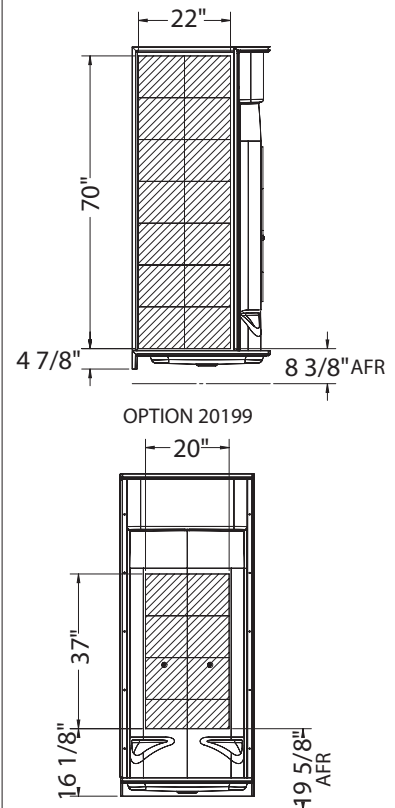

### GRAB BARS

OPTION 20203

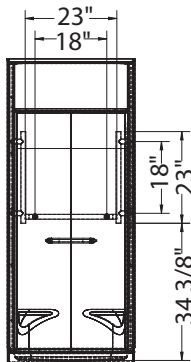

OPTION 20204

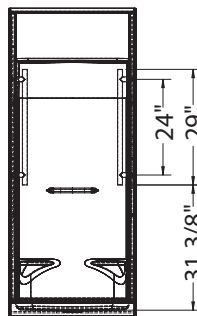

OPTION  
 20203-20204

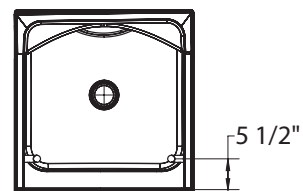

All dimensions are approximate. Structure measurements must be verified against the unit to ensure proper fit.