

# MAAX SUBMITTAL SPECIFICATIONS

## KDS 3060

**MODEL NUMBER 145036**

DIMENSIONS: 60" x 30" x 80" Fiberglass



Project : .....  
Contractor : .....  
MAAX Representative : ..... Tel : .....  
Date : .....

**www.maax.com**

Vivez l'expérience  
**MAAX®**  
Enjoy the experience

### STANDARD FEATURES

- Product available with or without Above-the-floor rough
- 4-piece shower with threshold base
- Large top corner shelves, wide soap dish and acrylic handle
- Right seat, left seat or no seat configuration
- Unique feature: pin system for easy front installation
- All grab bars can support up to 300 lbs

### OPTIONS

- 18" Modern straight grab bar
- 24" Modern straight grab bar
- Wall reinforcement (one wall)
- One 12-in. handle with metallic finish

### UNIQUE FEATURES

- PIN system

### SYSTEMS

- None

### DOOR SELECTION

Combine with MAAX's complete shower door offering visit [www.maax.com](http://www.maax.com)

### CERTIFICATIONS

Maax products adhere to one or more of the following certifications:



2017-11-10

## MAAX SUBMITTAL SPECIFICATIONS

# KDS 3060

MODEL NUMBER 145036

## TECHNICAL DRAWINGS

### STANDARD

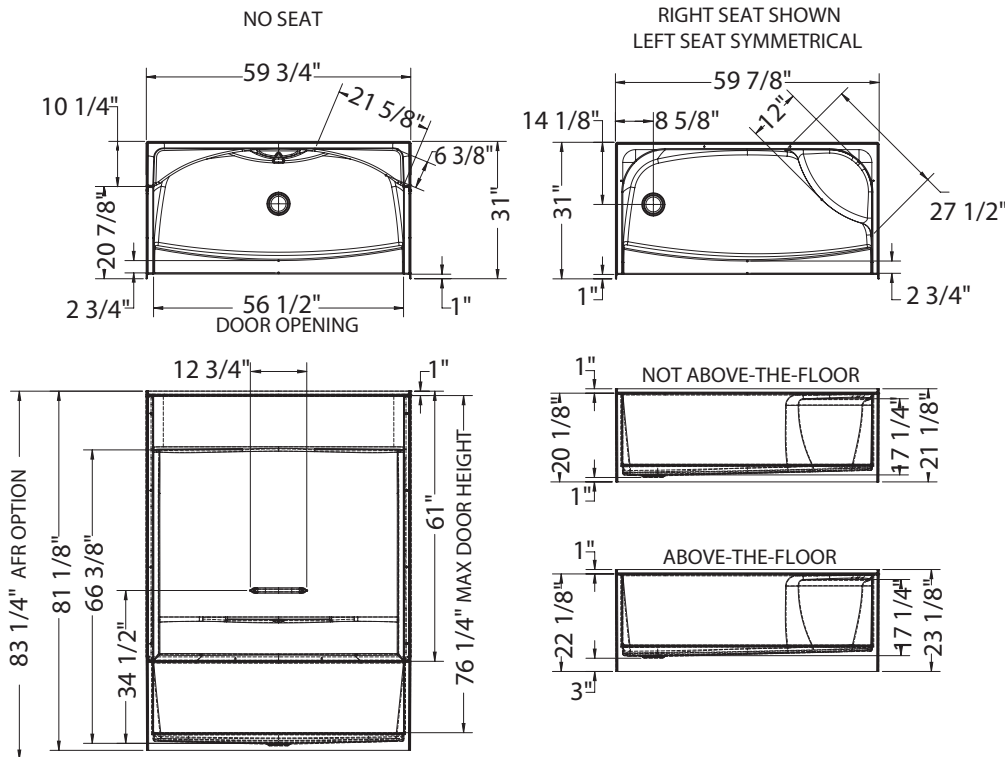

### REINFORCEMENT BACKING

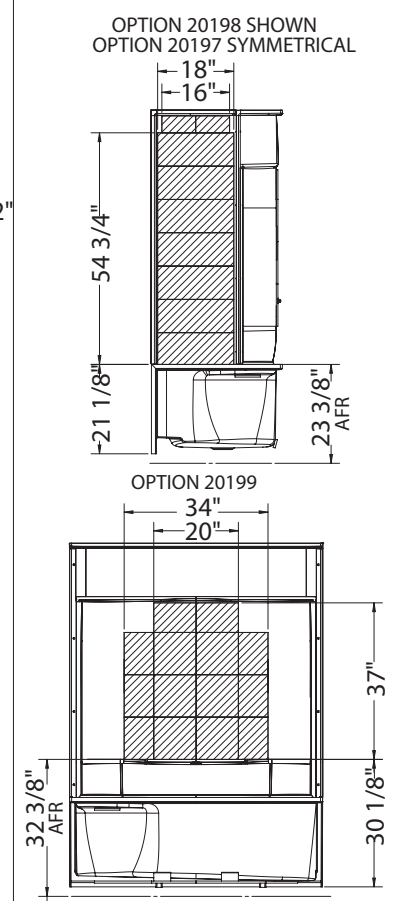

### GRAB BARS

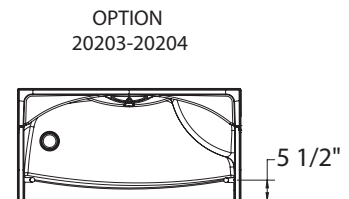
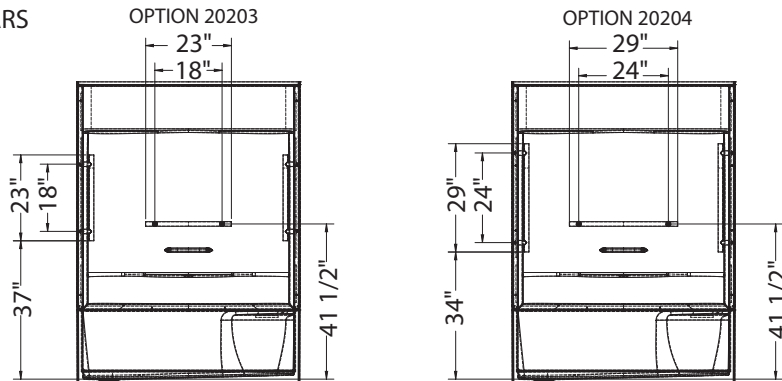

All dimensions are approximate. Structure measurements must be verified against the unit to ensure proper fit.