

# MAAX SUBMITTAL SPECIFICATIONS

## SPS 3060

**MODEL NUMBER 145038**

DIMENSIONS: 60" x 30" x 20" Fiberglass



Project : .....  
Contractor : .....  
MAAX Representative : ..... Tel : .....  
Date : .....

**www.maax.com**

Vivez l'expérience  
**MAAX®**  
Enjoy the experience

### STANDARD FEATURES

- Rectangular shower base
- Integrated tiling flange
- Right or left integrated seat
- Available with Above-the-Floor Rough (AFR)
- Textured floor
- Right, Left or Center drain

### OPTIONS

- Tile Adaptor (for door installation)

### UNIQUE FEATURES

- Tiling Flange

### SYSTEMS

- None

### DOOR SELECTION

Combine with MAAX's complete shower door offering visit [www.maax.com](http://www.maax.com)

### CERTIFICATIONS

Maax products adhere to one or more of the following certifications:



2017-11-09

## MAAX SUBMITTAL SPECIFICATIONS

# SPS 3060

MODEL NUMBER 145038

## TECHNICAL DRAWINGS

RIGHT SEAT SHOWN  
LEFT SEAT SYMMETRICAL

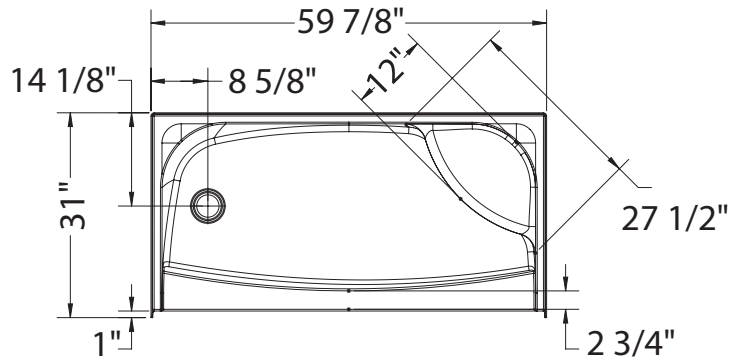

NOT ABOVE-THE-FLOOR

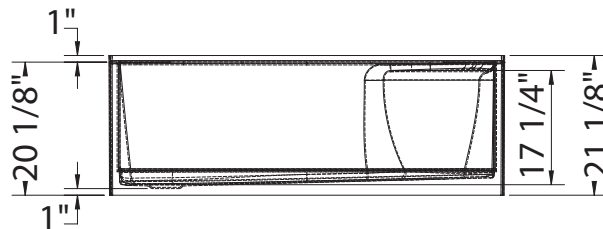

ABOVE-THE-FLOOR

