

B3Round 4832

Model number:	410001
---------------	--------

Dimensions:	48" x 32" x 4"	Installation:	Material:	Acrylic
-------------	----------------	---------------	-----------	---------



Standard Features:

- Acrylic rectangular base with round drain
- Smooth floor
- Center drain
- Certain configurations available with Stabili-T anti-slip bottom meeting ADA, ANSI or CSA standards
- Drain not included
- 3" threshold base

Product characteristics:

- Made in North America
- Utile Compatible
- Bestseller

Warranty:

25 Years

Standard colors:

White (001)

Bone (004)

Biscuit (007)

Certifications

MAAX products adhere to one or more of the following certifications:

UL

ICC
ES
PMG

Recommended products (Visit our website for a complete list of our recommended products)

No	Description
138996	Halo Sliding Shower Door 44 1/2-47 x 78 3/4 in. 8 mm
138997	Halo Sliding Shower Door 56 1/2-59 x 78 3/4 in. 8 mm
138998	Halo Return Panel for 32 in. Base

B3Round 4832

Model number:

410001

Dimensions: 48" x 32" x 4"

Installation:

Material: Acrylic

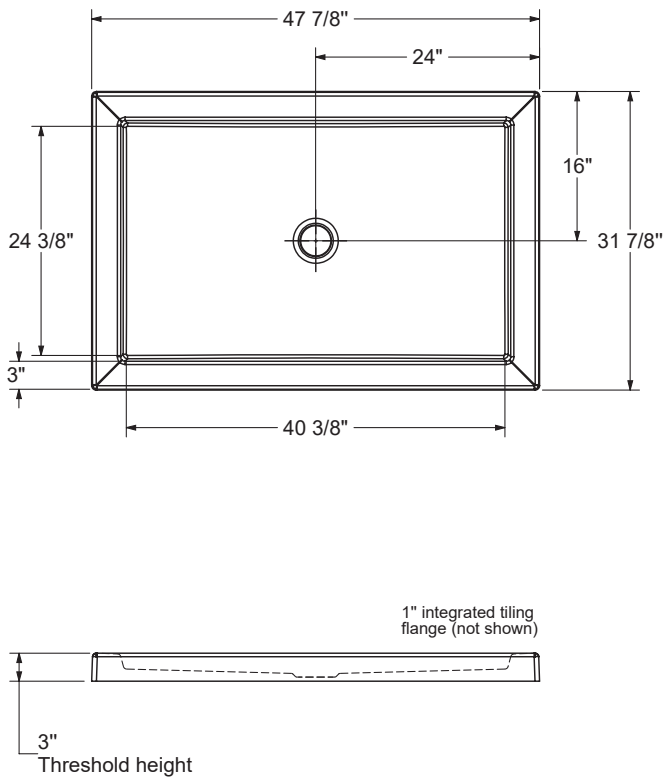

Dimensions:
47 7/8 x 31 7/8 x 4 in. (1216 x 810 x 102 mm)
Weight:
41 lbs (18.59 kg)
Shape:
Rectangular
Drain location:
Center
Installation:
Alcove
Corner Left
Corner Right
Alcove Deep
Wall Mounted
Tunnel
Alcove - Stabili-T

This technical drawing is universal for every 4832 configuration.

Integrated tiling flange : 1" height x 1/4" thick (not shown)
Tiling flange position is determined by chosen configuration.

All dimensions are approximate. Structure measurements must be verified against the unit to ensure proper fit.

Project:

Contractor:

Representative:

Date:

Tel:

Notes: