

Core & Coil (71A) MH 175W - 450W

**CORE & COIL HID MH BAL 320W M132/154
120/277/347V C&C**

The basic ballast is the open core and coil which is most often used as a component within a lighting luminaire. The core and coil also forms the nucleus of Philips Advance's five other ballast configurations.

Product data

General Information	
ANSI Code	M132-M154
Lamp Type	320W MH
Number of Lamps	1 piece/unit
Circuit Type	SUPER-CWA
Ballast Type	Magnetic HID
Base Model	71A58A2A
Core Size	4 1/4 x 4 3/4 (2 coil)
Suitable For Outdoor Use	Yes
Ignitor Catalog Number	LI533-H4
Ignitor Temperature Rating	105°C
Capacitor Value	21 MFD
Capacitor Catalog Number	7C210P40R
Capacitor Requirements	400V
Capacitor Temperature Rating	105°C
Capacitor Diameter/Oval Dimensions	1.75 in
Capacitor Height	4.80 in
Automatic Restart	No

Operating and Electrical	
Input Voltage	120/277/347 V
Input Frequency	60 Hz
Inp. Current (Open Circuit)	2.6/1.1/0.9 A
Input Current (Starting)	2.2/0.95/0.7 A
Input Current (Short Circuit)	1.6-2.55/0.7-1.1/0.55-0.85 A
Secondary Short Circuit Current	2.9-3.6 A
Constant Wattage Deviation	10%
Ballast Factor (Nom)	1
Power Factor (Nom)	0.90
Nominal Open Circuit Voltage	280 V
Input Current (Operating) (Nom)	3.25/1.4/1.1 A A
Input Power (Nom)	368 W
Rated Lamp Watts	320 W
Wiring	
Wire Striplength	0.5 mm
Wire Length by Color	12"
Wire Type	Stranded
Remote Wiring Configuration Allowed	Yes

Core & Coil (71A) MH 175W - 450W

Max Ballast-Lamp Distance Remote Wiring	2'
Recommended Fuse Value	8/4/3 A

Approval and Application

Open Circuit Voltage Test (Volts)	260-310 V
Approbation Marks	ULR CSA certificate RoHS Compliant
Temperature Marking	C/C/C
UL Recognized	Yes
Hipot Test (1 Minute)	2000 V
Hipot Test (2 Seconds)	2500 V
UL Insulation Class	H(180°C)
UL Temperature Code	1029C

Product Data

Order product name	CORE & COIL HID 71A58A2500DA
EAN/UPC - Product	781087042762
Order code	71A58A2500DA
Numerator - Quantity Per Pack	1
Numerator - Packs per outer box	4
Material Nr. (12NC)	913710577402
Net Weight (Piece)	4.523 kg

Dimensional drawing

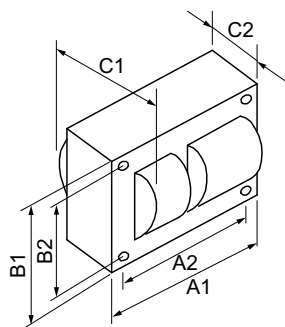

MH BAL 320W M132/154 120/277/347V C&C

Product	C1	C2	A1	A2	B1	B2
CORE & COIL HID 71A58A2500DA	3.65 in	1.8 in	4.8 in	4.4 in	4.3 in	3.9 in

