



# Core & Coil (71A) LPS

## CORE & COIL HID 71A0490001D

The basic ballast is the open core and coil which is most often used as a component within a lighting luminaire. The core and coil also forms the nucleus of Philips Advance's five other ballast configurations.

### Product data

General Information	
ANSI Code	L71
Lamp Type	55W LPS
Number of Lamps	1 piece/unit
Circuit Type	HX-HPF
Ballast Type	Magnetic HID
Base Model	71A0490
Core Size	3 X 4 (2 coil)
Suitable For Outdoor Use	Yes
Capacitor Value	14 MFD
Capacitor Catalog Number	7C140M30RA
Capacitor Requirements	240V
Capacitor Temperature Rating	105°C
Capacitor Diameter/Oval Dimensions	1.65 in
Capacitor Height	2.75 in
Automatic Restart	No

Operating and Electrical	
Input Voltage	120/208/240/277 V
Input Frequency	60 Hz
Input Current (Open Circuit)	2.35/1.39/1.18/0.98 A
Input Current (Starting)	0.8/0.46/0.39/0.36 A
Input Current (Short Circuit)	0.36-0.54/0.23-0.34/0.2-0.3/0.16-0.25 A
Secondary Short Circuit Current	0.5-0.7 A

Constant Wattage Deviation	10%
Ballast Factor (Nom)	1
Power Factor (Nom)	0.90
Open Circuit Voltage	480 V
Input Current (Nom)	0.73/0.42/0.36/0.32 A A
Input Power (Nom)	80 W
Rated Lamp Power	55 W

Wiring	
Wire Striplength	0.5 mm
Wire Length by Color	12"
Wire Type	Stranded
Remote Wiring Configuration Allowed	Yes
Max Ballast-Lamp Distance Remote Wiring	Determined by AWG used
Recommended Fuse Value	6/4/3/3 A

Approval and Application	
Open Circuit Voltage Test (Volts)	430-530 V
Approval Marks	ULR CSA certificate RoHS Compliant
Temperature Marking	A/A/A/A
UL Recognized	Yes
Hipot Test (1 Minute)	2000 V
Hipot Test (2 Seconds)	2500 V
UL Insulation Class	H(180°C)

Core & Coil (71A) LPS

UL Temperature Code	1029A
Product Data	
Order product name	CORE & COIL HID 71A0490001D
EAN/UPC - Product	781087025567
Order code	177014
Local order code	.

Numerator - Quantity Per Pack	1
Numerator - Packs per outer box	1
Material Nr. (12NC)	913700502031
Net Weight (Piece)	3.362 kg

Dimensional drawing

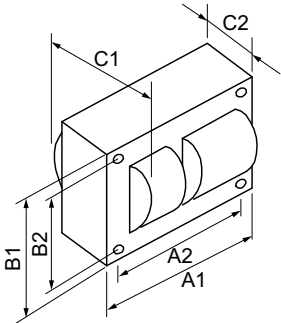

Product	C1	C2	A1	A2	B1	B2
CORE & COIL HID 71A0490001D	3.5 in	2.25 in	3.9 in	3.5 in	2.8 in	2.4 in

LPS BAL 35/55W L70/71 QUAD KIT

