

# Core & Coil (71A) MH ~LT~ 175W

## CORE & COIL HID MH BAL 100W M90/140 480V/120T C&C

The basic ballast is the open core and coil which is most often used as a component within a lighting luminaire. The core and coil also forms the nucleus of Philips Advance's five other ballast configurations.

### Product data

General Information		Operating and Electrical	
ANSI Code	M90-M140	Input Voltage	480 V
Lamp Type	100 MH	Input Frequency	60 Hz
Number of Lamps	1 piece/unit	Inp. Current (Open Circuit)	0.55 A
Circuit Type	HX-HPF	Input Current (Starting)	0.3 A
Ballast Type	Magnetic HID	Input Current (Short Circuit)	0.24-0.36 A
Base Model	71A5340T	Secondary Short Circuit Current	1.35-1.65 A
Core Size	3 X 4 (2 coil)	Constant Wattage Deviation	12%
Suitable For Outdoor Use	Yes	Ballast Factor (Nom)	1
Ignitor Catalog Number	LI533-H4	Power Factor (Nom)	0.90
Ignitor Temperature Rating	105°C	Nominal Open Circuit Voltage	260 V
Capacitor Value	10 MFD	Input Current (Operating) (Nom)	0.3 A A
Capacitor Catalog Number	7C100M30RA	Input Power (Nom)	132 W
Capacitor Requirements	300V	Rated Lamp Watts	100 W
Capacitor Temperature Rating	105°C	Wiring	
Capacitor Diameter/Oval Dimensions	1.65 in	Wire Striplength	0.5 mm
Capacitor Height	2.75 in	Wire Length by Color	12"
Automatic Restart	No	Wire Type	Stranded
		Remote Wiring Configuration Allowed	Yes

Core & Coil (71A) MH ~LT~ 175W

Max Ballast-Lamp Distance Remote Wiring	25'
Recommended Fuse Value	2 A
Approval and Application	
Open Circuit Voltage Test (Volts)	234-286 V
Approbation Marks	RoHS Compliant CSA certificate
Temperature Marking	C
UL Recognized	Yes
Hipot Test (1 Minute)	2000 V
Hipot Test (2 Seconds)	2500 V
UL Insulation Class	H(180°C)
UL Temperature Code	1029C

Product Data	
Order product name	CORE & COIL HID 71A5340500DT
EAN/UPC - Product	781087094099
Order code	71A5340500DT
Numerator - Quantity Per Pack	1
Numerator - Packs per outer box	6
Material Nr. (12NC)	913700532809
Net Weight (Piece)	2.627 kg

Dimensional drawing

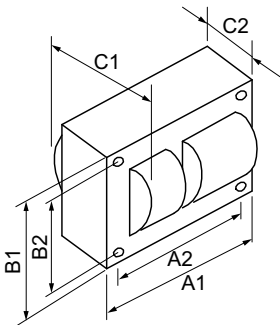

MH BAL 100W M90/140 480V/120T C&C

Product	C1	C2	A1	A2	B1	B2
CORE & COIL HID 71A5340500DT	2.9 in	1.7 in	3.9 in	3.5 in	2.8 in	2.4 in

