



GWL3-LED50

LED Wall Light



SPECIFICATIONS*

Watts	50
Lumens	5025
Efficacy	101
Replaces Up To	150W MH
Colour Temp	5000K*
Certification	cULus, IP65, DLC
Operating Temp	-40°C to +40°C
Voltage	120-277V*, 347V
LED Life	100,000 Hours
Housing Material	Cast Aluminum
Lens Material	Polycarbonate
Finish	Bronze
Total Harmonic Distortion	13.72%
Power Factor	>80
Mounting Options	Wall Mounted

*Standard



DESCRIPTION

The GWL-LED fixtures are compact in design, have an easy installation feature and a high efficacy of over 100 lumens per watt.

APPLICATIONS



Entrances
and Exits



Offices



Condos

FEATURES

- Fixture is designed to hook and secure itself on top of the housing so installer can use both hands to connect wires easily.
- The backbox has a built-in level bubble to facilitate mounting alignment
- Die cast aluminum housing with stainless steel hardware
- The fixture can be surface mounted onto a junction box or directly mounted on the wall

*The above specs apply to the standard product configuration. For spec information on other product configurations please see page 2.

NOTE: Not all of our product configurations are qualified on the DLC QPL. To view all of our DLC qualified products please visit the DLC qualified products list at www.designlights.org/qpl.

CANDELA PLOTS

GWL3-LED50 5K MOUNTED AT 24 FEET

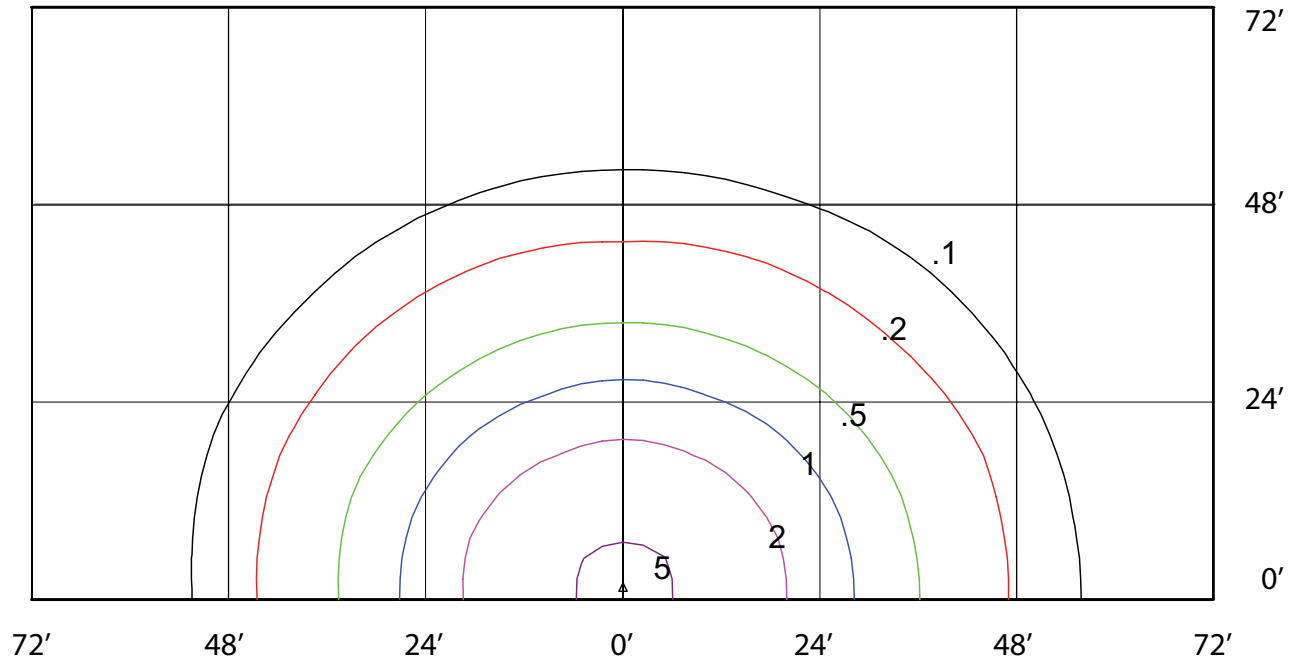

DIMENSIONS

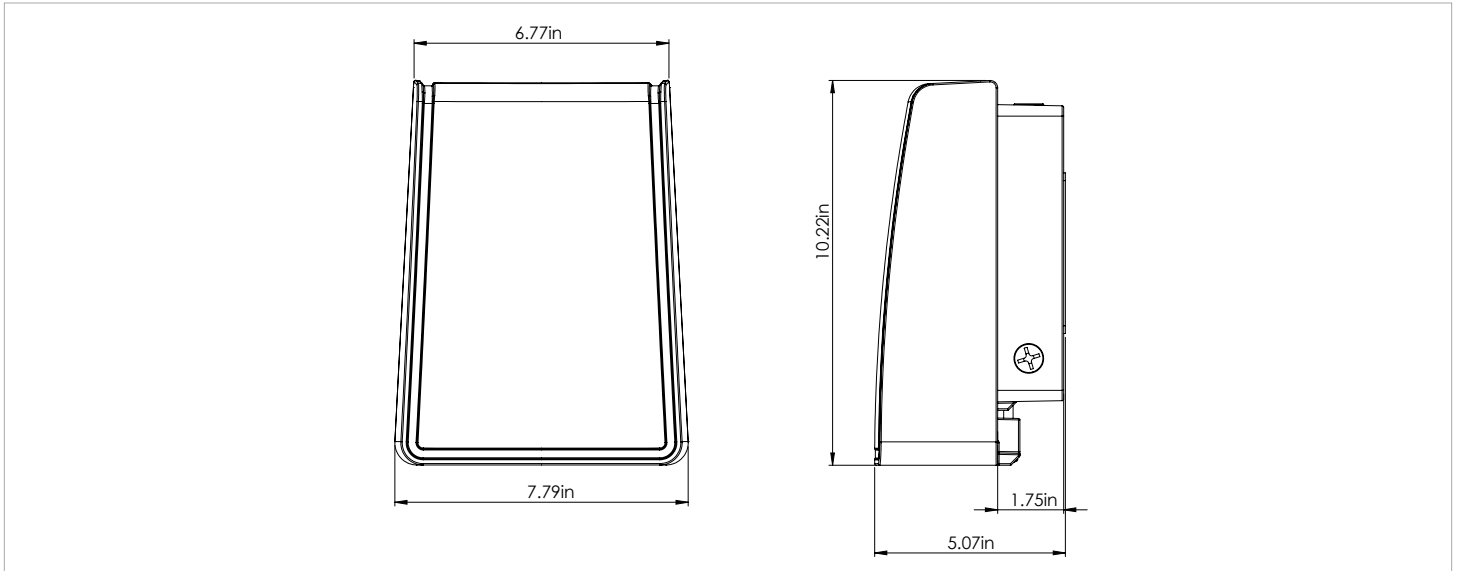

EASY INSTALLATION



Open fixture, mount back box to junction box

Hook fixture on top of the housing and easily connect wires using both hands

Unhook fixture from housing, flip over and reattach fixture to housing

Push fixture against housing and tighten screw(s) below lens

OTHER MODEL SPECIFICATIONS

MODEL DESCRIPTION	VOLTAGE (V)	INPUT POWER (W)	LIGHT OUTPUT	EFFICACY (Lm/W)	THD	PF	CCT(K)	CRI
GWL3-LED50-B-5K-XXX	120-277	49.81	5025.1	100.88	13.72	0.9051	5000	84
GWL3-LED50-C-5K-XXX	347	51.3	4893.7	95.39	12.78	0.918	5000	80.8

LEGEND

B - 120V-277V, C-347V
5K - 5000K
XXX - HOUSING FINISH

ORDERING GUIDE

GWL3

LED50

WATTS	VOLTAGE	COLOUR TEMP.	FINISH
	B - 120 - 277V*	5K - 5000K*	BRZ - BRONZE*
	C - 347V		