



PIPE TOOLS & VISES
SINCE 1896

Pump Stick® Cordless Water Transfer Pump

Replacement Parts

Applies to: 08140,
08141, 08144, 08146

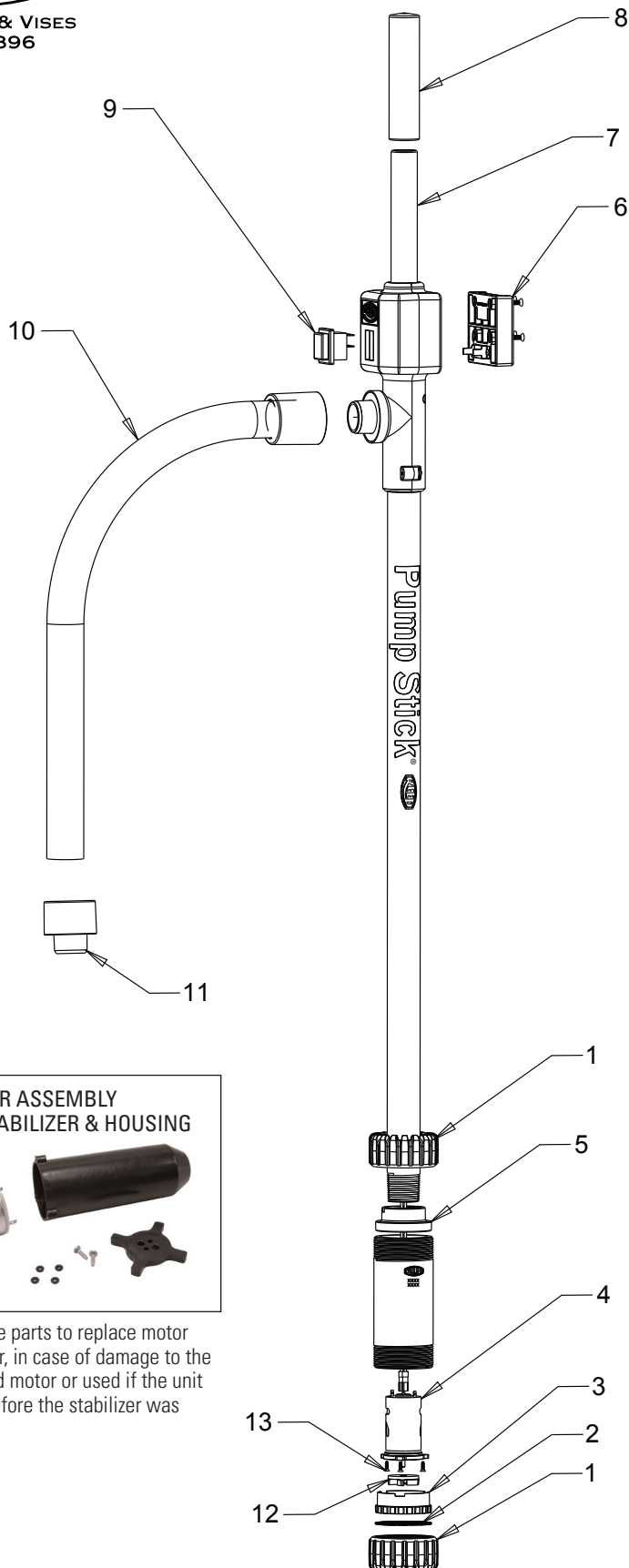

Parts List

Ref. No.	Part Number	Description
1	48106	END CAP (2)
2	98198	COARSE SCREEN (standard)
	98166*	MEDIUM SCREEN
	98167*	FINE SCREEN
	98168*	FELT FILTER 100 MICRON
	98188*	MARINE STRAINER
	98189*	DOMED STRAINER
3	48109	SPACER
4	08142	CP15 MOTOR ASSEMBLY**
5	48105	UNION
6	98139	STANDARD BOSCH ADAPTER PLATE
	98140*	DEWALT ADAPTER PLATE
	98141*	MILWAUKEE ADAPTER PLATE
	98149*	MAKITA ADAPTER PLATE
7	98132	STANDARD HANDLE 6 INCH
	98184*	HANDLE 24 INCH W/GRIP
8	40095	HANDLE GRIP
9	48118	SWITCH
10	98143	HOSE 2FT (standard)
	98144*	HOSE 4FT
	98145*	HOSE 7FT
11	98147*	HOSE COUPLING
12	48108	IMPELLER
13	48127	MOTOR MOUNTING SCREWS (3)
14	98199	MOTOR ASSEMBLY w/ STABILIZER & HOUSING

*Optional Parts

** Motor Assembly includes motor, motor mount (with screws), and impeller.

Units shipped after April 2021 include 98198 Coarse Screen, installed.

14 MOTOR ASSEMBLY w/ STABILIZER & HOUSING



Kit provides all the parts to replace motor housing and motor, in case of damage to the motor housing and motor or used if the unit was purchased before the stabilizer was changed in 2023.

Reed Manufacturing
1425 West 8th Street
Erie, PA 16502 USA

QUALITY
& Service
that Last a Lifetime

Phone: 800-666-3691 or 814-452-3691
reedsales@reedmfgco.com
www.reedmfgco.com

RP-1224-138