

## PRE-INSULATED HEAT SHRINKABLE TERMINALS AND SPLICES

Terminals are NOT Actual Size See Sizing Chart on B-38, B-39

B

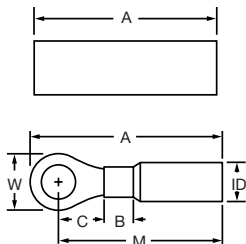

### RING TERMINALS

These heat shrinkable products provide a tough, environmentally sealed wire termination. These terminals and splices insulate and protect the electrical connections from wire pull-outs, abrasions and mechanical abuse. They also resist water, salt and other contaminants.

### BUTTED SEAM

LISTED

Rated at 600V, 105°C

Part #	Wire Size	Stud Size	Colour Insul.	Approx. Dimen. in Inches			
				A	W	C	M
761648	16-14	8	Blue	1.150	0.310	0.144	0.932
761649	16-14	10	Blue	1.275	0.394	0.225	1.035
761650	16-14	1/4	Blue	1.306	0.474	0.284	1.080
761651	16-14	3/8	Blue	1.548	0.706	0.414	1.207
761652	12-10	10	Yellow	1.417	0.394	0.225	1.035
761653	12-10	1/4	Yellow	1.467	0.474	0.284	1.080
761654	12-10	3/8	Yellow	1.829	0.706	0.414	1.207

For use with Copper Solid and Stranded Wire Only



### FEMALE DISCONNECTS (FOR .250 X .032 TABS)

### BUTTED SEAM

LISTED

Rated at 600V, 105°C

Part #	Wire Size	Stud Size	Colour Insul.	Approx. Dimen. in Inches	
				A	W
761655	16-14		Blue	1.14	0.253

For use with Copper Stranded Wire Only



### MALE DISCONNECTS

### BUTTED SEAM

LISTED

Rated at 600V, 105°C

Part #	Wire Size	Stud Size	Colour Insul.	A	W
761656	16-14		Blue	1.227	0.25

For use with Copper Stranded Wire Only



### BUTT CONNECTORS

### SEAMLESS

LISTED

Rated at 600V, 105°C

Part #	Copper Cond. Range	Stock Size (in)	Colour Code (ins)	Max. Insul. Diam.	A	ID
761244	22-18	0.03	Red	0.12	1.50	0.055
761245	16-14	0.03	Blue	0.155	1.50	0.09
761246	12-10	0.04	Yellow	0.215	1.625	0.142

For use with Copper Solid and Stranded Wire Only

\*Consult factory for other possible sizes and styles.

Add Suffix "B" for 500 pcs bulk pack

Standard Pack – 25 pcs/pack

