

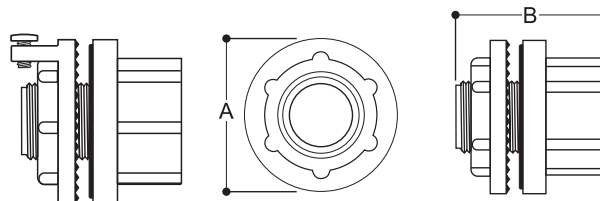

## WH SERIES CONDUIT HUBS



### DIE CAST ZINC

#### PART NUMBERS

Hub Size	Zinc Die Cast	Grounded	A	B	Mtg. Hole (minimum)
1/2"	WH-1	WH-1-G	1.54	1.31	0.84
3/4"	WH-2	WH-2-G	1.73	1.37	1.05
1"	WH-3	WH-3-G	2.04	1.59	1.31
1 1/4"	WH-4	WH-4-G	2.42	1.59	1.66
1 1/2"	WH-5	WH-5-G	2.79	1.59	1.90
2"	WH-6	WH-6-G	3.30	1.59	2.37
2 1/2"	WH-7	WH-7-G	3.70	2.47	2.88
3"	WH-8	WH-8-G	4.39	2.47	3.50
3 1/2"	WH-9	—	4.81	2.69	4.11
4"	WH-10	—	5.38	2.69	4.63

### WH SERIES WATERTIGHT CONDUIT HUBS

The Tuff-Seal™ WH Series of Watertight Conduit Hubs feature a design with unique angled serrations that provide a larger & tighter surface plus a reliable watertight seal even with rough or oversized knock-out. Used to connect rigid metal conduit (or IMC) to a threadless opening in electrical enclosures, Remke Conduit Hubs are rated NEMA 4 and may be used in either wet or dry applications.

Remke Watertight Conduit Hubs are available in 1/2" to 4" hub sizes in these materials:

- Die Cast Zinc – high strength & hardness with outstanding corrosion resistance

Designed with simple 2-piece construction, Remke WH Series Hubs offer positive grounding, protective insulated throats that prevent wire abrasion and an embedded O-Ring to ensure a watertight seal. A grounded style is also available.



G