



<b>EAN:</b>	4013288194992	<b>Size:</b>	265x75x50 mm
<b>Part number:</b>	05003884001	<b>Weight:</b>	269 g
<b>Article number:</b>	Belt A Imperial 1	<b>Country of origin:</b>	TW
		<b>Customs tariff number:</b>	82042000

- 9-piece bit-socket set on a robust textile belt, 1/4"
- Bit-sockets with all the advantages of the Wera bit technology
- Bit-sockets with holding function for screws/bolts
- Smooth Twist to Unlock mechanism for a secure fit and simple removal of the sockets
- Suitable for attachment to a wall, shelf, tool trolley and to the Wera 2go System

Typically Wera designed robust textile belt with 8 in-hex bit-sockets taking up minimal space. A smooth Twist to Unlock mechanism ensures a secure fit and simple removal of the sockets. Comes with „Take it easy“ Tool Finder with colour coding according to size to enable the right tool to be selected easily and quickly. Includes a snap hook for secure fastening to a belt loop or pocket. Supplied with a nonwoven reverse side and hook and loop strips for simple attachment e.g. to a wall, shelf, tool trolley and to the Wera 2go tool transport system.

**Web link**

[https://products.wera.de/en/innovations\\_and\\_autumn\\_winter\\_campaign\\_2019\\_2020\\_belt\\_a\\_imperial\\_1.html](https://products.wera.de/en/innovations_and_autumn_winter_campaign_2019_2020_belt_a_imperial_1.html)

Wera - Belt A Imperial 1  
05003884001 - 4013288194992

Wera Werkzeuge GmbH  
Korzerter Straße 21-25  
D-42349 Wuppertal  
Tel: +49 (0)2 02 / 40 45-0  
E-Mail: [info@wera.de](mailto:info@wera.de)

**Set contents:**



**8740 A HF**

05003383001	1 x 1/8" x 28 mm
05003384001	1 x 9/64" x 28 mm
05003385001	1 x 5/32" x 28 mm
05003386001	1 x 3/16" x 28 mm
05003387001	1 x 7/32" x 28 mm
05003388001	1 x 1/4" x 28 mm

**Wera Belts**



Wera Belts



Whoever would have thought that the storage of sockets could be completely revolutionised and that someone could come up with a stylish belt with securely attached sockets that can still be easily removed.

**Bit sockets with retaining function for hexagon socket screws**



The clamping of the screw is achieved by a flexible locking ball. The holding function is especially helpful in confined, hard-to-reach spaces, where there is no room for a second hand to secure the screw.

**Manual and machine sockets**



The manual and machine sockets can be used both for hand and power tools use (non-impact). Users need just one socket set for all applications.

**Web link**

[https://products.wera.de/en/innovations\\_and\\_autumn\\_winter\\_campaign\\_2019\\_2020\\_belt\\_a\\_imperial\\_1.html](https://products.wera.de/en/innovations_and_autumn_winter_campaign_2019_2020_belt_a_imperial_1.html)

Wera - Belt A Imperial 1  
05003884001 - 4013288194992

Wera Werkzeuge GmbH  
Korzerter Straße 21-25  
D-42349 Wuppertal  
Tel: +49 (0)2 02 / 40 45-0  
E-Mail: [info@wera.de](mailto:info@wera.de)

**"Take it easy" tool finder  
system**



"Take it easy" tool finder system - with profile and size colour-coding for quick and easy tool selection. Colour-coded system for hexagon drive screws (L-Keys, Zyklus bit sockets), external hex drive screws and nuts (Joker wrenches, Zyklus sockets and Zyklus bit sockets with holding function), and TORX® drive screws (L-Keys, Zyklus bit sockets).

**Secure hold and easy removal**

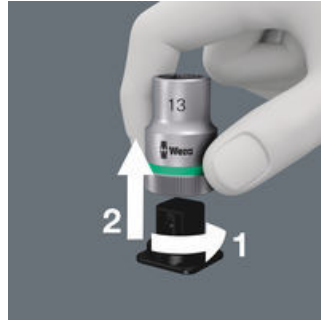

The all new smooth turning mechanism guarantees both secure and rattle-free storage, yet allows easy removal of the tool.

**Practical nonwoven strips**



The textile belt can be attached by means of the nonwoven reverse side and the hook and loop strips e.g. to a wall, shelf, tool trolley and to the Wera 2go tool transport system.

**Comes with convenient snap  
hook**



The robust textile belt can be secured to a belt loop or pocket by means of the snap hook.

**Web link**

[https://products.wera.de/en/innovations\\_and\\_autumn\\_winter\\_campaign\\_2019\\_2020\\_belt\\_a\\_imperial\\_1.html](https://products.wera.de/en/innovations_and_autumn_winter_campaign_2019_2020_belt_a_imperial_1.html)

Wera - Belt A Imperial 1  
05003884001 - 4013288194992

Wera Werkzeuge GmbH  
Korzer Straße 21-25  
D-42349 Wuppertal  
Tel: +49 (0)2 02 / 40 45-0  
E-Mail: [info@wera.de](mailto:info@wera.de)