

AF - 6030 2 Piece [60x30x72]

Gelcoat surface, reinforced fiberglass

Above floor rough-in bathtub with split walls

Soap ledges

Non slip bottom

Tiling flange

Armrests

Standard White

CSA Approved

Jetting Options

- AJ-6 jet whirlpool system
- AJ-Air System

Approximate Weight

- 130 lbs

Dimensions

A	59 3/4"	(1518mm)
B	30 3/4"	(781mm)
C	72 1/2"	(1842mm)
D	14 1/2"	(368mm)
E	10 1/2"	(267mm)
F	14"	(356mm)

Overflow
to Drain

G	18 1/2"	(470mm)
H	52"	(1321mm)

WALL
S

Door Opening

54"
(1372mm)

Inner Tub Dimensions

TOP	52 x 25"	(1321 x 635mm)
BOTTOM	43 x 18 1/2"	(1092 x 470mm)

VOLUME 198 L

ABOVE FLOOR MODEL

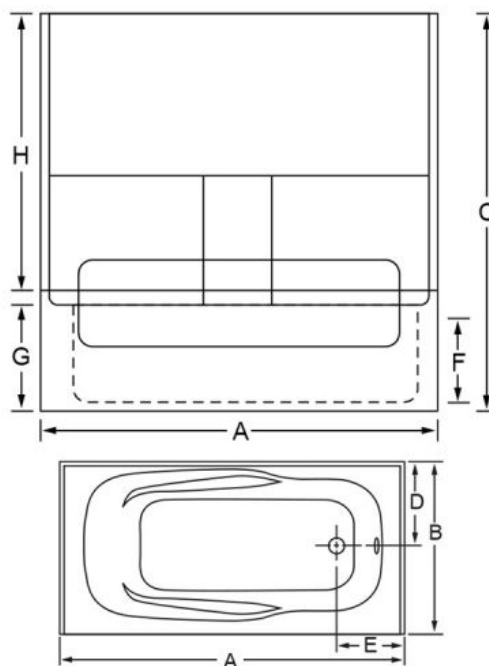

Product is made of Gel-coat surface & reinforced with heavy-duty fiberglass. The unit has a 1" nailing flange on front & top edges (except for drop in tubs). Product measurements are to the outside of nailing flange. Measurements are plus (+) or minus (-) 1/4".

Altрек cannot assume responsibility for code compliance in your specific project. Please check specifications and other information with the appropriate authorities before ordering.

Altрек reserves the right to discontinue or make changes to product dimensions at any time. Standard colour is WHITE. Additional charge for Bone, Biscuit & Linen.