



PRODUCT DESCRIPTION

A seamless loop of light and metal, the Mobius loop pushes boundaries with a non-orientable surface. Encased in a hand formed etched acrylic tube a innovative, omnidirectional LED light strip brightly illuminates. Inspired by artisanal metal knot decor, the LED pendants provide both functional light and create interest in their form. Finished in Natural Aged Brass and completed with a two-tone black and brass canopy, this fashion-forward lighting sculpture is sure to make a statement.

MEASUREMENTS

DIMENSION : 32" L x 27" W x 29" H  
MAX OAH : 73.75" OAH  
CANOPY : 8" W x 1.5" H x 8" L  
HANGING WEIGHT : 11.68 lb

LAMPING

INPUT VOLTAGE : 100-135V  
LUMENS : 3,510 Rated (3,220 Del.)  
BULB : 1 x 40.3W LED PCB Integrated , 40W Total  
BULB INCLUDED : (Integrated)  
DIMMABLE : ELV  
CRI : 90 CRI  
COLOR\_TEMP : 3000K

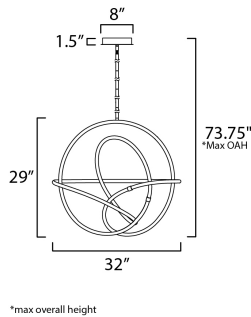

FINISHES OPTION

 Black / Gold (BKGLD)

GLASS

White 01

MATERIAL

Steel + Aluminum+Acrylic

RATINGS

cETLus  
Dry Location



ADDITIONAL

RATED LIFE 40000 Hours  
OPERATING TEMPERATURE:  
-20°C (-4°F), 40°C (104°F)

Always consult a qualified electrician before installing any lighting product.



Contemporary  
Lighting™

WESTERN DISTRIBUTION CENTER (HEADQUARTER)  
253 NORTH VINELAND AVE | CITY OF INDUSTRY, CA 91746  
EASTERN DISTRIBUTION CENTER  
101 GARDNER PARK | PEACHTREE CITY, GA 30269  
P. 626.956.4200 | F. 626.956.4225 | maximlighting.com